



CONSTRUCTION NOTICE

AUGUST 2023

Alley Entrance from Highland Park Way SW Closed and Sidewalk Detours in Effect

WHAT'S HAPPENING

To increase safety and accessibility, we are rebuilding the sidewalk on the west side of Highland Park Way SW between SW Holden St and SW Portland St. As part of this work, we need to close and rebuild the entrance to the alley from Highland Park Way SW.

WHEN

The alley entrance is expected to be closed from August 31 – September 6. The sidewalk is currently closed, and it is scheduled to reopen by September 8.

WHAT TO EXPECT

All residents will need to use the alley entrance on 11th Ave SW during the closure. Also, if you are walking along Highland Park Way SW, please use the sidewalk on east side. There are crossings at SW Holden St and SW Kenyon St. (See map on the right.)

CONSTRUCTION NOISE

You have likely heard especially noisy work as our crews demolished the existing sidewalk. They use a chipping hammer to break up the concrete and it is very loud and generates vibrations. Most of that work is done, but there is a small section remaining, which will likely be demolished this week.

KEEPING YOU INFORMED

We are working to provide better and more timely notifications for people who live in the project area. If you would like to get weekly emails about what to expect in terms of noise and impacts, please send us a message at: HighlandHolden@seattle.gov. Note: These are separate from the broader and less frequent updates you subscribe to on our webpage.

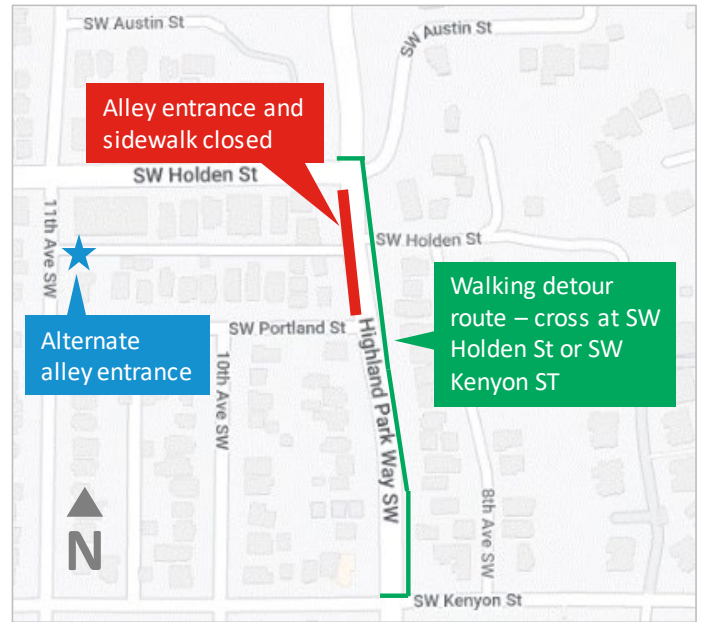

bit.ly/3pQCn2L

Scan the QR code to learn more about the project and to sign up for email updates!

Thank you for your patience as we work to complete these improvements in your neighborhood!

CONTACT INFORMATION

Highland Park Way SW & SW Holden St Safety Project
HighlandHolden@seattle.gov | (206) 900-8741
Interpretation services are available for free.

