



906

TRACK



908











906

WASHINGTON  
AVT2628  
KENDALL



STAMP:

PERMIT SET

**Project Name: Welch Residence - New Carport**  
**Project Address: 906 Summit Avenue E, Seattle, WA 98102**

REVISIONS:

DATE: 9/30/2022

SCALE: As Shown

JOB #: 31-2022

DWN: CHK:

SHEET TITLE:

**CARPORT  
FLOOR AND ROOF  
PLANS**

SHEET:

**A101**

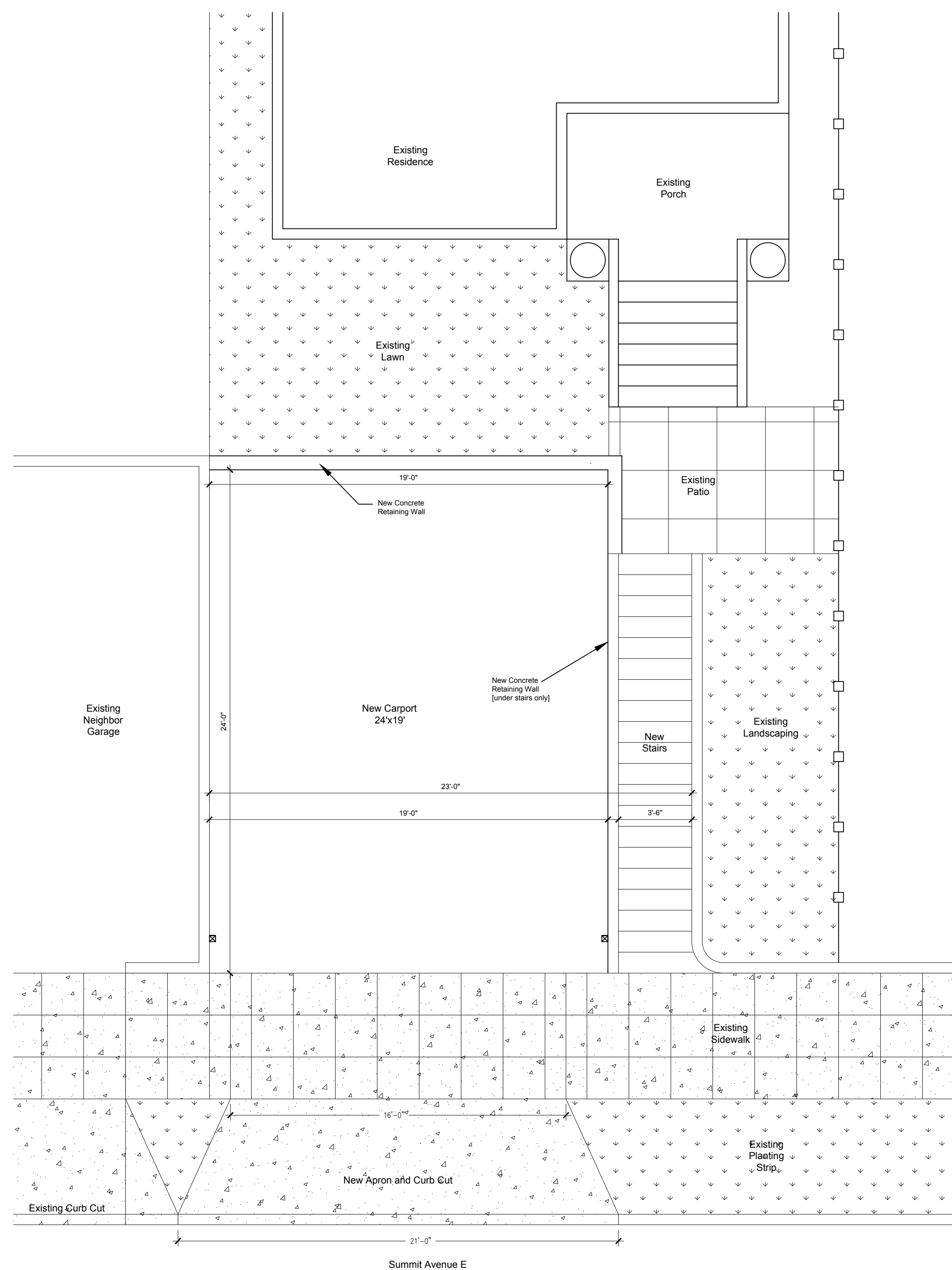

**1 CARPORT PLAN**  
A101 SCALE: 1/4"=1'

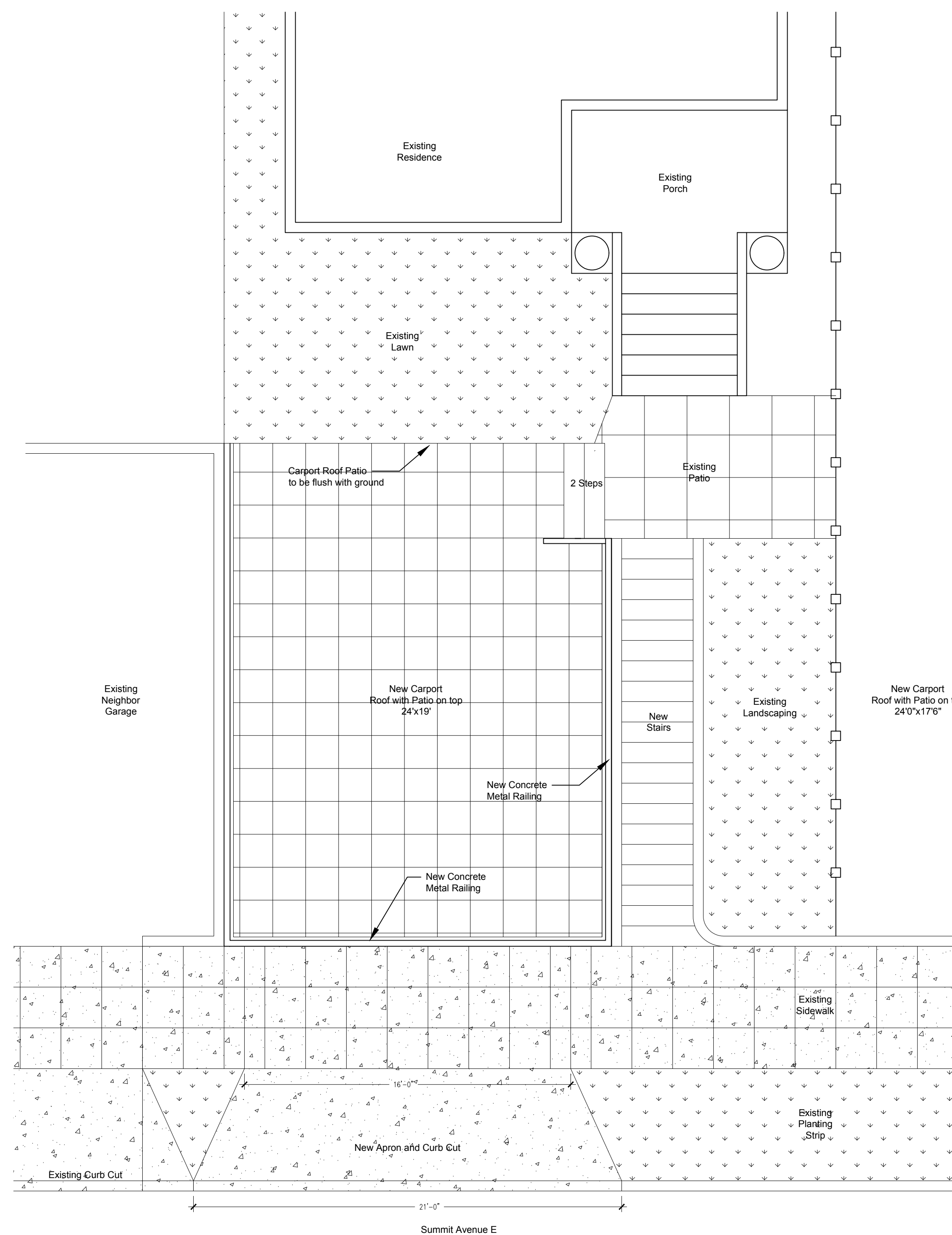

**2 CARPORT ROOF PLAN**  
A101 SCALE: 1/4"=1'

**SVS**

Architecture LLC

27311 10th Place S  
Des Moines, WA 98198  
SVSArchitecture@gmail.com  
www.vladsirbu.com  
(425) 442-3412



STAMP:

PERMIT SET

**Project Name: Welch Residence - New Carport**  
**Project Address: 906 Summit Avenue E, Seattle, WA 98102**

REVISIONS:

DATE: 9/30/2022  
SCALE: As Shown  
JOB #: 31-2022

DWN: CHK:

SHEET TITLE:

WEST CARPORT  
ELEVATION

SHEET:

**A102**



1 WEST ELEVATION  
A102 SCALE: 1/4"=1'



STAMP:

PERMIT SET

Project Name: Welch Residence - New Carport  
Project Address: 906 Summit Avenue E, Seattle, WA 98102

REVISIONS:

DATE: 9/30/2022

SCALE: As Shown

JOB #: 31-2022

DWN: CHK:

SHEET TITLE:

SOUTH CARPORT  
ELEVATION

SHEET:

**A103**

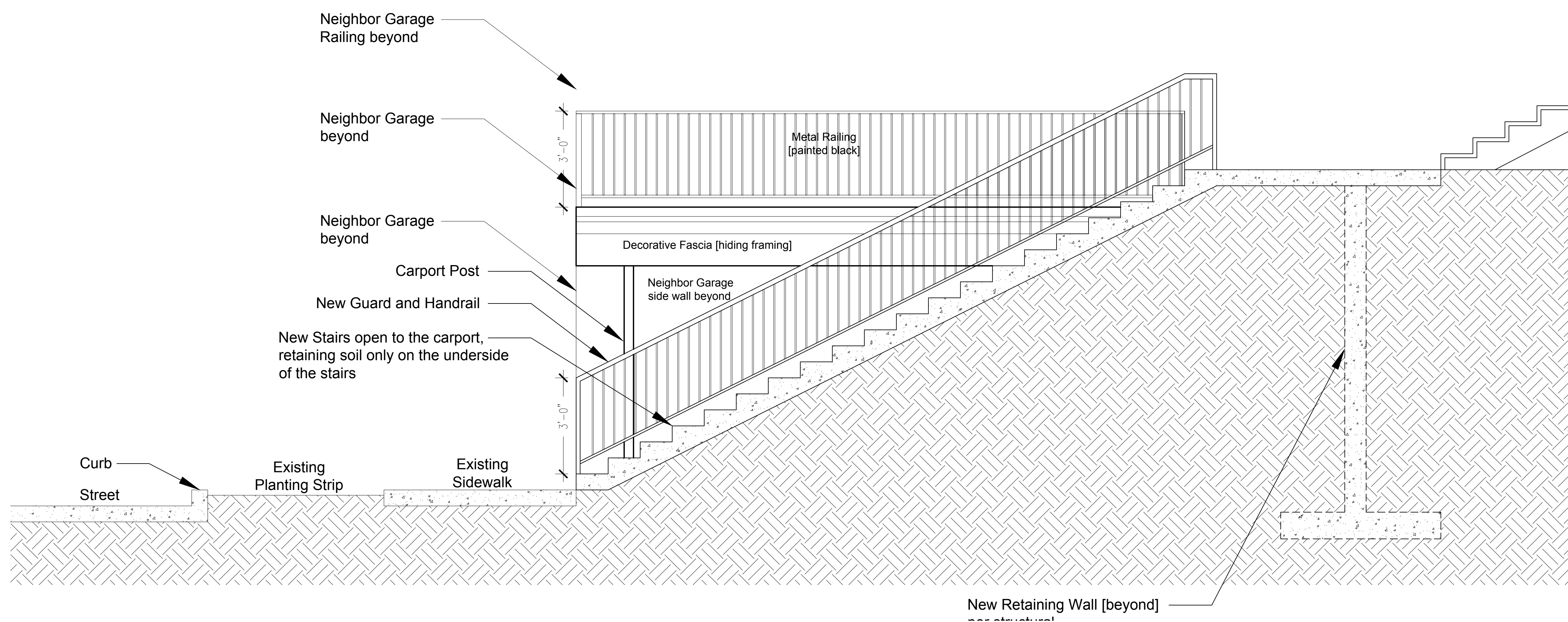
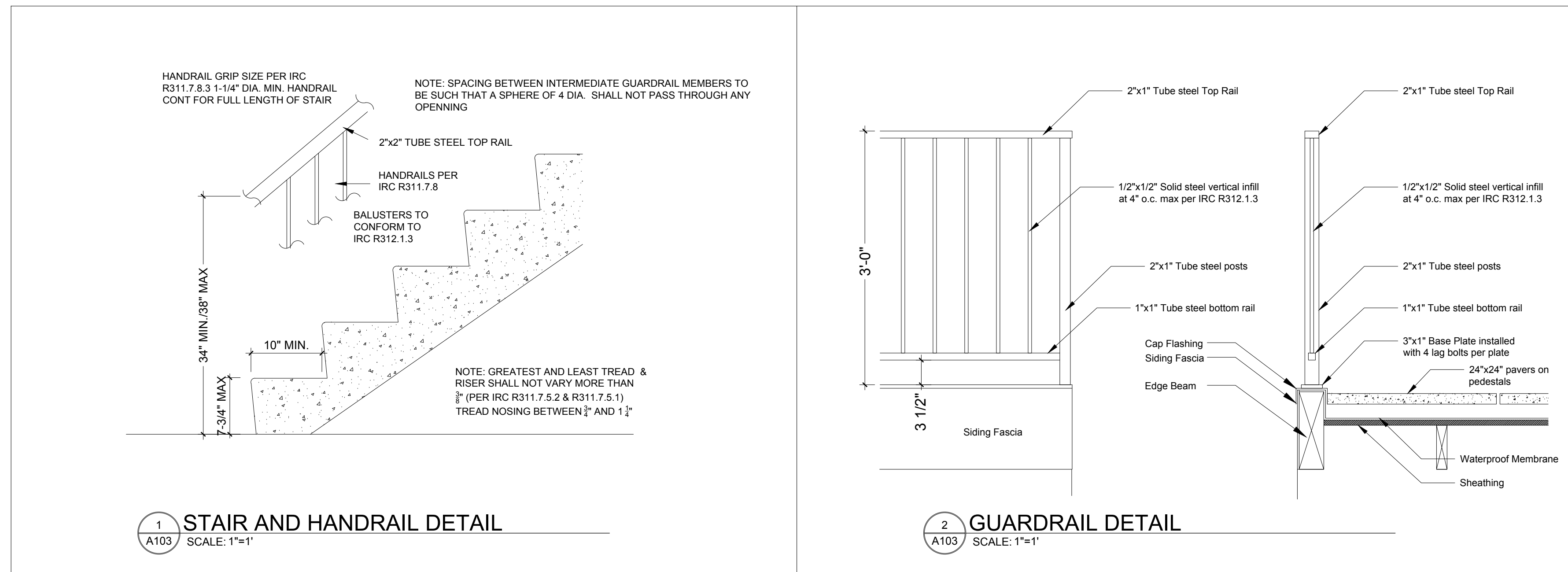

**1 SOUTH ELEVATION**  
SCALE: 1/4"=1'



1020

1020 Belmont Ave E, Seattle, WA 98102



1000 Belmont Ave E, Seattle, WA 98102



1028 Belmont Ave E, Seattle, WA 98102



766 Belmont Ave E, Seattle, WA