



# memo

---

to **Genna Nashem, DON + Pioneer Square Preservation Board**  
from **Amanda Bailey, MIG; Steve Burke, MIG; Dave Rodgers, MIG**  
re **Pioneer Square East West Streets Pedestrian Improvements**  
**Light Poles and Chief Seattle Bases - Seattle City Light Feedback on Reuse**  
MIG #15149.03  
date **August 4, 2022**

---

## OVERVIEW

When presenting the Pioneer Square East West Streets Pedestrian Improvements project (the Project) to the Pioneer Square Preservation Board (Board), the Board requested more information and documentation regarding the existing Chief Seattle light pole bases, stating that they did not want to lose the historic bases, if possible.

The project team (OWCP with MIG) met with Tom Borek (SCL) to discuss the Chief Seattle light pole bases at each of the three (3) locations where poles are proposed to be relocated. Purpose of relocating the poles is to improve accessibility and the overall pedestrian experience in the right-of-way as part of the Project. Note the locations below, and in further detail on pages 4-5.

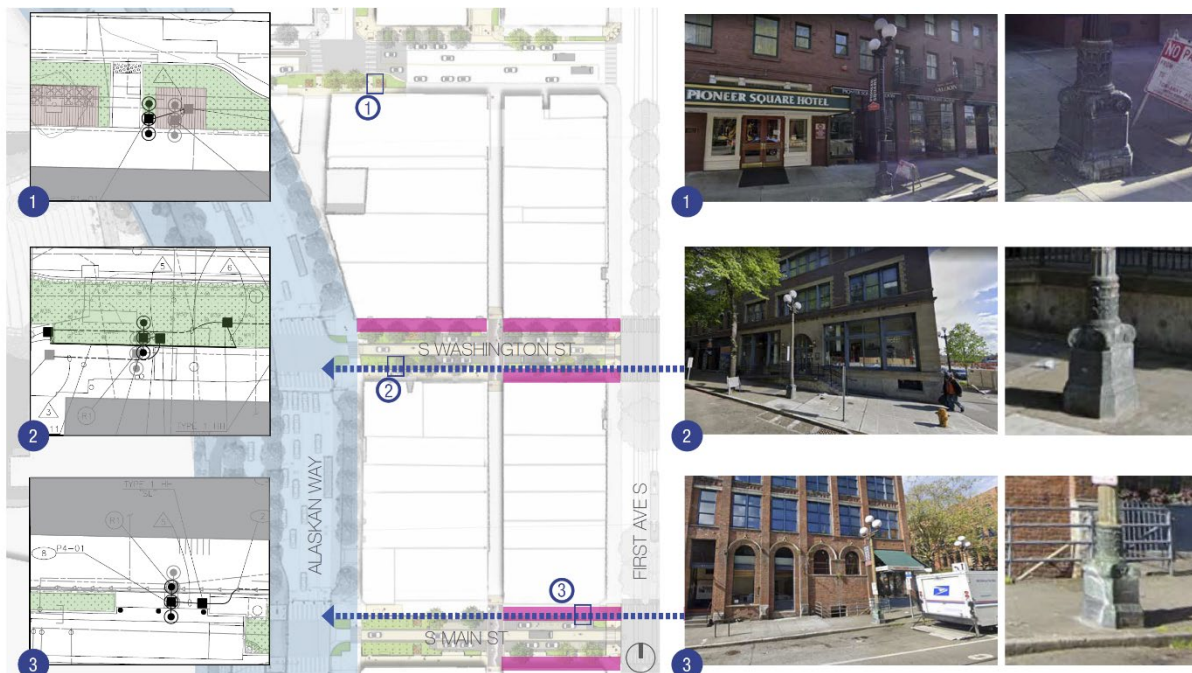

## SCL FEEDBACK ON “TYPE D” POLES WITH CHIEF SEATTLE BASES

One can identify the old poles from circa 1927, called “Type D” poles, by the collar roughly 15 feet up the pole (see orange arrow in Figure 1). The collars exist on poles that were switched from the acorn fixtures to the three-globe fixtures, many circa the 1960s and 70s. All three of the Project’s poles to be relocated are “Type D” ornamental poles as identified by their collars and have Chief Seattle bases.



Figure 1. "Type D" pole with collar identified.

Light poles and Chief Seattle bases installed circa 1927 are concrete-filled. The method of anchoring these poles to foundations consisted of four (4) steel angle cleats that were imbedded in concrete inside the base and sitting just outside of the base below sidewalk grade. Over the years, these steel cleats degraded to the point that they are easy to break off whenever a sidewalk is removed. Quite often, the only way to remove the old pole and base would be to either cut the supporting cleats, or carefully cut the anchor bolts below grade. However, both removal methods would make the pole unusable (see Figure 2).





*Figure 2. Example of Chief Seattle Base removed during construction*

As can be seen in Figure 2, the steel angle cleats have started to delaminate making the pole unsafe. SCL, as policy, does not reuse, relocate, or repurpose these old poles within the public ROW as they don't meet current standards. SCL will not take liability to maintain infrastructure that is structurally unsafe or that would create hazardous conditions for the public. This applies to any existing ornamental concrete-filled Chief Seattle Base, not only in the Pioneer Square area, but in other locations of CDB as well.

If the access door on the back side (typically facing away from the street, see Figure 3) of the Chief Seattle base were to be opened, you will see the concrete-filled interior. The screws are often stripped on the doors of these bases, rendering them inoperable.



*Figure 3. Access Panel.*

From a salvage standpoint, per SCL specifications, the three existing poles are to be delivered to SCL. SCL cannot reuse.

Mr. Borek shared that the new Chief Seattle bases were believed to have been developed in collaboration with SDOT, SCL, and the Board. These newer bases are made of bronze, not painted, and will patina over time. They are two-piece instead of one-piece, for constructability reasons, and are now installed without being filled with concrete.

## **PROJECT-SPECIFIC CHIEF SEATTLE BASE AND POLE LOCATIONS**

Per the map on page 1, each Chief Seattle base and pole were identified and assessed as follows:

1. At south side of the S Yesler Way and Western Ave intersection:

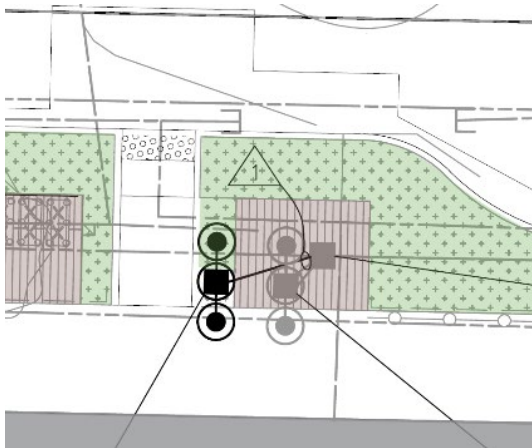

This is a “type D” pole with the Chief Seattle base filled with concrete. The pole was more recently painted black. The pole and base are not reusable.

2. At south side of S Washington St, just east of Alaskan Way:



This is a “type D” pole with the Chief Seattle base filled with concrete. The pole and base are not reusable.

3. At north side of S Main St, just west of First Ave S:

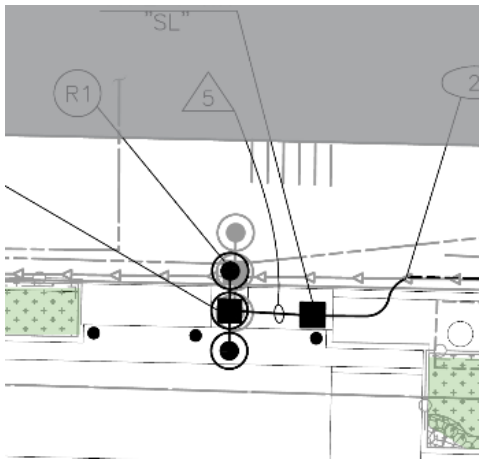

This is a “type D” pole with the Chief Seattle base filled with concrete. The pole and base are not reusable.