

Multifamily Roll-Off Compaction
(242 Apartments + 7,600 ft2 Commercial)
Best Practices

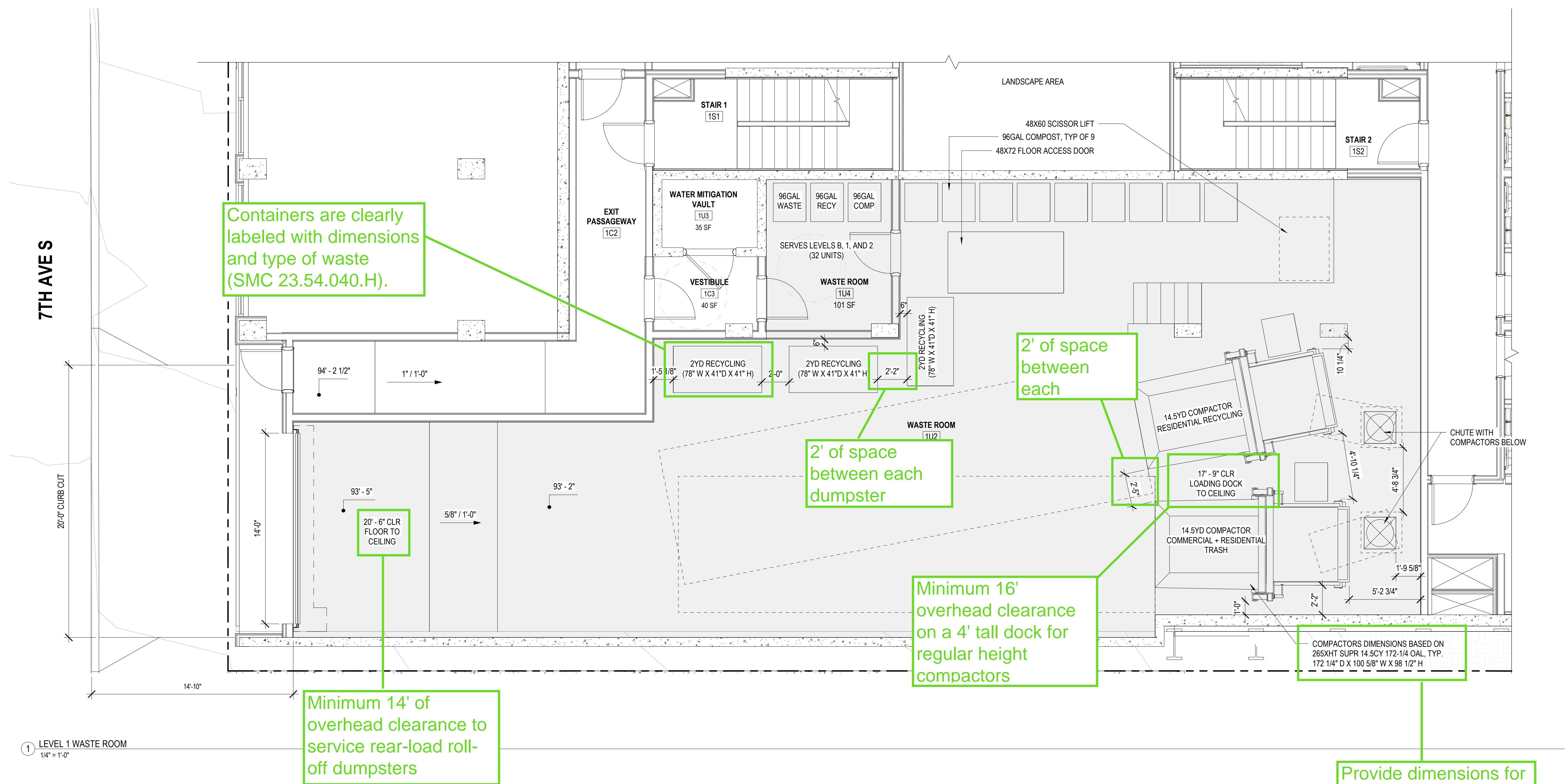

SOLID WASTE NOTES

242 TOTAL RESIDENTIAL UNITS (74 CONGREGATE, 168 SEDU)
- LEVELS B, 1 & 2 DO NOT HAVE ACCESS TO TRASH CHUTE/COMPACTOR (32 UNITS)
5000 SF COMMERCIAL

WASTE ROOM LOAD

COMPOST
COMMERCIAL (1 TOTE / COMMERCIAL SPACE) * 4 COMMERCIAL SPACES = 4X 96G TOTES
RESIDENTIAL 242 UNITS * (1 TOTE / 50 UNITS) = 5X 96G TOTES

9X 96G TOTES

RECYCLING
COMMERCIAL 5000 SF * (1 CY / 1000 SF) = 5CY
RESIDENTIAL 242 UNITS * (1 CY/10 UNITS) = 24.2 CY

**3 X 2CY DUMPSTERS (COMMERCIAL)
1 X 14.5 CY COMPACTED**

TRASH
COMMERCIAL 5000 SF * (1 CY / 1000 SF) = 5CY
RESIDENTIAL 242 UNITS * (1 CY/10 UNITS) = 24.2 CY

1 X 14.5 CY COMPACTED

WASTE ROOM STORAGE AREA (SMC 23.54.040)

RESIDENTIAL	MORE THAN 100 DWELLING UNITS = 575 SF + (4 SF / UNIT) * 142 UNITS = 1,143 SF
COMMERCIAL	5,001 - 15,000 SF OF NON-RESIDENTIAL AREA = 125 SF
TOTAL	1,268 SF + (1,268 SF * 15%) = 1,088 SF
TOTAL REQUIRED	1,268 SF
TOTAL PROVIDED	1,864 SF

PER SMC 23.54.040.C: FOR DEVELOPMENTS WITH > 100 DWELLING UNITS, THE REQUIRED MIN AREA FOR STORAGE STAPCE MAY BE REDUCED BY 15% IF THE AREA PROVIDED HAS A MIN. HORIZONTAL DIMENSION OF 20 FT.

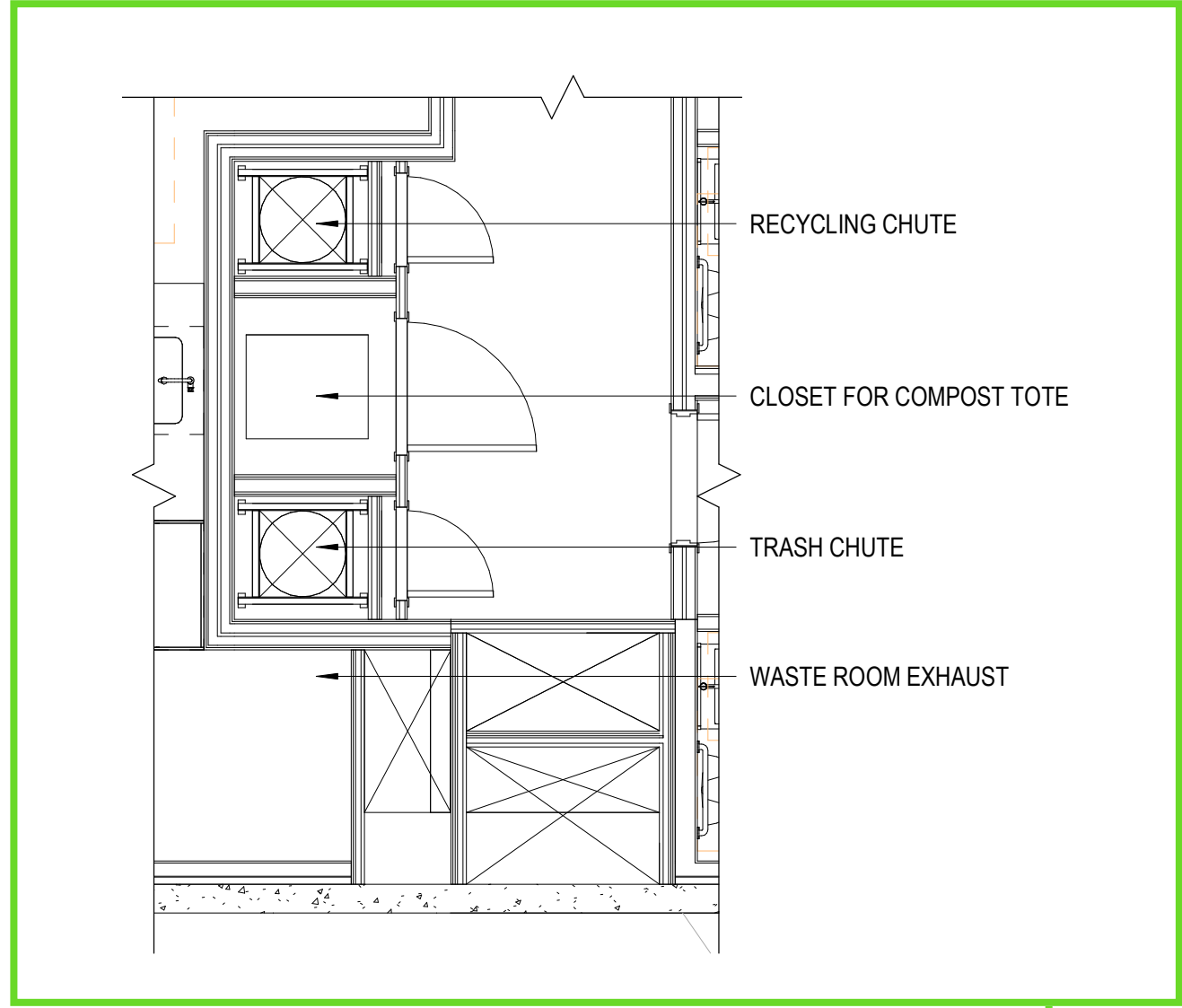

Recommended on-floor solid waste disposal rooms include space for one, 32-gallon food waste container

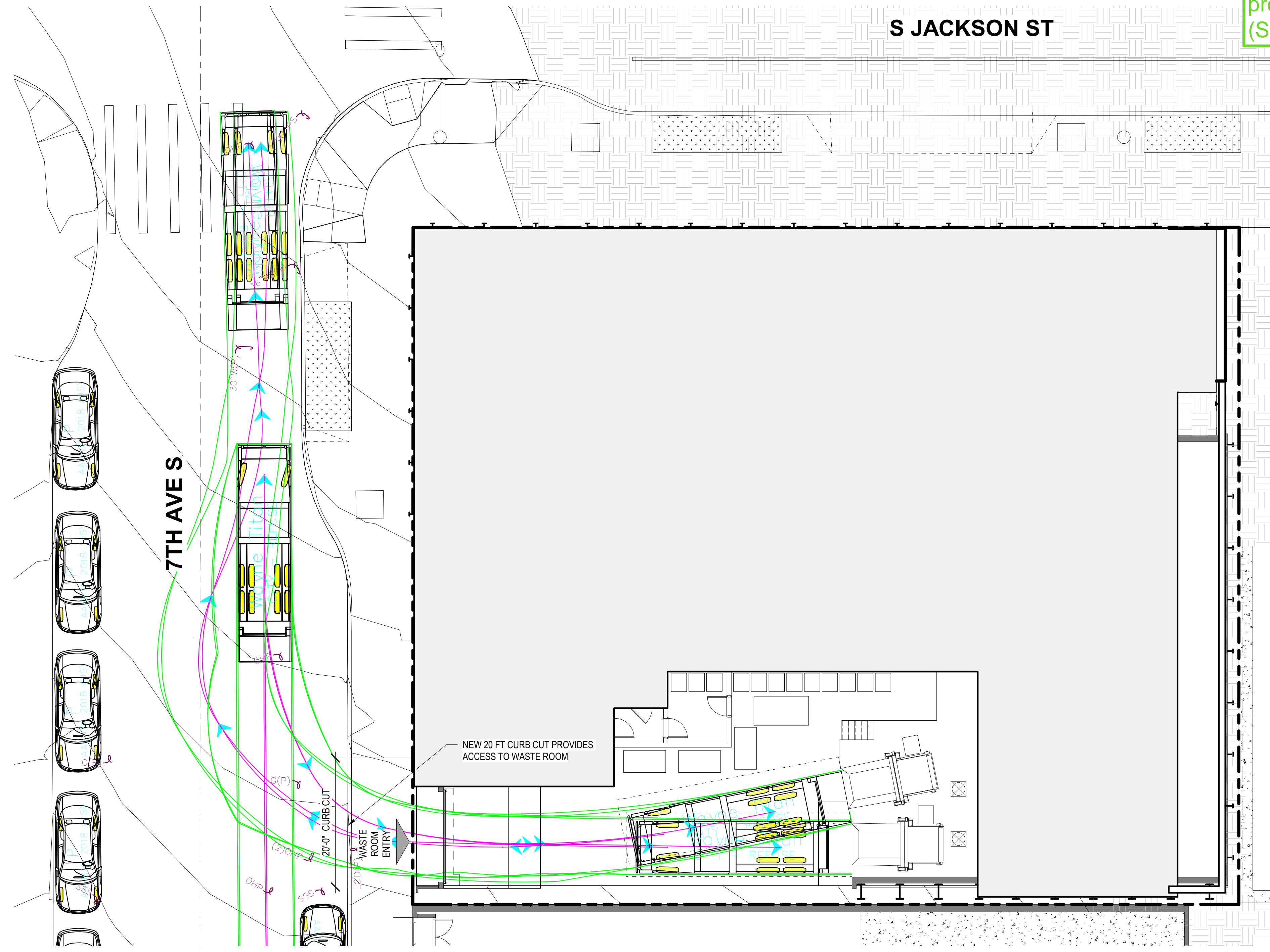

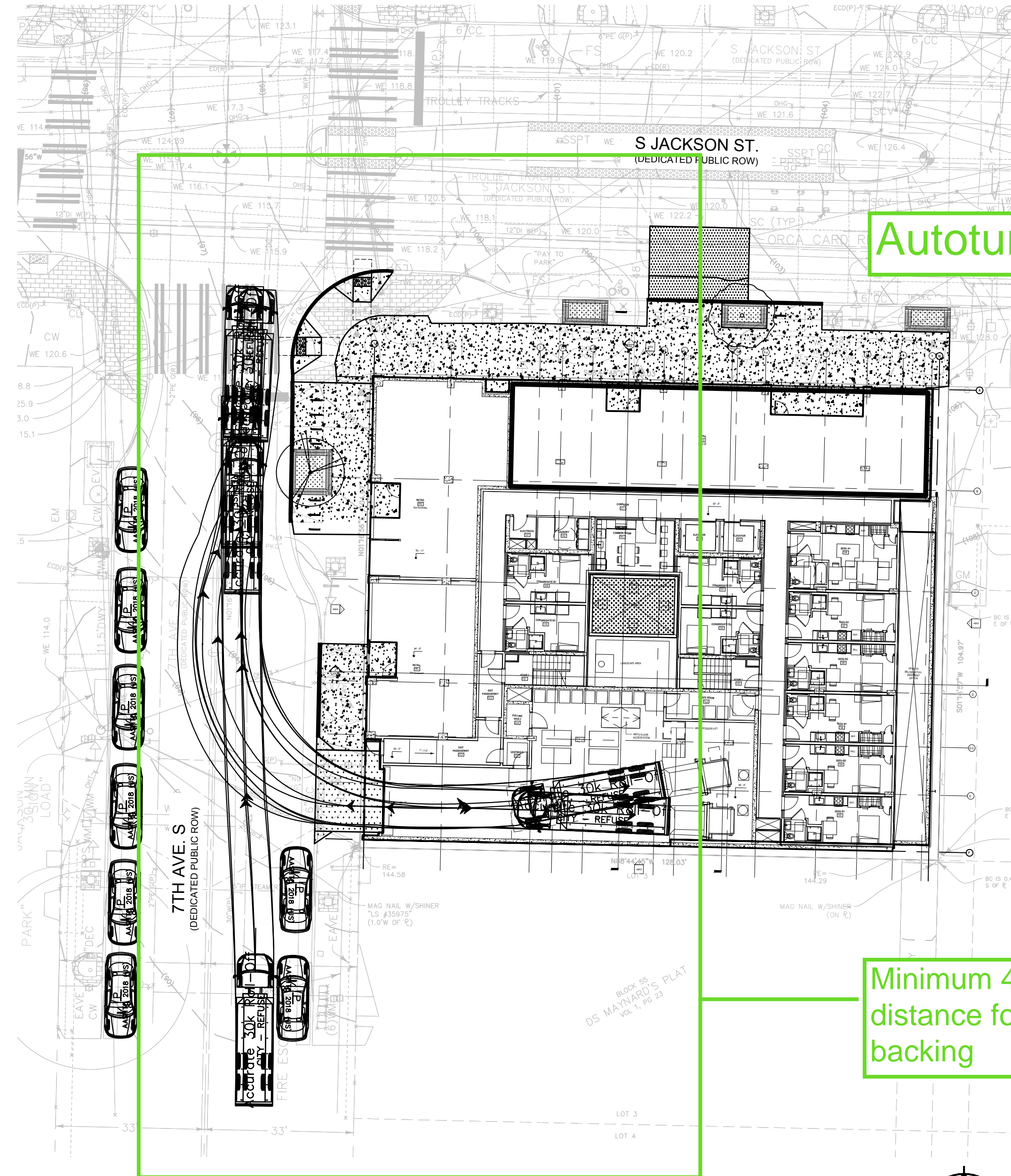

Autoturn analysis overlaid on site plans

Minimum 45'
distance for
backing

TRUCK TURNING MOVEMENTS - SOUTH DUMPSTER

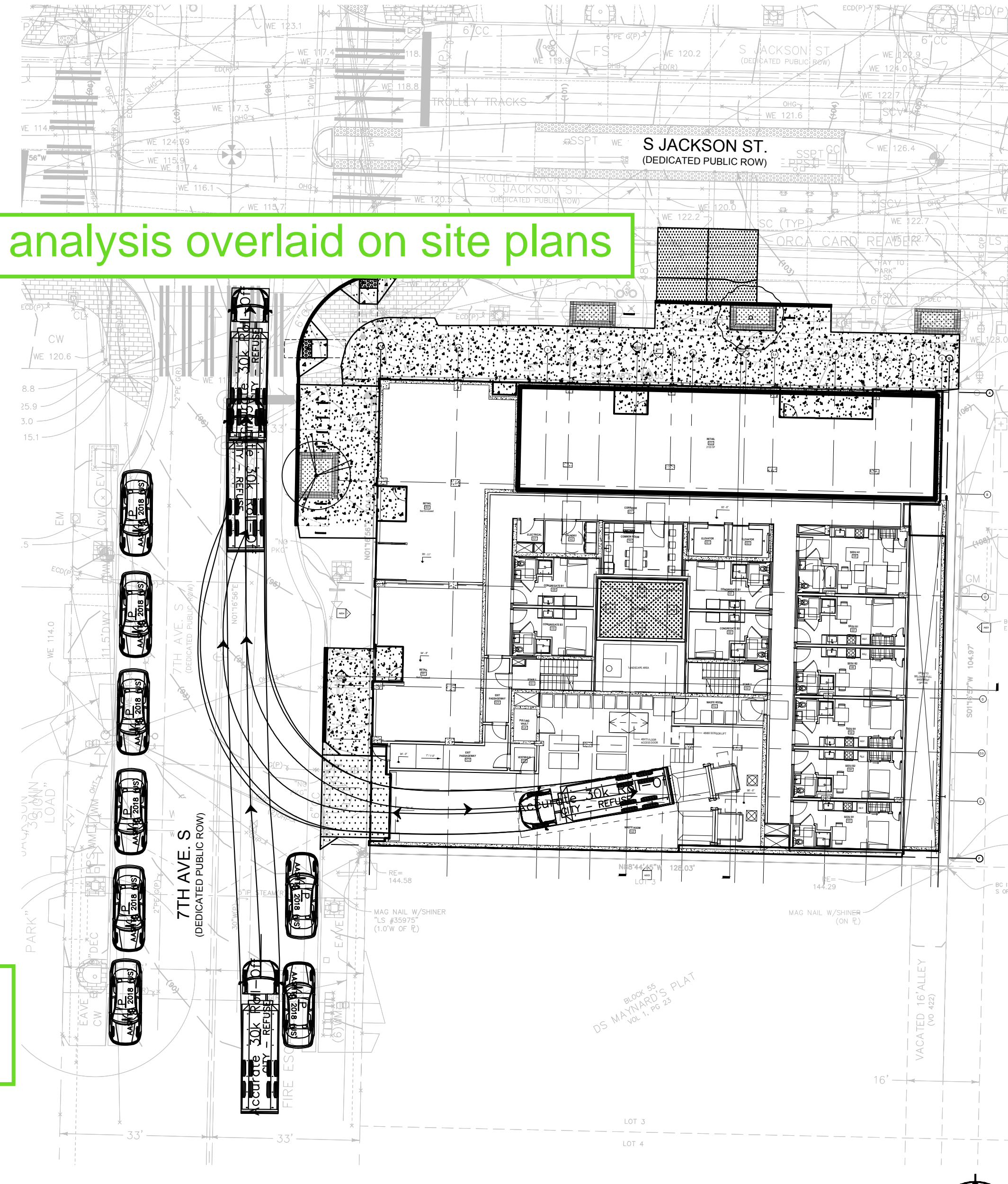
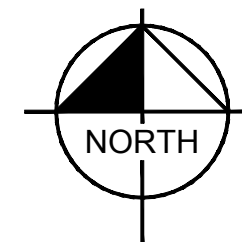
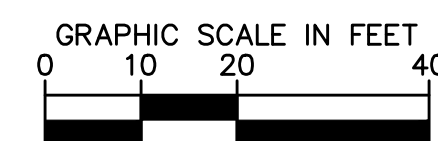

TRUCK TURNING MOVEMENTS - NORTH DUMPSTER

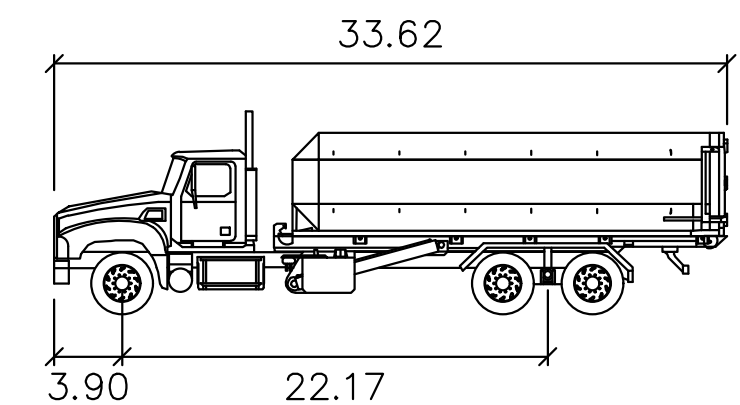
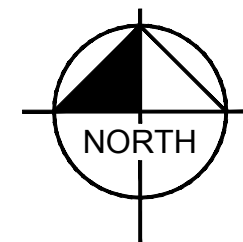
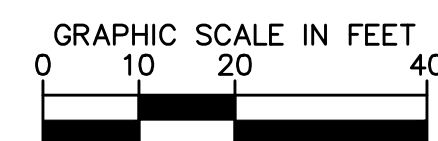

feet
Width : 8.17
Track : 8.02
Lock to Lock Time : 6.0
Steering Angle : 32.7

ROLL-OFF TRUCK PROFILE

Clearly labeled truck
dimensions

701 S JACKSON ST TRUCK TURNING MOVEMENTS

SEPTEMBER 30, 2021