

1"=5' Cross Section Public Alley 1

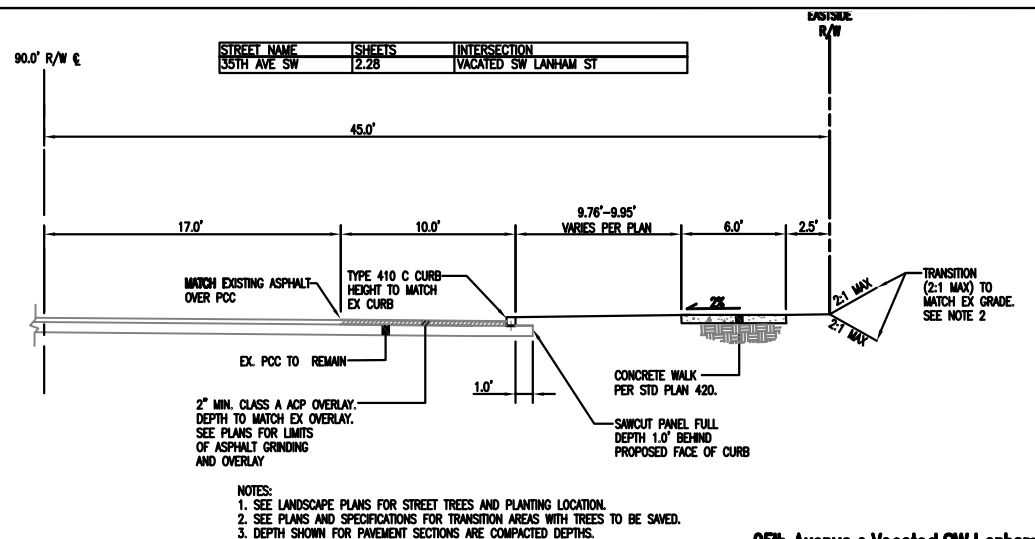

35th Avenue - Vacated SW Lanham St 2

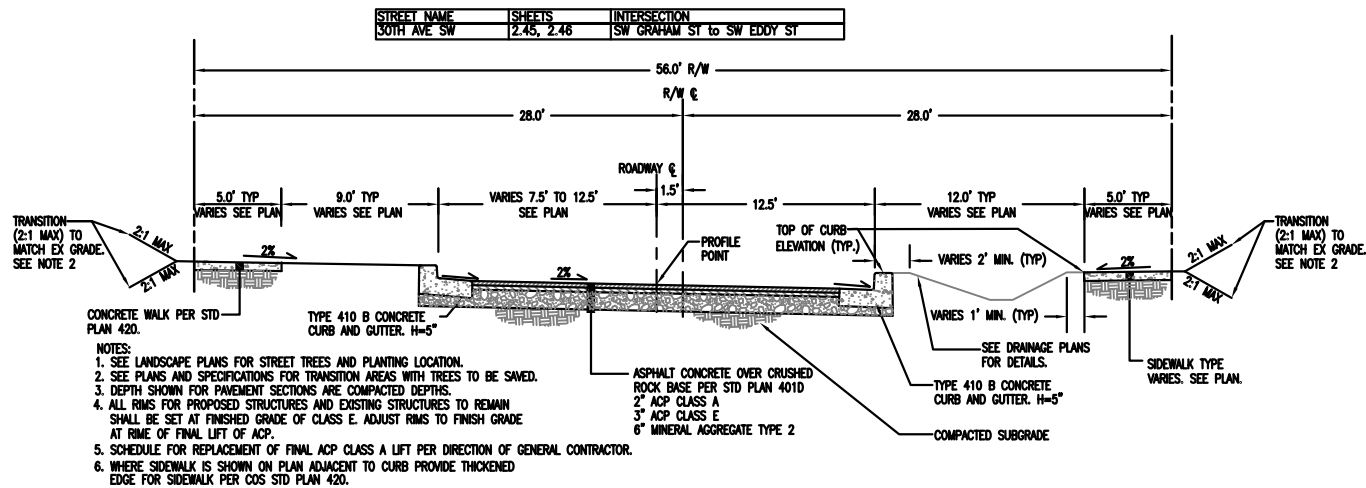

1"=5' Cross Section 25' Road, 56' Right Of Way, Swale on Right 3

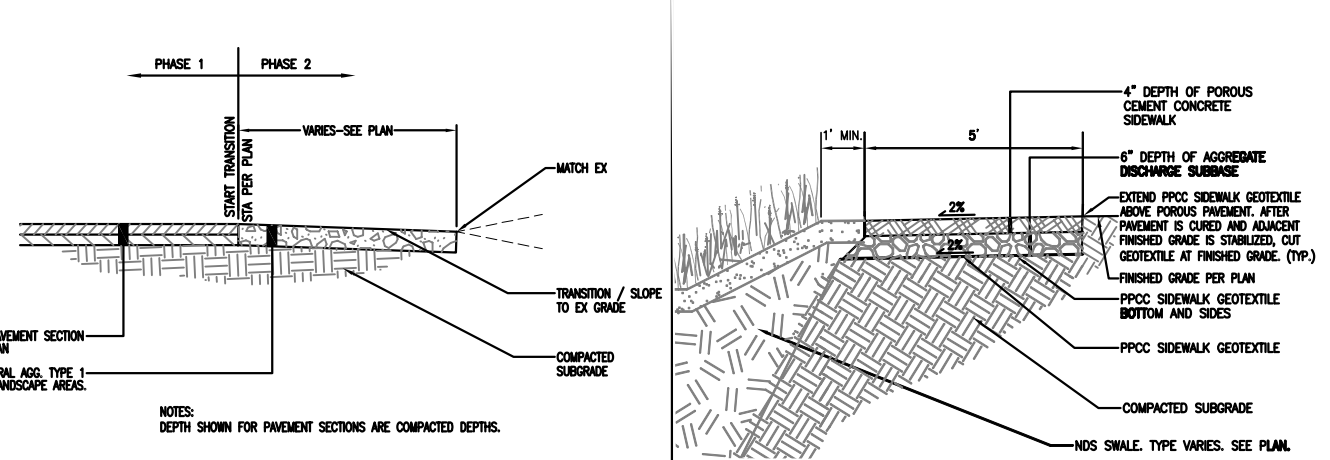

Temporary Transition Between Phase I And II In Existing Landscape Areas 4

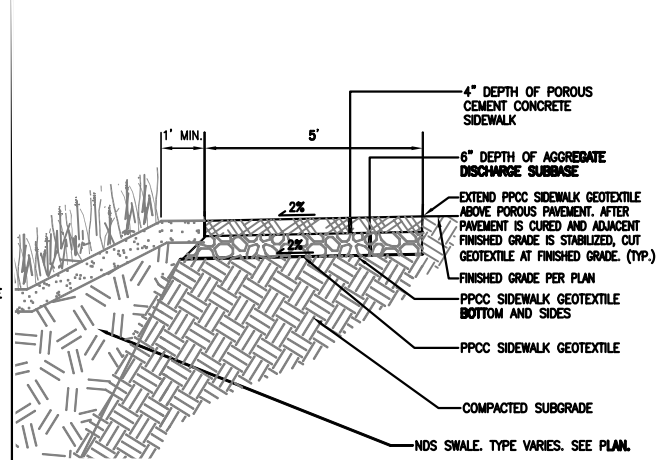

Porous Cement Concrete Sidewalk 5

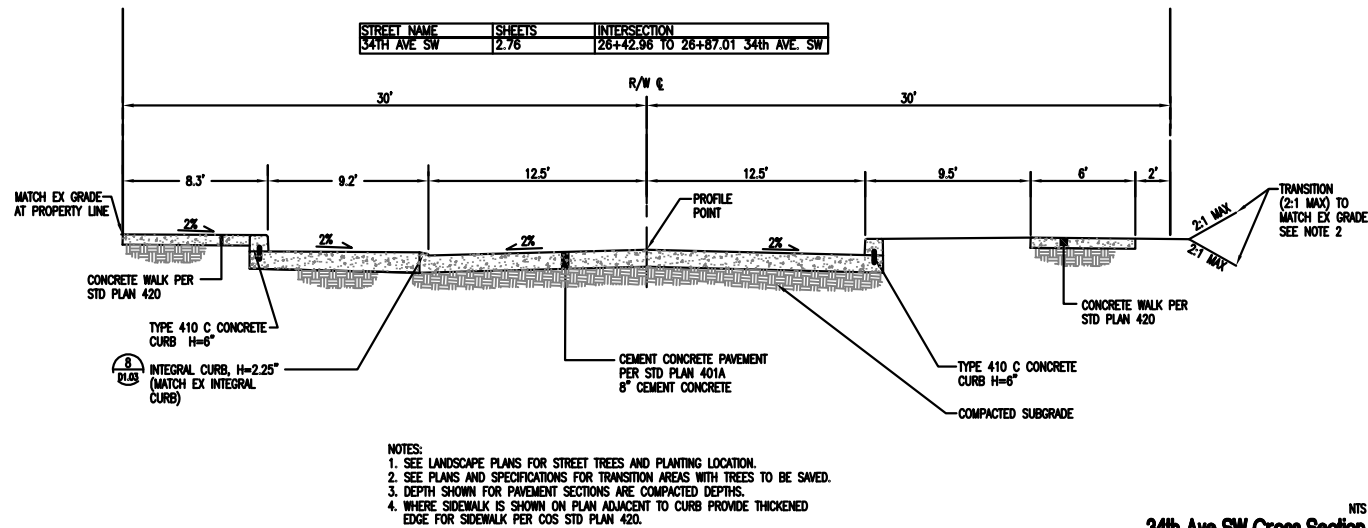

34th Ave SW Cross Section 7

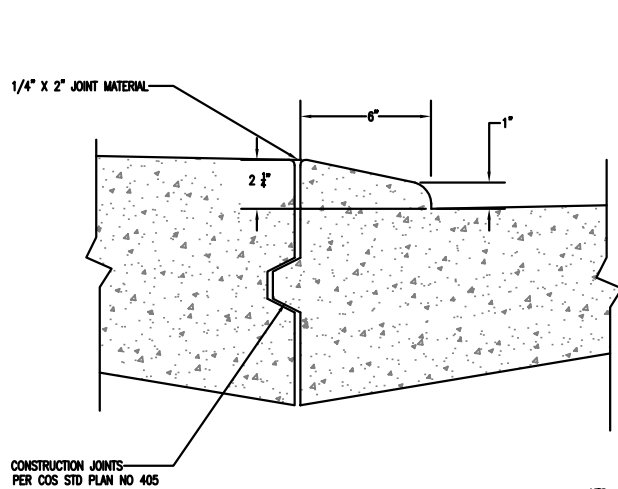

Integral Curb 8

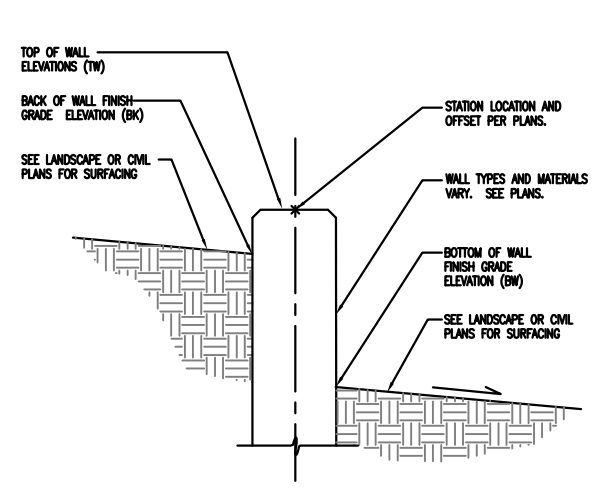

Typical Elevation At Walls 9

VULT SERIAL NO. 34285  
 DATE MARK  
 NATURE REVISIONS  
 MADE/CHKD (REV'D)

File: G:\02\1002026\Current\PC\plans\High\Detail-01.dwg ID: Anthony Date: 16-Sep-04 4:21:14pm  
 Layout:



DESIGN COMPANY  
 815 Western Ave., Suite 400  
 Seattle, WA 98104  
 Phone: 206.231.0326  
 Fax: 206.231.0725  
 WWW.SVRDESIGN.COM



REVIEWED BY SPU/WATER ENGINEERING	20.....
REVIEWED BY SPU/DRAINAGE	20.....
APPROVED BY SDOT STREET IMPROVEMENT PERMITTING	20.....

NAME OR INITIALS AND DATE	INITIALS AND DATE
DESIGNED JKG	REVIEWED:
CHECKED TYS	PLAN REVIEW ANALYST .....
DRAWN JZ_CB	PLAN REVIEW SEC. MGR .....
CHECKED JWB 18, 2004	RECEIVED:
DESIGN REVIEW	REVISED AS-BUILT.....

All work done in accordance with the City of Seattle Standard Plans and Specifications in effect on the date shown above, and supplemented by Special Provisions.

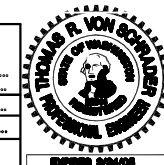

City of Seattle  
 Seattle Department  
 of Transportation  
 WORK ORDER NO. TWP0503 SPU NO. NS10188  
 PERMIT NO. X8134 APPROVED  
 SCALE: H.A. NOTED V. INSPECTOR'S BOOK

3000 SW GRAHAM ST.  
 HIGH POINT REVITALIZATION  
 SDOT PROJECT NO. T03-1748  
 DPD PERMIT NO. 737141  
 HIGH POINT DRIVE SW et al  
 WM, PSS, PSD, C/W, CONC. CURB, PAVING, ETC.  
 Street Section Details

SDOT PROJECT NO. T03-1748
Vault Plan No. 777-588
SHEET D1.03 OF

QA/QC REVIEWER