



North Downtown Mobility Action Program (NODO MAP)

Investments around North Downtown and the New Arena at Seattle Center

Presentation Overview

- NODO Mobility Action Plan finalization
 - Scope
 - Schedule
 - Funding
- Highlights on project development process:
 - Broad Street Complete Streets
 - Protected Intersection at Dexter Ave N / Thomas St
 - Seattle Center to Waterfront Greenway
- Next Steps
- Websites

NODO MAP Finalization and Execution Plan Development Oct. 2018 to Dec. 2019

- Prioritize Tier 1 projects
 - Assess how projects support guiding principals
 - Apply community input, agency support, system needs
 - Develop planning-level cost estimates for recommended projects
 - Leverage improvements by others
 - Determine schedule of projects based on anticipated new arena opening date (mid-2021) and other projects' schedules
- Refine project scope, assume project delivery method, identify team members, refine schedule and cost
- Update funding sources and partnerships to contribute to projects
- Finalization of NODO Mobility Action Plan (December 2019)

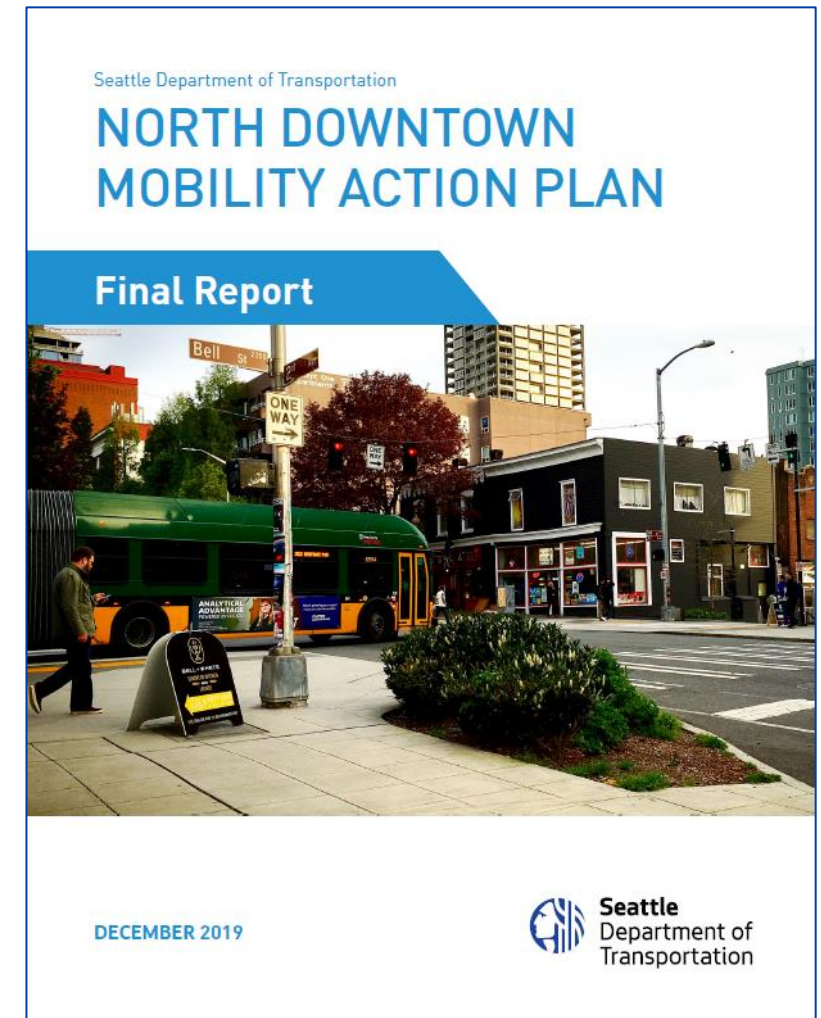

NODO MAP Priority Projects



NODO MAP Funding Assumptions

- OVG will contribute \$40 million over 39 years into a City Arena Transportation Fund → \$1,025,000 per year
- Different ways to fund projects:
 - Leveraging existing SDOT projects and use OVG fund to augment existing funds
 - Borrowing amount and then using OVG funding to service the debt over time
 - Pay-as-you-go scenario, using OVG funding to closely match work completed per year
- Anticipate \$9 million in improvements between now and 2021, and \$28 million in the first 10 years when combined with existing programs, mitigation resources and other funding sources.

NODO MAP Funding Assumptions

Project	Planning-level cost estimates ¹	Anticipated Sources
A: 1st Ave N & Queen Anne Ave N Complete Streets	\$3,870,000	CATF/OVG
B: 1st Ave & Broad St Complete Street Extension	\$1,870,000	CATF
C-East: Thomas St Greenway: Thomas/Dexter Protected Intersection	\$990,000	LCLIP
C-West: Thomas St Greenway: Seattle Center to Waterfront Neighborhood Greenway	\$2,200,000	CATF
D: Pedestrian Improvements in Belltown	\$730,000	CATF
E: Monorail Improvement Seed-funding	\$1,000,000	CATF
F: SR 99 to Waterfront Access and Mobility ^{2,3}	\$5,000,000	Port/OVG
G: Denny Way Corridor East Operational Improvements ³	\$10,080,000	SDOT/Grants/OVG
H: Harrison St Corridor Operational Improvements ³	\$2,880,000	CATF/SDOT/OVG
I: Neighborhood Programmatic Improvements	\$850,000	CATF

1. Excludes infrastructure improvements done by others

2. Anticipated date pending further coordination with the Port of Seattle

3. Operational improvements will be made along three corridors, and include updates to signal timing, vehicle detection, and fiber

NODO MAP Priority Projects

Project	Year											
	2018	2019	2020	2021	2022	2023	2024	2025	2026	2027	2028	2029
A: 1st Ave N and Queen Anne Ave N Complete Streets		Planning	Design	Construction								
B: 1st Ave and Broad St Complete Street Extension into Belltown		Planning	Design	Construction								
C-East: Thomas Street Greenway: Thomas/Dexter Protected Intersection		Planning	Design	Construction								
C-West: Thomas Street Neighborhood Greenway: Seattle Center to Waterfront		Planning	Design	Construction								
D: Pedestrian improvements in Belltown (1st Ave and Battery St signal)						Construction	Design	Seed Funding				
E: Monorail Improvements Seed-Funding			Seed Funding									
F: Denny Way Corridor Signals*	Planning	Design	Design	Construction								
G: Harrison St Corridor Signals*				Planning	Design	Construction						
H: SR 99 to Waterfront Access and Mobility (Broad St) Signals*			Planning	Design	Construction							
I: Neighborhood Programmatic Improvements				Planning	Design	Construction	Construction	Construction	Construction	Construction	Construction	Construction
			Planning	Design	Design	Construction	Construction	Seed Funding	Seed Funding			

Highlights of Project B: 1st & Broad St Complete Street Extension

- Modification of 2nd Ave PBL by OVG to allow for 2-thru lanes on 2nd Ave for arena garage flush post-event
- Leverage improvements to complete bicycle connection from 2nd and Broad to new PBL at 1st Ave N
- Challenges:
 - Freight route
 - Transit impacts
 - Signals
 - Coordination with Denny Way ITS Project
 - Operational analysis of route

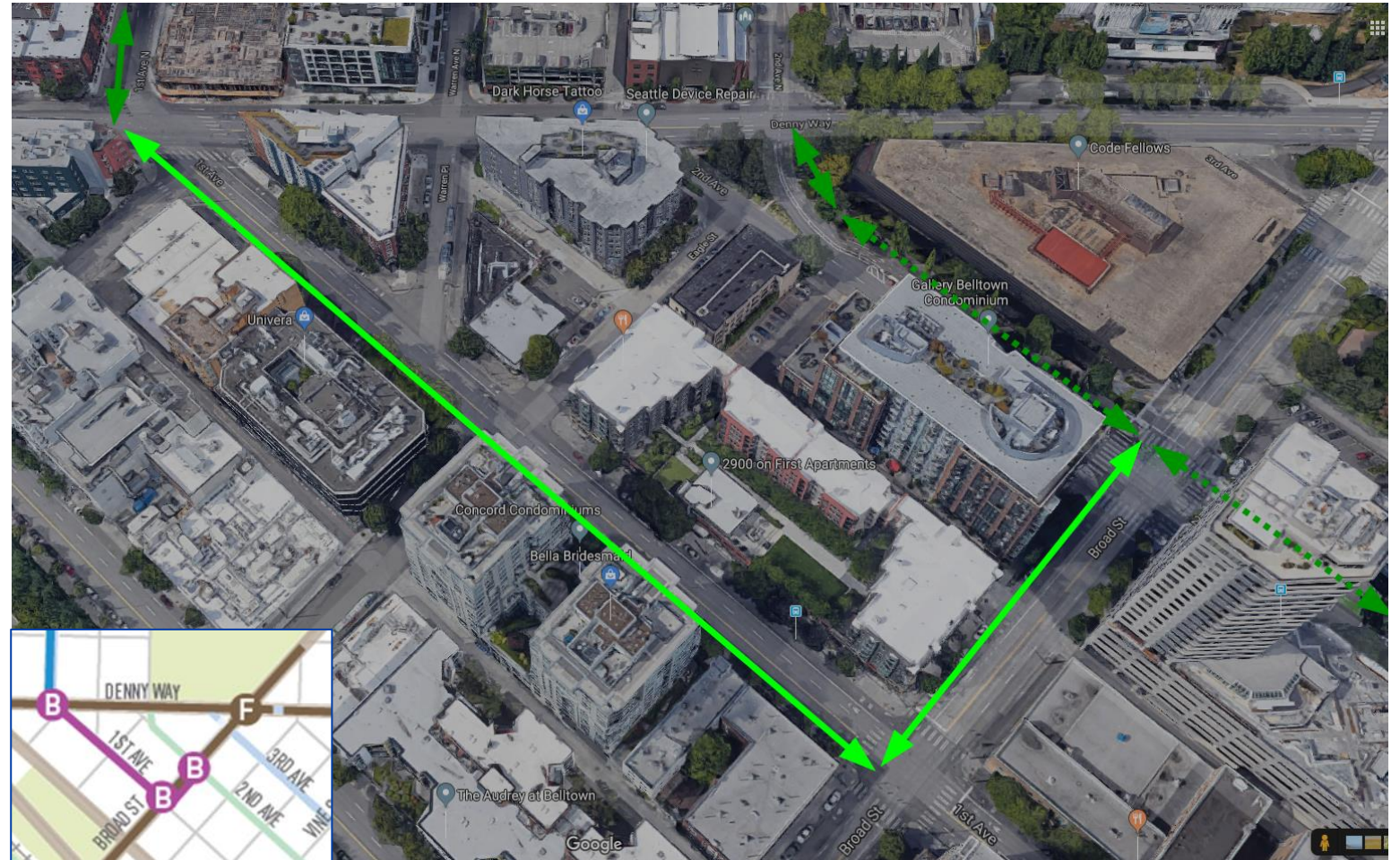

Thomas Street Redefined: 3 Key Transformative Elements

- Plaza connecting Seattle Center
 - Skate park connection
 - Half Block closure 5th to alley
- North Promenade Cross-Section
 - 36' pedestrian and bicycle promenade
 - Multi-use pathway, sidewalk and landscaping
 - 18' roadway
- Dexter Ave Protected Intersection
 - Bike facility connection
 - Transit connection

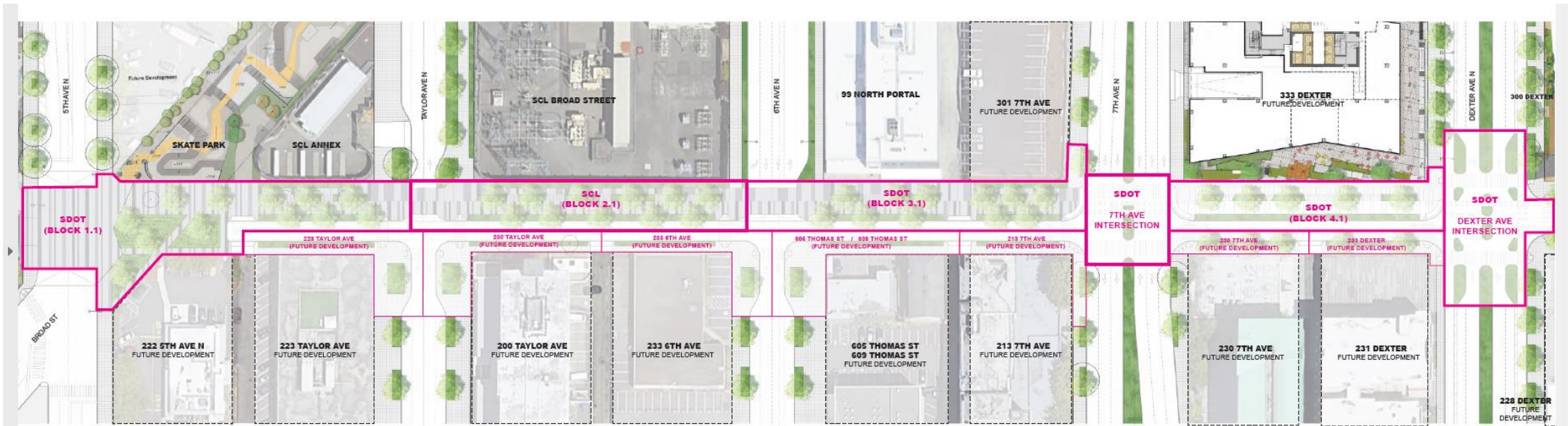

Highlights of Project C-East: Dexter/Thomas Protected Intersection

- Leverage the reconstruction of Thomas St across 7th Ave to facilitate east-west pedestrian and bicycle travel between South Lake Union and Uptown.
- Associated with Thomas Street Redefined
- Challenges:
 - Active development in intersection
 - Coordination with WSDOT construction, SCL design, private development
 - Interim/early, permanent improvements



Highlights of Project C-West: Seattle Center to Waterfront NGW

- Improve and highlight the route people use to walk and bike between the central waterfront and Seattle Center via the Thomas Street overpass
- Leverage improvements by OVG at 1st /Thomas and QA/Thomas
- Coordinate with Thomas Street Redefined – concept plan
- Advance baseline design schedule with intent to meet arena opening date

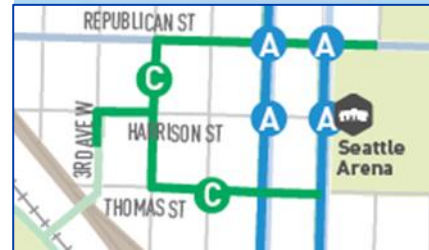

Highlights of Project C-West: Seattle Center to Waterfront NGW

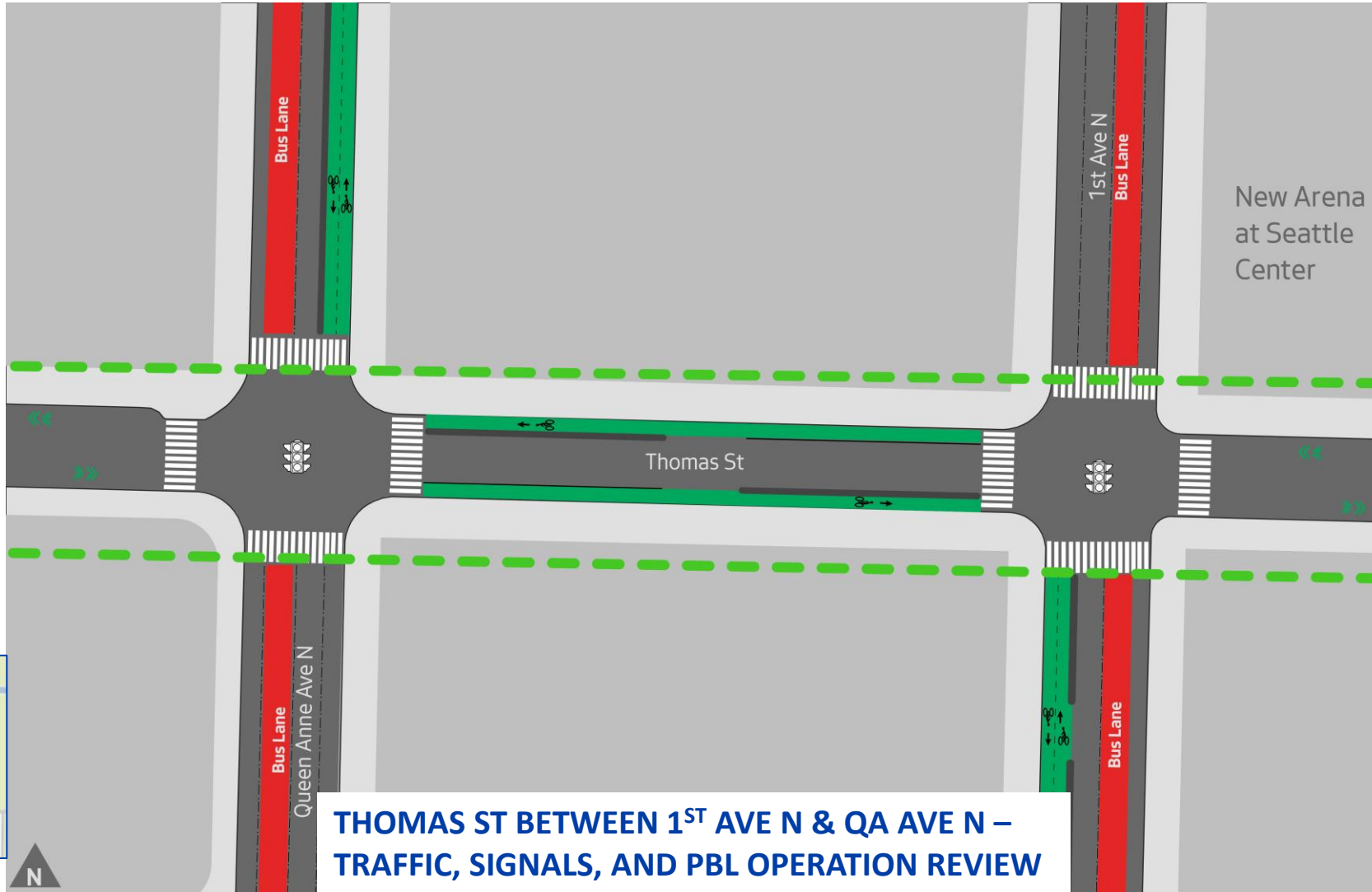

Highlights of Project C-West: Seattle Center to Waterfront NGW

- Collect existing speed and volume count
- Review existing locations of all-way stops
- Determine warrants for proposed all-way stops
- SDOT is also reviewing for all-way stops in between Denny Way and Mercer St, from Elliott Ave W to Seattle Center



Highlights of Project C-West: Seattle Center to Waterfront NGW



REVIEWING OPTIONS FOR EASIER ACCESS ON AND OFF THOMAS ST OVERPASS

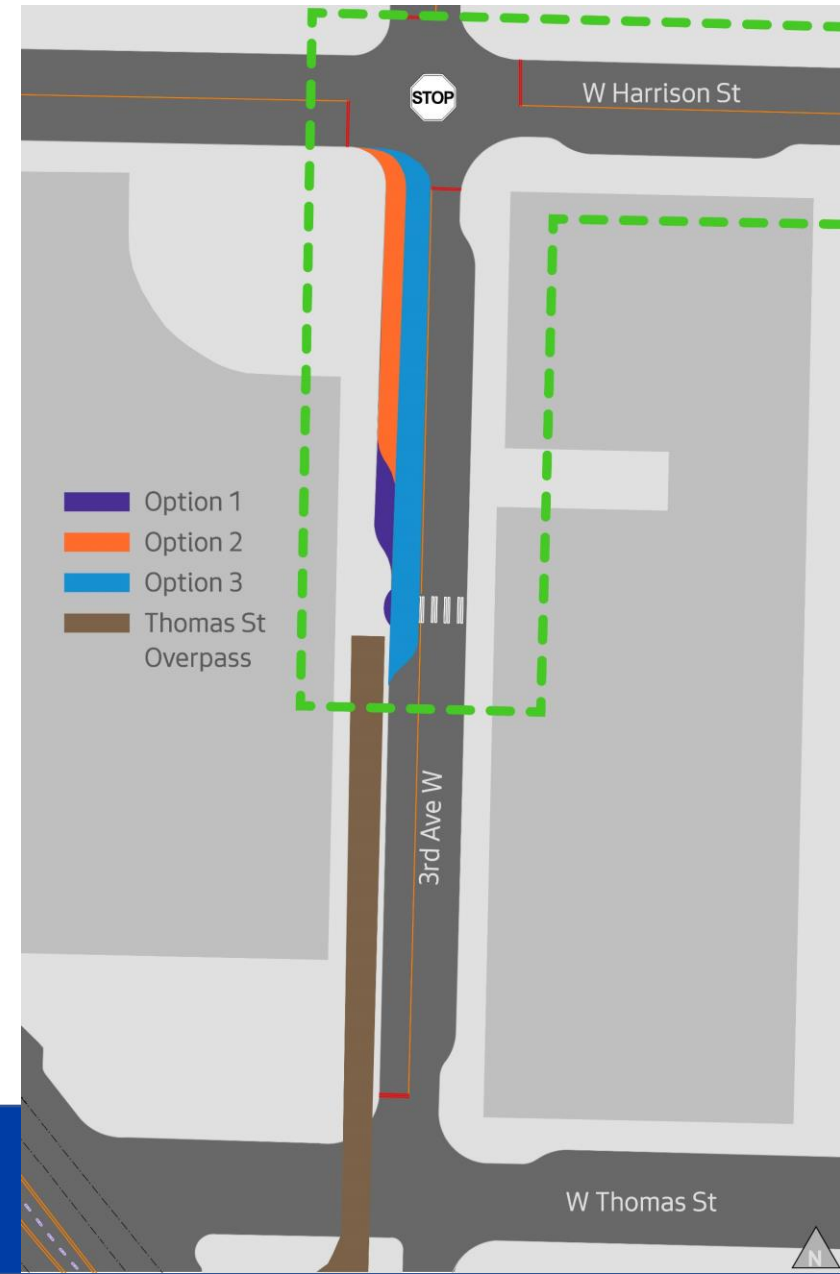

Next Steps

Action Item	
Continue stakeholder engagement	Ongoing
Complete Thomas St Redefined Concept Plan from Elliott to Eastlake	Q1 2020
Construct Interim Changes <ul style="list-style-type: none"> • 5th Ave N & Thomas St – Half Block Closure • Dexter Ave N & Thomas St – Right In/Right Out Diverter 	Q1 2020
Advance Thomas St Redefined Design concepts at: <ul style="list-style-type: none"> • 5th Ave N to Taylor Ave N along Thomas • 6th Ave N to 7th Ave N along Thomas (adapt WSDOT work on northern block face) • Dexter to Terry 	Design 2020
Advance design of Dexter & Thomas Protected Intersection	Construction 2021
Advance design of Seattle Center to Waterfront Neighborhood Greenway	Construction 2021
Advance design of Broad Street Complete Streets	Construction 2021

Websites

- **NODO MAP**

- <https://www.seattle.gov/transportation/NODOMAP>

- **Thomas Street Redefined**

- <https://www.seattle.gov/transportation/projects-and-programs/programs/urban-design-program/street-design-concept-plans/thomas-street-redefined>

- **Seattle Center to Waterfront NGW**

- <https://www.seattle.gov/transportation/projects-and-programs/programs/greenways-program/seattle-center-to-waterfront-greenway>

