



# Route 40 Transit-Plus Multimodal Corridor Project

Seattle Bicycle Advisory Board Meeting  
August 5, 2020



# Presenters



**Route 40**



**Kay Yesuwan**  
Seattle Department  
of Transportation  
Project Developer



**Jeff Sangillo**  
CDM Smith  
Transportation  
Planner

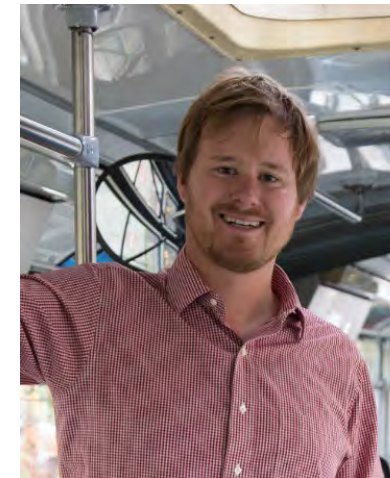

**Mike Bjork**  
CDM Smith  
Transportation  
Planner

# Agenda

1. Route 40 Background
2. Project Objective & Scope
3. What we heard to date
4. Concepts Ideas, request for SBAB input
5. Current Schedule & Funding
6. Next Steps



Route 40





**Route 40**



# 1 Route 40 Background

# Route 40 Introduction



## Route 40

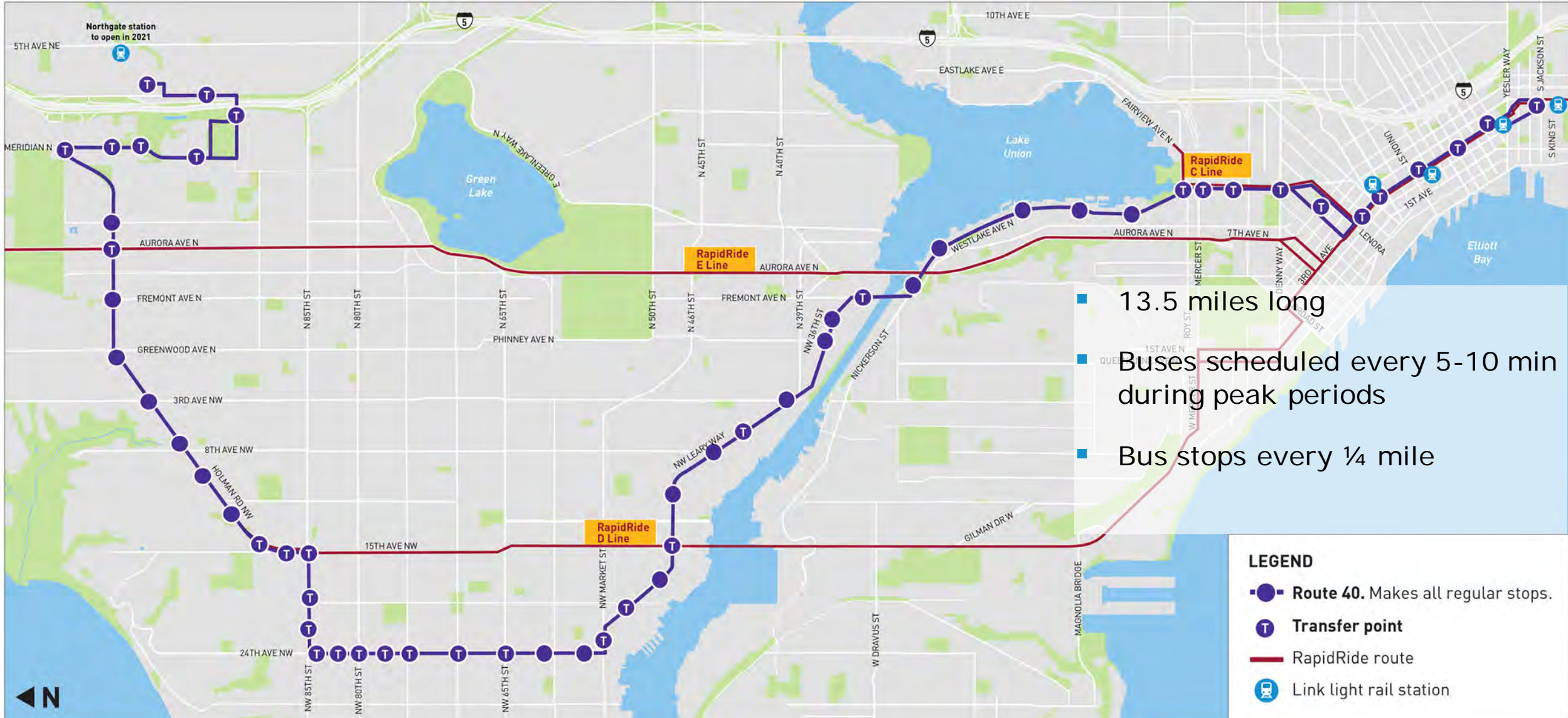

- 13.5 miles long
- Buses scheduled every 5-10 min during peak periods
- Bus stops every ¼ mile

**LEGEND**

- **Route 40.** Makes all regular stops.
- T **Transfer point**
- RapidRide route
- Ⓛ Link light rail station



**Route 40**



## 2 Project Objective & Scope



# Route 40 Transit Plus-Multimodal Corridor Project Objectives



Route 40



- Make bus trips faster and more reliable, now and in the future
- Make it safer and easier to get to and on the bus
- Respond to community needs and priorities
- Fulfill Levy to Move Seattle commitments



# Route 40 TPMC Target Study Segments



Route 40

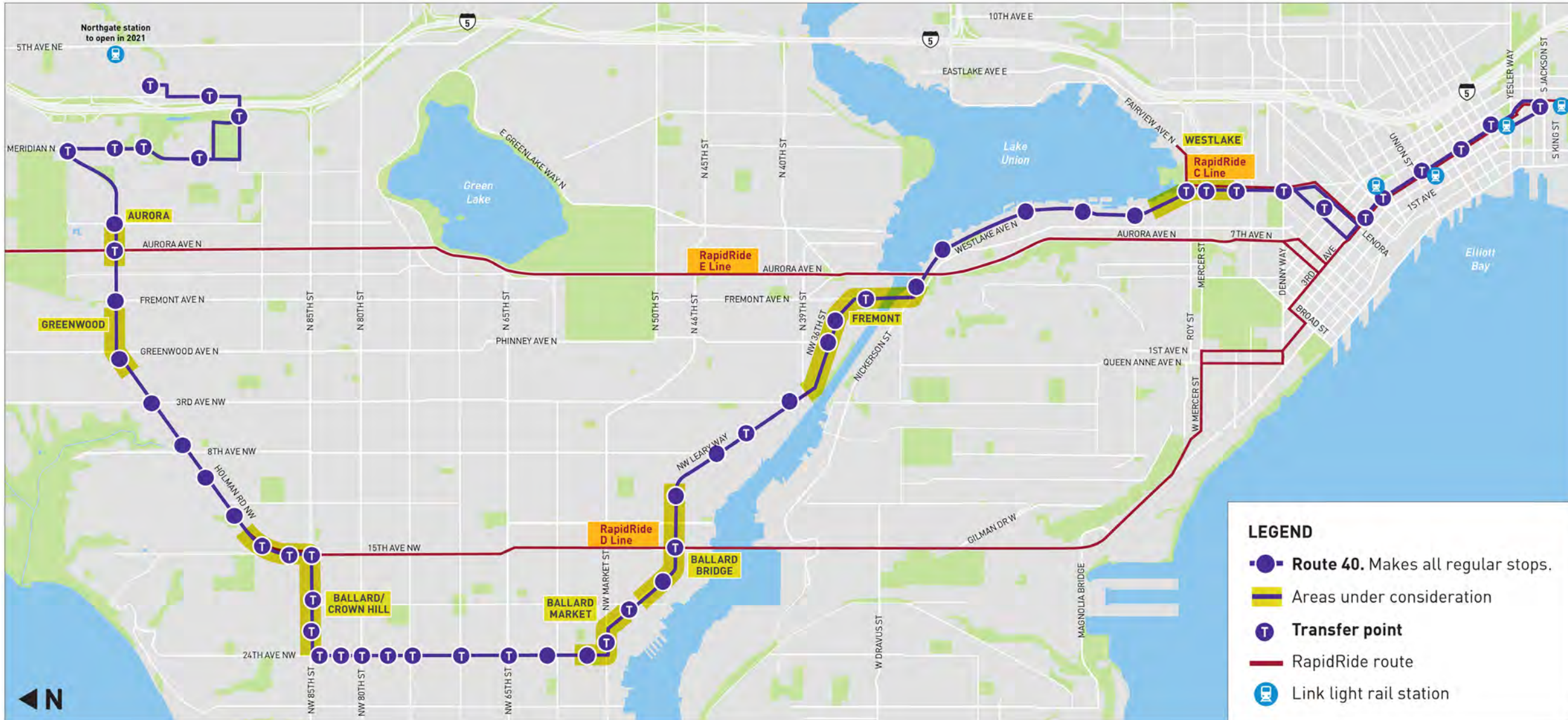





**Route 40**



### 3 What we heard to date

# Who We Heard From

- Online survey opened 2/24/2020 to 4/3/2020, received 1060 responses
- King County operator ride along and survey
- 40 attendees of 6/30/2020 virtual meeting



# What We Heard So Far



+

**Route 40**



## ROUTE 40 RIDER PRIORITIES



1. Bus speed and reliability improvements



2. Walking and bicycle accessibility improvements and new crossings



3. Keeping cars and freight moving



4. Reducing traffic speeds for safety reasons



5. Keeping parking along the route



**Route 40**



## 4 Concepts Ideas

Study Segments – Draft

Request for SBAB input

# Route 40 Concept Ideas

- Transit stops
  - Bus bulb outs
  - Stop relocation/consolidation
  - Extended bus zone
- Bus Lanes
- Roadway
  - Queue jumps
  - Turn restrictions
  - Channelization
  - Curb bulbs

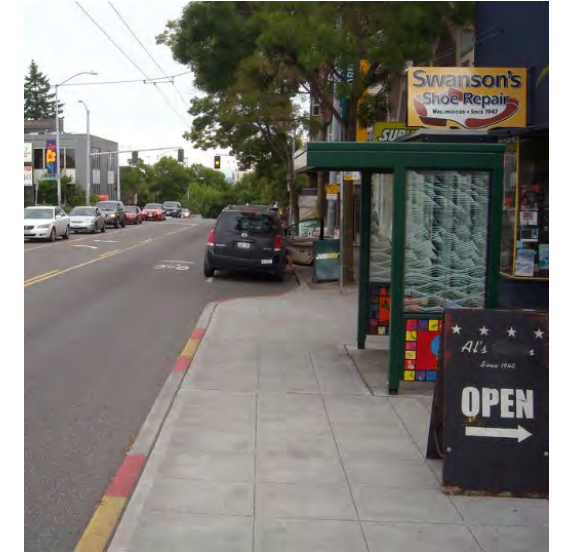





# Route 40 Concept Ideas - Walking & Biking



Route 40



## WALKING AND BIKING PROJECT IDEA RANKINGS

-  1. Improved sidewalks and crosswalks
-  2. Accessible ramps and curbs at intersections
-  3. Improved bike paths and crossings
-  4. Improved bike connections

# Westlake Segment - DRAFT

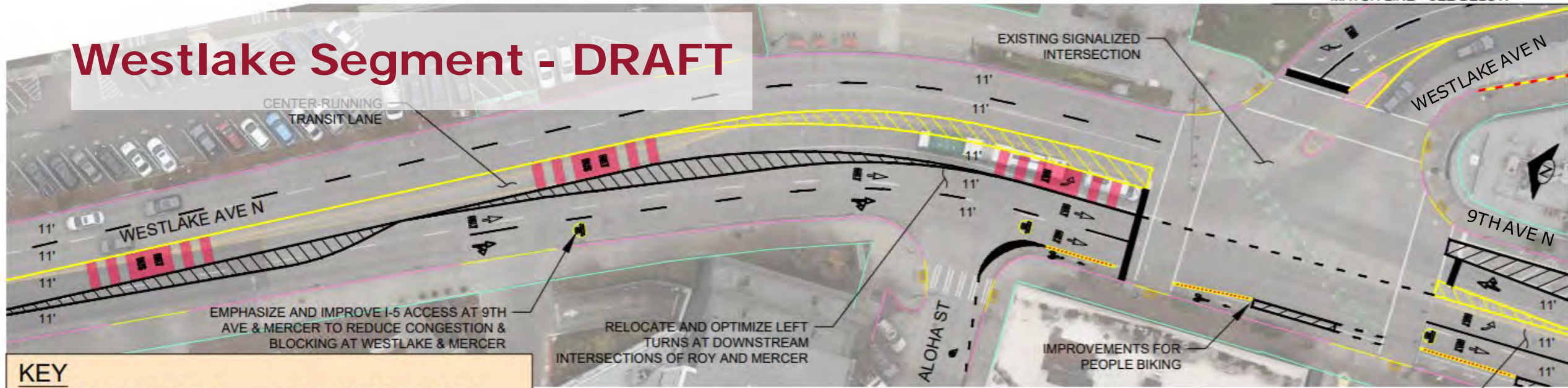

**KEY**

	EXISTING CURB		CHANNELIZATION ELEMENTS
	NEW CURB		24/7 BUS ONLY
	NEW SIDEWALK		LANDSCAPING
	BUS STOP		
	CONCRETE BUS PAD		

**NOTE: ADDITIONAL ANALYSIS REQUIRED AT 9TH & ROY AND 9TH & MERCER INTERSECTIONS**

EXPANDED LEFT TURN LANE TO MAINTAIN ACCESS NEEDS BETWEEN WESTLAKE, VALLEY, AND EASTLAKE

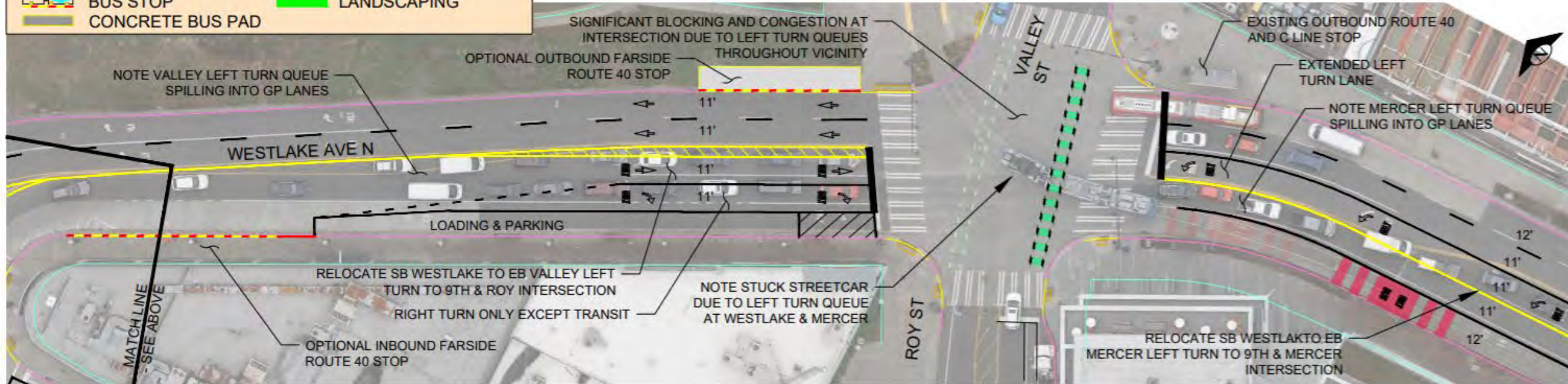

# Fremont Segment (South of Bridge) - DRAFT

KEY			
	EXISTING CURB		CHANNELIZATION ELEMENTS
	NEW CURB		24/7 BUS ONLY
	NEW SIDEWALK		LANDSCAPING
	BUS STOP		
	CONCRETE BUS PAD		

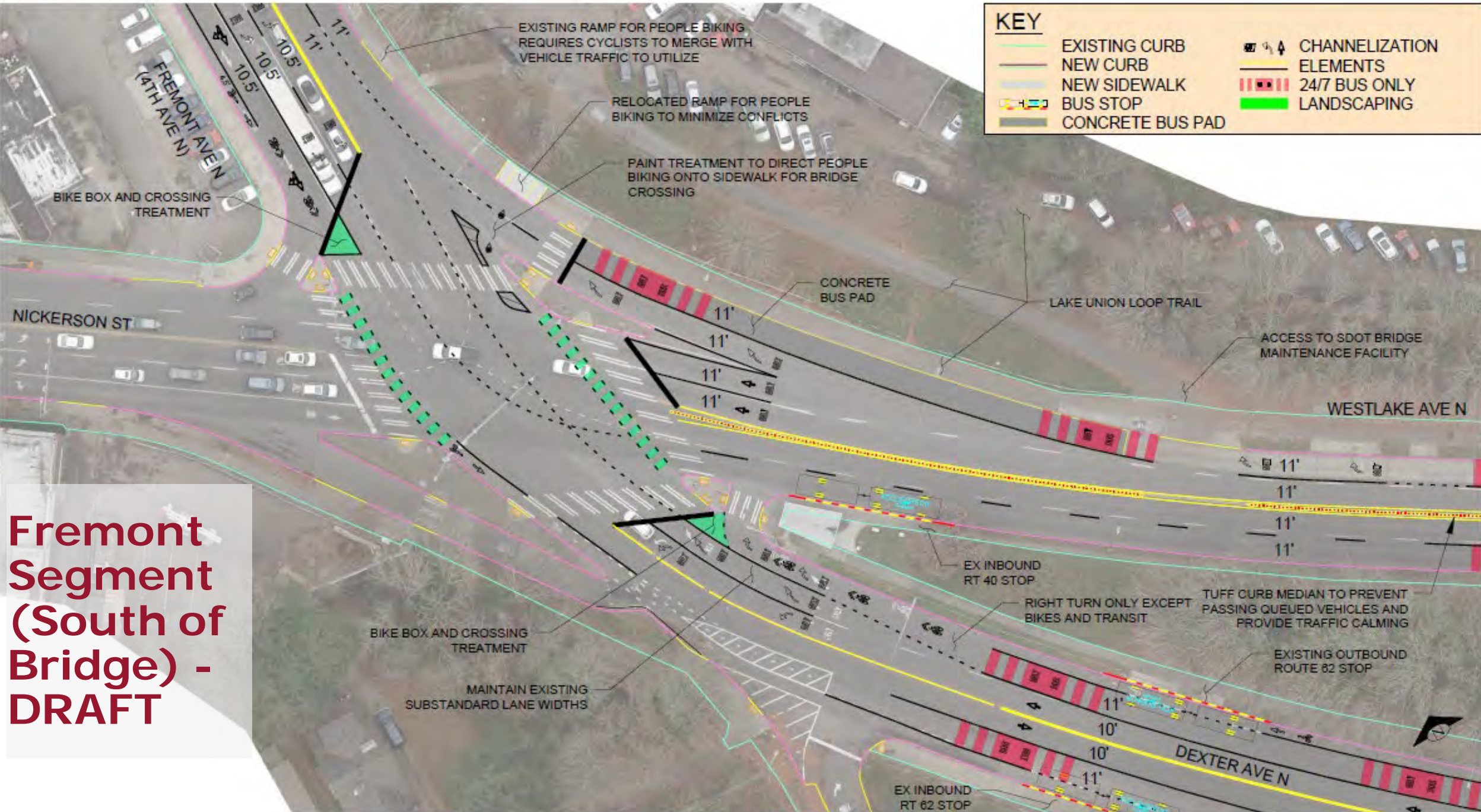



# Fremont Segment (North of Bridge) - DRAFT

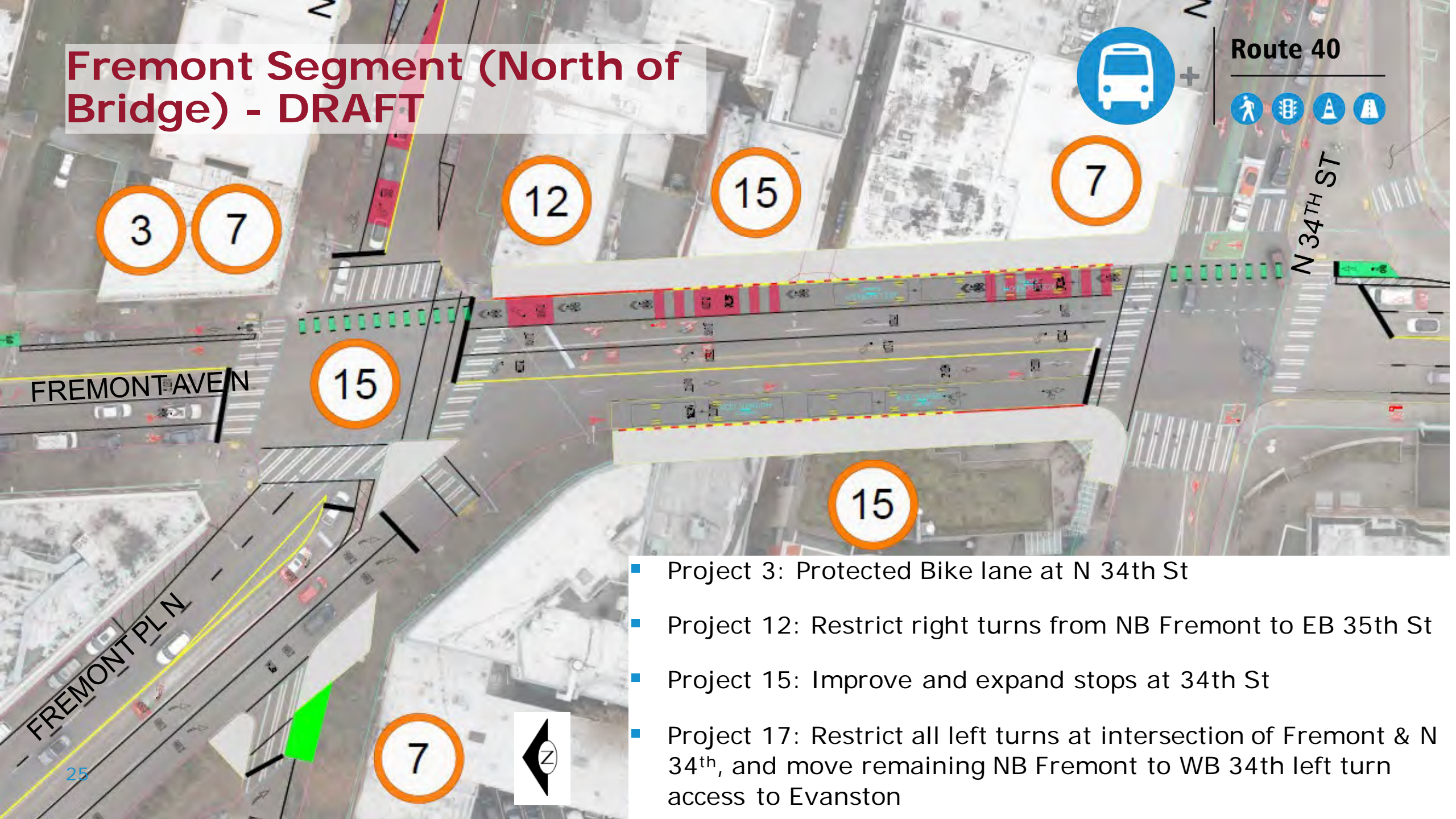

Route 40



N 34TH ST

- Project 3: Protected Bike lane at N 34th St
- Project 12: Restrict right turns from NB Fremont to EB 35th St
- Project 15: Improve and expand stops at 34th St
- Project 17: Restrict all left turns at intersection of Fremont & N 34th, and move remaining NB Fremont to WB 34th left turn access to Evanston



# Ballard/ Market Segment - DRAFT

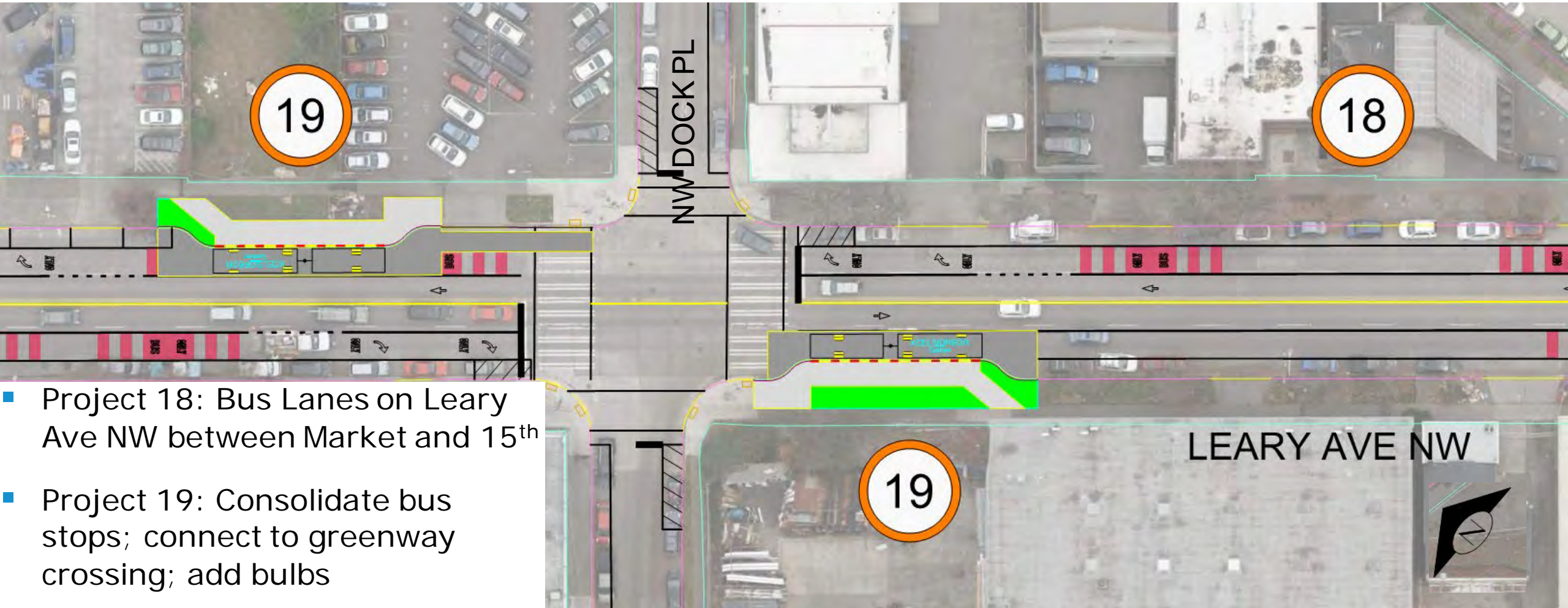

Route 40



- Project 18: Bus Lanes on Leary Ave NW between Market and 15<sup>th</sup>
- Project 19: Consolidate bus stops; connect to greenway crossing; add bulbs

KEY			
	EXISTING CURB		CHANNELIZATION ELEMENTS
	NEW CURB		24/7 BUS ONLY
	NEW SIDEWALK		LANDSCAPING
	BUS STOP		
	CONCRETE BUS PAD		

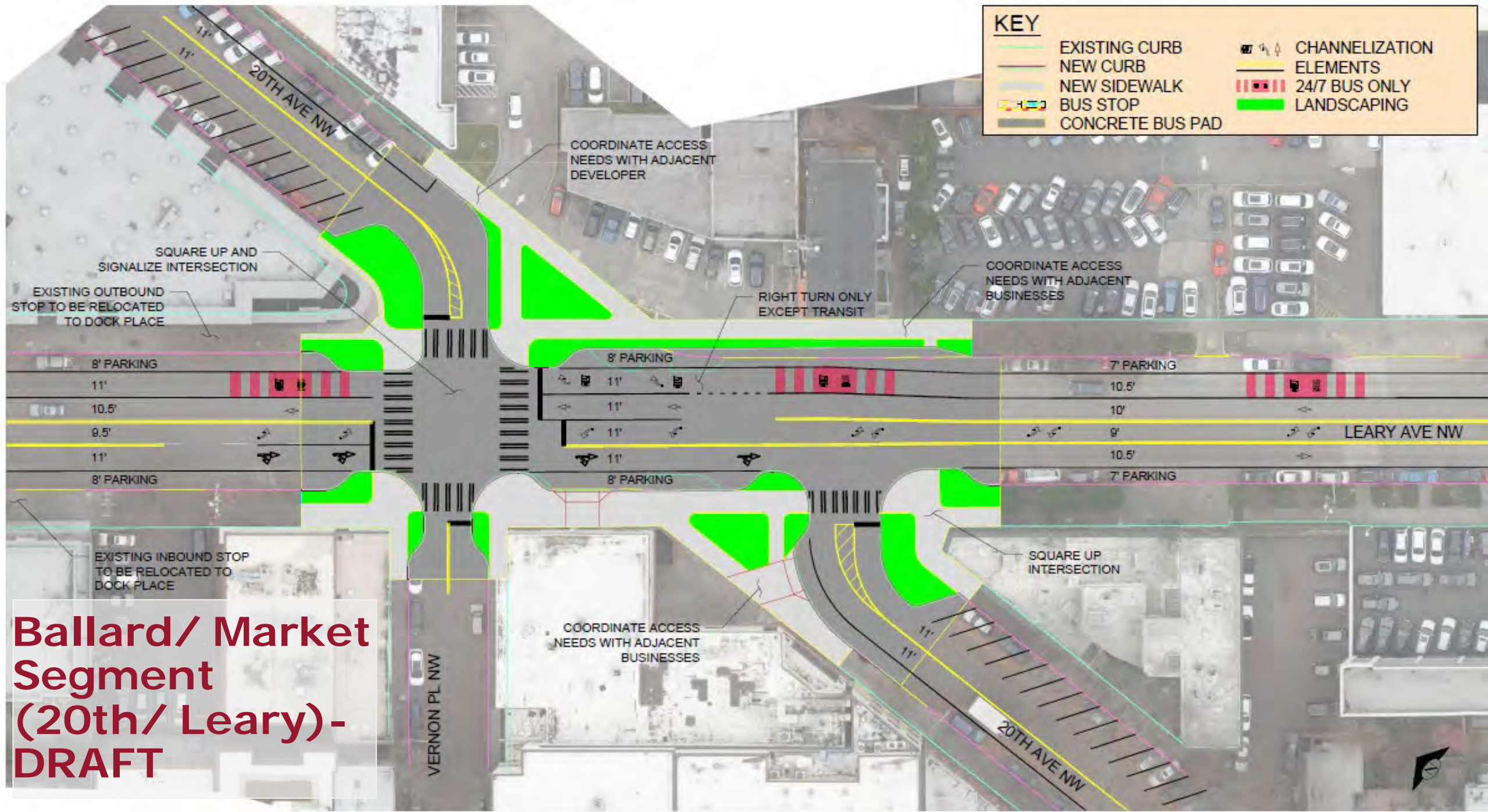









**Ballard/ Market Segment (20th/ Leary)- DRAFT**



# Ballard/ Market Segment (Market/22nd/Leary) - DRAFT

**KEY**

	EXISTING CURB		CHANNELIZATION ELEMENTS
	NEW CURB		24/7 BUS ONLY
	NEW SIDEWALK		LANDSCAPING
	BUS STOP		
	CONCRETE BUS PAD		

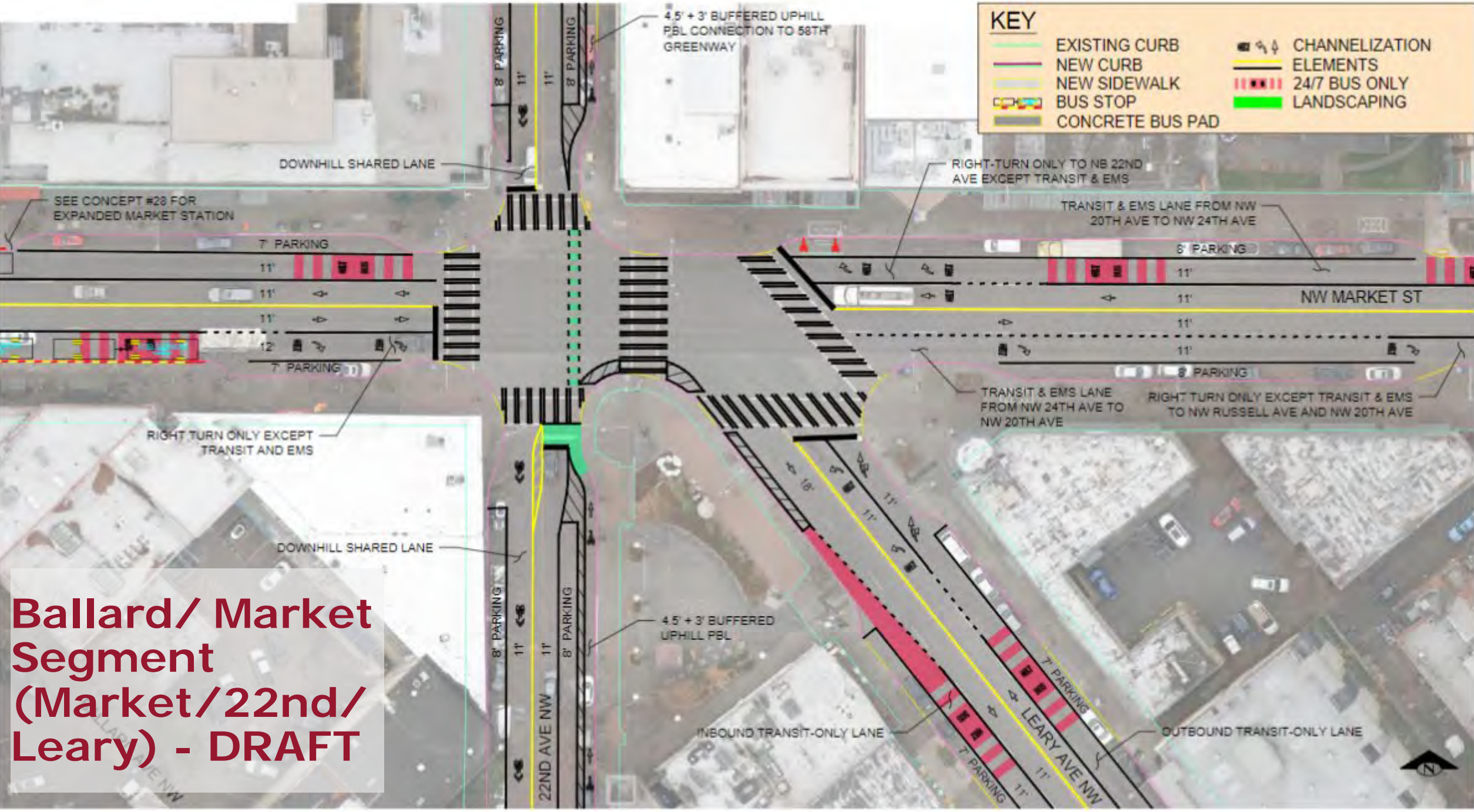



**Route 40**



## 5 Current Schedule

## Funding

# Route 40 TPMC Project Schedule



Route 40

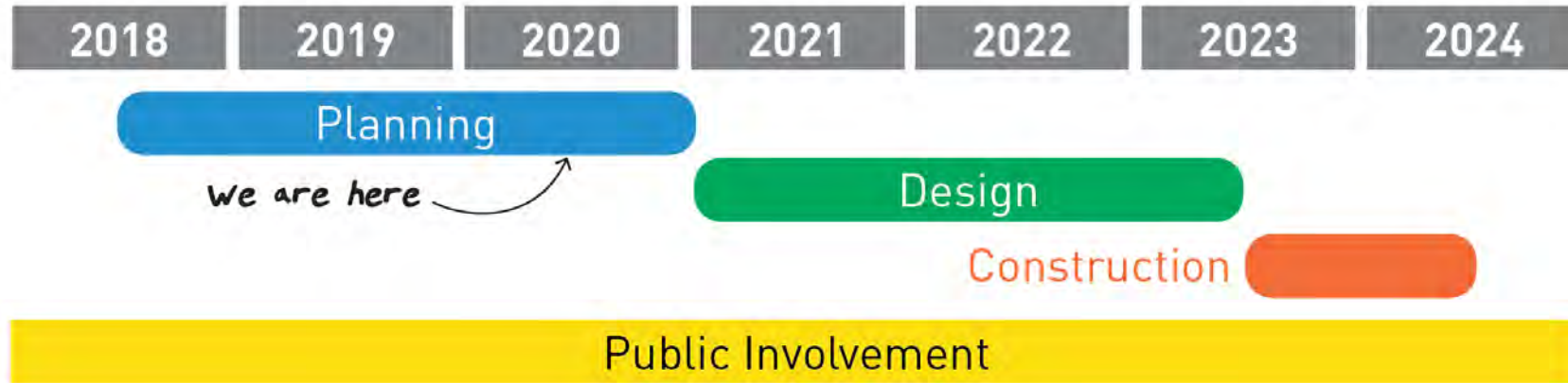

- **Planning**

**What we do:** Collect traffic and transit data, review previously completed studies, develop concepts and gather community experiences to define options.

- **Design**

**What we do:** We work with the community and produce a more detailed project design.

- **Construction**

**What we do:** We construct the project and keep the community informed on the latest construction updates, schedule, and expected impacts.

# Route 40 TPMC Project Funding



Route 40



Funding Source	Funding Amount
Move Seattle Levy	\$9.5M
Local	\$0.1M
Leverage	\$3.4M
Identified Leverage	\$10.0M
<b>Total Budget</b>	<b>\$23.0M</b>



**Route 40**



## 6 Next Steps



# Next Steps



- Use community feedback to shape draft concepts
- Perform technical evaluations of concepts, including operational review, cost estimating, and construction feasibility
- Partner agency and stakeholder coordination on revised concepts
- Advance select concepts to 30% design
- Future opportunities for input



**Route 40**



## Comments/Questions?

[Route40@seattle.gov](mailto:Route40@seattle.gov)

<http://www.seattle.gov/transportation/route40>