



FACT SHEET

HOLMAN RD NW & 13TH AVE NW NEW SIGNAL

Building projects identified and prioritized by the community

November 2017

PROJECT BACKGROUND

Crossing improvements are coming to the intersection of Holman Rd NW and 13th Ave NW. Community members concerned about the safety of students crossing at street level at this location made the request for a new traffic signal and crosswalk as part of the City's Neighborhood Street Fund (NSF) program. There are currently no signalized crossings on Holman Rd NW along the half-mile stretch between and 6th Ave NW and the top of the hill at Mary Ave NW.

In response to community input, the project design keeps the bridge and installs one crosswalk just below it. This project will improve safety, predictability, and accessibility for people walking, biking, using mobility devices, and riding transit along Holman Rd NW. Adding a street-level crossing also supports the future North Seattle Neighborhood Greenway along NW 92nd St to Whitman Middle School.

PROJECT ELEMENTS

- New pedestrian and bike signal and crosswalk on Holman Rd NW at 13th Ave NW
- Additional lighting at the bus stop on Holman Rd NW

PROJECT BENEFITS

- Enhanced safety for people crossing Holman Rd NW at street level at 13th Ave NW
- Improved accessibility for people using mobility devices, riding bikes, or pushing strollers
- Increased visibility of transit travelers

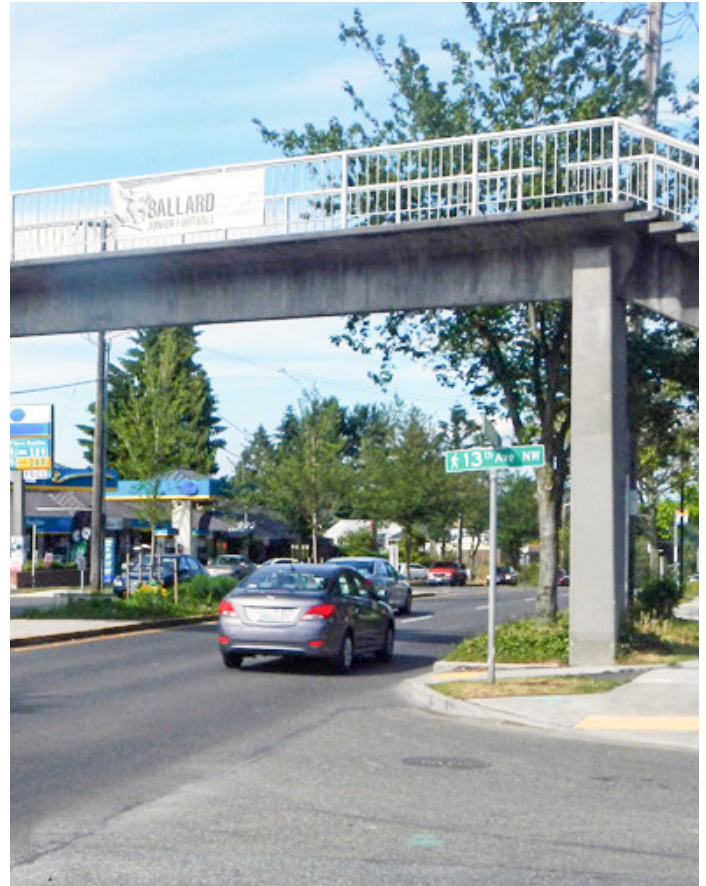

Existing conditions at Holman Rd NW and 13th Ave NW intersection

PROJECT LOCATION

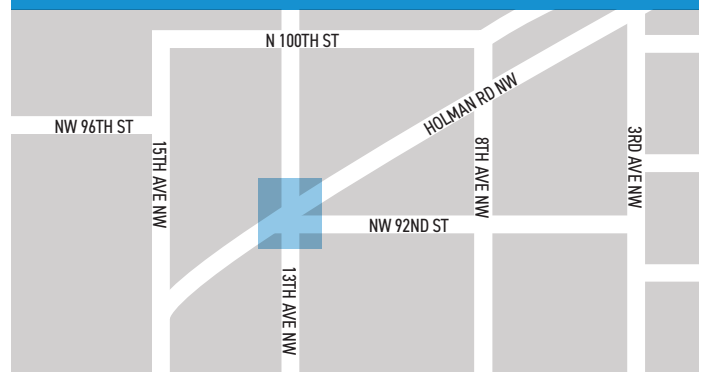

PROJECT INFORMATION AND CONTACT

www.seattle.gov/transportation/NSFHolman.htm
NSFHolman@seattle.gov | (206) 733-9361
NSF Outreach Lead: Kristin Anderson



Seattle
Department of
Transportation



PROJECT DESIGN

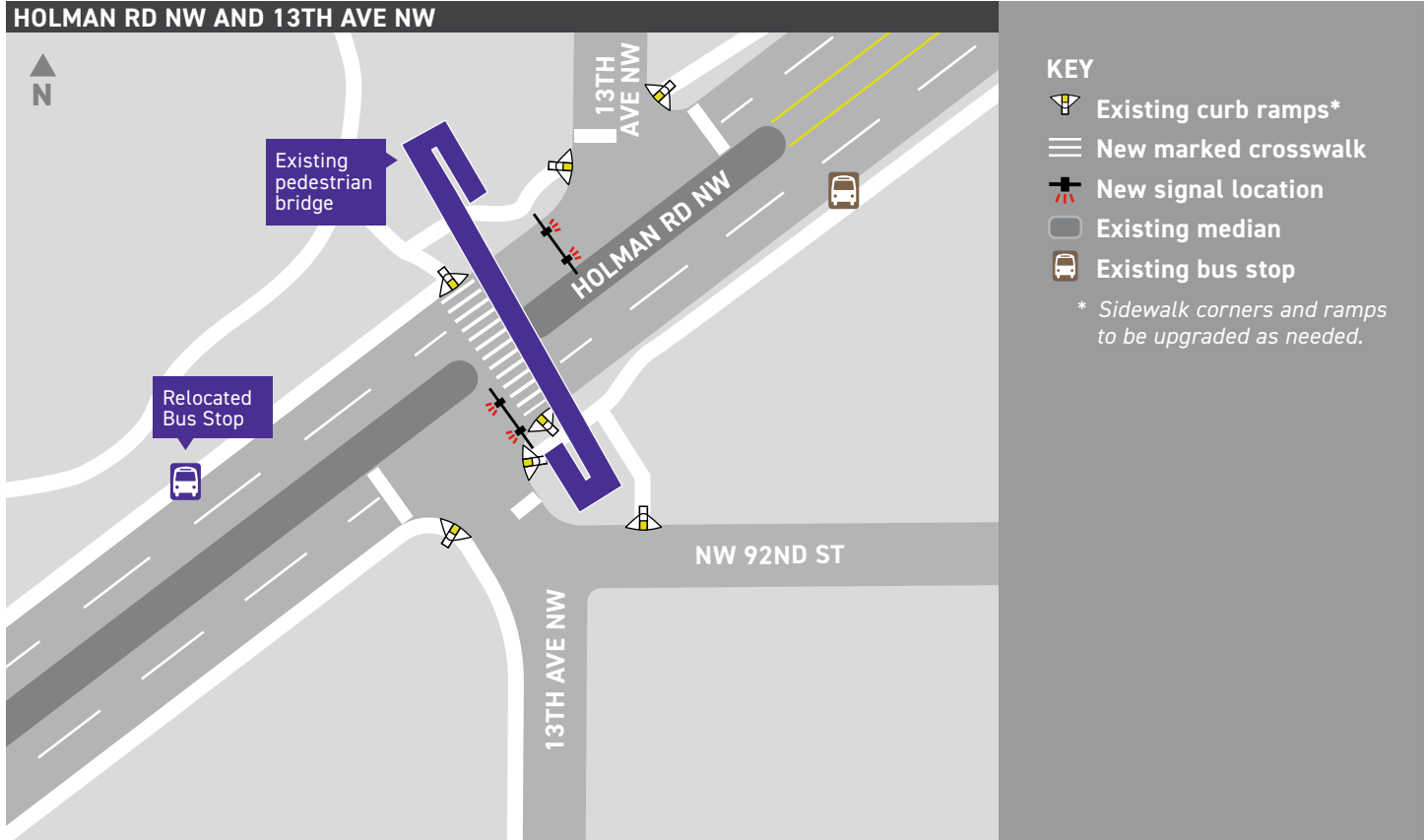

SCHEDULE

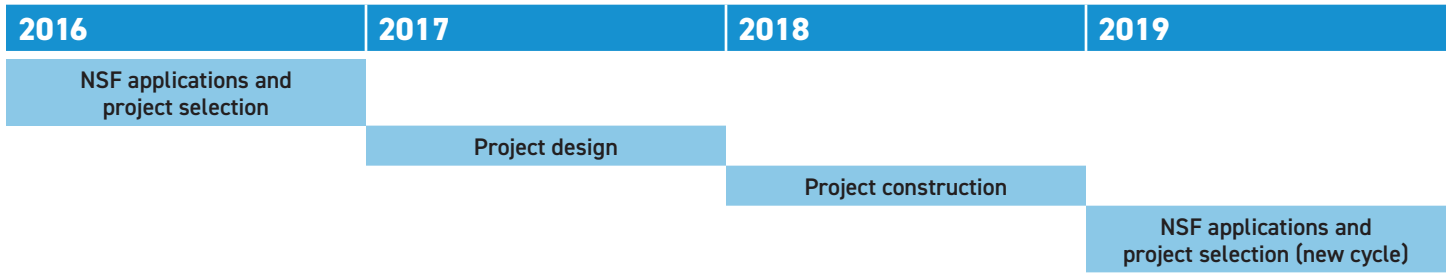

FUNDING

Funding comes from the 2015 voter-approved, 9-year Levy to Move Seattle, which will improve safety for all travelers, maintain streets and bridges, and invest in reliable, affordable travel options for a growing city. The levy includes \$24 million to continue the Neighborhood Street Fund program over the 9 years.

STAY INVOLVED!

We want to keep you up to date. Feel free to contact us and be on the lookout for final design information in early 2018 and construction information in spring 2018.

Sign up to receive email updates:
NSFHolman@seattle.gov

PROJECT INFORMATION AND CONTACT

www.seattle.gov/transportation/NSFHolman.htm
 NSFHolman@seattle.gov | (206) 733-9361
 NSF Outreach Lead: Kristin Anderson



Seattle
 Department of
 Transportation

