



130th / 125th Mobility & Safety Project *Bike Advisory Board Presentation*

October 4, 2023

Project Background and Context



Background

Sound Transit accelerated the opening of the NE 130th St Infill Station to open in **2026** rather than 2031

Sound Transit anticipates **50%** of light rail riders will arrive at the station by transit and **40%** by walking or biking



Source: Sound Transit

NE 130th Street infill station

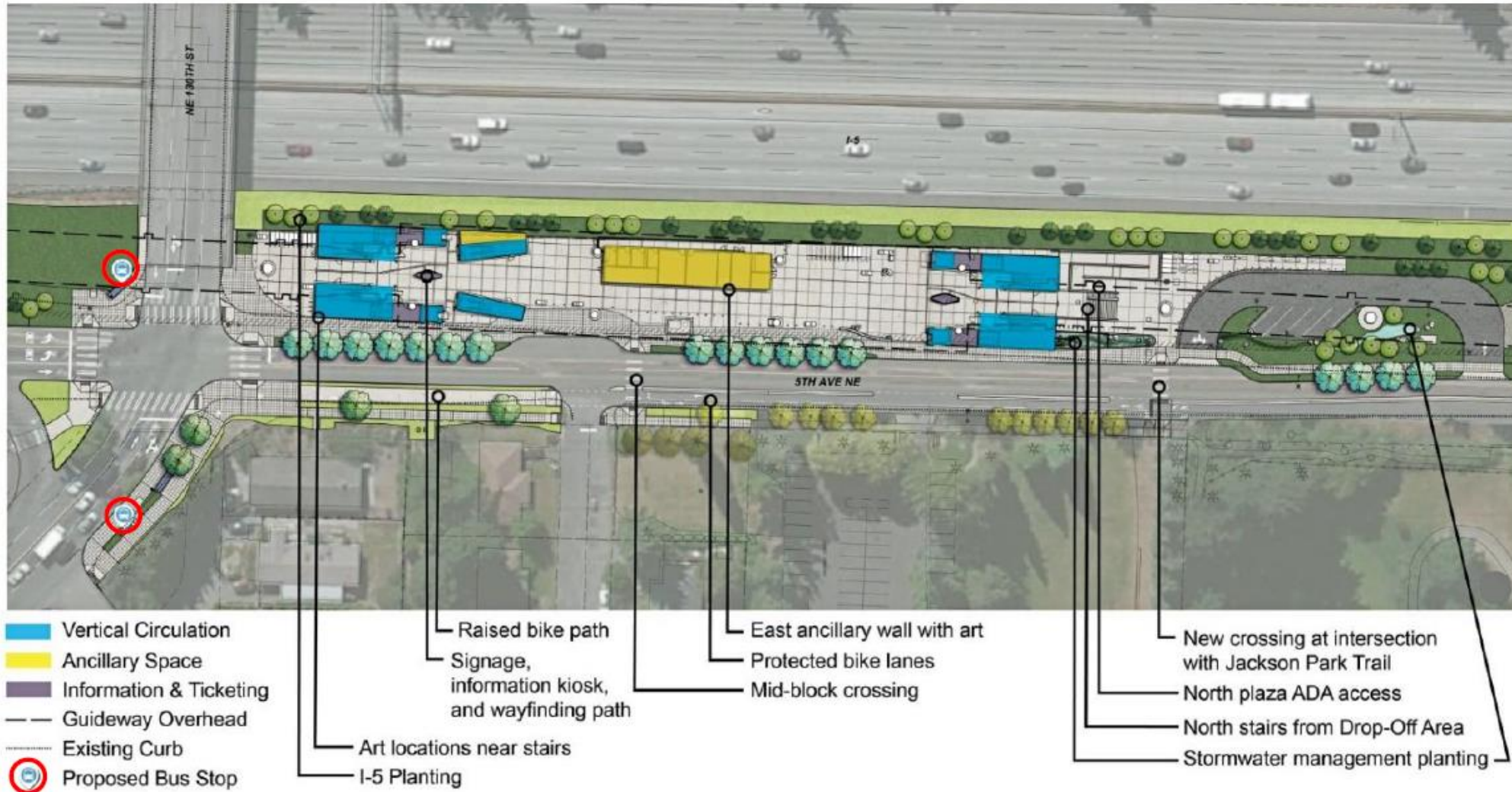

Source: Sound Transit | 90% Design presentation (Dec 2022)

Land Use

- Current zoning map with Early Action Land Use Map amendment marked in dashed red line (Passed by City Council in 2021)
- Additional zoning changes are being evaluated as part of the One Seattle Comprehensive Plan update (to be adopted in 2024)

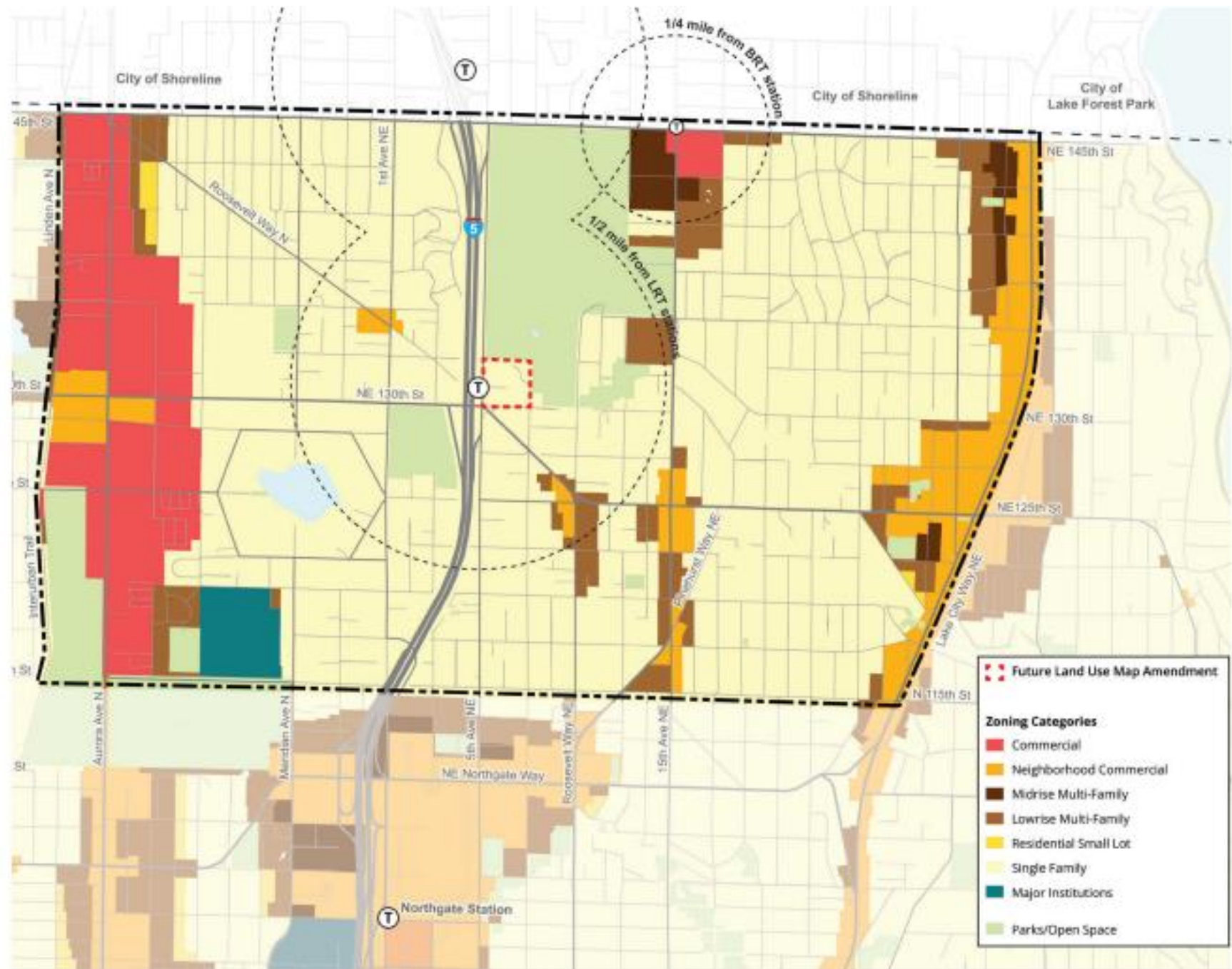

Background

- The corridor **needs improved transit, bike and pedestrian facilities** to provide safe and efficient access to the new light rail station and transit stops along the corridor.
- NE 130th/NE 125th Corridor Improvements Project **includes many of the key catalyst safety and access investments from SDOT's Multimodal Access Study** completed in 2020.

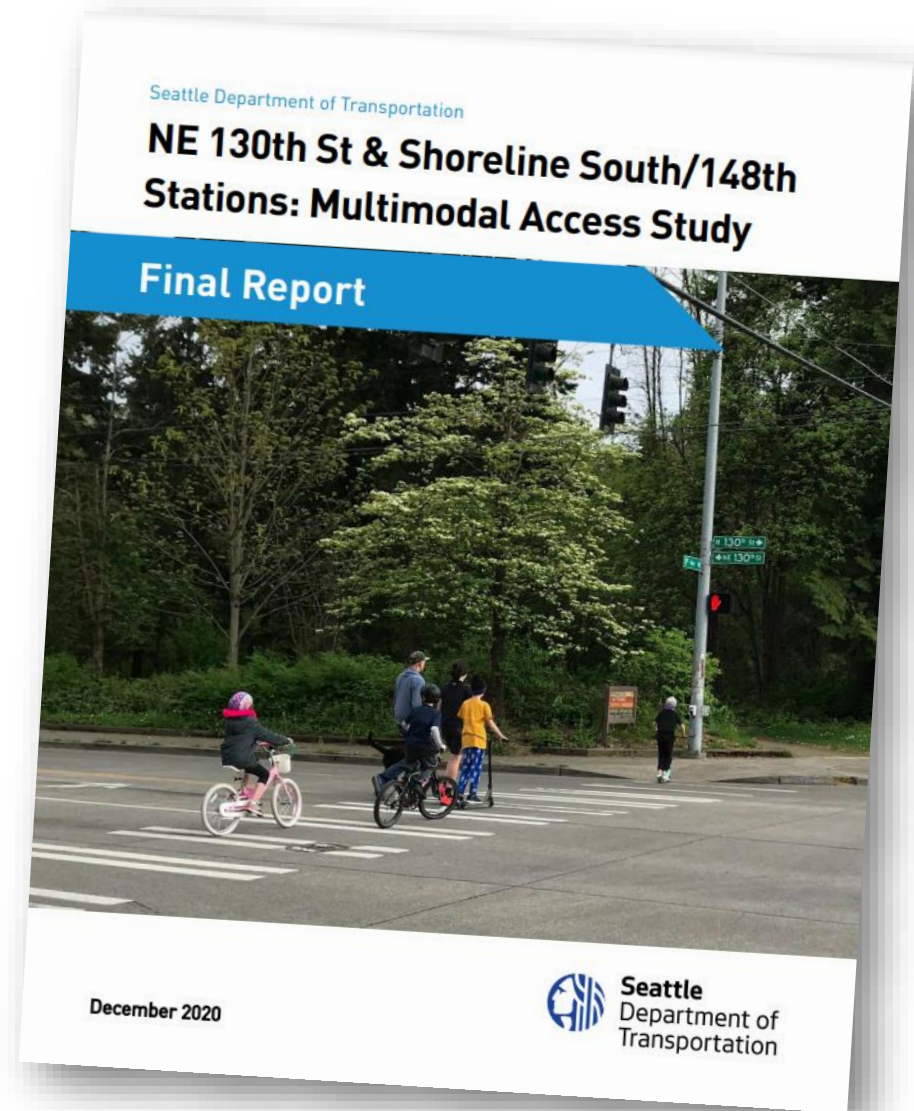

Lynwood Link Proposed Routes



Project Limits

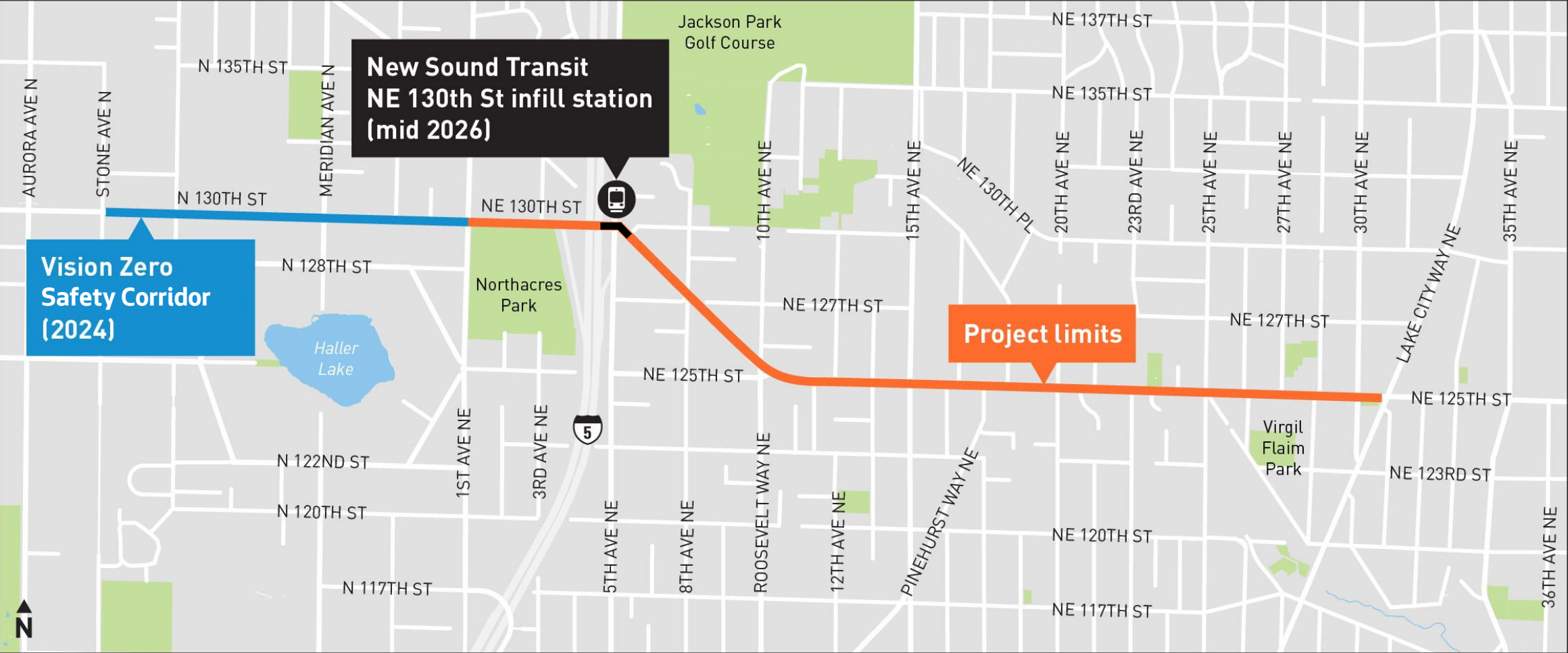

130th St: Stone Ave N to 1st Ave

Vision Zero Rechannelization

*Proposed standard cross section, certain segments will be wider/narrower based on roadway conditions

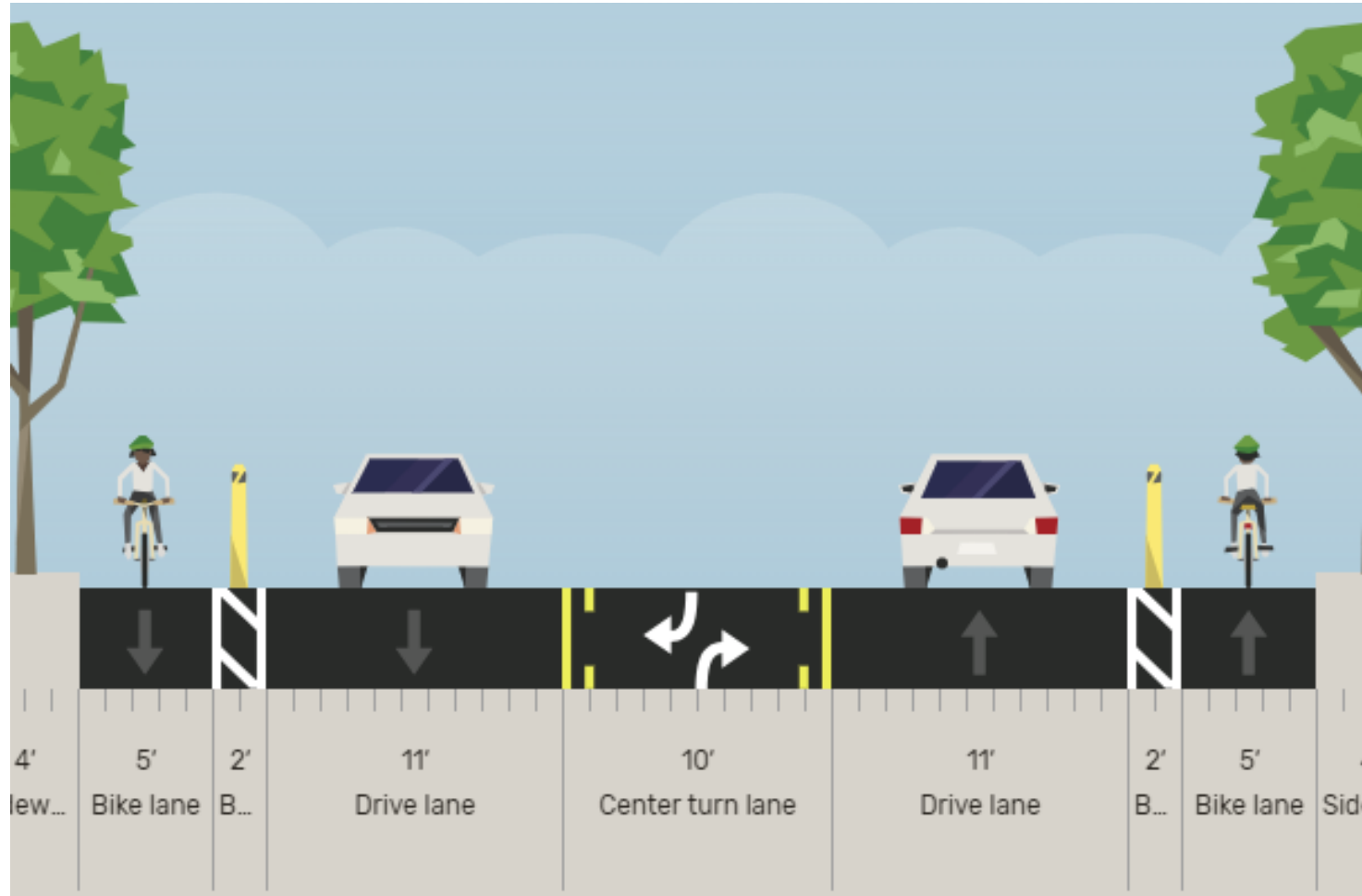

Project Objectives

- Improve **access, safety for people walking, biking, and travelling along the NE 130th/Roosevelt Way NE/NE 125th corridor and to the future NE 130th St light rail station.**
- Adjust roadway and intersection design to support **eliminating fatal and serious injury crashes** for all users and minimize conflict points between buses and people biking.
- **Support new bus service** to the NE 130th Street light rail station by **improving existing bus stops amenities and adding new bus stops** in previously unserved portion of NE 130th St/Roosevelt Way/NE 125th St corridor.
- Implement **transit priority treatments** along the NE 130th and NE 125th corridor to improve transit reliability.
- Advance project objectives in a way that **responds to community needs and priorities.**
- Develop an implementation plan to **complete construction in 2026** to align with the opening of the NE 130th St light rail station.

Project Timeline

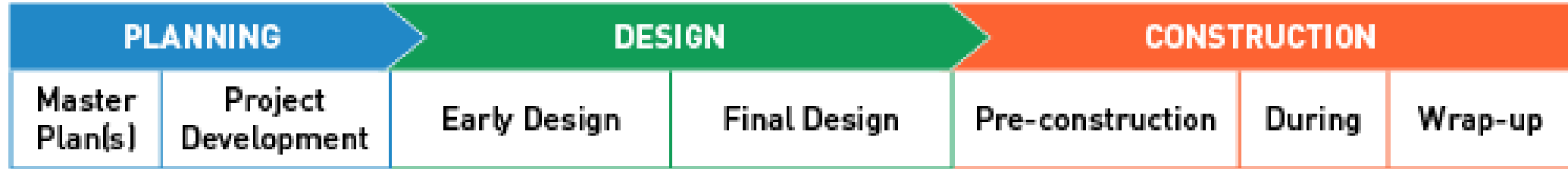

we are here

Draft Conceptual Designs



130th St: 1st Ave to 3rd Ave

NE 130th St: 1st Ave
NE to 3rd Ave NE

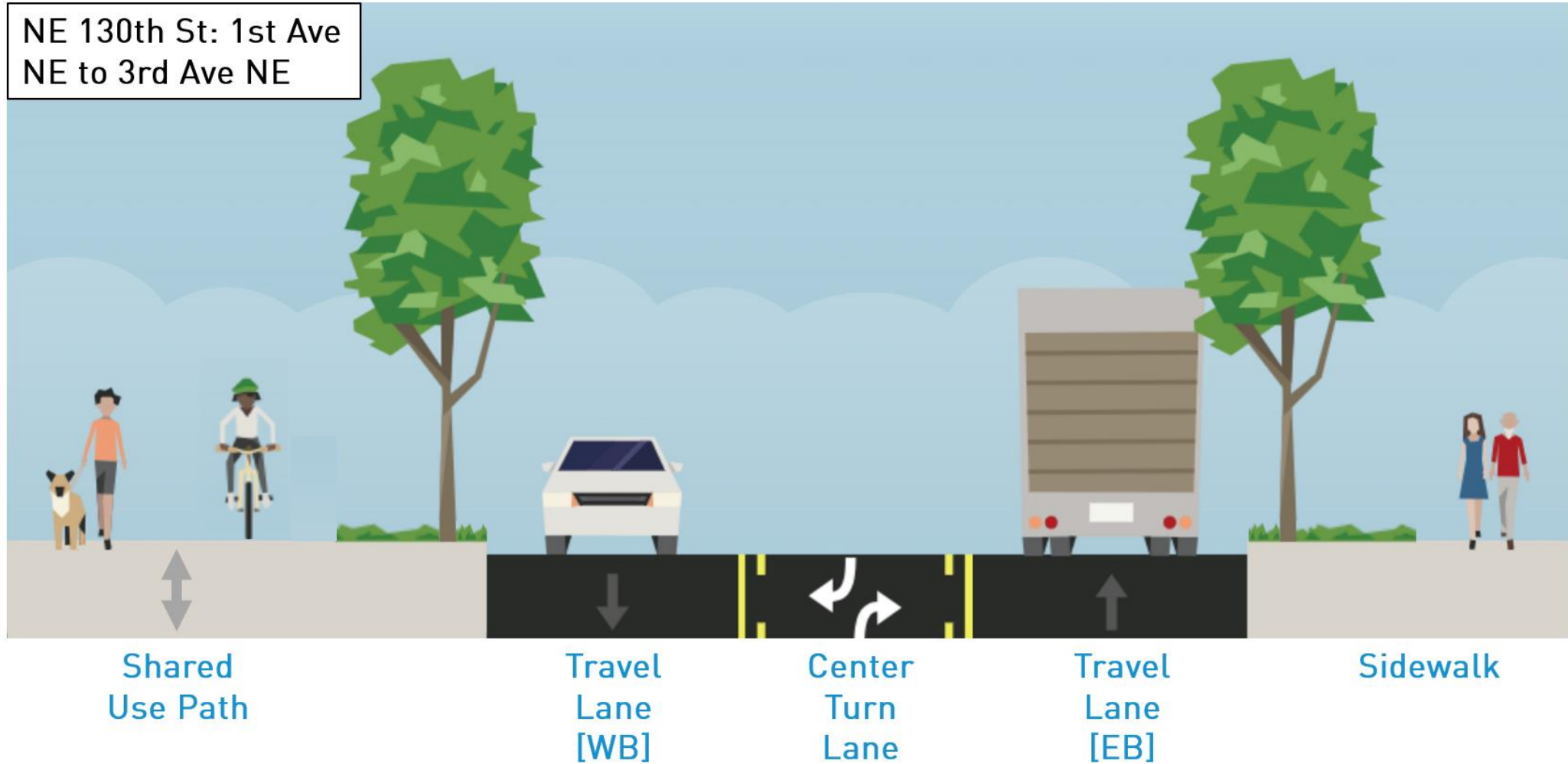

130th St / I-5 Overpass

NE 130th St I-5 overpass
(between 3rd Ave NE and 5th Ave NE)

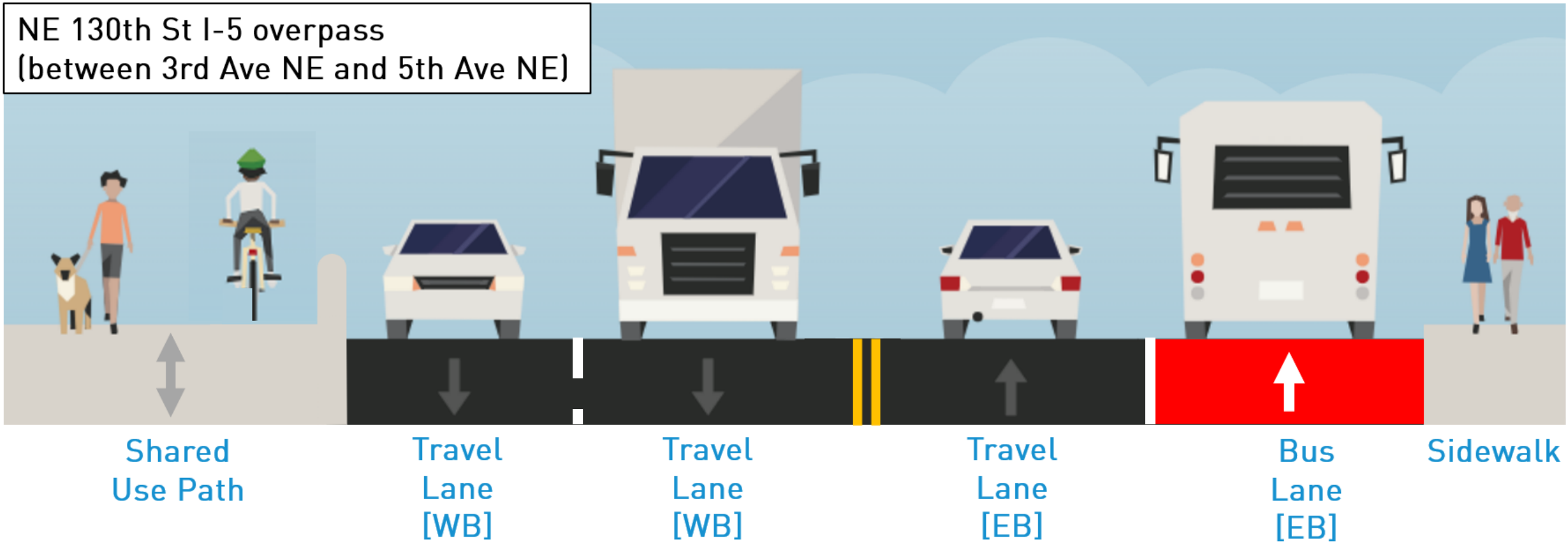

130th St / I-5 Overpass

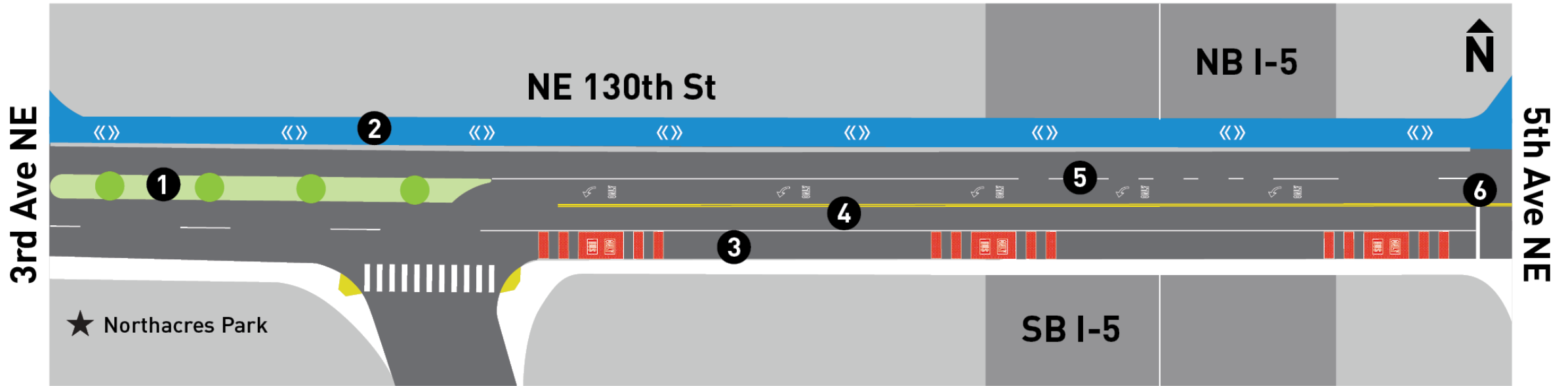

- 1** Planted median from 3rd Ave NE to southbound I-5 on ramp
- 2** Shared use path on the north side for people walking, biking, and rolling
- 3** 1 bus only lane, which will serve the planned bus stop on the southwest corner of NE 130th St and 5th Ave NE
- 4** 1 eastbound general purpose lane
- 5** 2 westbound general purpose lanes
- 6** No eastbound left turns to northbound 5th Ave NE

Roosevelt Way, 5th Ave to 8th Ave

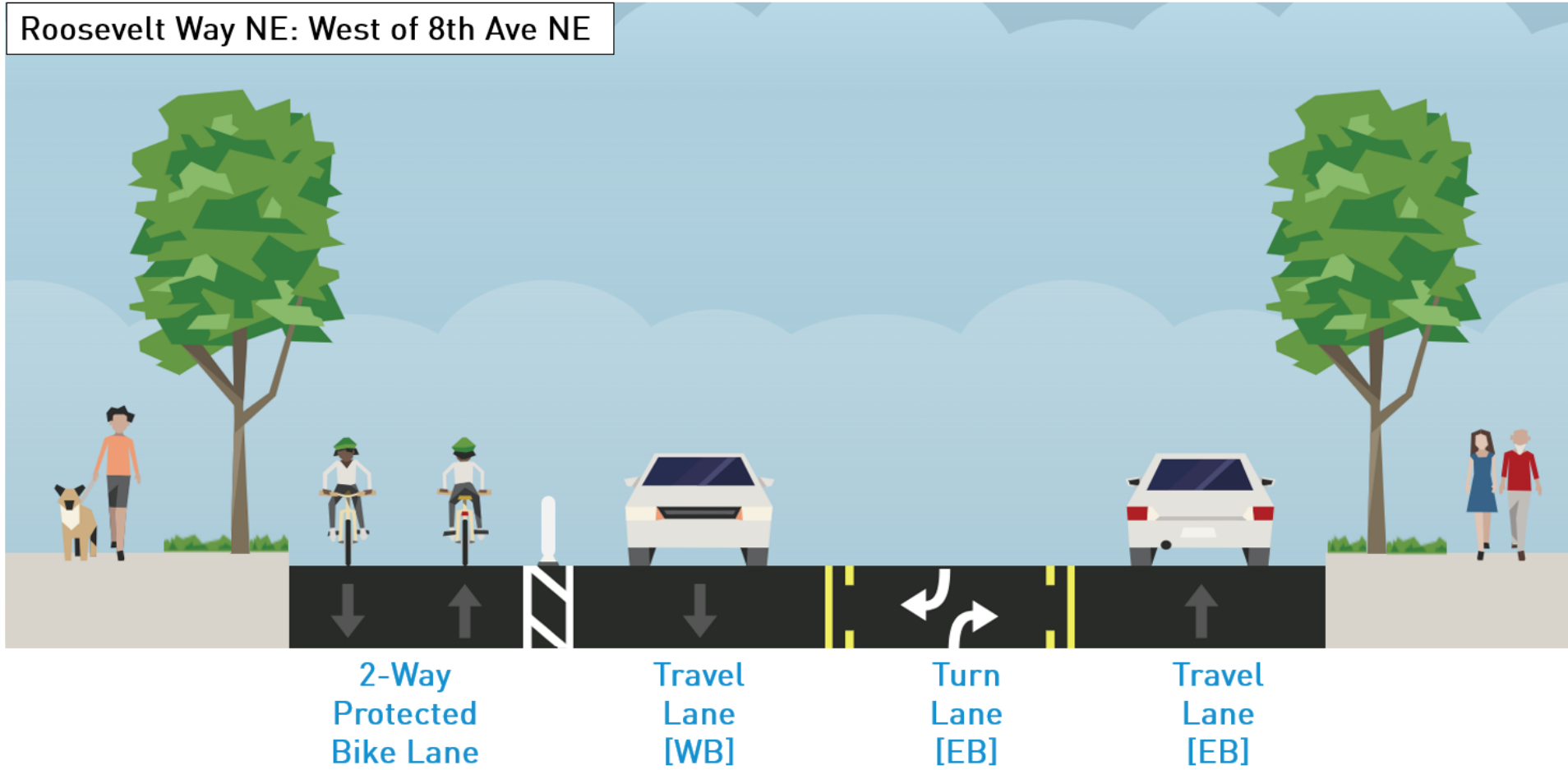

Roosevelt Way NE at 8th Ave NE

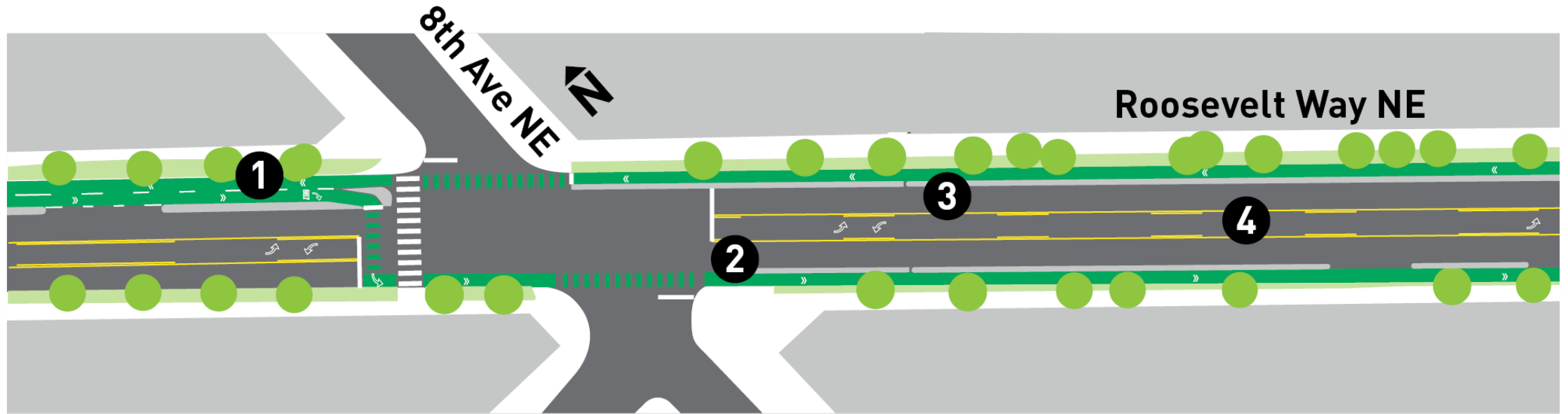

1 Transitions to directional protected bike lanes at 8th Ave NE

2 1 eastbound general purpose lane

3 1 westbound general purpose lane

4 1 two-way center left turn lane

Roosevelt Way, 8th Ave to 10th Ave

Roosevelt Way NE: East of 8th Ave NE

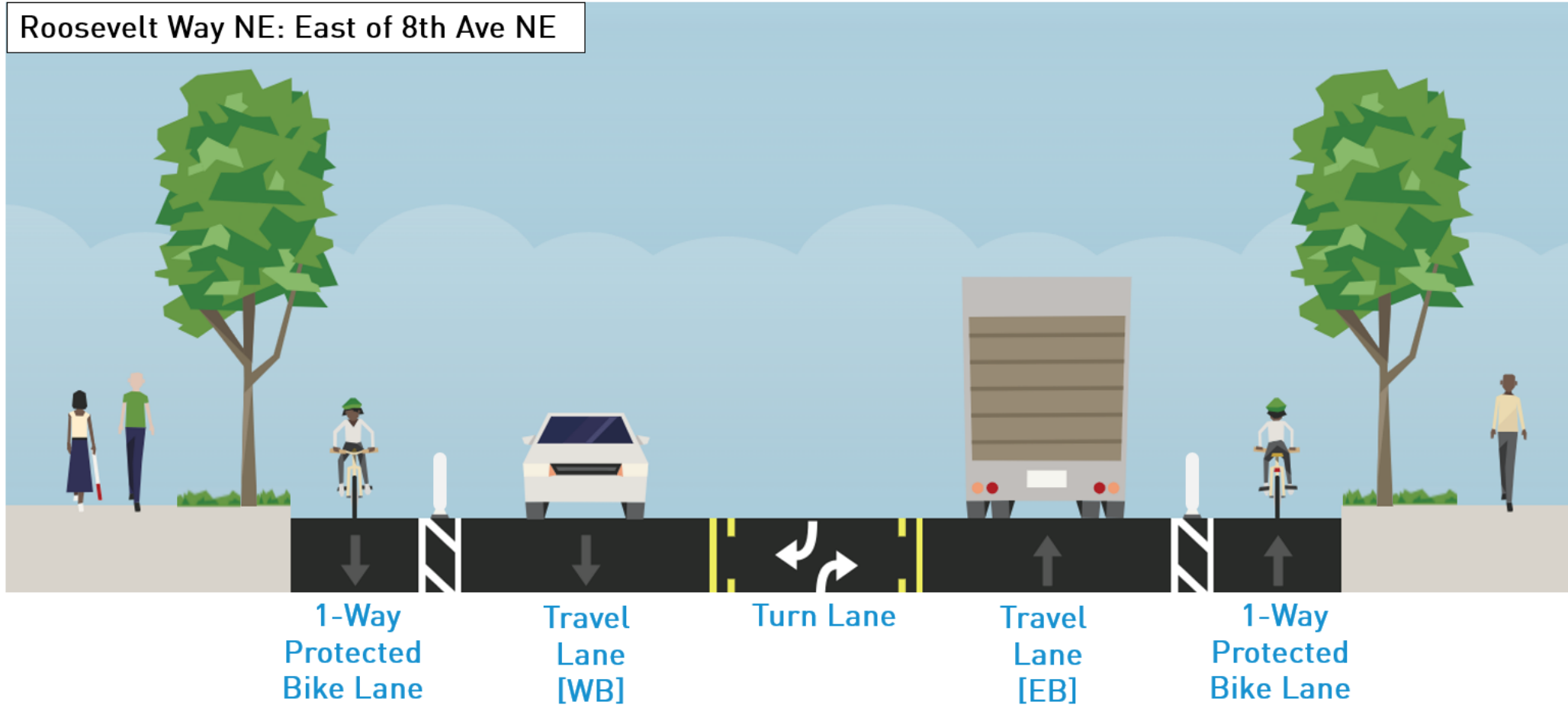

125th St, 10th Ave to Lake City Way NE

NE 125th St: 10th Ave NE to Lake City Way NE

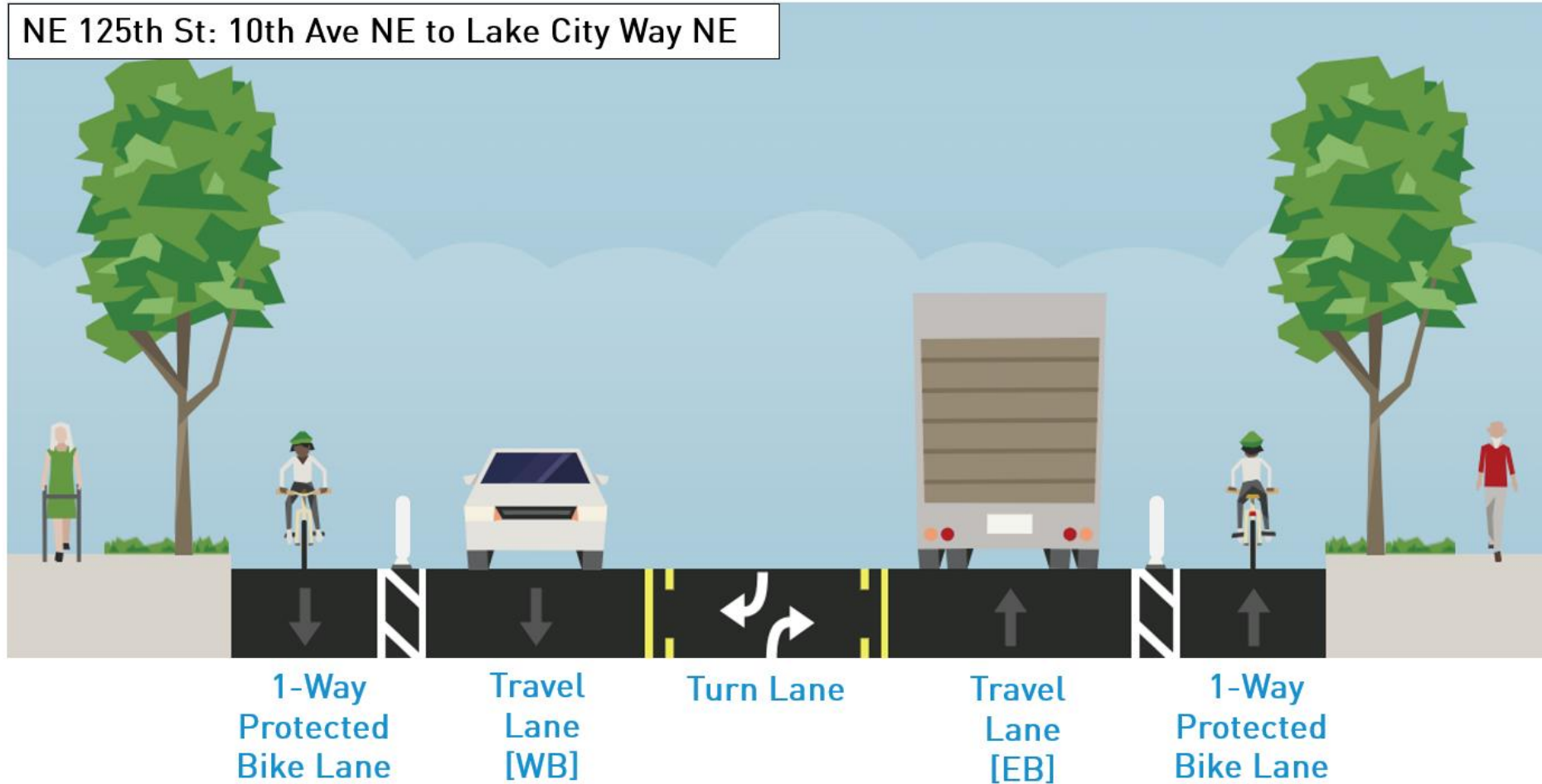

Questions?

Stay in touch:



NE130thSt_NE125thSt_Project@seattle.gov



<https://www.seattle.gov/transportation/projects-and-programs/programs/transportation-planning/ne-130th-and-125th-mobility-and-safety-project>