



2015 SBC Code Solution

The following interpretation is intended to provide guidance to staff for consistency of review and is subject to change without notice. Application of this interpretation, policy or code alternate to specific projects may vary.

Code Issue:

Are all columns required to be individually fire protected in fire rated wall assemblies?

Interpretation:

It depends on the type of the column.

1. Wood columns that are not individually fire protected in rated wall assemblies are allowed.

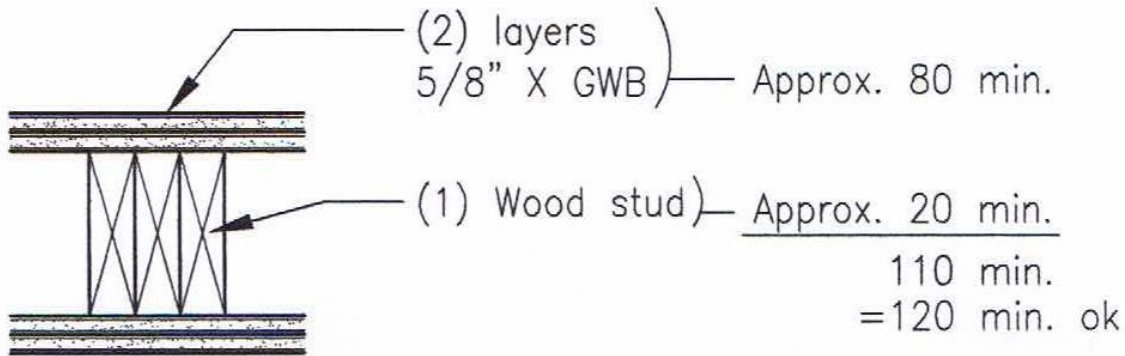

2. Steel columns located in a 1-hour fire rated wall assembly shall be protected. Here is an example of minimum acceptable protection for 1 hour:

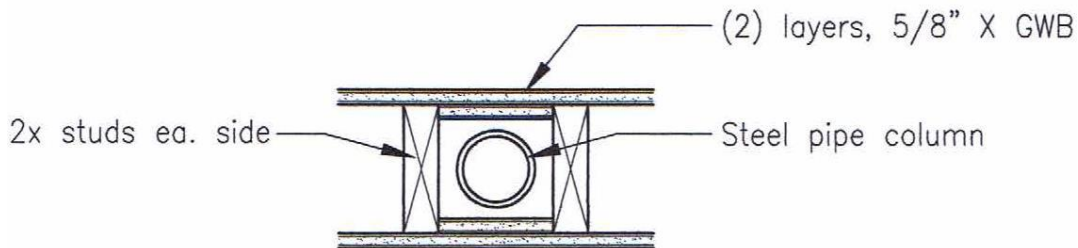

Steel columns located in a 2-hour fire rated wall assembly shall be protected with a U.L. tested assembly for a 2-hour fire rated steel column.

For questions about whether this code solution applies to your project:

- If you have submitted a permit application, contact the Building Code plan reviewer assigned to your application
- If you have not submitted an application, send us a question through the SDCI website
<http://www.seattle.gov/dpd/toolsresources/sendusaquestion/default.htm> or in person at the Applicant Services Center. Visit the Applicant Services Center website for more information about hours and location
<http://www.seattle.gov/dpd/aboutus/whoware/applicantservicescenter/default.htm>



