

# playground options | summary

## nature adventure

Calling all adventurers! This play scheme features net climbers, nature play structures like large logs and boulders, and a track swing.



ELEMENTS FROM THIS SCHEME TO INTEGRATE IN NEXT ITERATION:

- natural materials
- log/rock climber
- net structure (if space allows)
- track swing (if space allows)

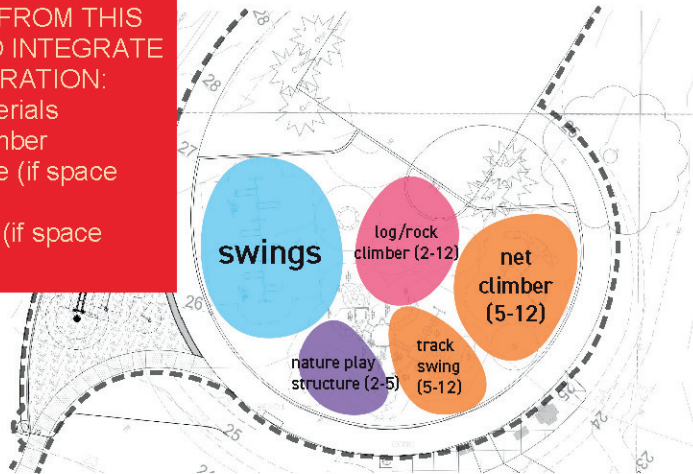

## garden theme

Play amongst giant flowers and insects in this garden-themed play area! Bright colors, music play, and whimsical play structures set this scheme apart.



ELEMENTS FROM THIS SCHEME TO INTEGRATE IN NEXT ITERATION:

- shade structure
- music/sensory play
- bold colors
- theme connection to urban farm (can standard equipment be configured to a loose farm/garden theme)?

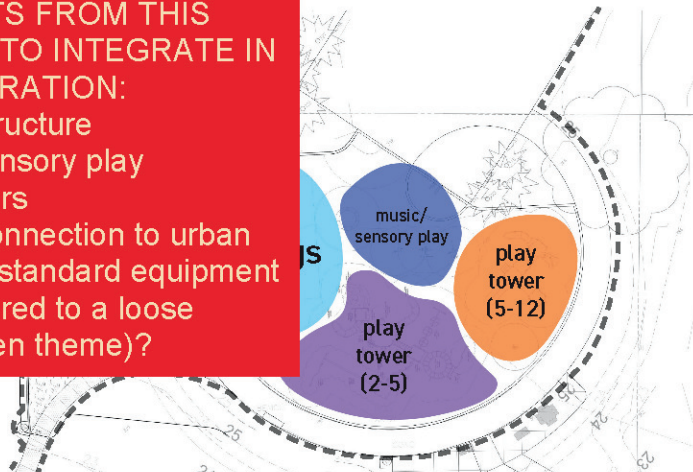

## inclusive play focus

Play is for everyone! While all the play schemes will have accessible play elements, this scheme prioritizes inclusivity with a fully-accessible play tower, spinner, swings, and sensory play.

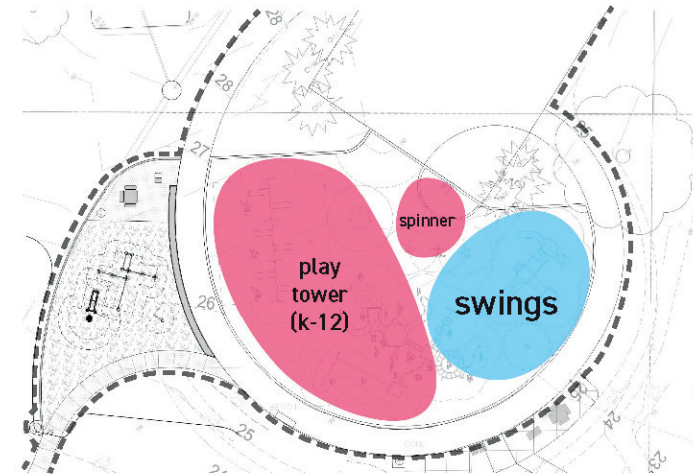

ELEMENTS FROM THIS SCHEME TO INTEGRATE IN NEXT ITERATION:

- accessible swings & dish swings
- accessible spinner
- play tower with ramped entry (if space allows)

## play tower

Reach new heights with two play towers focused on maximizing height for slides.

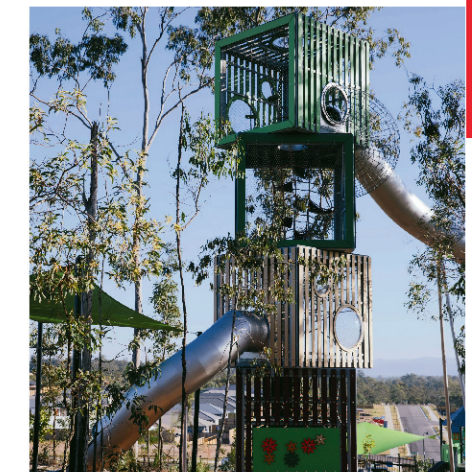

ELEMENTS FROM THIS SCHEME TO INTEGRATE IN NEXT ITERATION:

- slide
- play tower height



# community feedback

What play equipment do you like most in your desired play scheme?



What is your preference for type of play surfacing?

1. rubberized surfacing
2. playground grass/ turf
3. hybrid (wood fiber chips and rubberized surfacing)
4. wood iber chips

1. shade
2. slide
3. log/rock climber
3. swings
4. music/sensory play
5. net climber
6. spinner
7. play tower
8. track swing

Community also expressed interest in natural materials, bold colors, equipment for multiple age groups (both 2-5 and 5-12 yrs), connection to surrounding nature (trees/Lake Washington), and synergy with the Rainier Beach Urban Farm and Wetlands.

What inclusive play elements would you like to see at the park?

1. play tower with ramp
2. swings
3. wheelchair accessible spinner
4. music/sensory play



**For more info, Contact:**

**PLANNER:** Shaquan Smith  
**PHONE:** (206)256 - 5944  
**EMAIL:** shaquan.smith@seattle.gov