

Terry Pettus Park Renovation

Jenny A. Durkan
Mayor

Samuel Assefa
Director, OPCD

Brianna Holan, Chair

Justin Clark, Vice Chair

Kim Baker

Elizabeth Conner

Azzurra Cox

Mark Johnson

Rick Krochalis

Amalia Leighton

Vinita Sidhu

Elaine Wine

Michael Jenkins
Director

Valerie Kinast
Strategic Advisor

Aaron Hursey
Planner

Juliet Acevedo
Administrative Staff

**Office of Planning and
Community Development
Seattle City Hall**
600 4th Avenue, 5th Floor
Seattle, WA 98124

TEL 206-684-0435
FAX 206-233-2784
seattle.gov/designcommission

Commissioners Present

Brianna Holan, Chair
Kim Baker
Elizabeth Conner
Azzurra Cox
Mark Johnson
Rick Krochalis
Amalia Leighton
Vinita Sidhu
Elaine Wine

Commissioners Excused

Justin Clark, Vice Chair

Project Description

Originally constructed in 1971, Terry Pettus Park is a street-end pocket park located along the eastern shore of Lake Union in the Eastlake Neighborhood. The purpose of the project is to renovate the existing park as well as to increase the park size through the acquisition and development of an adjacent property located southwest of the existing park. The goals of the renovation are to maintain waterfront recreational access, increase durability of park materials, improve accessibility, improve access from adjacent trails and pathways, and to provide shoreline restoration. The project is funded through the Seattle Parks District and currently includes \$1,576,000 for the planning, development, and construction of the park.

Meeting Summary

This was the Seattle Design Commission's (SDC) second review of the Terry Pettus Park Renovation Project. The purpose of this meeting was to review the schematic design phase (60% design) for the project. The SDC voted, 8-1, to approve the schematic design for the Terry Pettus Park Renovation project with several conditions and recommendations.

Recusals and Disclosures

None

November 19, 2020

9:00 - 10:30 am

Project Type

CIP

Phase

Schematic Design (60% design)

Previous Reviews[9/17/20](#)**Presenters**Duane Dietz
Jones & JonesToby Ressler
SPR**Attendees**Omar Akkari
SDOTMario Campos
Jones & JonesRichard Fernandez
SPUJoy Jacobson
FASDave LaClergue
SPUChris Leman
Neighborhood ResidentRob Widmeyer
Neighborhood Resident

Figure 1: Project location

Summary of Presentation

Duane Dietz, of Jones & Jones, and Toby Ressler, of SPR, presented the schematic design proposal for the Terry Pettus Park Renovation project. The team provided information on the project background, site location (see figure 1), existing conditions and surrounding context as well as additional information on community outreach. The team then focused the rest of the presentation on the updated design proposal for the project. The updated design includes spaces for gathering and seating as well as a dock and gravel beach area for swimming and launching hand powered boats. A large plaza is located along Fairview Ave E while a secondary arrival gathering space adjacent to the parking and loading area. A picnic area, dock, and gravel beach are located along the lower, southwestern portion of the park and provide water access. These spaces are connected by an accessible pathway leading from Fairview Ave E to the shoreline. The proposed design also includes an additional gathering space that provides stair access to the gravel beach. The updated design will include native planting and site materials such as seating, tables, bollards, and a hand-carry boat slide. The design will also include an osprey nest to provide a habitat for local osprey that are currently residing in the area. *See figure 2 for more information.*

The design proposal includes the integration of the Cheshiahud Loop Trail along the southern and western portion of the park site. The team is also coordinating with Seattle Public Utilities on the development of a Green Stormwater Infrastructure (GSI) project located adjacent to the park site.

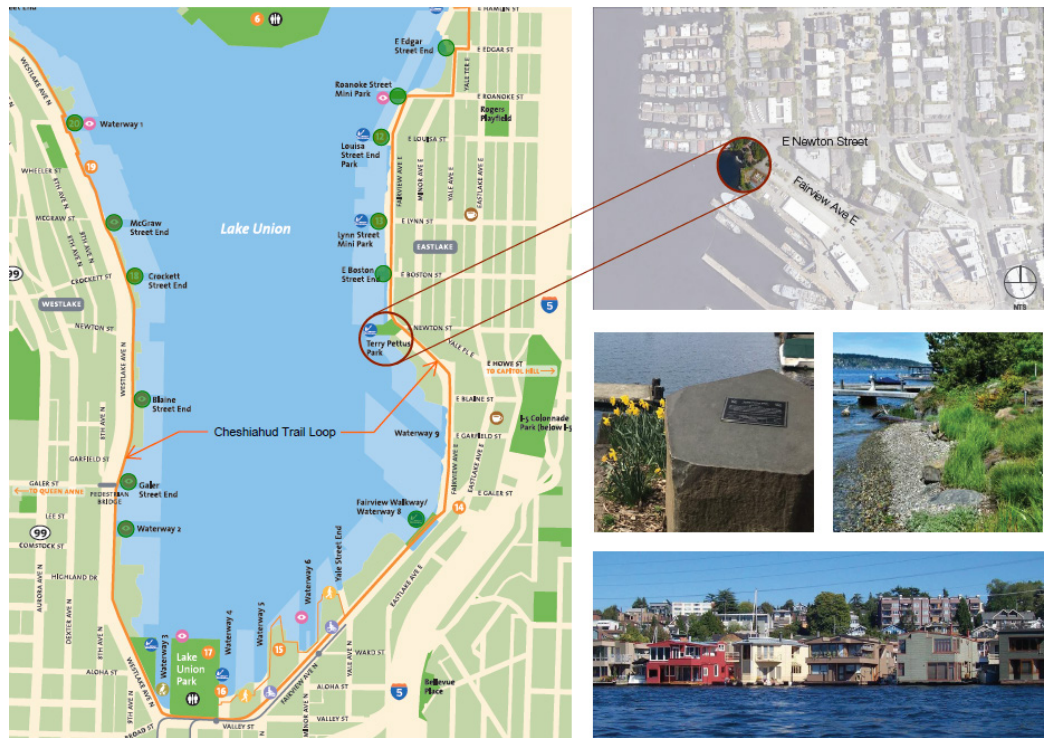
Agency Comments

Richard Fernandez, SPU, stated that the project presented a great opportunity for SPU to repair failed infrastructure within the area. Richard then mentioned that they are waiting for SPR to submit a more detailed design and proposed project costs prior to making a decision, but is anticipating to have a separate contracted project for the adjacent GSI project, which would also include additional GSI improvements in other places within the neighborhood. Richard said they would continue to work with SPR to make sure both the planning and design for both the SPU and SPR projects are coordinated.

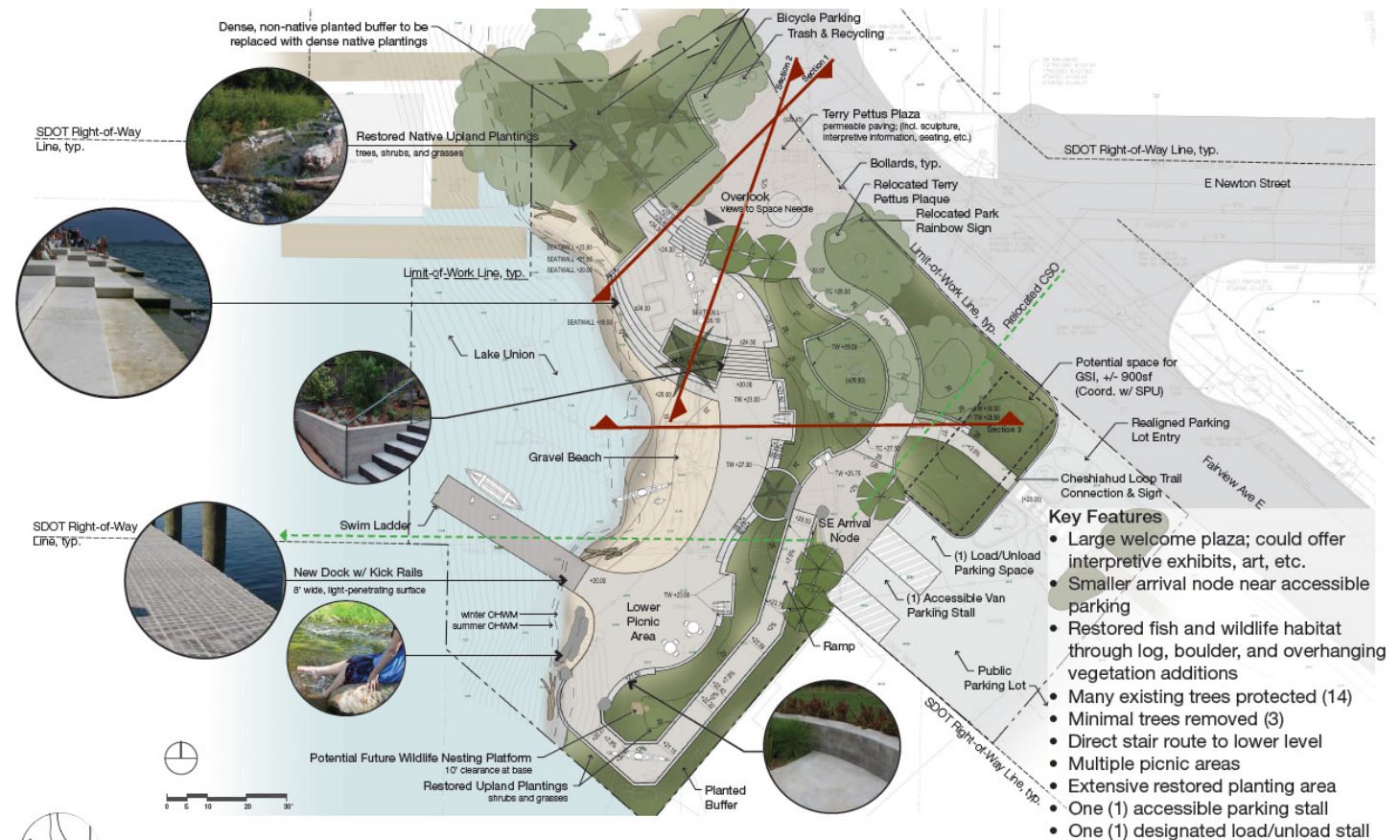

Figure 2: Updated design proposal

Public Comments

None

Summary of Discussion

The Commission organized its discussion around the following issues:

- Overall design response to site conditions, surrounding neighborhood, and art integration
- Circulation – Site circulation, ADA access, Parking, and Dock location
- Sustainability and habitat restoration
- Materials, planting, and lighting

Overall design response to site condition, surrounding neighborhood, and art integration

The SDC acknowledged the positive development of the design proposal, but remained concerned with the limited information provided on community outreach for the project. Commissioners stressed the importance of providing ongoing community outreach and collecting demographic information, as the design continues to develop, to better understand who is providing input and how that input is influencing the design. The Commission then recommended the project team continue to conduct community outreach as the design process continues as well as strongly recommending to consider measuring demographics to have a better understanding of who is responding and participating and how their input is influencing the overall design.

The SDC was encouraged to hear the project team is thinking about ways to incorporate art. Commissioners support the team's goal of integrating art within the design and recommended the project team continue to think about how the budget can prioritize art integration. The SDC then recommended the team coordinate with an artist as soon as possible. Commissioners also encouraged the team to consider using art as wayfinding as well a way to highlight sustainability and natural systems found throughout the project site.

The Commission then commented on the development of specific project elements. Commissioners appreciated the inclusion of specific elements such as kayak storage and the osprey nest. The Commission recommended the project team provide a water fountain on site or provide wayfinding to direct users to the nearest off-site water fountain. The Commission then raised concern over the sharp turn along the pathway

between the loading area and dock and encouraged the project team to soften the edge so to not negatively affect users carrying kayaks or other large items.

Circulation – site circulation, ADA access, parking, dock location

The SDC is concerned with the level of engagement and coordination with SDOT on the development of the street edge and right-of-way (ROW) design, overall Street Improvement Permit (SIP) process, and integration of the loop trail through the park. The Commission stressed the importance of coordinating with SDOT as the team continues to develop the proposed design and goes through the permitting process. The Commission discussed conditioning approval on providing additional information about how they are coordinating with SDOT in the development of the ROW design, SIP process, and integration of loop trail during the subcommittee review that will address overall design developments.

The Commission then discussed concerns with limited access to the middle terrace. Commissioners stressed the importance of providing a space that is accessible for all users and recommended the team either provide universal access to the middle terrace or remove the terrace from the design proposal. The Commission then conditioned the team address this issue during the subcommittee review that will address overall design developments.

The SDC commended the project team for the location of the dock. Commissioners agreed that the dock would protect the beach area and that the location provided adequate space between the dock and adjacent houseboat community.

Sustainability and habitat restoration

The SDC commended the project team for their approach to sustainability and habitat restoration. The Commission also appreciated the team's coordination with SPU as it continues to develop future GSI facilities adjacent to the project site. Commissioners recommended the project team continue to coordinate with SPU as their project develops. Commissioners also recommended the team continue to work with SPU to provide information that will tell a story throughout the project site, highlighting the sustainability program as well as other features related to habitat restoration such as the osprey nest. The Commission then discussed conditioning project approval on the team providing an update on their coordination with SPU during the subcommittee review that will address overall design developments.

Materials, planting, and lighting

Overall, the SDC appreciated the continued development of the proposed materials and planting palette. Although Commissioners appreciated the thought and detail that went into selecting materials, they expressed concern with the amount of different materials being used for a small park. The Commission recommended the project team reduce the number of different materials and encouraged them to be intentional about the design and detailing of specific materials, such as the bollards and site furniture, as well as the plant palette to be culturally and contextually relevant to the site. Commissioners also recommended the team use materials to reinforce the users experience such as through wayfinding to help guide users to different areas of the park.

The Commission then encouraged the project team to continue to further soften the edges and materials used as they approach the shoreline. Commissioners also identified the boat slide as an opportunity for an artistic, culturally responsive element and encouraged the team to use a material such as wood to build the slide. The Commission then reiterated its concern with the design and dimension of the loop trail entering the park and encouraged the project team to use a material such as a tactile paving strip to provide a physical cue for cyclists entering into the park.

Action

The Commission thanked the project team for their presentation of the schematic design phase for the Terry Pettus Park Project. Overall, the SDC appreciated the team providing enhanced water access, commitment to habitat restoration, and expanding the picnic and recreation use areas. The Commission also appreciated the project team's coordination with SPU, as well as the continued development of the materials palette. The SDC voted, 8-1, to approve the schematic design proposal for the Terry Pettus Park project with the following condition:

1. Return for a subcommittee meeting to review how the proposed design has continued to develop. Specific details to be reviewed include the continued development of the middle terrace design & access, plans for art integration, and continued coordination with SDOT and SPU in the development of the adjacent ROW design and SIP process, integration of the loop trail to the City trail system, and GSI projects.

The Commission also provided the following recommendations:

1. Evaluate opportunities for providing universal access to the middle terrace; or consider removing the middle terrace.
2. Continue to conduct community outreach. Strongly consider measuring demographics to have a better understanding of who is responding and participating and how their input is influencing the overall design.
3. Continue to seek art funding and consider bringing an artist onto the project team.
4. Consider using art as wayfinding
5. Continue to explore the addition of a water fountain on-site or provide wayfinding to the existing water fountain north of the project site
6. Continue to collaborate with SPU to provide information that will tell a seamless story about the sustainability program across the various projects in the ROW and the Parks site.
7. Continue to be intentional about the design of materials, such as bollards and site furniture, so they are contextually and culturally relevant to the site
8. Focus on using materials that reinforce the overall design intent. Also consider using materials to encourage pedestrian flow, use, and wayfinding

The following are comments from commissioners who voted against the project:

Amalia Leighton – Although the project team has stated where they are in coordination with city agencies, this was not reflected in the presentation of the design that was given today. I am specifically concerned with the limited coordination between SDOT and SPU in the development of the current design that was presented. If the design and development schedule is as stated, then coordination with SDOT and SPU should have occurred much earlier in the process.

I am also concerned at the dimensions of the loop trail at the limits of the project and going through the park. As designed, the dimensions do not adequately address the interactions and potential conflicts between the park users and the cyclists and pedestrians moving along the trail through the park. It would help to know if the trail through the park is considered a spur of the trail or the mainline of the trail.