

# Alaskan Way Viaduct & Seawall Replacement Program



**Seattle Design Commission**  
**May 5, 2011**

# Urban Design Guidelines

## Alaskan Way Viaduct & Seawall Replacement Program

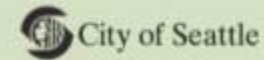
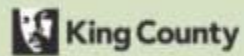
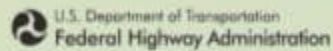

## PORTAL AREA DESIGN GUIDELINES

### SR 99 BORED TUNNEL ALTERNATIVE

SUBMITTED TO: WASHINGTON STATE DEPARTMENT OF TRANSPORTATION AND CITY OF SEATTLE  
PREPARED BY: ROMA DESIGN GROUP IN ASSOCIATION WITH NBBJ

JUNE 18, 2010

## Urban Design Guidelines

- WSDOT, SDOT, ROMA Design and NBBJ developed guidelines in 2009 and 2010 with the Seattle Design Commission.
- Provide a framework and a unified vision to guide implementation over multiple project design and construction contracts.
- Include goals, objectives and guiding principles.
- Respond to City of Seattle initiatives and neighborhood planning efforts.





## Urban Design Goals

1. Provide for the safety and comfort of pedestrians, bicyclists, transit, freight and other vehicles.
2. Reinforce the sense of place and give structure and orientation to the urban experience.
3. Contribute positively to the fabric of the city and the unique qualities of adjacent neighborhoods.
4. Contribute to the sustainability of the urban environment.

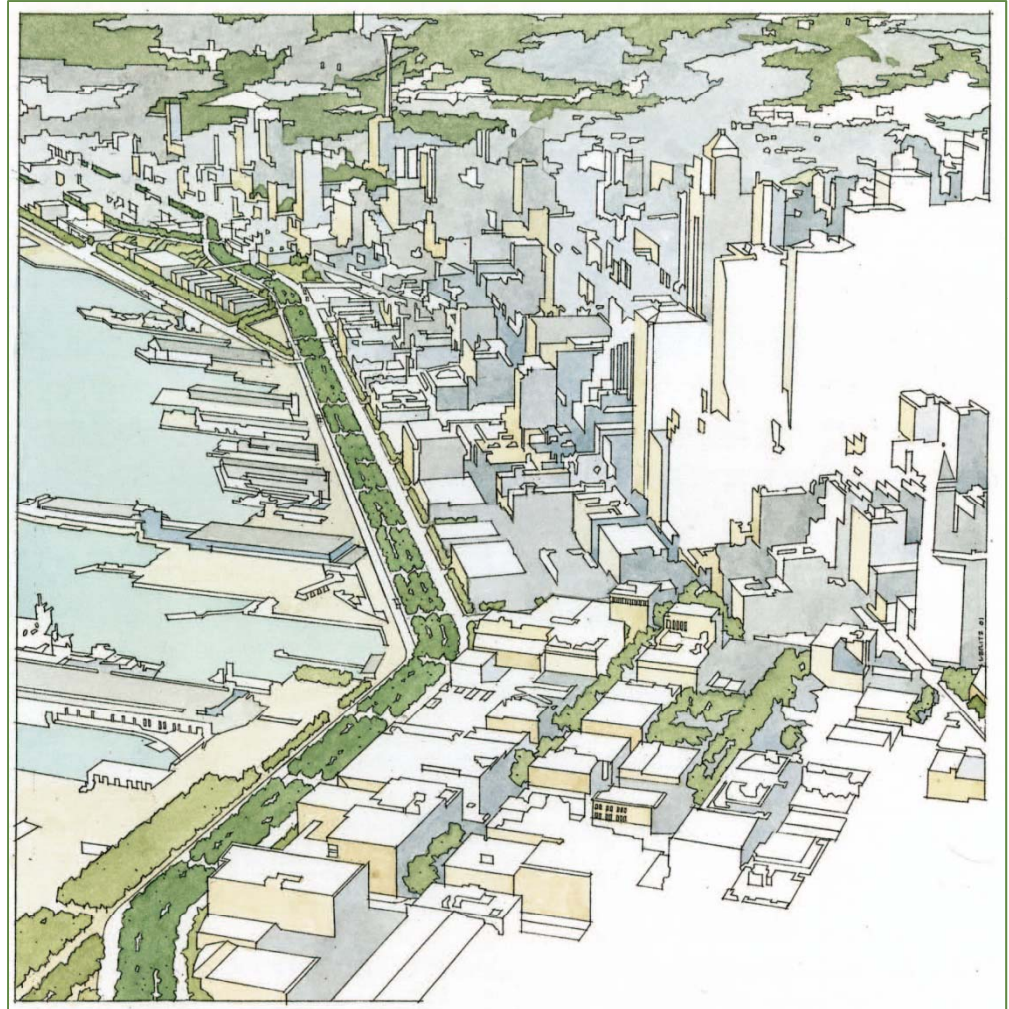



## Alaskan Way Viaduct & Seawall Replacement Program





## Alaskan Way Viaduct & Seawall Replacement Program



## Alaskan Way Viaduct & Seawall Replacement Program





## Overview of South Portal Area

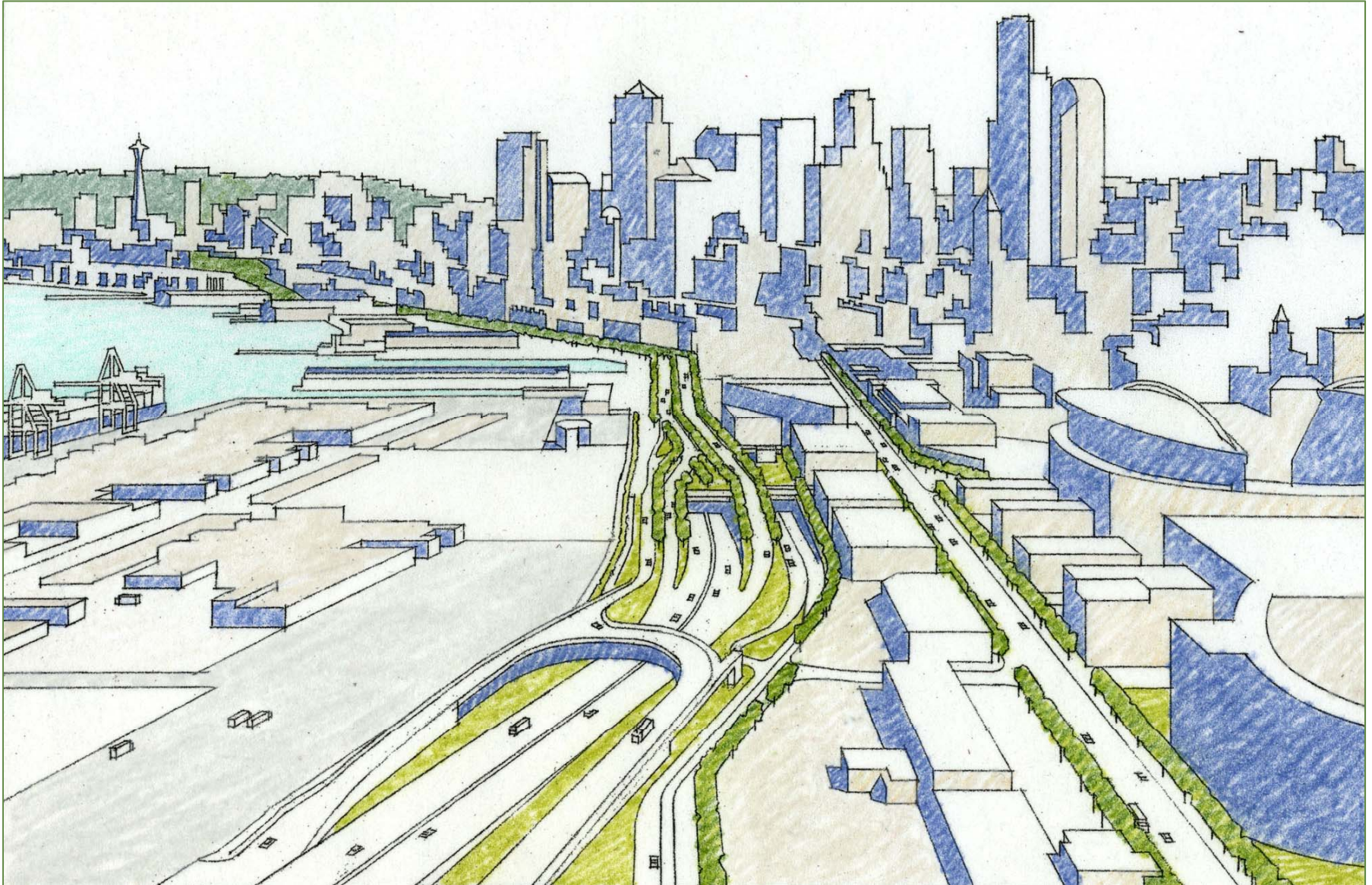



## Bicycle and Pedestrian Access

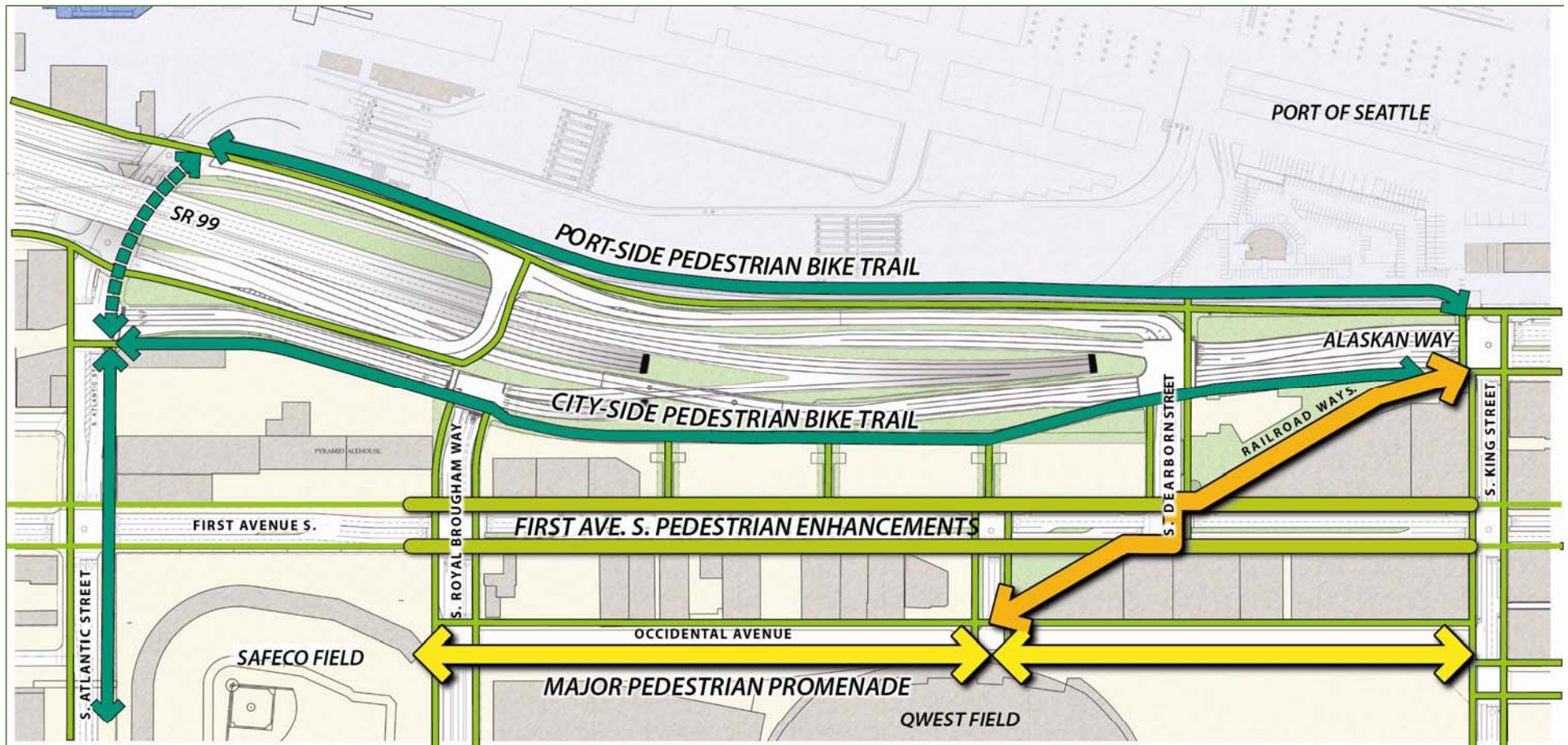

# Opportunity Areas

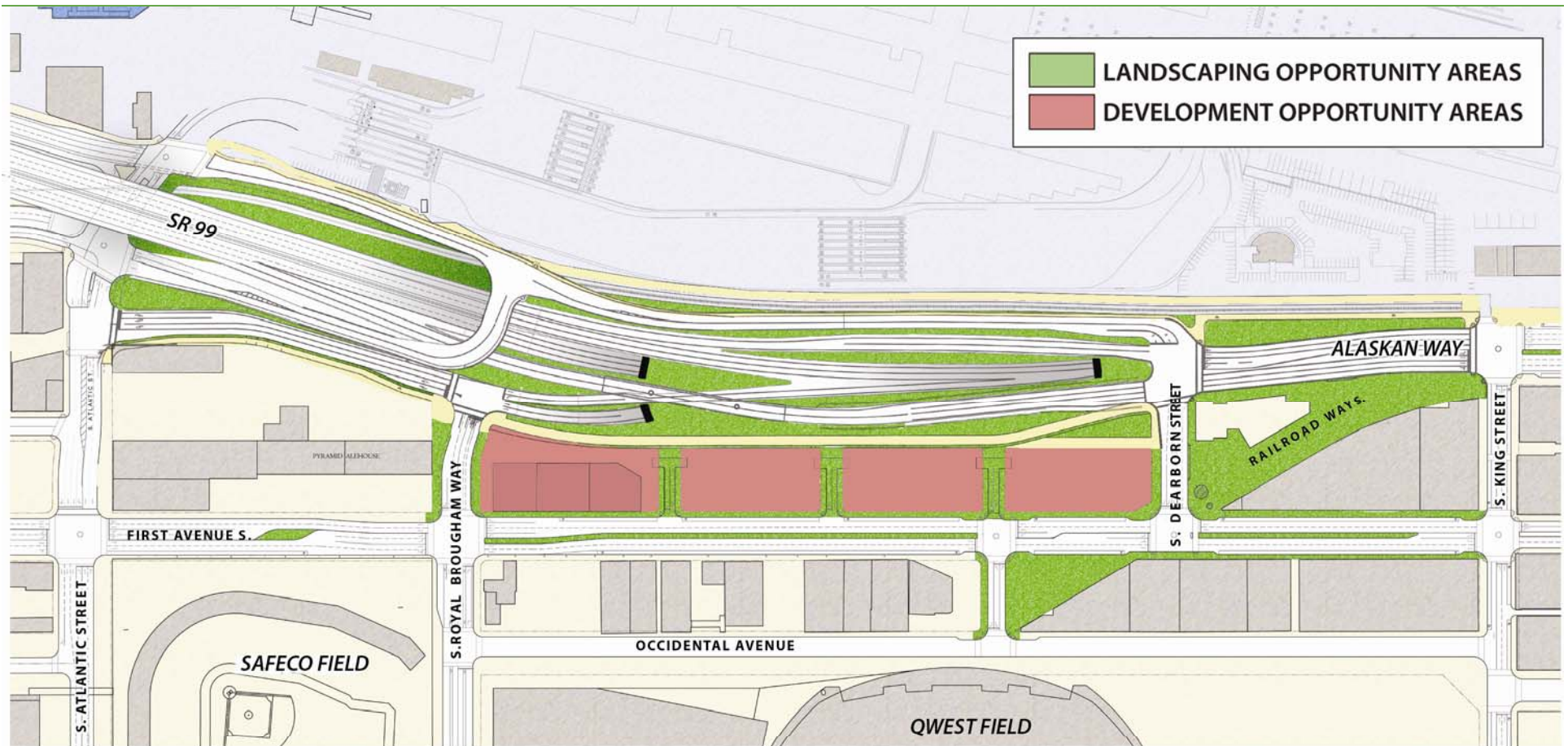



## New Waterfront Connection

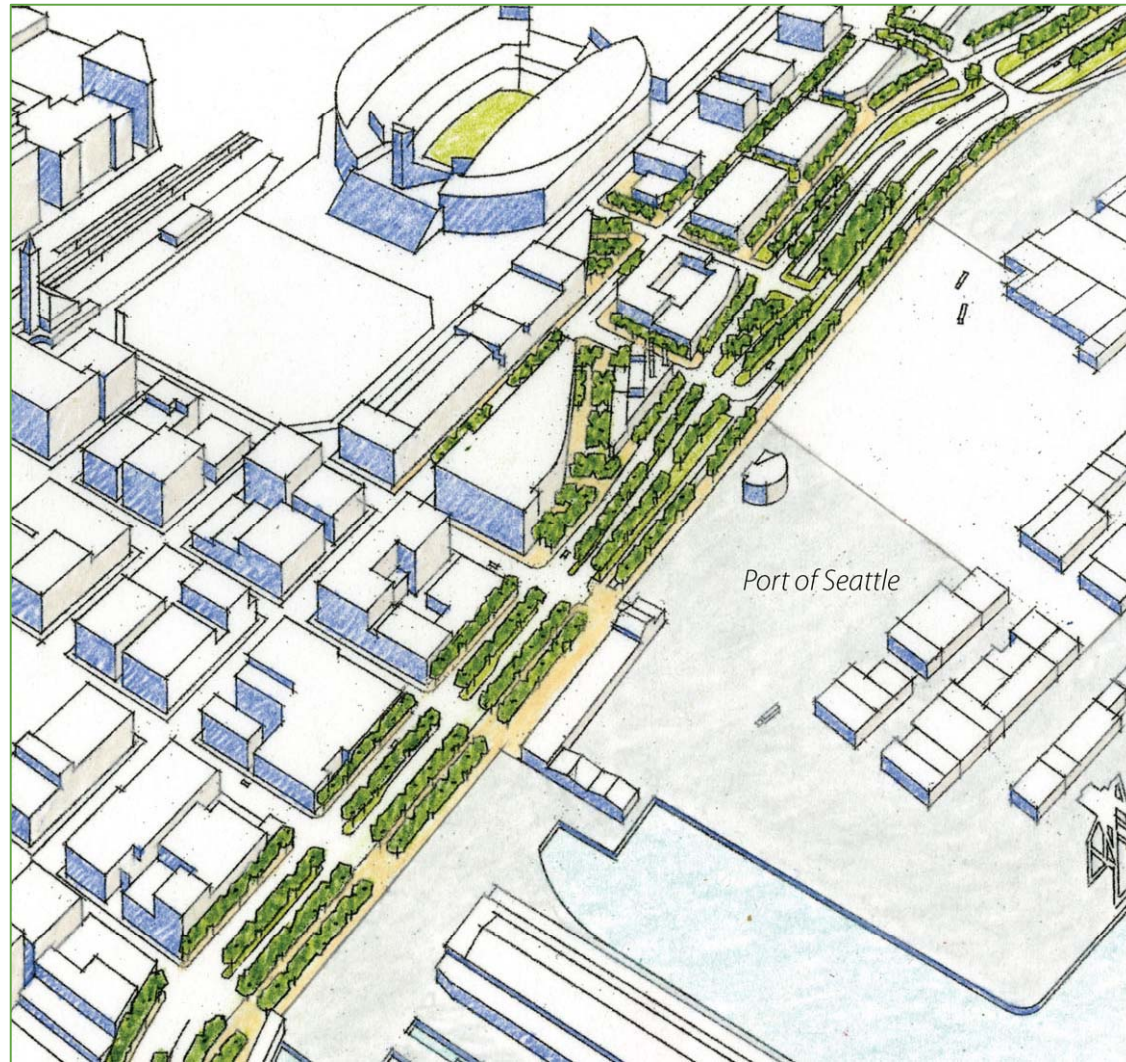



## Railroad Way S. Concepts





## Railroad Way S.

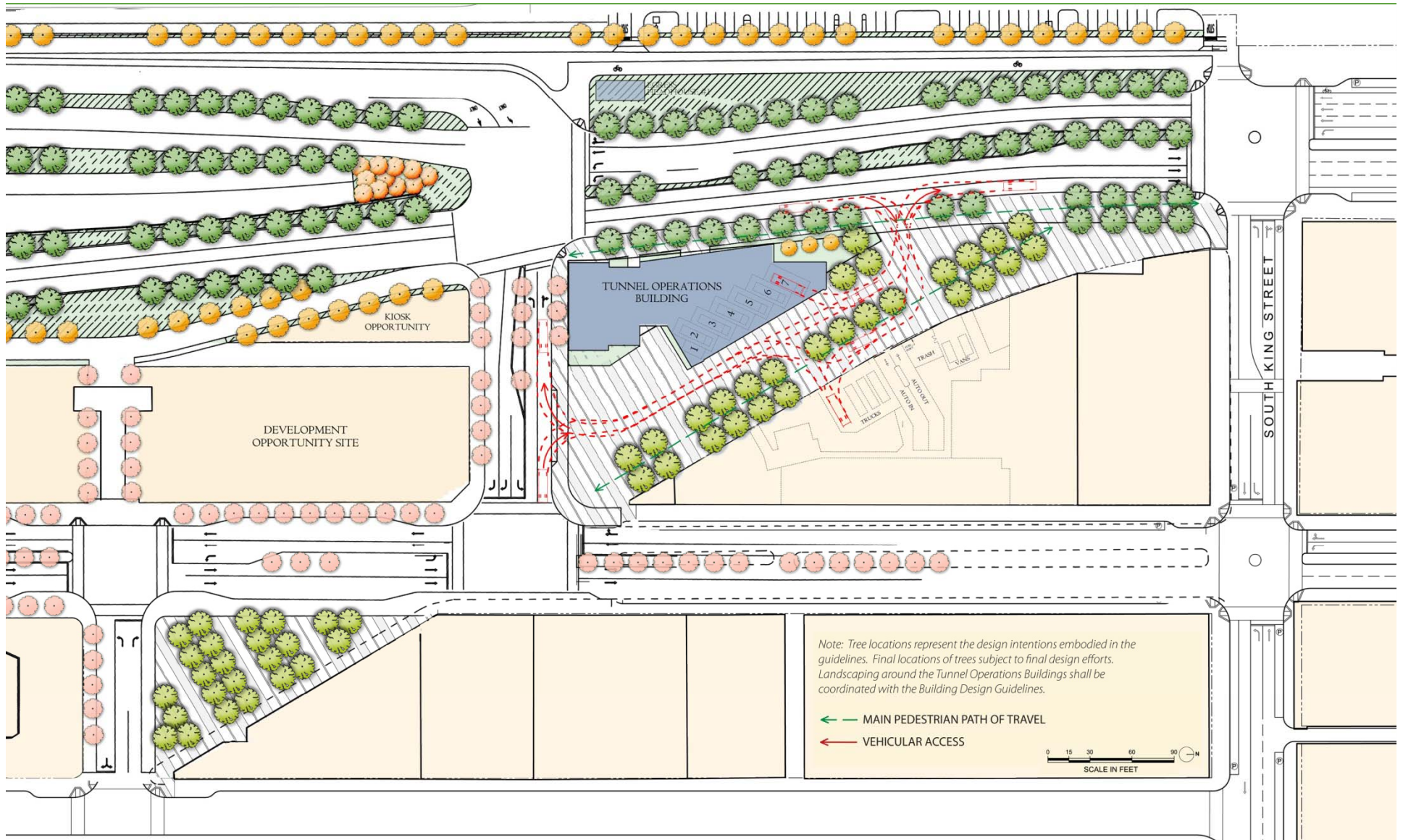

## Design Influences

### Neighborhood context / design influences

- Pioneer Square
- Stadiums / SODO
- Industrial / Port of Seattle
- Central waterfront

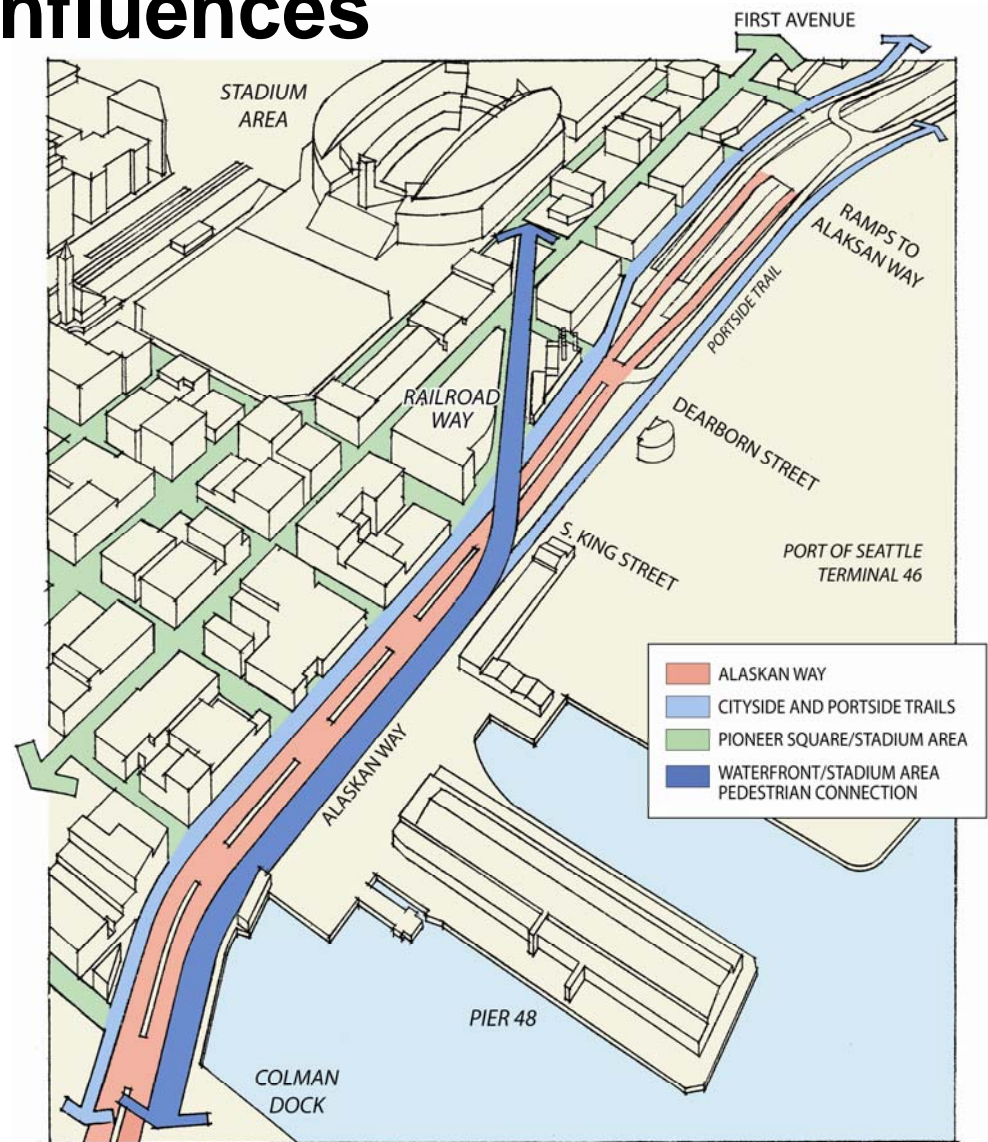



# South Portal Landscape Concept

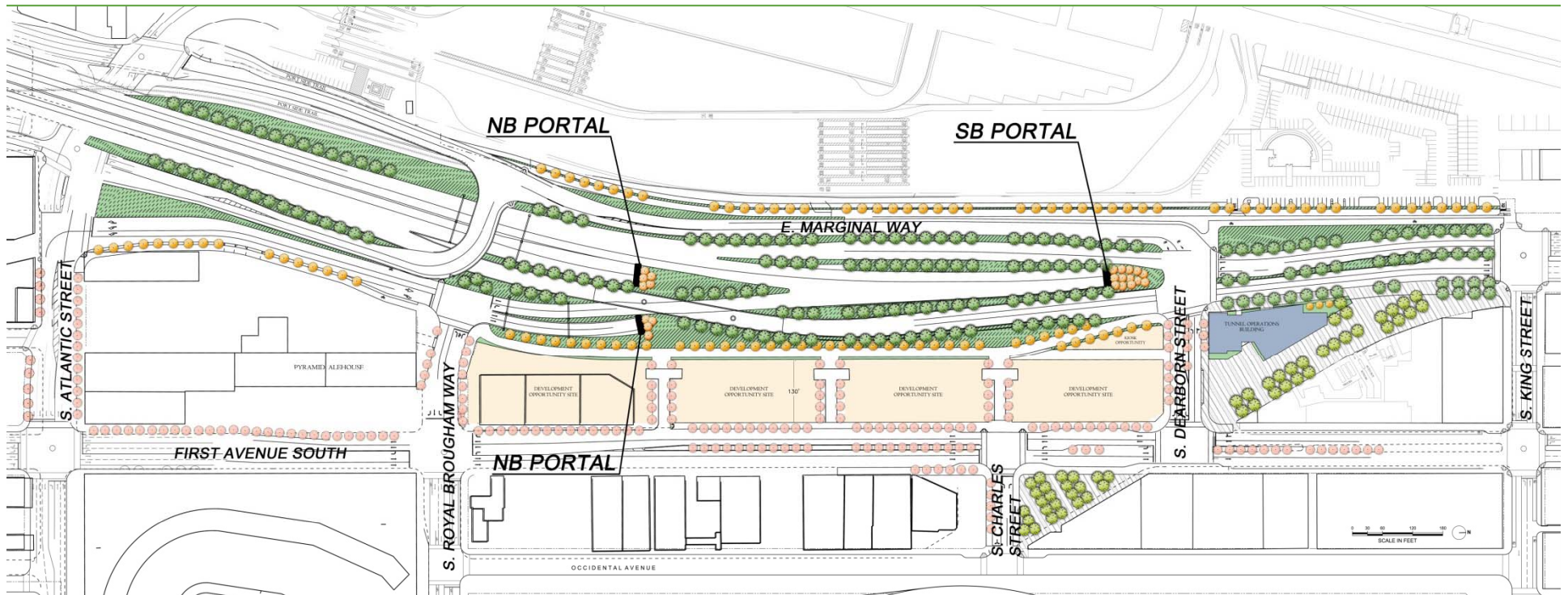



## Portal Area Context

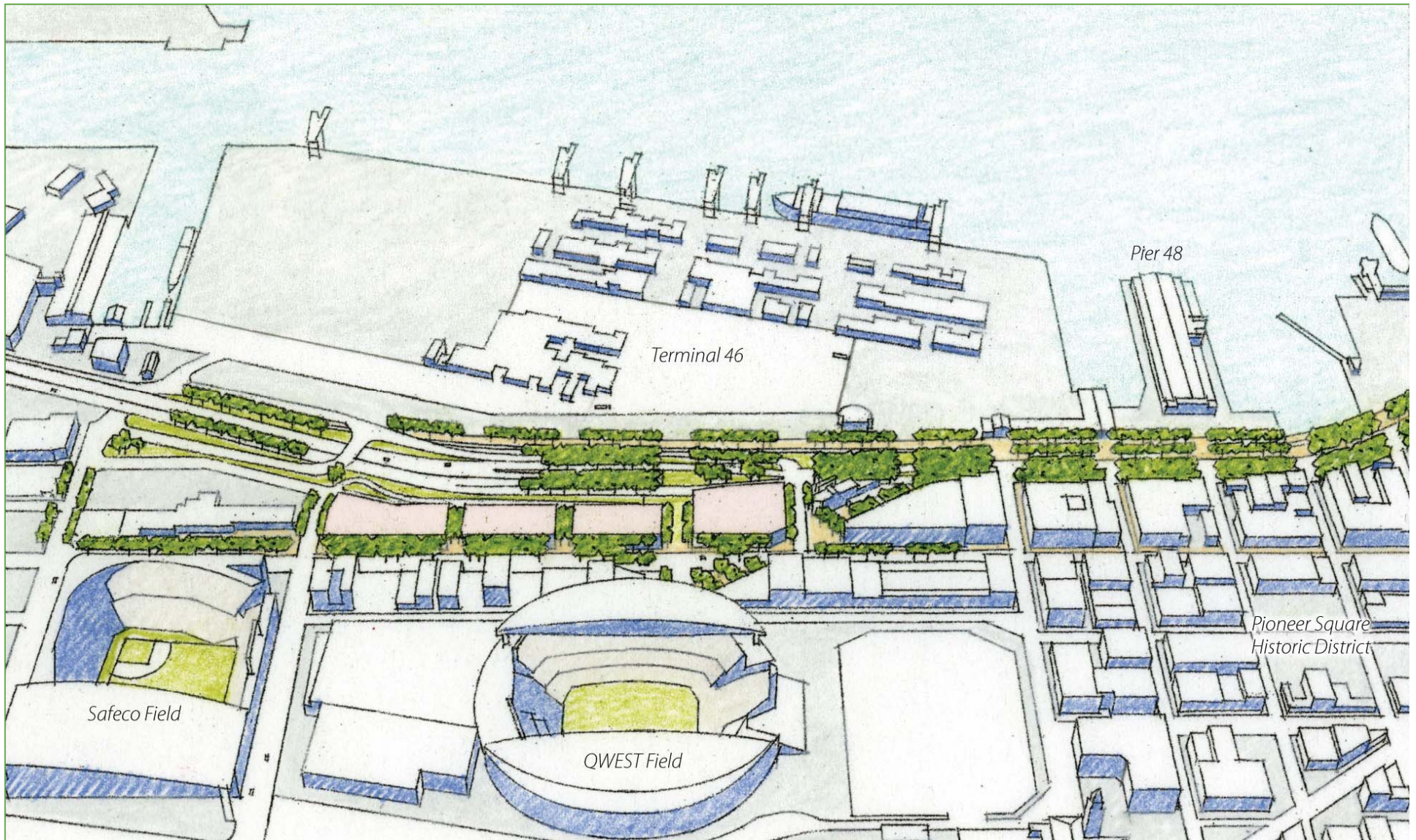



## S. Atlantic Street Overcrossing





# Entrance to Tunnel and City Street Grid





# Implementing Design Guidelines

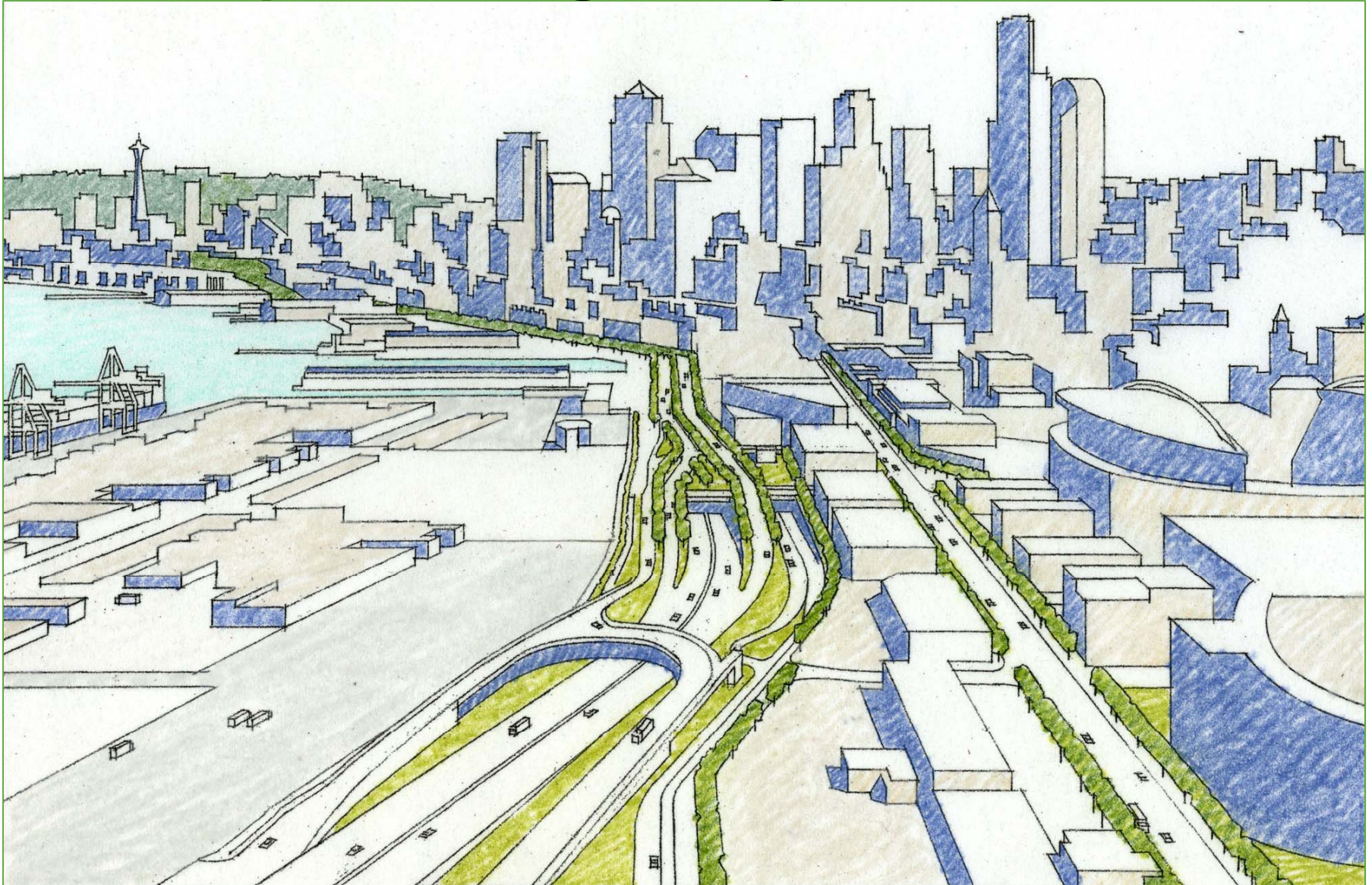

## **Future Meetings and Topics**

### **Summer 2011**

- North and south portal area urban design elements
- Urban design elements for the north and south operations buildings

### **Fall 2011 through 2013**

- Follow up presentations



# Alaskan Way Viaduct and Seawall Replacement Program



## **Website:**

[www.alaskanwayviaduct.org](http://www.alaskanwayviaduct.org)

## **E-mail:**

[viaduct@wsdot.wa.gov](mailto:viaduct@wsdot.wa.gov)

## **Hotline:**

1-888-AWV-LINE