

# **Seattle Design Commission Plan for Commenting on the Ballard Link Extension DEIS**

**March 5, 2026**

**Commission Business**





Anticipated date of Ballard DEIS publication is May 28, 2026

Focused approach – in lieu of commenting on all stations and the whole alignment, Commission will focus on 7 most critical locations.

Approach will call for ST and City to tailor their DEIS presentations to commission areas of interest.

Approach emphasizes Commission role as lead voice on urban design implications of publicly funded projects

## Compared to Preferred Tunnel 15th Avenue Station Option (IBB-2b)

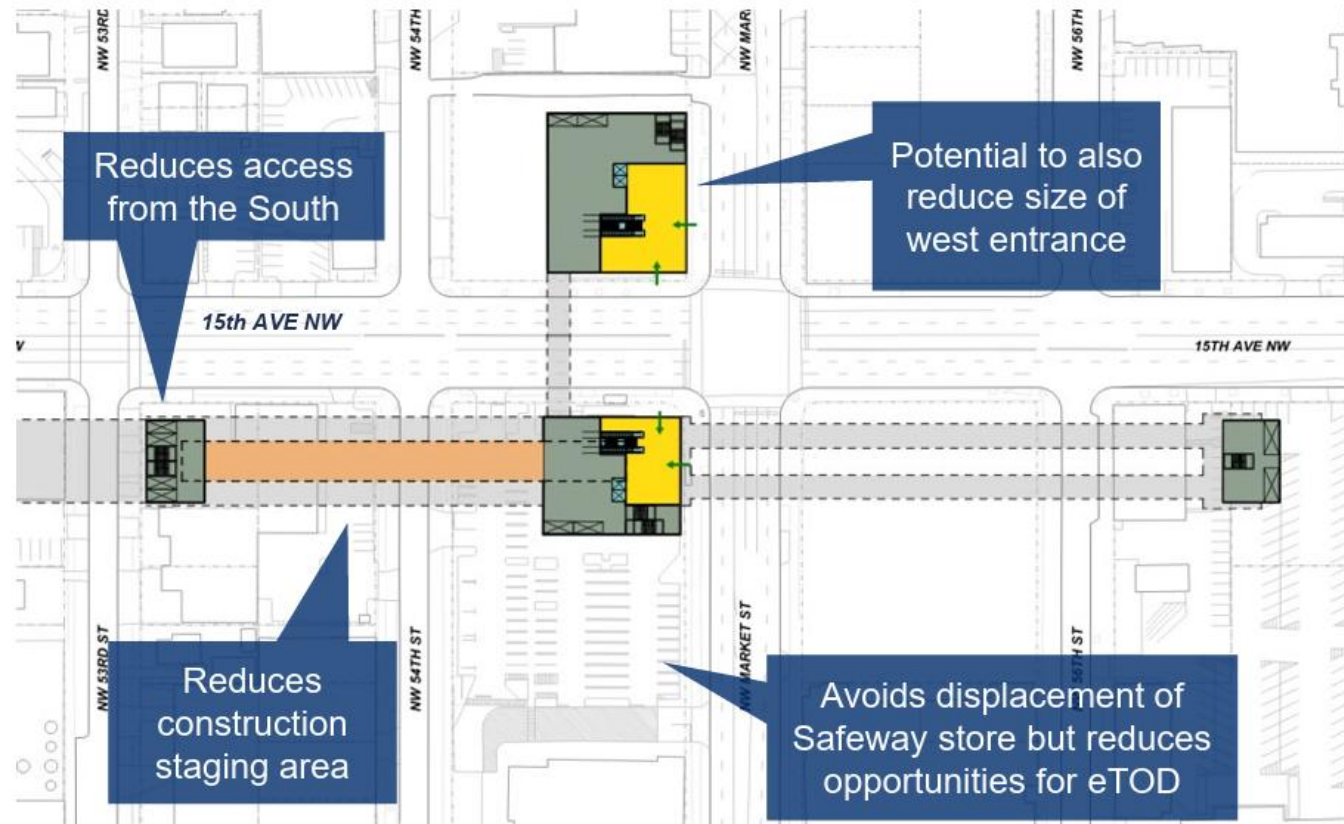

Cost delta compared to realigned financial plan:  
**+\$70 million** (or +\$30 million with optional smaller west entrance)



# 1 . Ballard Station

- Transportation – Station access
- Land Use - TOD opportunities

# 2. Elliott Guideways/Queen Anne Portal

- Visual impacts
- Land Use impacts – Fragmentation of development along the corridor

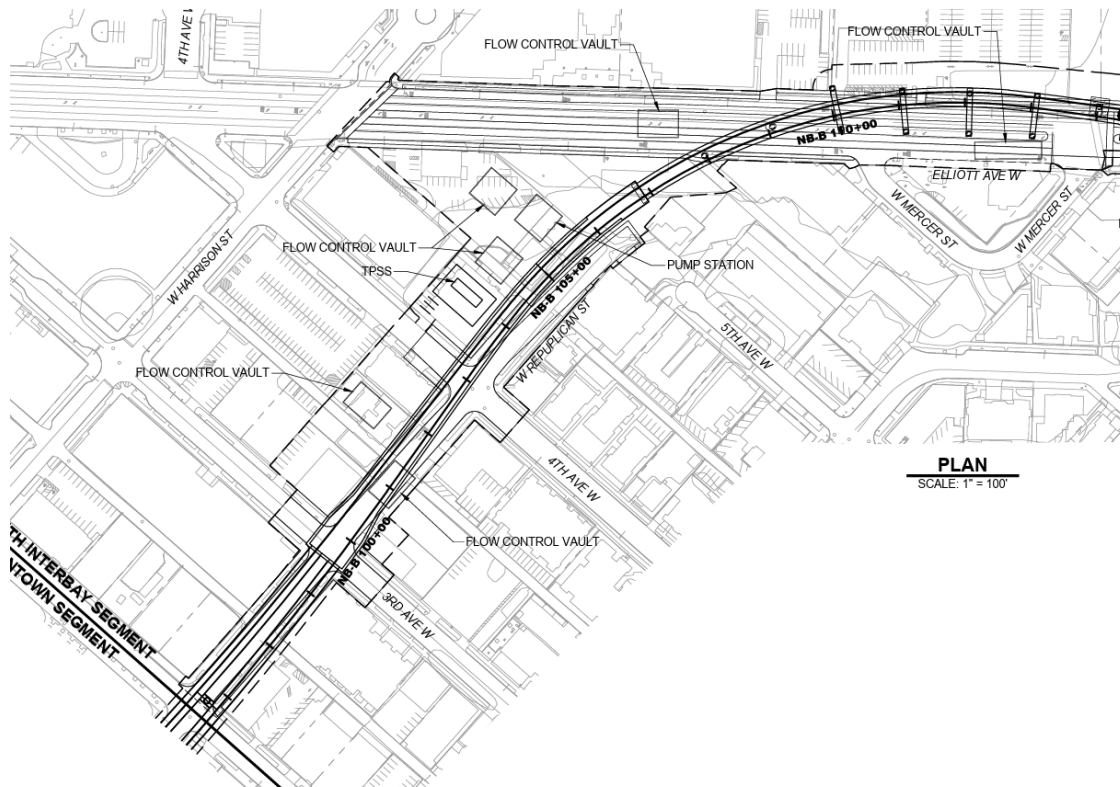

Source: City of Seattle, King County (2019, 2020, 2021).

**Alternatives**  
 Preferred Alternative  
 Preferred Alternative with Third-party Funding  
 Other Alternatives

**Alternative Profile**  
 Elevated  
 At-Grade  
 Station  
 New

**Legend:**  
 Segment Line  
 Railroad  
 Park  
 Key Observation Point (KOP) and View Direction  
 City of Seattle Designated Scenic Route  
 Location of impact to visual quality with one or more alternatives near areas with concentrations of sensitive viewers  
 XXXXX Approximate Areas with Concentration of Sensitive Viewers

**FIGURE 3- Visual Setting and Impact Ballard Link Extension South Interbay Segment West Seattle and Ballard Link Extension**

0 800 1600



### 3. Smith Cove / Seattle Center - Minimum Operating Segment

- Visual impacts
- Transportation – Transit connectivity, non-motorized access, integration with existing transportation infrastructure
- Land Use – TOD opportunities

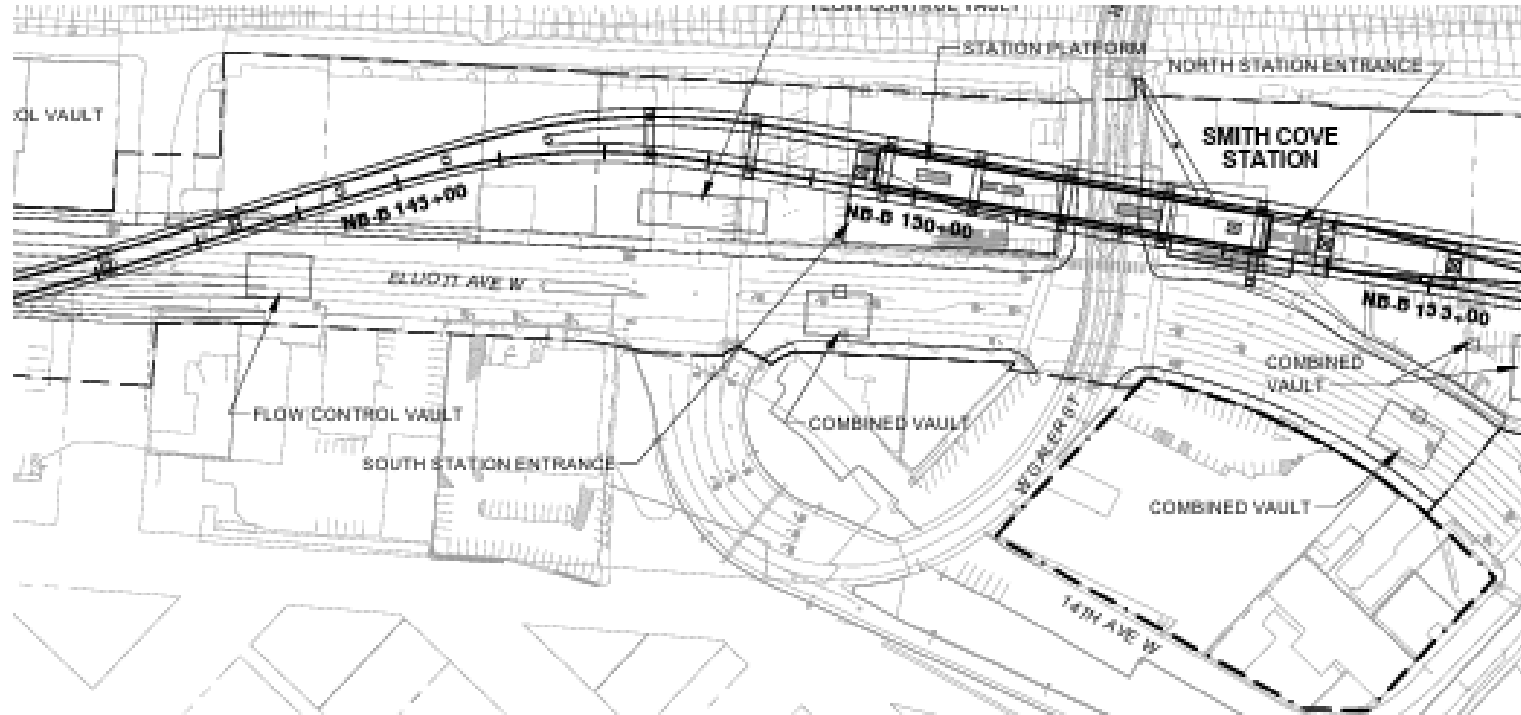
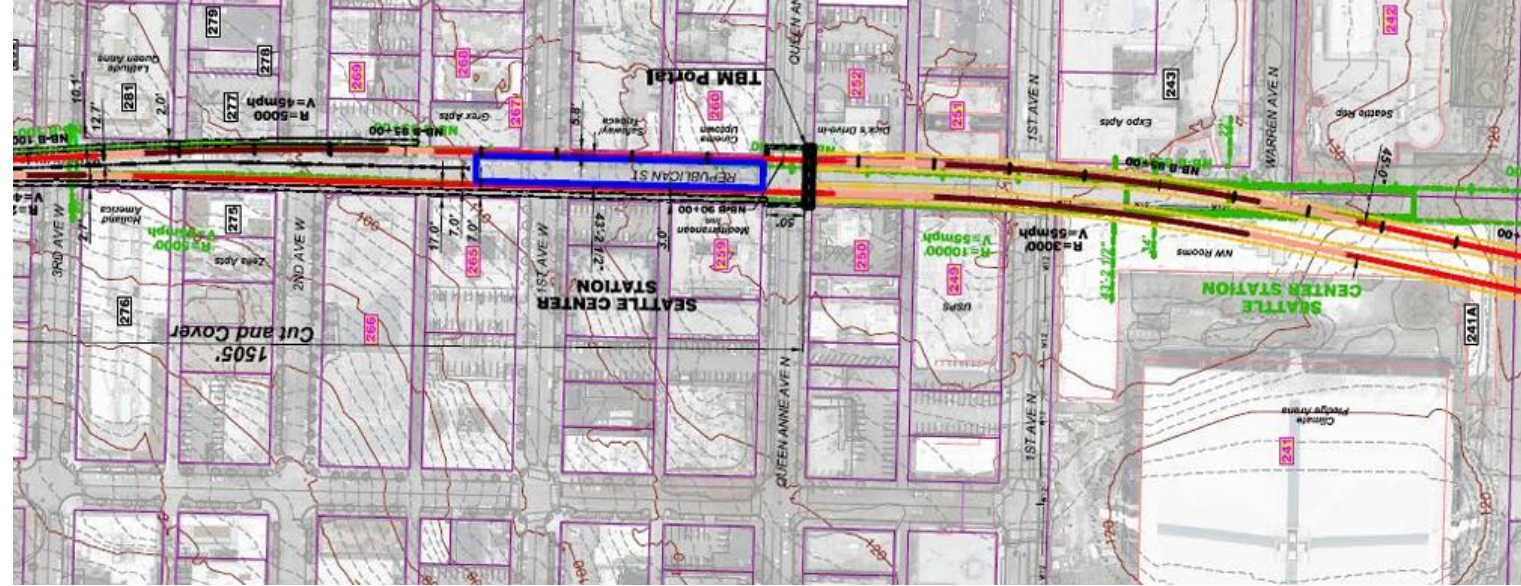

NOTE:  
STATION SHOWN SCHEMATICALLY. SEE DWG B13-ASP100

## 4. SLU and Denny Station Consolidation

---

- Transportation – Transit network opportunities, station access
- Land Use – TOD opportunities, public realm

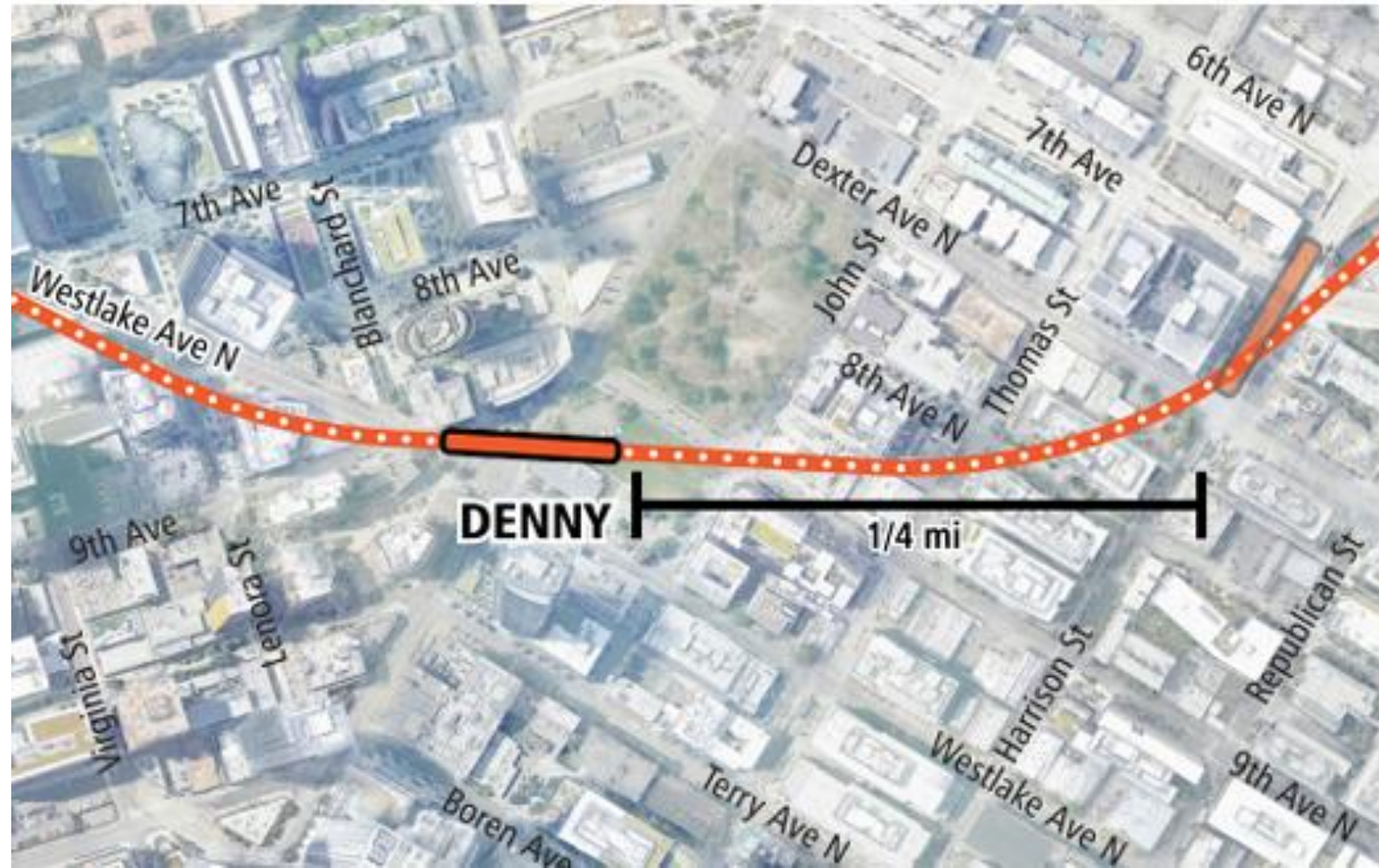

# 5. Westlake Station

- Transportation – Transit integration, transfer experience
- Land Use – Public realm

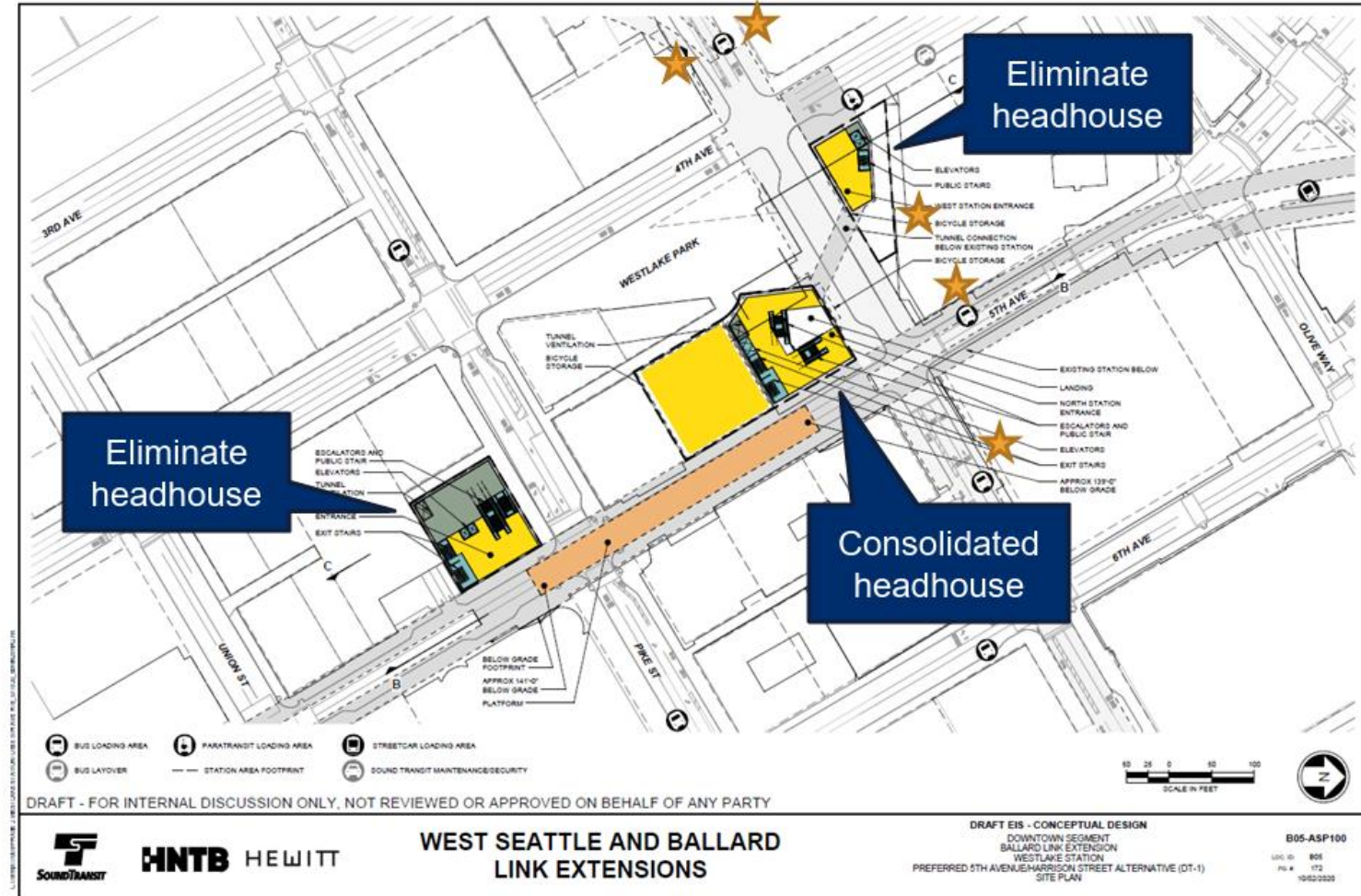

# 6. Midtown Station

- Transportation – Station access
- Social Justice – Access to regional facilities

Figure 13 Station North of CID Architectural Station Plan

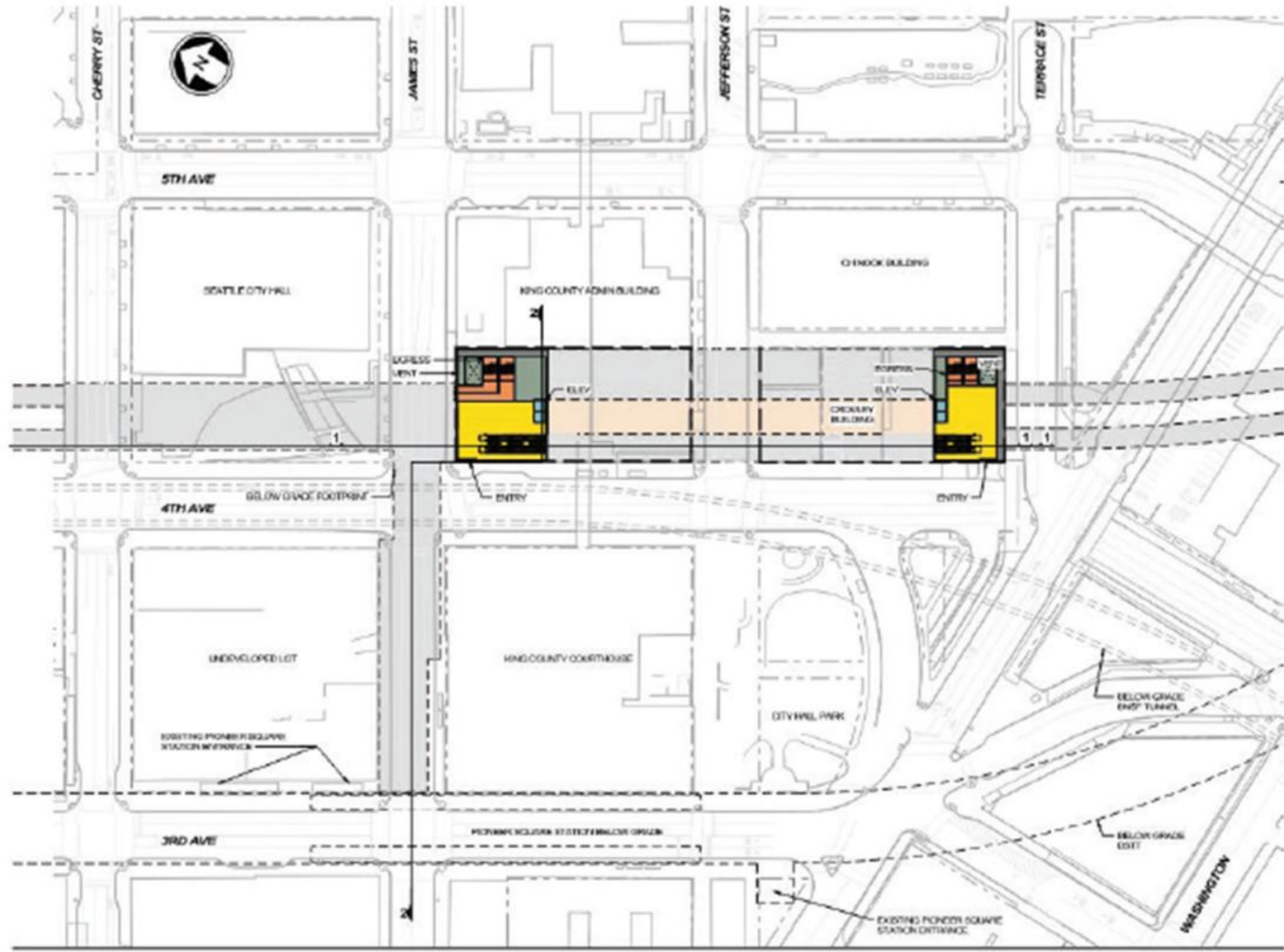

# 7. CID Station

- Transportation – Transit transfers, station access, impacts to transit and freight
- Social Justice – Impact minimization, land use impacts and opportunities
- Acknowledge International Special Review District will review



# SDC DEIS Commenting Process

---

SDC will begin evaluating publicly available plans before the DEIS is released.

---

Depending on change in issues (location of Minimum Operable Segment, SLU station elimination, Westlake impacts, etc), we may need to pivot following DEIS publication.

---

Following DEIS release and presentations by Sound Transit and City on 7 locations of interest, staff will prepare a memo on Commission letterhead to City project leadership.

---

City project leadership may integrate the SDC comments in the overall City BLE DEIS comments.

---

SDC staff may participate in overall City DEIS reviews if there is a topic where this is appropriate.

# Schedule prior to DEIS publication

---

## MARCH

- Present focused approach to full Commission for discussion and concurrence
- Confirm approach and topics with SDOT and ST
- Convene Light Rail subcommittee meetings
  - Review previous compiled comments on 7 focused locations
  - Determine scope/topics of comments for each location based on DEIS areas of analysis, to help refine ST and City presentations

## APRIL

- Sara Maxana 2Q presentation to address how City team can support SDC's DEIS reviews of the 7 focus locations.
- Determine if additional site visits are needed to add content or context

## MAY

- Present list of items of interest for each review location to full Commission for comment and concurrence
- Communicate list of items of interest at each location to ST and City

# Schedule after publication of DEIS

---

## JUNE

- Sound Transit presents DEIS information for the 7 focus locations
- City provides concurrent background information
- Presentations broken into two parts
- Meeting format will include questions from Commissioners and answers by ST and City; Commissioners will provide comments. No action will be taken. The comments will be formally adopted in the SDC DEIS comment memo.
- Prepare minutes following meeting

# Full Commission Briefings by Sound Transit and City Team

---

## Presentation 1:

- Ballard Station
- Elliott Guideways & Queen Anne portal
- Smith Cove / Seattle Center  
as Minimum Operating Segment

## Presentation 2:

- SLU and Denny station consolidation
- Midtown Station
- Westlake Station
- CID Station – Transit integration, non-motorized access

# After Briefings by Sound Transit and City

---

- Convene subcommittee to discuss staff draft of memo.
- Discuss refined draft with full Commission and vote on concurrence.
- Discuss draft memo with City ST Team.
- Finalize and send memo to City ST Team.