

3rd & Yesler Safety Improvements

Pioneer Square Preservation Board briefing



Seattle
Department of
Transportation

Core Team



Ian Macek
Project Owner and
Project Developer



Laurentiu Dusciuc
Project Engineer



Matthew Howard
Public Outreach Lead



Alex Phillips-White
Project Manager

Presentation Outline

- Project Background
- Project Goals
- Design Details
- Schedule
- Questions and Discussion



Background

- Part of One Center City Near-Term Action Plan
 - Co-funded by King County / Sound Transit / SDOT
- Public Life Study (2019)
- Interim Design (2022)
 - Paint and post to reduce crossing distances, create more space for pedestrians, and help buses move more efficiently
- Permanent Design (now)

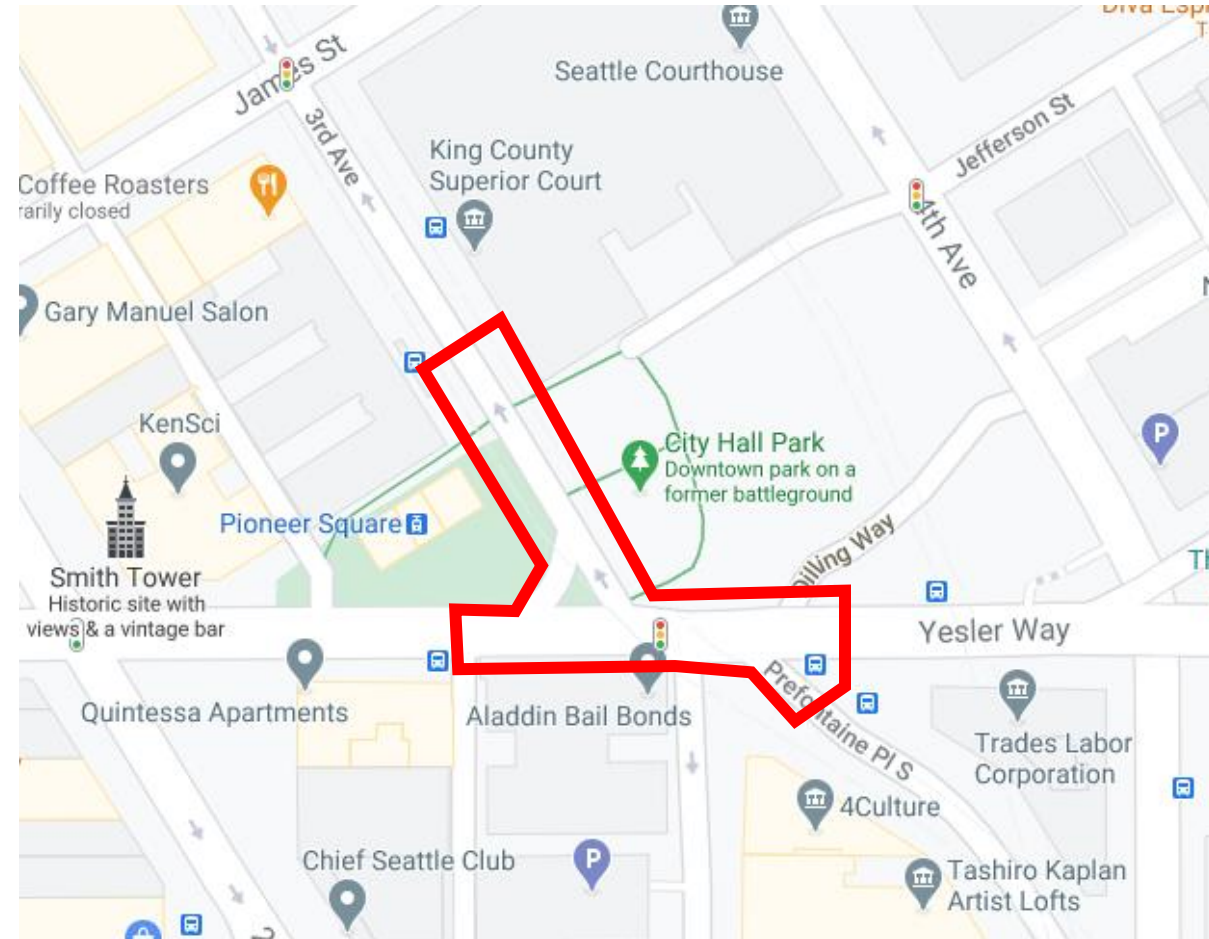

Project Goals

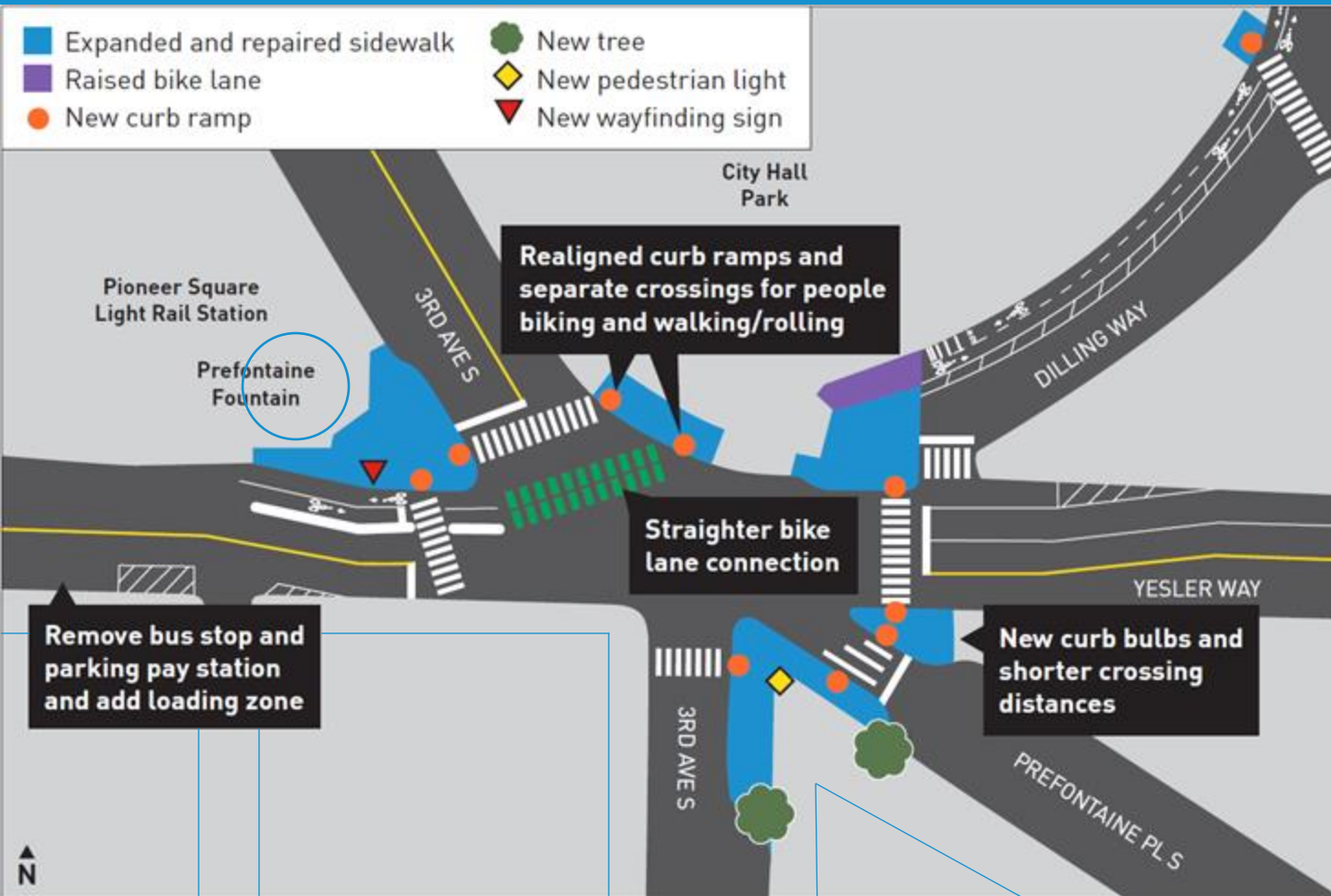

Expand pedestrian space

- Widen sidewalk at NW corner into slip lane and along Prefontaine Fountain
- Formalize interim curb bulbs
- Address tree root upheaval
- Explore opportunities to add trees

Improve bike and pedestrian crossing

- Straighten and separate bike and ped crossing
- Install bike signals

Art element to be explored as standalone project in coordination with adjacent Fortson Square

Sidewalks and curb lines

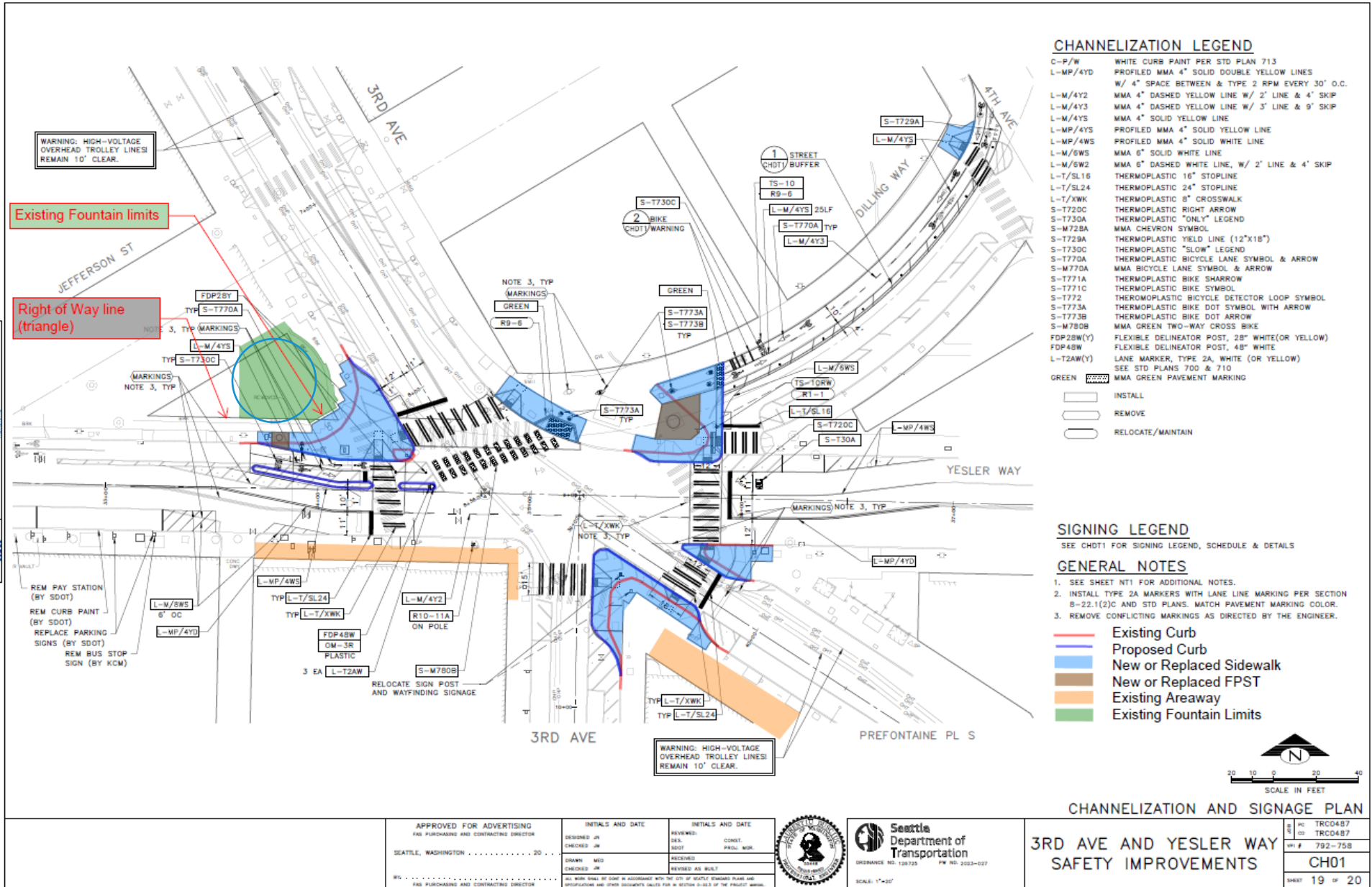

Notes:

- Remove slip lane with permanent curb bulb
- Align and shorten crossings
- Concrete bike buffer
- No granite curbs in project limits
- Cast Iron Detectable Plate at Ramps

Fountain and surrounding bricks

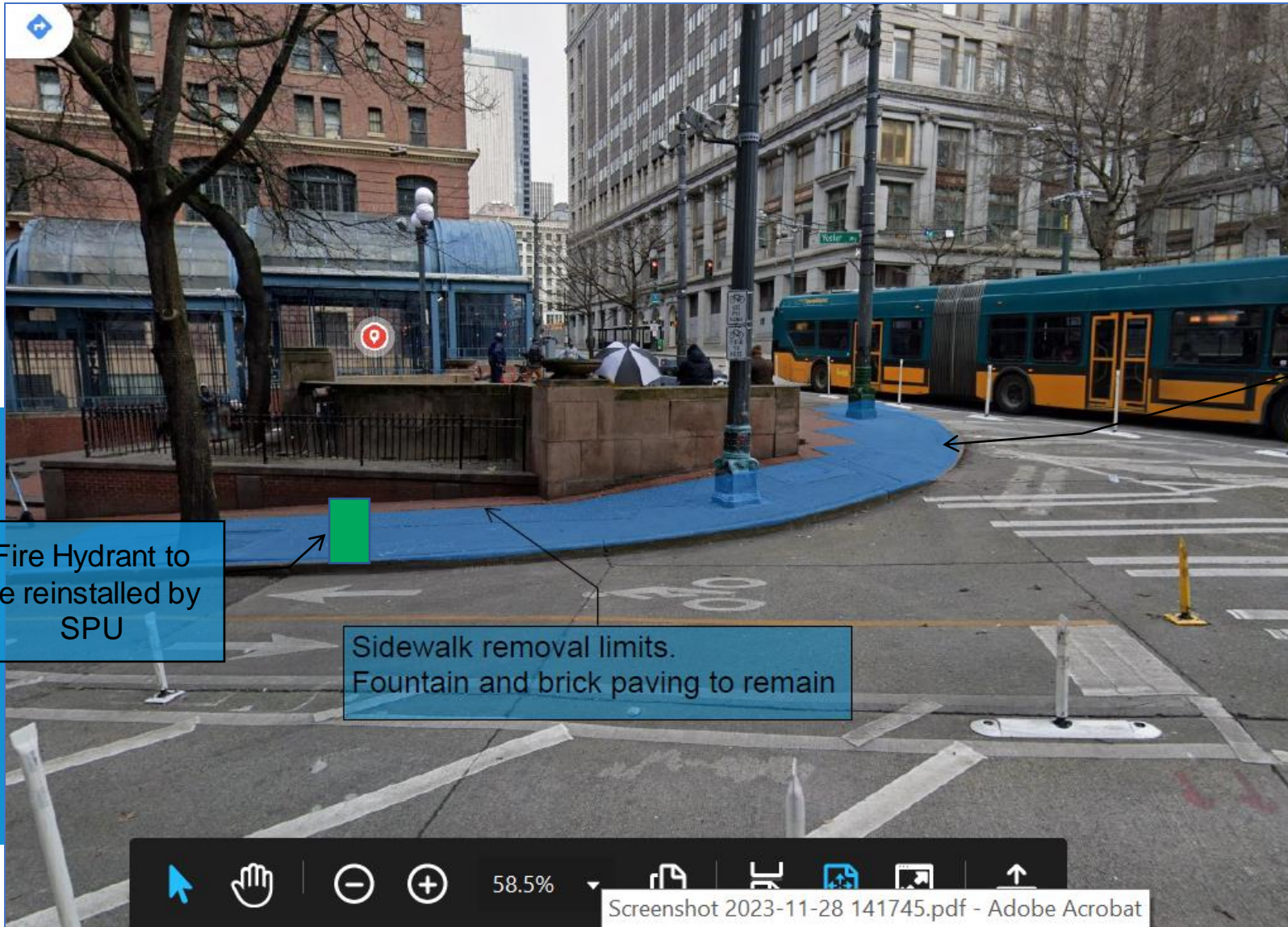

Notes:

- No impact to Prefontaine Fountain or brick sidewalk; no granite curbs in project
- Existing street trees and light poles to remain
- Street name inlays to be relocated to new sidewalk curb line
- Fire hydrant to be reinstalled by SPU

Street trees



FPST example in Board preferred Chestnut color

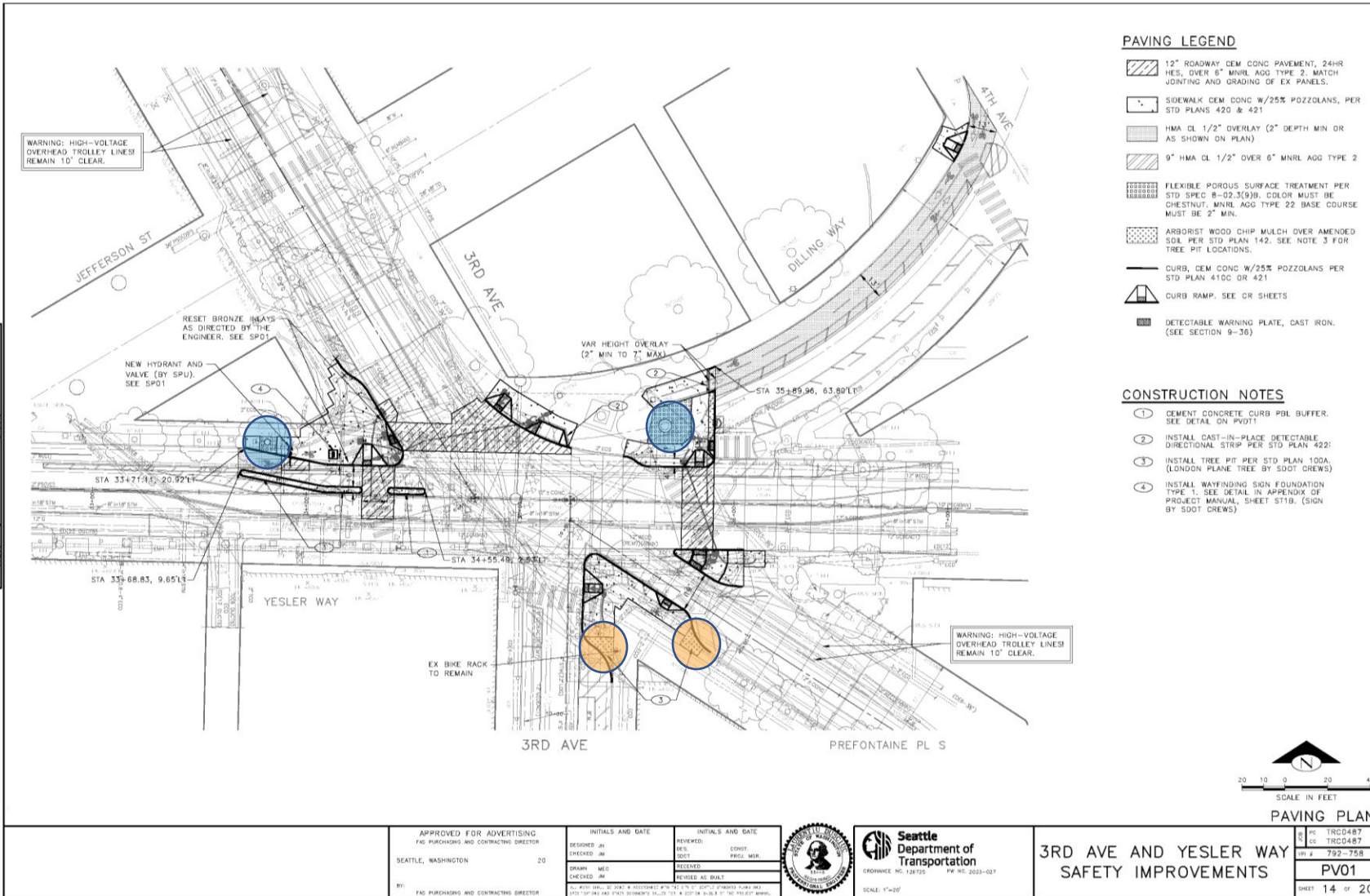

Notes:

- Flexible Porous Surface Treatment (FPST) to adhere to preferred District color
- Blue dot = install FPST around existing trees
- Yellow dot = new street tree

Street tree by City Hall Park

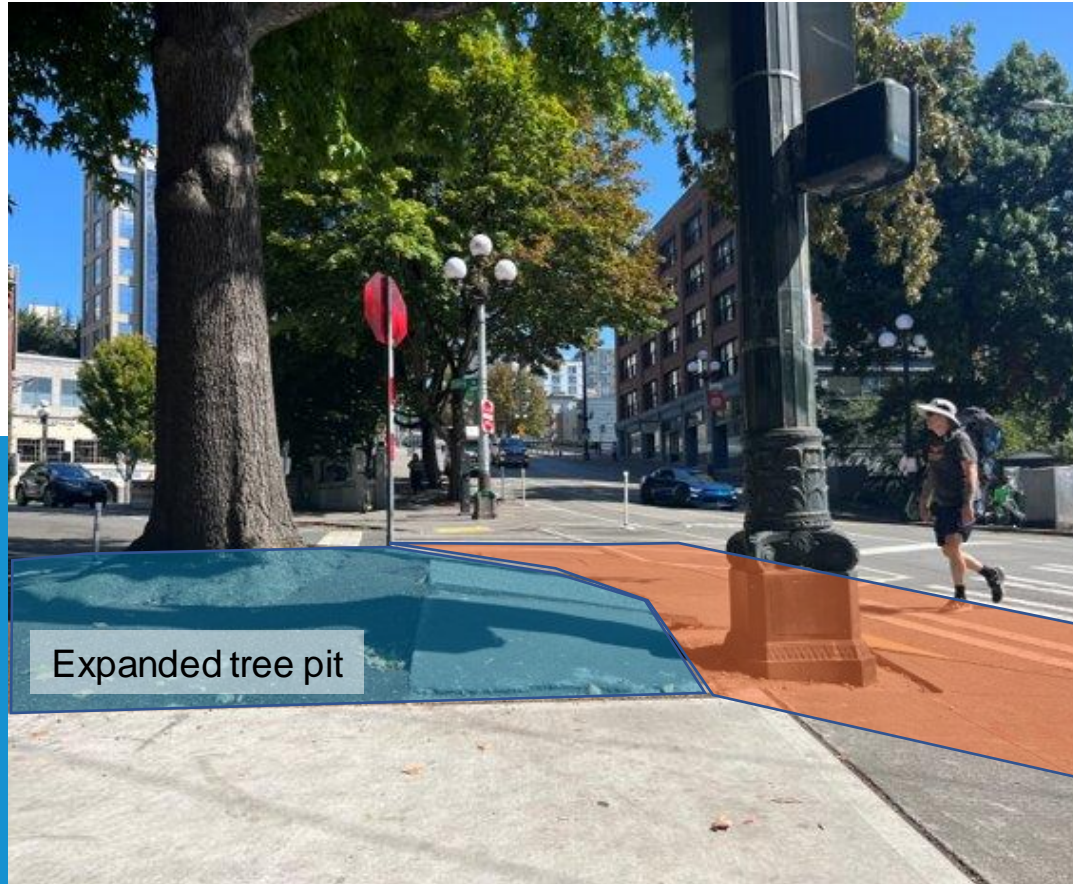

*Depictions not to scale

Street furniture

Wayfinding sign

Pedestrian light

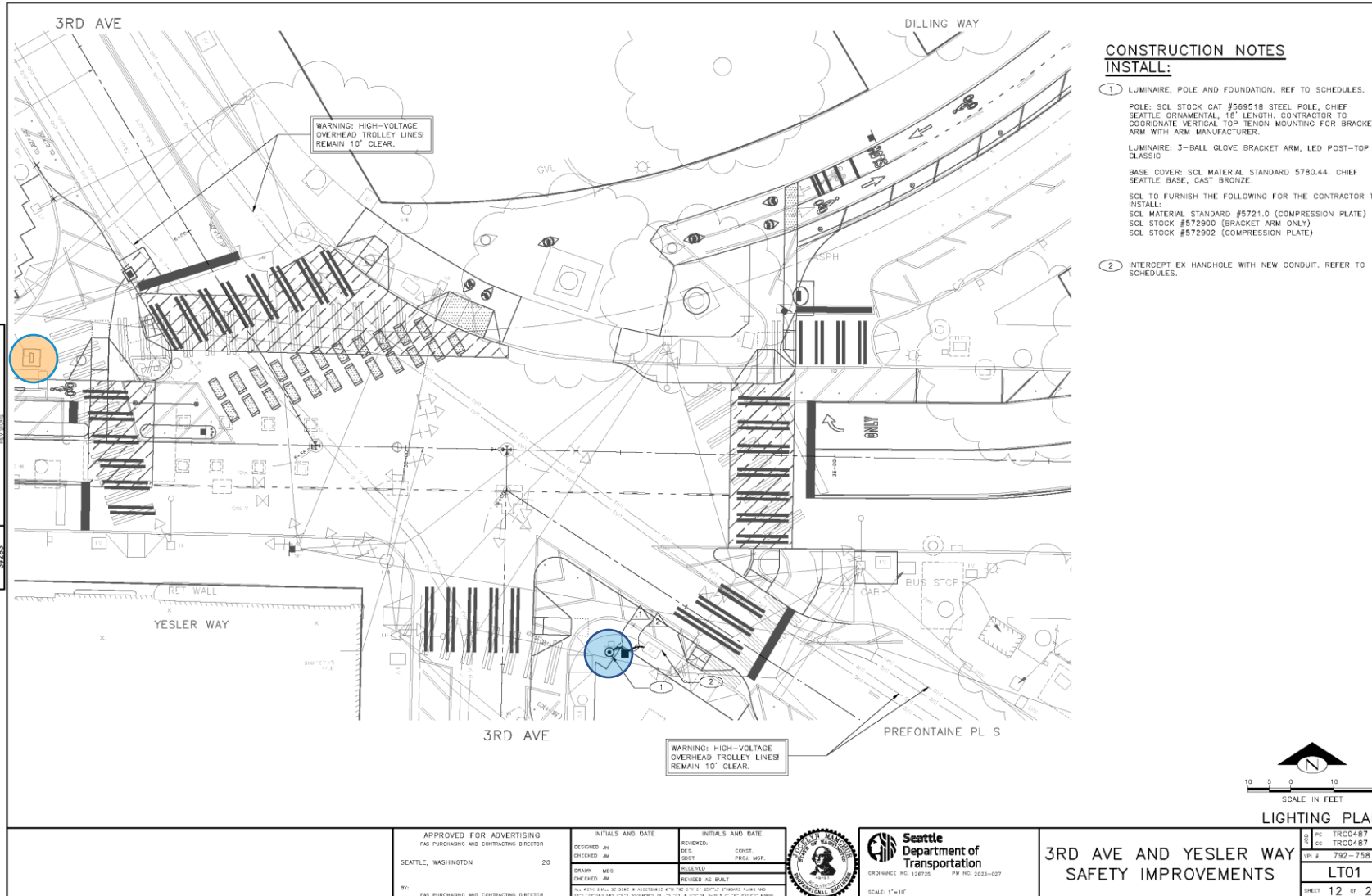
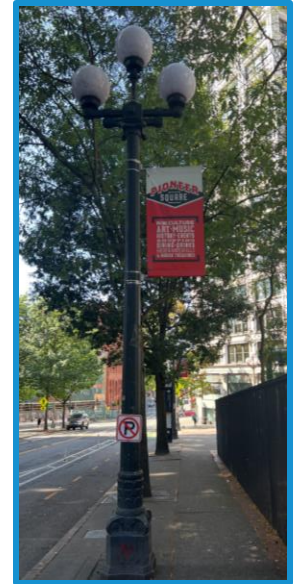

Notes:

- Yellow dot = new wayfinding sign
- Blue dot = new light pole

Street furniture



Expanded sidewalk area with wayfinding sign location*

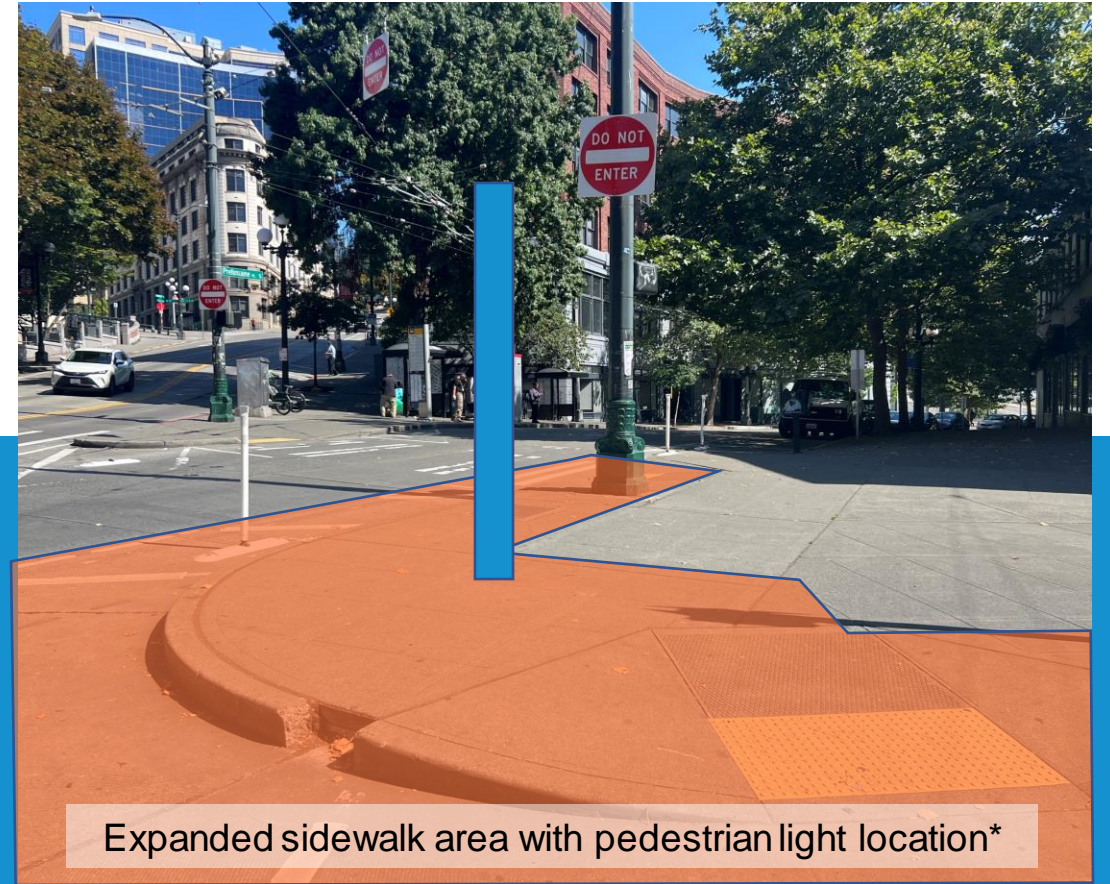

Expanded sidewalk area with pedestrian light location*

*Depictions not to scale

Channelization

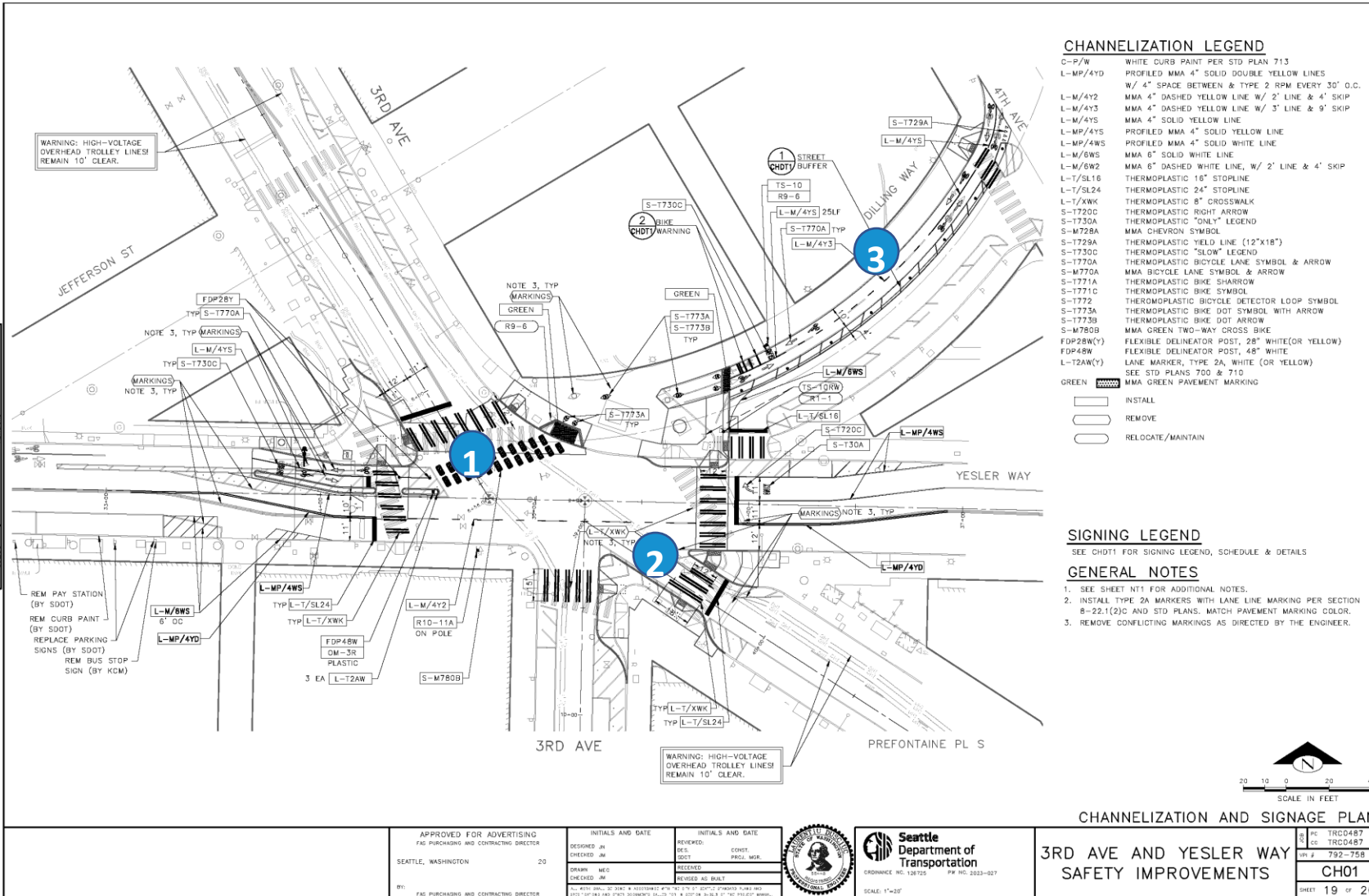

Notes:

1. Straighten and separate bike and pedestrian crossing
2. Shorten and align all pedestrian crossings
3. Pave and re-mark bike lanes on Dilling Way
4. No changes to traffic lane configuration

Signals

Bike signal (blue)



APS example (yellow)

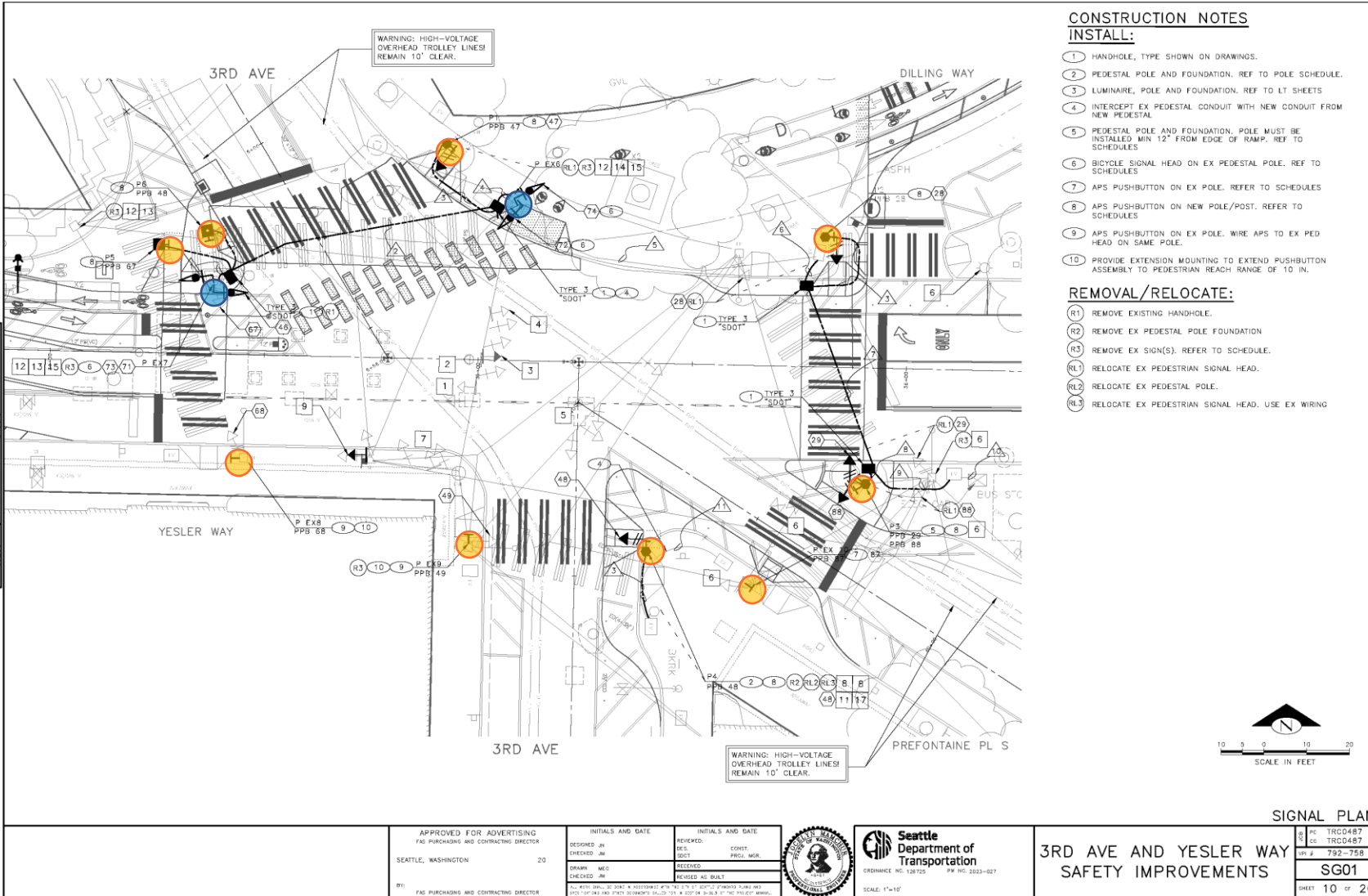

CONSTRUCTION NOTES INSTALL:

- 1 HANDHOLE, TYPE SHOWN ON DRAWINGS.
- 2 PEDESTAL POLE AND FOUNDATION. REF TO POLE SCHEDULE.
- 3 LUMINAIRE, POLE AND FOUNDATION. REF TO LT SHEETS
- 4 INTERCEPT EX PEDESTAL CONDUIT WITH NEW CONDUIT FROM NEW PEDESTAL
- 5 PEDESTAL POLE AND FOUNDATION. POLE MUST BE INSTALLED MIN 12" FROM EDGE OF RAMP. REF TO SCHEDULES
- 6 BICYCLE SIGNAL HEAD ON EX PEDESTAL POLE. REF TO SCHEDULES
- 7 APS PUSHBUTTON ON EX POLE. REFER TO SCHEDULES
- 8 APS PUSHBUTTON ON NEW POLE/POST. REFER TO SCHEDULES
- 9 APS PUSHBUTTON ON EX POLE. WIRE APS TO EX PED HEAD ON SAME POLE.
- 10 PROVIDE EXTENSION MOUNTING TO EXTEND PUSHBUTTON ASSEMBLY TO PEDESTRIAN REACH RANGE OF 10 IN.

REMOVAL/RELOCATE:

- R1 REMOVE EXISTING HANDHOLE.
- R2 REMOVE EX PEDESTAL POLE FOUNDATION
- R3 REMOVE EX SIGN(S). REFER TO SCHEDULE.
- RL1 RELOCATE EX PEDESTRIAN SIGNAL HEAD.
- RL2 RELOCATE EX PEDESTAL POLE.
- RL3 RELOCATE EX PEDESTRIAN SIGNAL HEAD. USE EX WIRING

Notes:

- Bike signals to be installed
- Accessible Pedestrian Signals (APS) to be installed per ADA
- Relocate existing pedestrian signals
- No changes to vehicular signals

SIGNAL PLAN

| | | |
|--|--|--|
| APPROVED FOR ADVERTISING: FAS PURCHASING AND CONTRACTING DIRECTOR SEATTLE, WASHINGTON 20 | INITIALS AND DATE DESIGNED BY CHECKED BY DRAWN MEC CHECKED BY | INITIALS AND DATE REVIEWED: RES. SDOT CONST. MGR. RECEIVED REVISED AS BUILT |
|--|--|--|

Seattle Department of Transportation
ORDINANCE NO. 126725 PP NO. 2023-027
SCALE: 1"=10'

3RD AVE AND YESLER WAY
SAFETY IMPROVEMENTS

| |
|----------------|
| PC TRC0487 |
| CC TRC0487 |
| REV # 792-758 |
| SG01 |
| SHEET 10 OF 20 |

Schedule

| Phase | Completion |
|--------------------|----------------|
| 30% Design | Q1 2023 |
| 60% Design | Q2 2023 |
| 90% Design | Q3 2023 |
| 100% Design | Q4 2023 |
| Ad/Bid | Q1 2024 |
| Construction | Q2 2024 |

We are here!

Questions?

Stay in touch:



Alex.Phillips-White@seattle.gov



206.376.2412



From the entire SDOT Team:
Thank you!

