



7/10/2024

Genna Nashem  
Pioneer Square Preservation District  
Department of Neighborhoods  
700 5<sup>th</sup> Avenue Suite 1700  
Seattle WA 98124

Palmer Court, 1000 1<sup>st</sup> Avenue South, 1<sup>st</sup> Floor

Ms. Nashem,

Thank you for conferring on this correction 7/9/24. With your direction and review we have:

- Provided a blank template showing Text & Graphic with dimensions
- Revised panel sign material to ACM, and provided attachment details
- Added the QR code url
- Shown how we will cover the Payscale signage
- Re-attached the property owner's authorization form
- Confirmed we will remove the landlord's temporary signage

Thank you,

A handwritten signature in black ink, appearing to read 'Erica Aeby', is written over a light gray grid background.

Erica Aeby (Owner Representative)  
Echo Alpha Projects  
206-303-0308



VICINITY MAP (SITE LOCATION DETAIL)

NON-ILLUMINATED PANEL SIGNS / VINYL WINDOW GRAPHICS

**PANEL SIGNS**



**TICKETS**



URL: <https://litimmersive.com/>

**LIT IMMERSIVE**

**WINDOW VINYL**



**LIT IMMERSIVE**

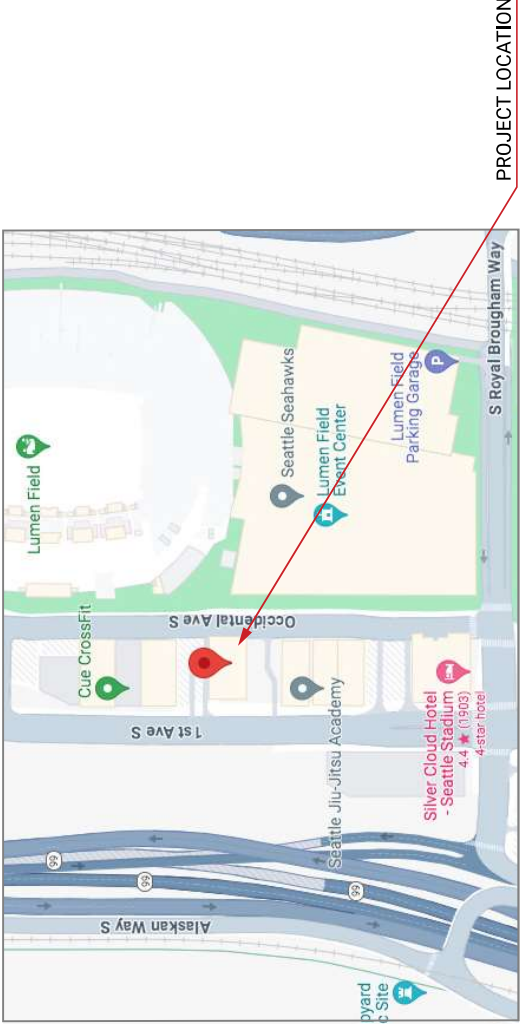
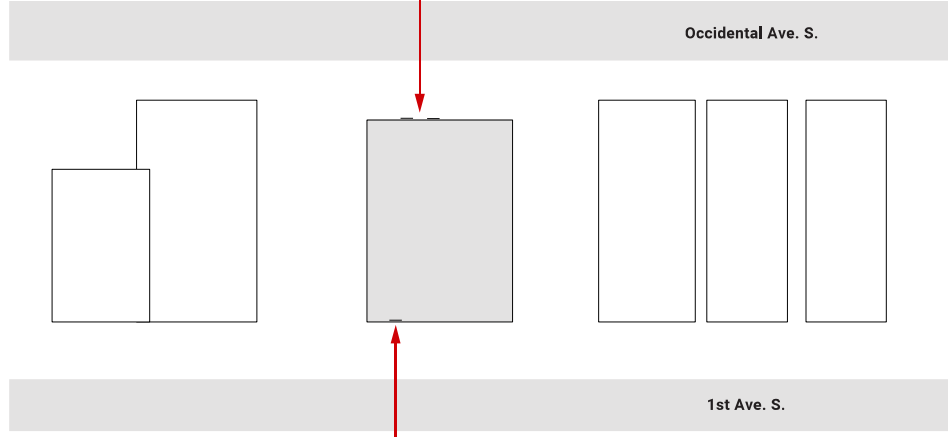

SITE ADDRESS: 1000 1st Ave S.  
Seattle, WA 98134

PARCEL NUMBER: 7666206676  
ZONE:

PROJECT: LIT IMMERSIVE  
CLIENT: LIT IMMERSIVE  
DATE: 06/25/24

**NOBLE NEON**  
206.708.6290  
studio@nobleneon.com

**PANEL SIGNS** 44" width x 54" height x ~1" depth

Aluminum (ACM) panels anchored onto MORTAR AREA ONLY of brick. Vinyl graphics applied to faces.

- A** 6mm ACM Paneling w/Vinyl Graphic Applied
- (2) PANELS**
- (12) COUNTERSUNK SCREWS (INTO MORTAR) @ EACH PANEL**

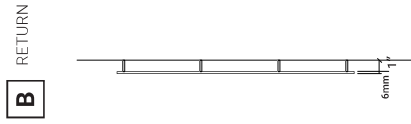
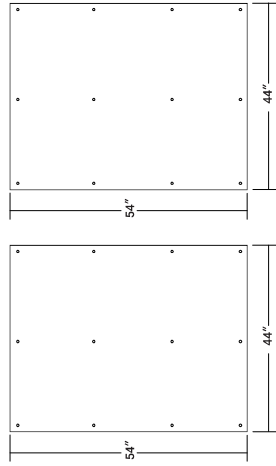

**ELEVATION** 1/8" = 1'-0"

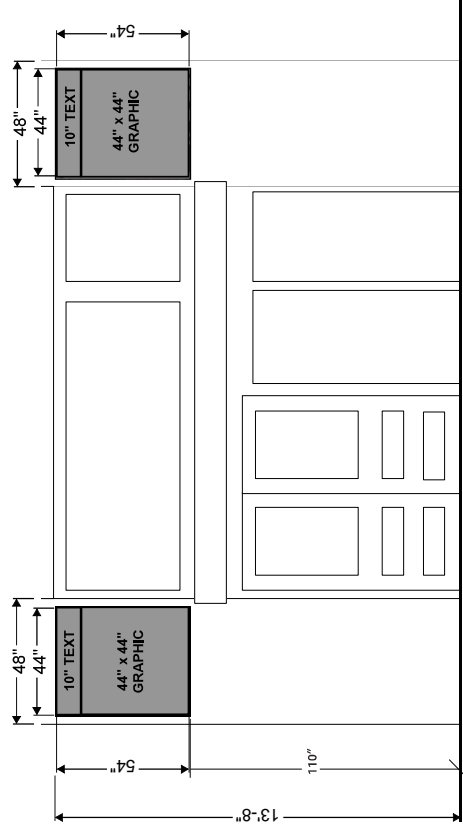

**INSTALLATION DETAIL**

Side View

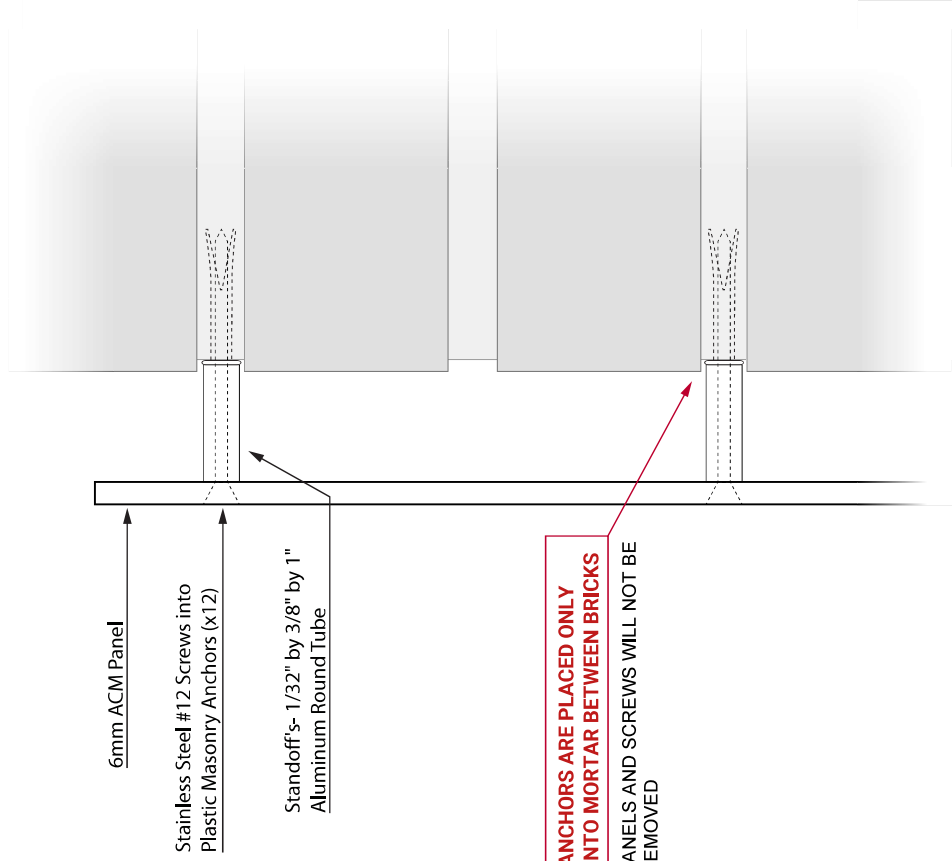

PROJECT: LIT IMMERSIVE  
 CLIENT: LIT IMMERSIVE  
 DATE: 06/25/24

206.708.6290  
 studio@nobleneon.com

**NOBLE NEON**

PARCEL NUMBER: 7666206676  
 ZONE

SITE ADDRESS: 1000 1st Ave S.  
 Seattle, WA 98134

**PANEL SIGNS** OCCIDENTAL AVE. S. SIDE

TEMPORARY VINYL GRAPHICS ON PERMANENT ACM PANEL

**PAINTED ACM PANEL ATTACHED TO HIDE THE EXISTING "PayScale" TEXT**

**Panel Size = 10" x 48"**

(Adhered via exterior rated 3M brand double sided adhesive tape)



LANDLORD'S TEMPORARY SIGNAGE WILL BE REMOVED

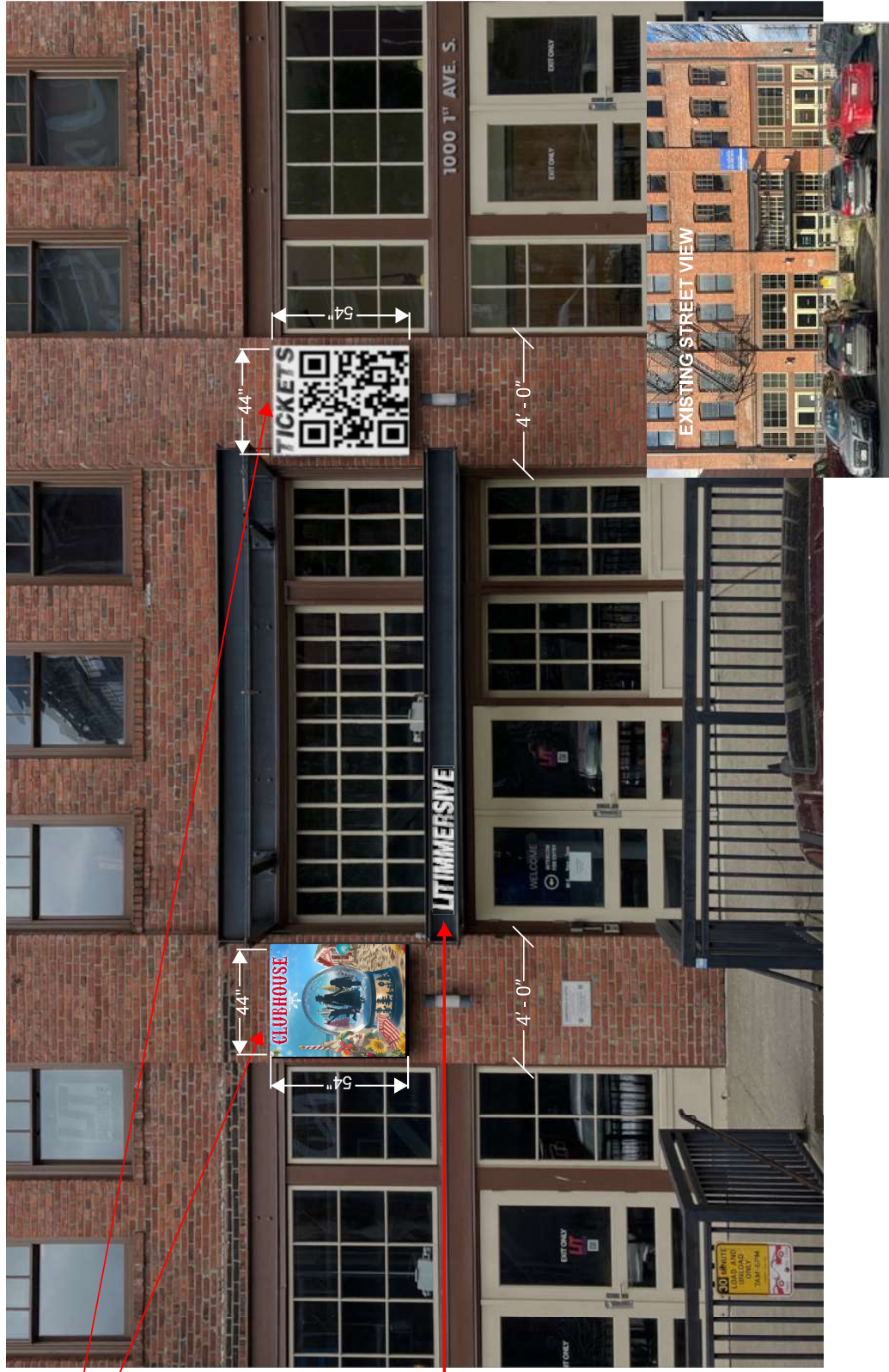

PROJECT: LIT IMMERSIVE  
CLIENT: LIT IMMERSIVE  
DATE: 06/25/24

PARCEL NUMBER: 7666206676  
ZONE:

SITE ADDRESS: 1000 1st Ave S.  
Seattle, WA 98134

**NOBLE NEON**  
206.708.6290  
studio@nobleneon.com

**PANEL SIGNS** OCCIDENTAL AVE. S. SIDE

\* ACM PANELS AND ANCHORS THEMSELVES WILL BE PERMANENT (not taken in and out of mortar repeatedly), AND ONLY THE VINYL GRAPHIC WILL BE CHANGED PERIODICALLY

\* PANELS PAINTED BLACK w/VINYL GRAPHIC APPLIED



ACM PANEL COVERS EXISTING PAYSCALE LOGO, ADHERED WITH OUTDOOR RATED TAPE, AND LIT IMMERSIVE VINYL LOGO APPLIED TO FACE

**NOBLE NEON**  
206.708.6290  
studio@nobleneon.com

PROJECT: LIT IMMERSIVE  
CLIENT: LIT IMMERSIVE  
DATE: 06/25/24

PARCEL NUMBER: 7666206676  
ZONE:

SITE ADDRESS: 1000 1st Ave S.  
Seattle, WA 98134

**WINDOW VINYL** 1st Ave S. Side

\* "LIT IMMERSIVE" LOGO GRAPHIC 10"

\* ROTATING SHOW POSTER  
(OBSCURES 25% OF A SINGLE WINDOW) → 3 x 5 = 15sf used  
9 x 7 = 63sf  
63 / 4 = 15.75sf available

\* THIS IS A TEMPLATE SCALED TO AVAILABLE SPACE ON THIS WINDOW THAT CHANGES OUT QUARTERLY WITH NEW SHOW INFO

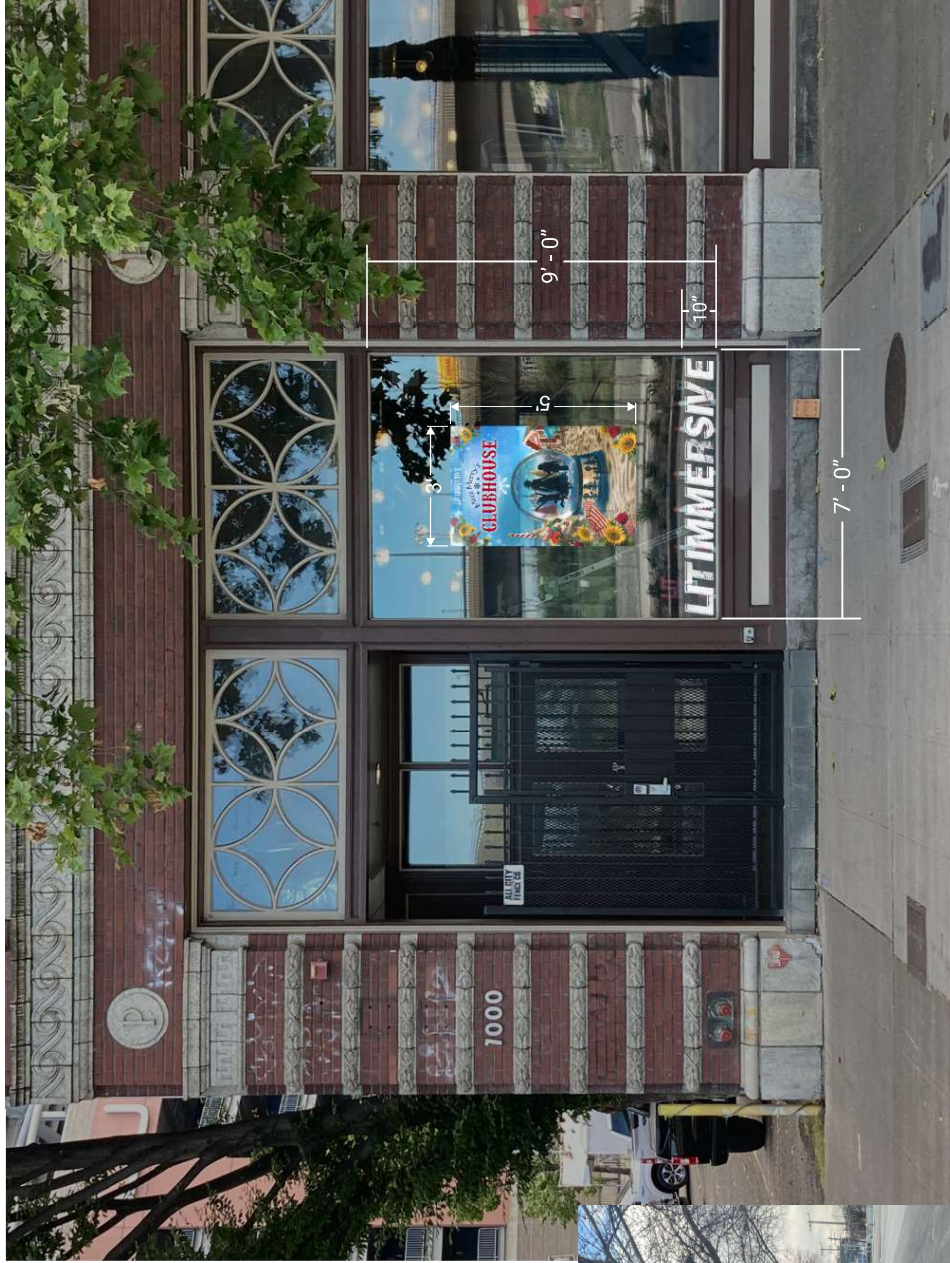

EXISTING STREET VIEW LOCATION



**NOBLE NEON**  
206.708.6290  
studio@nobleneon.com

PROJECT: LIT IMMERSIVE  
CLIENT: LIT IMMERSIVE  
DATE: 06/25/24

PARCEL NUMBER: 766G206676  
ZONE:

SITE ADDRESS: 1000 1st Ave S.  
Seattle, WA 98134

# POTENTIAL SHOW GRAPHIC EXAMPLES



# 6MM ACM PANEL & FASTENERS

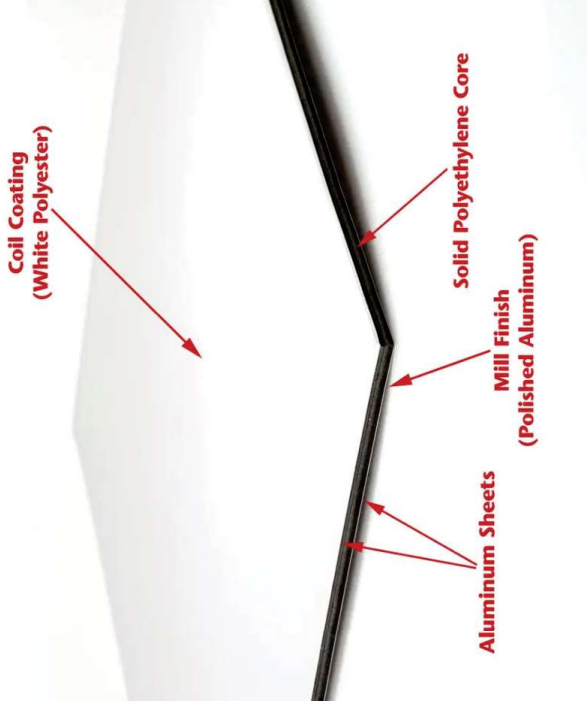

3/8" STANDOFF TUBE



MASONRY ANCHOR & #12 SCREW



OUTDOOR RATED DOUBLE STICK TAPE  
(COVERING EXISTING PAYSCALE LOGO)





I hereby affirm that I am the owner of the property located at:

Property Address/Location: 1000 1st Ave. S.

City: Seattle State: WA Zip Code: 98134

**By signing below, I verify that I have reviewed the proposed project/activities and authorize the individual identified in the following section to act as my authorized agent with regard to the Certificate of Approval Application (including requests for preliminary project briefings) made to City of Seattle’s Historic Preservation Program for the project/activities described below.**

Project/Activity for which Application (or briefing request) is being made: \_\_\_\_\_

Signage for LIT Immersive at Palmer Court Level 1

Per Alpha , Echo, Projects signage proposal dated 05/10/24

Signature of Owner:  Date: 05/16/24

Printed Owner Name: Ken Clark, American Life Inc.

Owner Mailing Address 2450 6th Ave S, Ste 200

City: Seattle State: WA Zip Code: 98134

Owner Email Address: ken.clark@americanlifeinc.com

Printed Name of Permit Applicant/  
Owner’s Authorized Agent: Erica Aeby

Address: 1000 1st Ave. S. First Floor

City: Seattle State: WA Zip Code: 98134

Applicant Email Address: erica@echoalphaprojects.com

Signature of Applicant/Agent:  Date: 5/16/24