

**Pike Place Market
Shug's Soda Fountain & Ice Cream
Relocation Design
1530 Pike Pl Triangle Building**

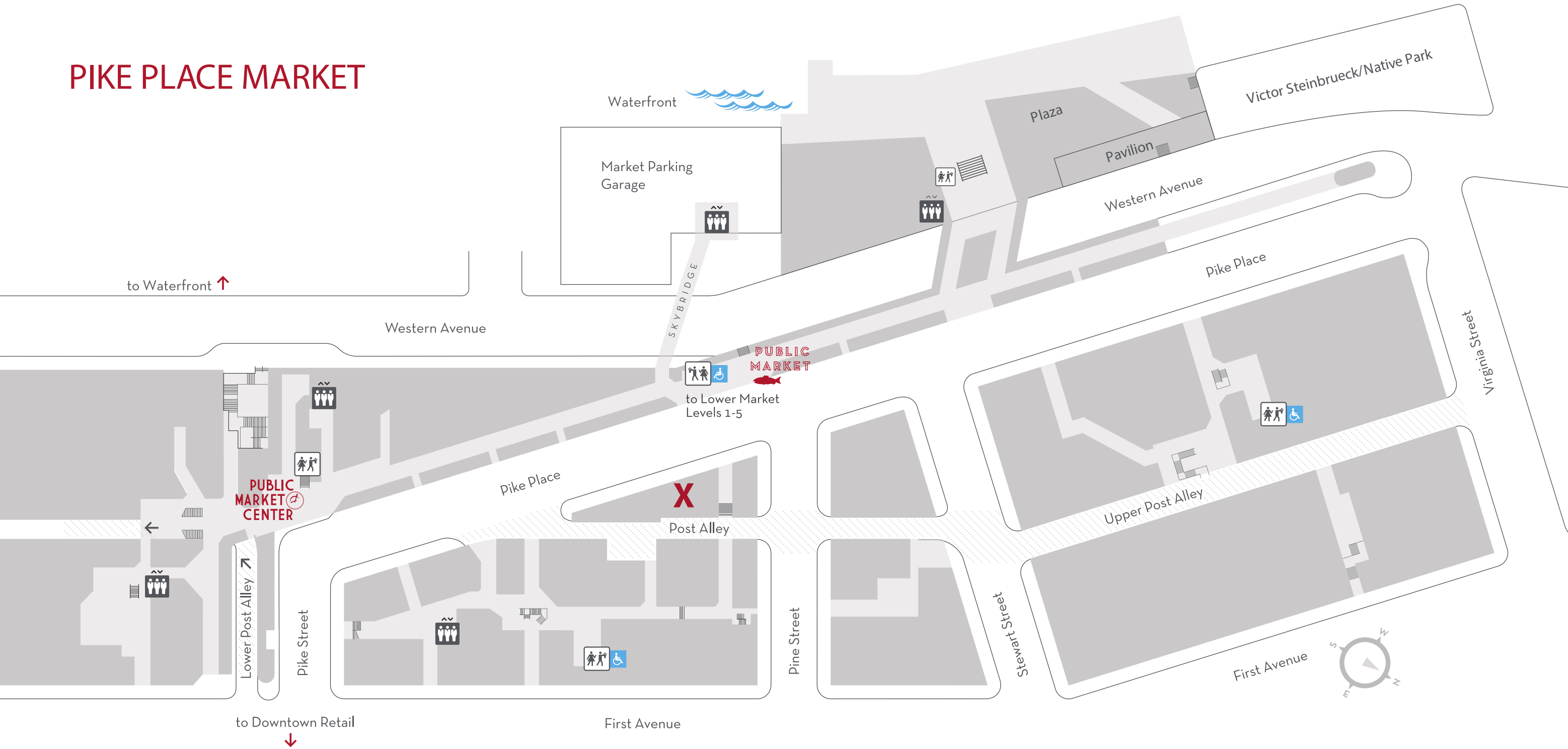

PIKE PLACE MARKET



Front of House Top View



Existing Exterior View

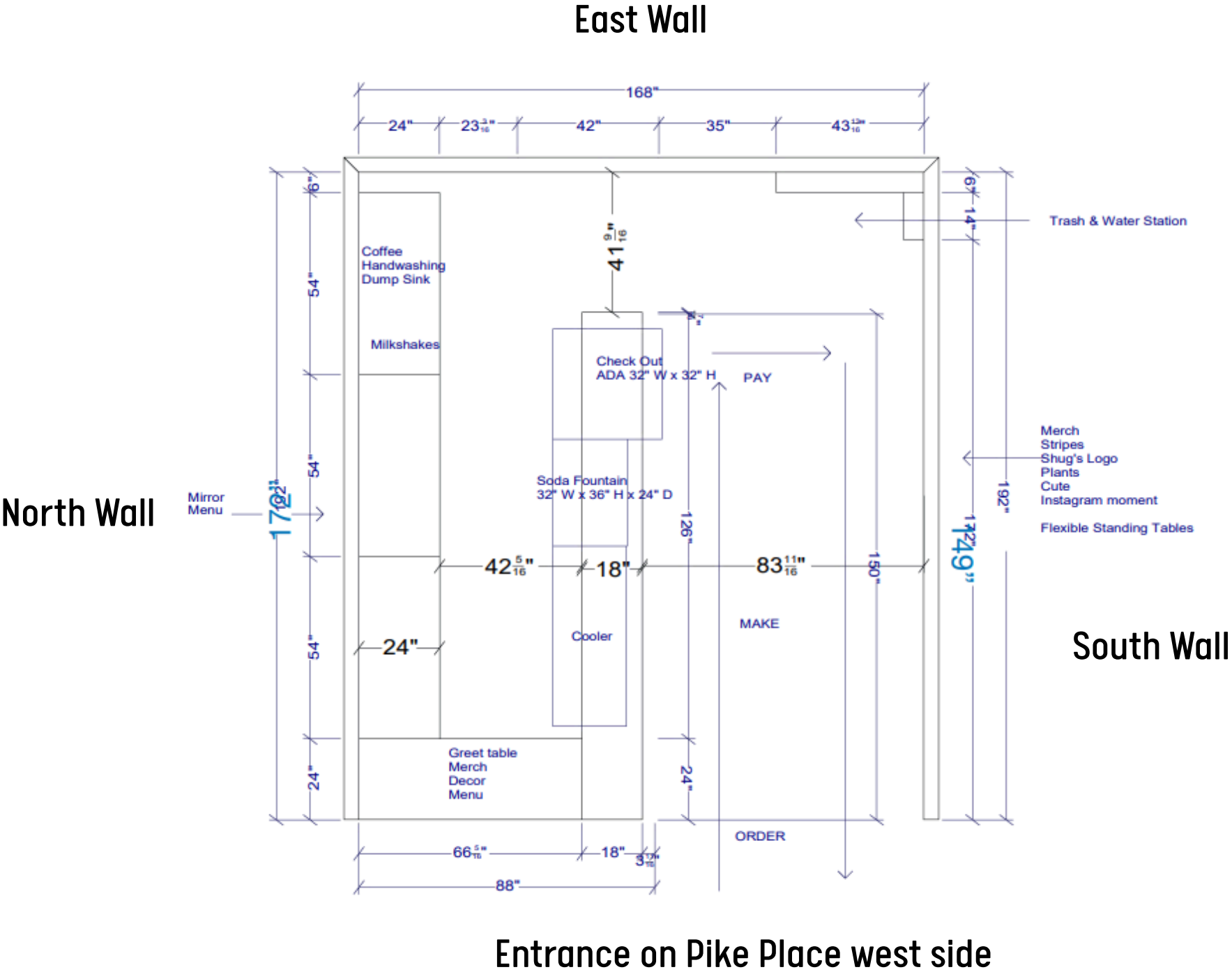

Soda Fountain Design

North side of the entry will be dedicated to the soda fountain, the ordering counter, service, and the back bar where all ice cream novelties, drinks, and treats will be prepared. The right side will be for guests to queue, enjoy treats, and look at menus.



Existing - North Wall

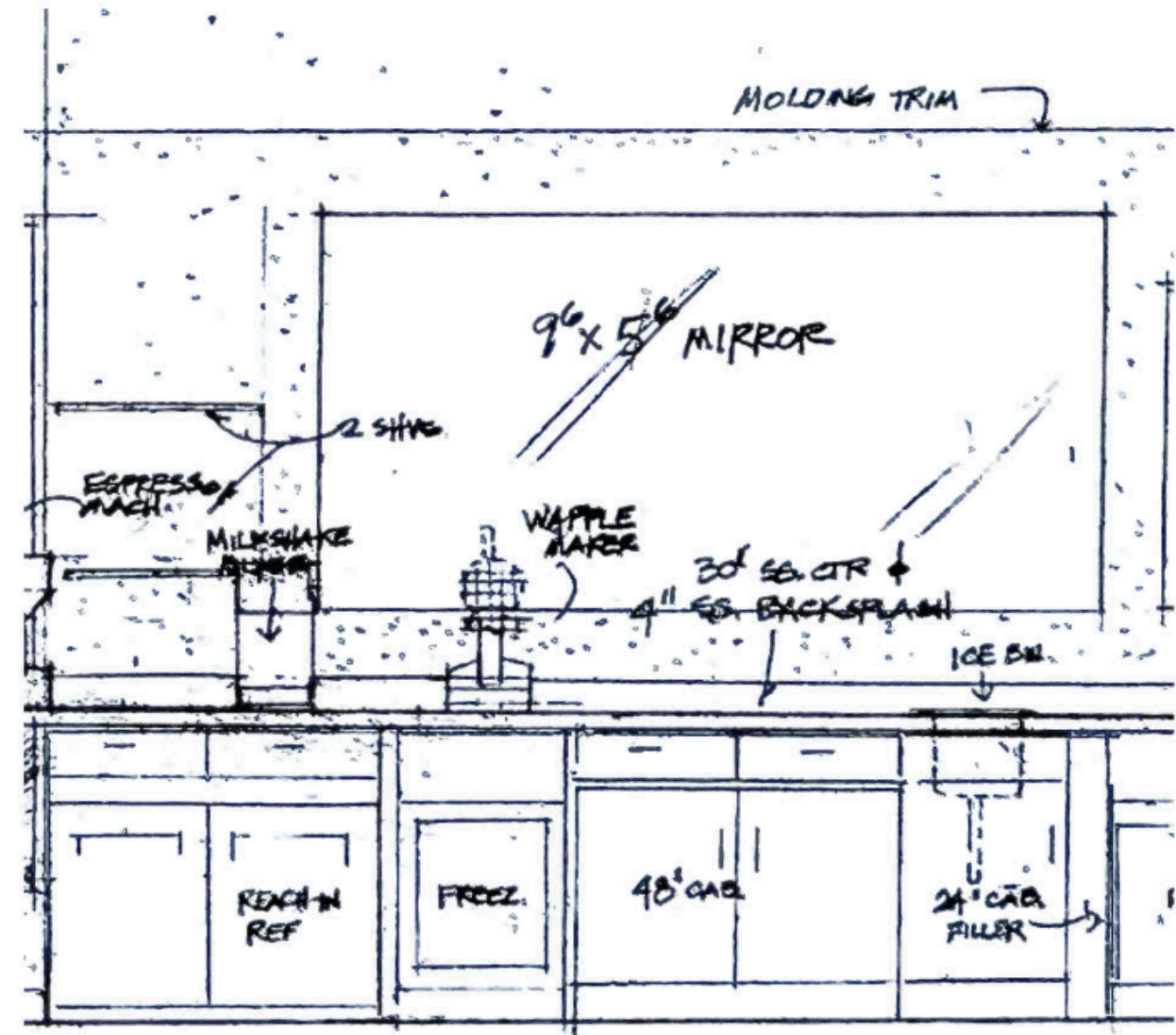

Back Bar Elevation North Wall

Soda Fountain Design

Custom cabinets, countertops, backsplash and mirror back bar:

Painted cabinet grade plywood or hardwood Sherwin William Dover White 6385

Countertops & Backsplash Stratus Blue Honed Back Bar and Ceaserstone Pure White Honed
Front Bar

Mirror - Back Bar 3/16" attached with mirror mastic

Seating - George & Willy white flexible wall mounted standing tables installed on south wall -
color white

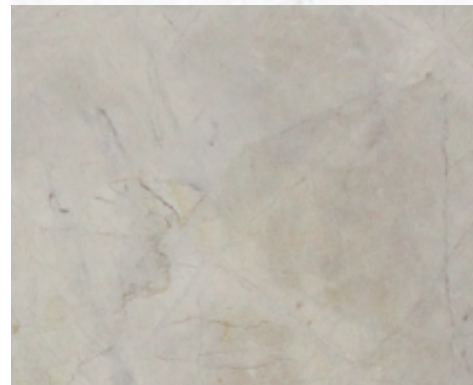

Stratus Blue

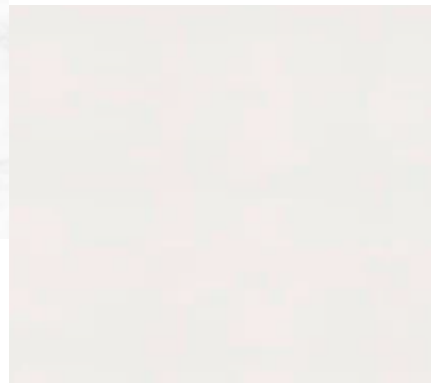

Ceaserstone Pure White



George & Willy wall mount table

23.6" dia. 18.11" T

Material: aluminum, zinc-coded steel

Removable bracket 4" W X 5.4" H

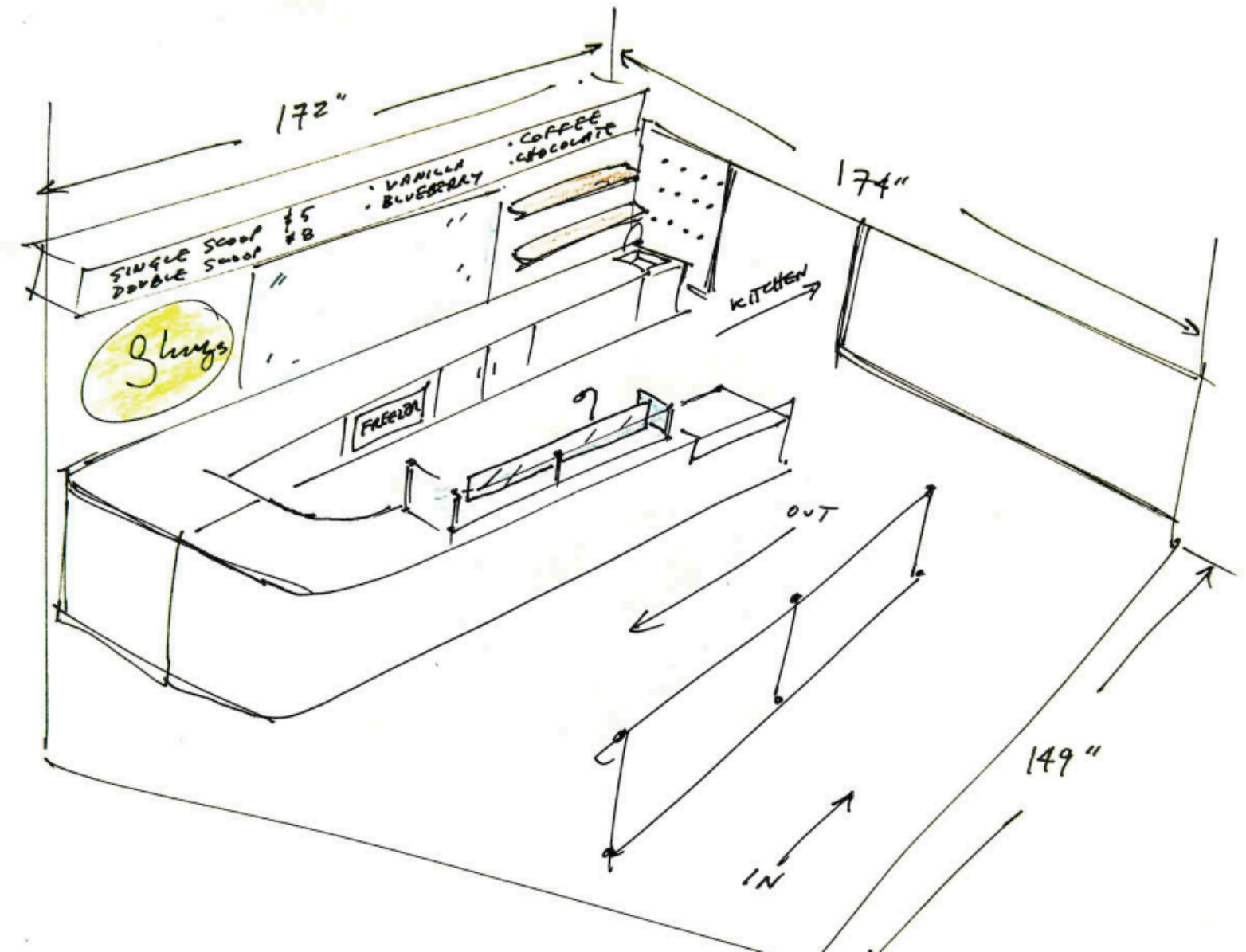

Soda Fountain 3D Concept Rendering

Soda Fountain Design

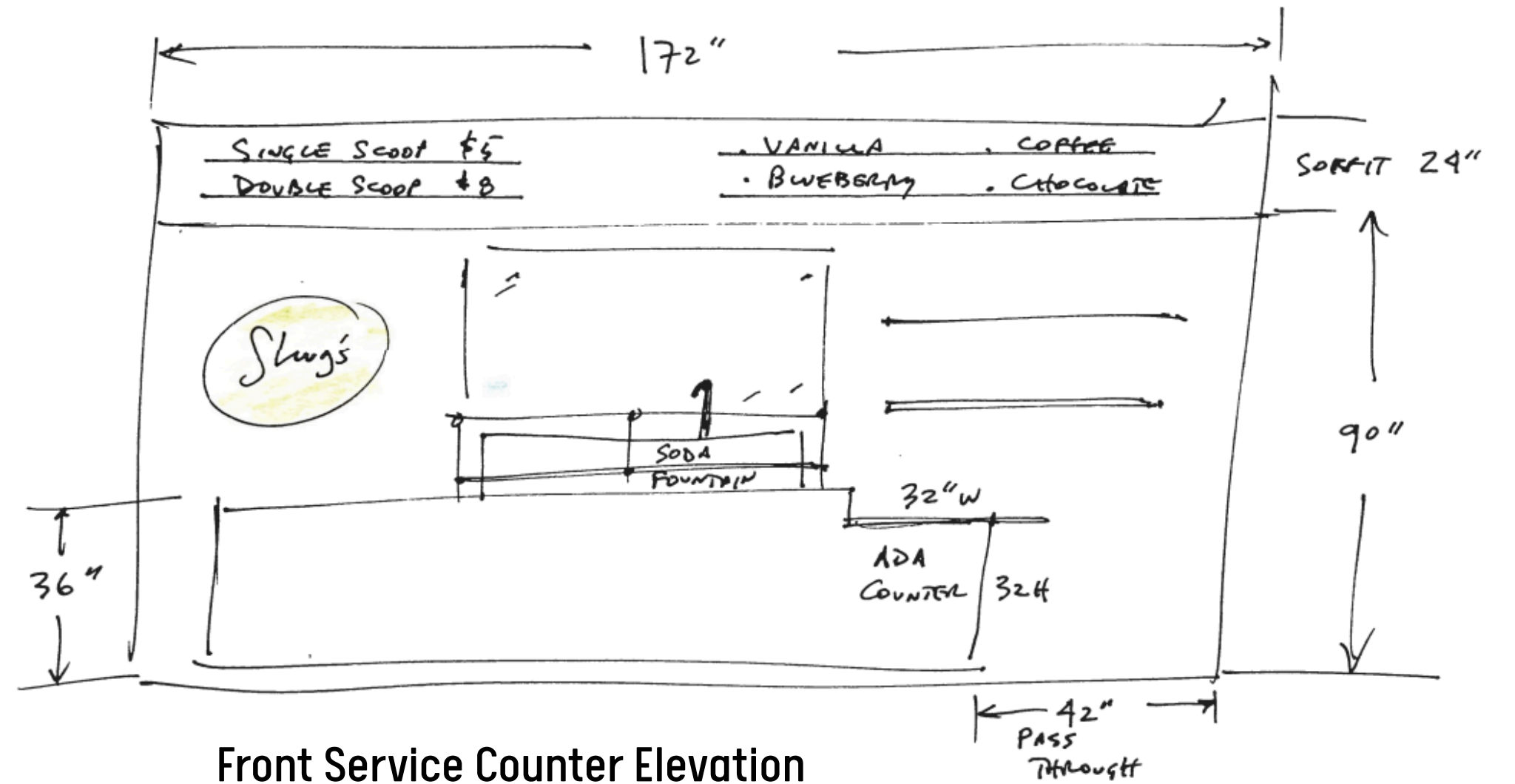

Front Service Counter Elevation

Restored Vintage Easy Frost 1960's Soda Fountain. The unique focal point of shop will be built-in.

Painted Feature Wall

South wall will be painted with Shug's mint green Pantone color 556-C and Sherwin Williams Dover White SW 6385.



PANTONE®
PQ-556C

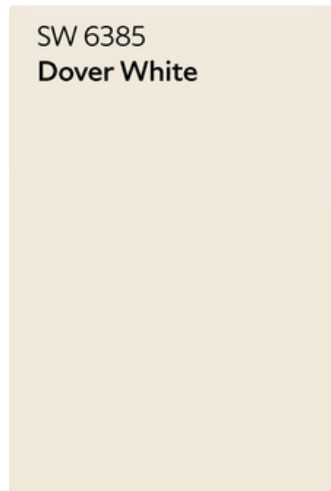

SW 6385
Dover White



Existing South Wall



Wall Paint Color

Replace current dark paint with a light, bright white; Dover White by Sherwin Williams all throughout the space.

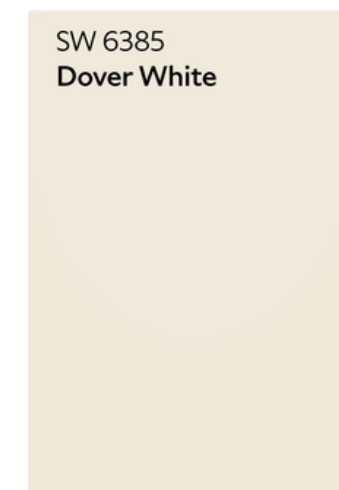

SW 6385
Dover White

Flooring Front of House



Penny Tile Keystone brand from Daltile
Color Biscuit for field and accent Keystone
Dark Green exact color to be determined.

Daltile > Keystones > Biscuit

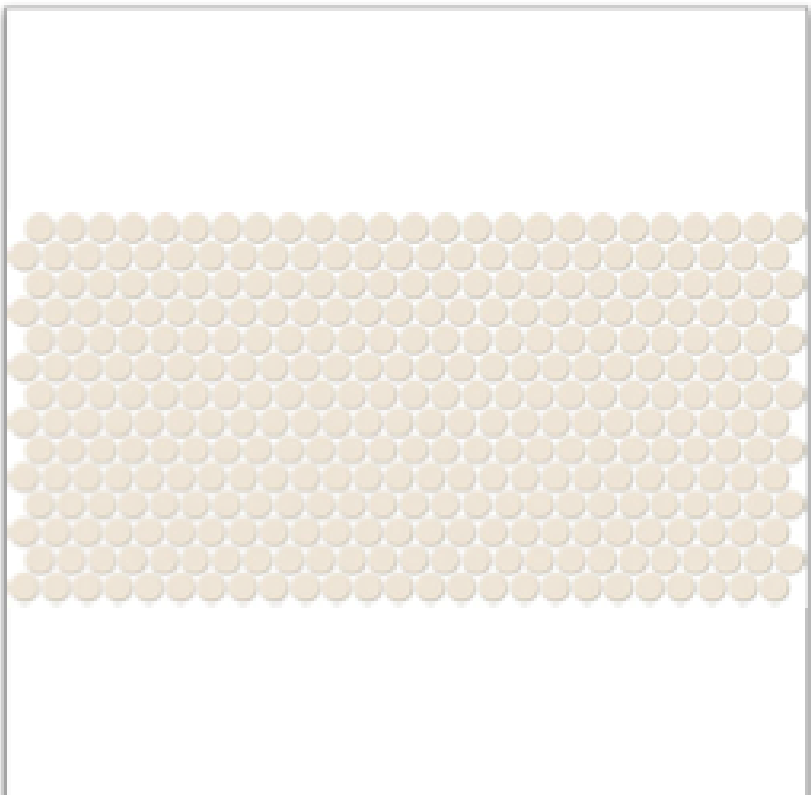

Inspiration for tile pattern - vintage soda fountain

COUNTERTOP | FLOOR | WALL

Biscuit

KEYSTONES

As a prominent product for years, the Keystones collection regularly introduces new shades and sizes for the freshest options and even more design flexibility.

Lighting



Replace existing shades and poles with Portland brand School House Electric - Vintage globe light shades, 12" X 12" dia. ribbed globe on cord, using same ceiling light pattern - 8 fixtures in FOH
Bulbs 2700 Kevin.



Existing Lighting - 9 fixtures in FOH

SITE PLAN

1530 Pike Pl

479 SF

Neighboring businesses:

Mee Sum, Lands of Origin and
Cinnamon Works

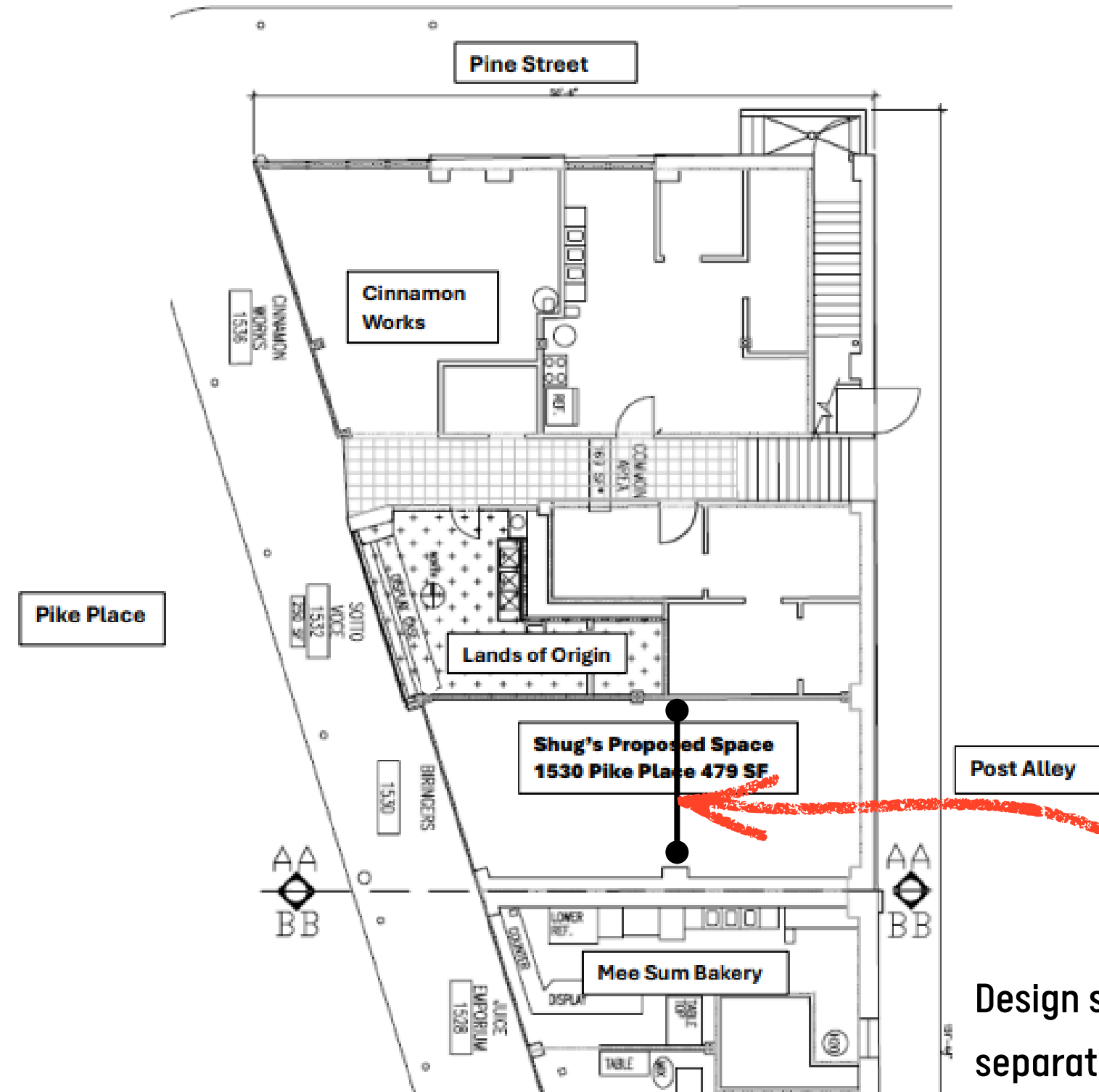

Design style is to keep front room and back room separated by a semi-spanning wall in center of space. Customer facing in the front and kitchen prep area in the back

Items to be replaced or removed



Removing shelf on north wall - FOH



Existing east wall replacing 2-compartment sink with 3-compartment sink.
Dishwasher remains - BOH

Front of House Equipment

Back Bar will have standard equipment to include:

Under counter refrigerator - Beverage Air

Horizontal ice cream freezer - Excellence Industries

Espresso machine

Milkshake mixer

1 handsink

Note: All equipment is from Shug's previous space or new space's previous tenant

Beverage-Air UCR48AHC 48" Undercounter Refrigerator

[Leave a review](#) Item #: 185UCR48AHC MFR #: UCR48AHC



Beverage-Air UCR48AHC Specs	
Quantity	1/Each
Shipping Weight	229.5 lb.
Width	48 Inches
Depth	29 1/4 Inches
Height	34 5/8 Inches
Interior Width	44 Inches
Interior Depth	17 Inches
Interior Height	23 Inches
Amps	2 Amps
Hertz	60 Hz
Phase	1 Phase
Voltage	115 Volts
Access Type	Doors
Capacity	13.9 cu. ft.
Compressor Location	Bottom Mounted
Compressor Style	Side / Rear Breathing
Door Style	Swing
Door Type	Solid
Features	Made In America Self-Closing Doors
Hinge Location	Left Right
Horsepower	1/5 hp
Number of Doors	2 Doors
Number of Shelves	4 Shelves
Plug Type	NEMA 5-15P
Refrigerant Type	R-290
Style	Counter Height
Temperature Range	36 - 38 Degrees F
Type	Refrigerators Undercounter Refrigerators



Espresso Machine



Hamilton Beach Commercial Drink Mixer



Krowne HS-26L - Hand Sink w/ Side Splashes - 16"



Krowne Metal HS-26L Specs

Model Number	HS-26L
Length	15 Inches
Width	16 Inches
Height	6 Inches
Low Lead Compliant	Yes
Manufacturer	Krowne Metal

Back of House Equipment Layout

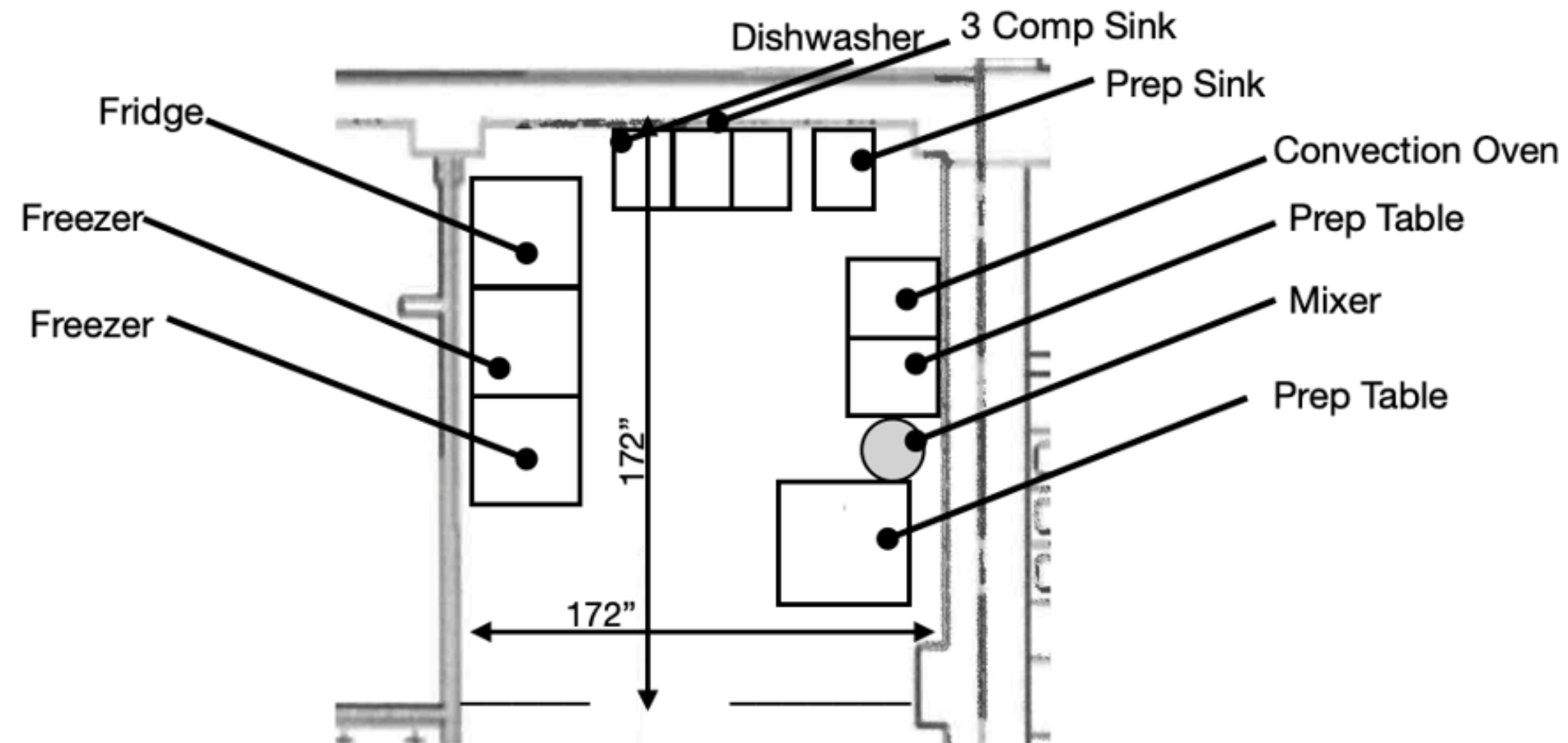

Back of House Equipment

Kitchen will have standard equipment to include:

Stand up freezer - Beverage Air

Stand up fridge - Beverage Air

Dishwasher

3-compartment sink

1 prep sink

1 handsink

Non-hooded convection oven - Moffat

Globe Mixer

Prep tables

Note: All equipment is from Shug's previous space or new space's previous tenant



BEVERAGE-AIR

Project:	AIA#
Item:	
Location:	SIS#
Approved:	

HORIZON TOP MOUNT REACH-IN
HR2HC Half-Glass Double Door Reach-In Refrigerator
Hydrocarbon Series

MODEL:
HR2HC-1HG



7 Year Parts/Labor Warranty
7 Year Compressor Warranty

CABINET CONSTRUCTION

- Exterior is stainless steel front and continuous coil coated sides
- Interior liner is made of corrosion resistant aluminum
- Full electronic control
- One piece grille
- LED interior light
- Self-closing door with 120° stay-open feature, on cam-lift hinges
- Snap-in magnetic gaskets for positive door seal
- Six (6) heavy-duty epoxy coated wire shelves
- 6" Heavy-duty casters, two (2) with brakes
- 8' Cord and plug (see electrical data for details)

OPTIONS & ACCESSORIES

- Tray slide pair, 1 tray slide set for (1) 18" x 26" or (2) 14" x 18" pans (A)
- Stainless steel universal tray slide pair, 1 tray slide set for (1) 18" x 26" or (2) 14" x 18" pans (AC)
- Tray slide kit #4 (19 sets per half section)
- Additional shelves
- Shelf clips
- Door locks
- Stainless steel breaker
- 6" Legs seismic/flanged
- 3" Casters
- Remote option* (see note on back page)

FINISH OPTIONS

- **HR Standard**
(S/S front, continuous coil coated sides, aluminum interior)
- **HRP**
(S/S front, S/S sides, aluminum interior)
- **HRS**
(S/S front, continuous coil coated sides, S/S interior)
- **HRPS**
(Complete S/S exterior & interior)

REFRIGERATION SYSTEM

- Uses environmentally friendly, energy efficient R290 refrigerant, and meets all regulatory requirements for CARB, SNAP, DOE & more
- Hot gas condensate evaporator
- Adaptive defrost
- Epoxy coated evaporator coil
- Maintains product temperatures between 36°F and 38°F

HR2HC TOP MOUNT REACH-IN REFRIGERATOR



BEVERAGE-AIR

MODEL	HR2HC-1HG
EXTERNAL DIMENSIONAL DATA	
Width Overall	52"
Depth Overall with Handle	33 1/4"
Height Overall	85"
Number of Doors	2
Depth with Door Open 90°	55 1/4"
Door Openings (in)	21 1/4" x 29 1/4"
INTERNAL DIMENSIONAL DATA	
NET Capacity (cubic ft.)	46.88
Internal Width Overall (in)	48"
Internal Depth Overall (in)	25 1/4"
Internal Height Overall (in)	62"
Number of Shelves	6
ELECTRICAL DATA	
Full Load Amperes **	6.0
Voltage	115/60/1
Nema Plug (8' cord)	5-15P
REFRIGERATION DATA	
Horsepower	1/3
Capacity (BTU/Hr)	2800
Heat Rejection (BTU/Hr)	4200
Charge (lbs/grams/ounces)	0.3307 / 150 / 5.30
SHIPPING DATA	
Gross Weight (crated lbs)	540 lbs
Height - Crated	88"
Width - Crated	55"
Depth - Crated	36"

*NOTE: Remote units are field wired and come with 6" legs.
Refrigerant must be specified at time of order.

We reserve the right to change specifications and product design without notice.
Such revisions do not entitle the buyer to corresponding changes, improvements,
additions or replacements for previously purchased equipment. Dimensional
tolerances +/- 1/4". Metric dimensions (MM).

ELECTRICAL CONNECTION



115/60/1**
NEMA 5-15P

Unit pre-wired at
factory and include
8' long cord and
plug set.

** NOTE: Units that utilize condenser cooled compressors have different electrical requirements.

Top Mount Reach-In Refrigerator
Model: HR2HC-1HG

Model Views

Required Clearance: Top 12" & Rear 3"

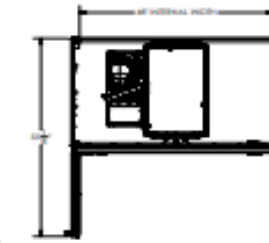

PLAN VIEW

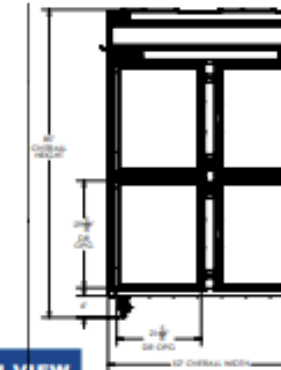

ELEVATION VIEW

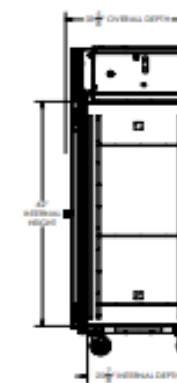

SIDE VIEW



BEVERAGE-AIR

Project: _____	AIA# _____
Item: _____	
Location: _____	SIS# _____
Approved: _____	

HORIZON TOP MOUNT REACH-IN
HR1HC Glass Door Reach-In Refrigerator
Hydrocarbon Series

MODEL:
HR1HC-1G



7 Year Parts/Labor Warranty
7 Year Compressor Warranty

CABINET CONSTRUCTION

- Exterior is stainless steel front and continuous coil coated sides
- Interior liner is made of corrosion resistant aluminum
- Full electronic control
- One piece grille
- LED interior light
- Self-closing door with 120° stay-open feature, on cam-lift hinges
- Snap-in magnetic gaskets for positive door seal
- Three (3) heavy-duty epoxy coated wire shelves
- 6" Heavy-duty casters, two (2) with brakes
- 8' Cord and plug (see electrical data for details)

OPTIONS & ACCESSORIES

- Tray slide pair, 1 tray slide set for (1) 18" x 26" or (2) 14" x 18" pans (A)
- Stainless steel universal tray slide pair, 1 tray slide set for (1) 18" x 26" or (2) 14" x 18" pans (AC)
- Tray slide kit #4 (19 sets per half section)
- Additional shelves
- Shelf clips
- Door lock
- Stainless steel breaker
- 6" Legs seismic/flanged
- 3" Casters
- Remote option* (see note on back page)

FINISH OPTIONS

- **HR Standard**
(S/S front, continuous coil coated sides, aluminum interior)
- **HRP**
(S/S front, S/S sides, aluminum interior)
- **HRS**
(S/S front, continuous coil coated sides, S/S interior)
- **HRPS**
(Complete S/S exterior & interior)

REFRIGERATION SYSTEM

- Uses environmentally friendly, energy efficient R290 refrigerant, and meets all regulatory requirements for CARB, SNAP, DOE & more
- Hot gas condensate evaporator
- Adaptive defrost
- Epoxy coated evaporator coil
- Maintains product temperatures between 36°F and 38°F

HR1HC TOP MOUNT REACH-IN REFRIGERATOR



BEVERAGE-AIR

MODEL	HR1HC-1G
EXTERNAL DIMENSIONAL DATA	
Width Overall	26"
Depth Overall with Handle	33 1/4"
Height Overall	85"
Number of Doors	1
Depth with Door Open 90°	55 1/4"
Door Opening (in)	21 1/4" x 61 1/4"
INTERNAL DIMENSIONAL DATA	
NET Capacity (cubic ft.)	22.28
Internal Width Overall (in)	22"
Internal Depth Overall (in)	26 1/4"
Internal Height Overall (in)	62"
Number of Shelves	3
ELECTRICAL DATA	
Full Load Amperes	2.7
Voltage	115/60/1
Nema Plug (8' cord)	5-15P
REFRIGERATION DATA	
Horsepower	1/4
Capacity (BTU/Hr)	1702
Heat Rejection (BTU/Hr)	2553
Charge (lbs/grams/ounces)	0.2425 / 110 / 3.88
SHIPPING DATA	
Gross Weight (crated lbs)	310 lbs
Height - Crated	88"
Width - Crated	33"
Depth - Crated	41"

*NOTE: Remote units are field wired and come with 6" legs.
Refrigerant must be specified at time of order.

We reserve the right to change specifications and product design without notice.
Such revisions do not entitle the buyer to corresponding changes, improvements, additions or replacements for previously purchased equipment. Dimensional tolerances +/- 1/4". Metric dimensions (MM).

Top Mount Reach-In Refrigerator
Model: HR1HC-1G

Model Views

Required Clearance: Top 12" & Rear 3"

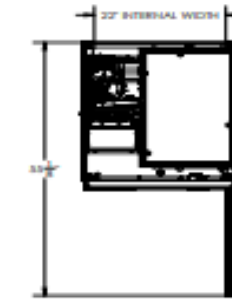

PLAN VIEW



ELEVATION VIEW

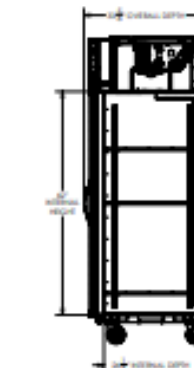

SIDE VIEW



L-1X

Chemical Sanitizing
Undercounter
Dishwasher

FEATURES:

- 30 racks / 120 covers per hour.
- Economical to operate. Uses only 1.7 gallons of water per cycle.
- All stainless steel construction assures long life and years of trouble free operation.
- 12-1/8" door opening.
- Unique spray arm system features upper and lower stainless steel wash arms with reinforced end caps.
- Built-in chemical pumps and deliming system assures proper chemical usage.
- Convenient to service "Work-in-a-drawer". All electrical components are attached to a sliding drawer for easy access and service.
- Standard pump to draining or uphill stand pipe to drain.
- Pump purging system improves results by eliminating soil and chemical carryover during rinse cycle.
- Stainless steel pump impeller. Offers extended life and service.
- Built-in strainer in water inlet system to prevent water valve from clogging.
- Two dishracks included.
- Built-in primer switches.
- Built-in instant start.
- Door safety switch makes operation safe.
- Stainless Steel Legs 4" (set of 4).



MODEL L-1X
Door Opening 12-1/8"
4" legs included
PN: 1146.60



Optional dishtable and Pre-wash.



Standard pump to floor drain or uphill stand pipe to drain.



Upper and lower rotating wash arms guarantee excellent results.



"Work-in-a-drawer", may be removed.



The optional Universal Pedestal has a storage feature for spare dishracks, with the ability to store two empty dishracks beneath the machine. 15-1/4"H X 24"W X 25-1/4"D.

Available Options

- Sustainer Heater
- Sanitizer Alarm
- The "TEMP-SURE" requires a separate 208-240v 3 phase 40 amp power supply
- Stainless Steel 6" Legs PN: 1146.05 (set of 4)
- Stainless Steel Pedestal
- 48" Undercounter dishtable with Pre-Rinse
- Alternative electrical available for export



L-1X

Chemical Sanitizing
Undercounter
Dishwasher

WARNINGS:

- Plumbing connections must be made by a qualified service company who will comply with all available Federal, State, and Local Health, Plumbing and Safety codes.
- CMA recommends utilizing a water softening system to maintain water hardness measurements of 3.5 gpg (grains per gallon) or less. This will assure maximum results and optimum operation of the dishmachine.

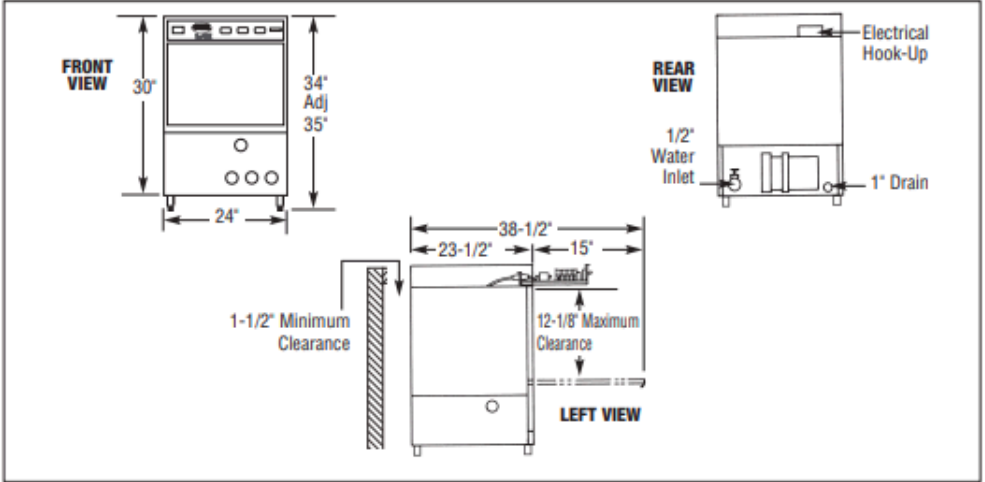

Specifications:

UNDERCOUNTER DISHWASHER	L-1X	METRIC		USA	METRIC
OPERATING CAPACITY RACKS PER HOUR (NSF RATED)	30	30	WASH PUMP MOTORS HP	1	1
OPERATING CYCLE			DIMENSIONS		
WASH TIME-SEC	58	58	DEPTH	23-1/2"	(59cm)
RINSE TIME-SEC	32	32	WIDTH	24"	(61cm)
DWELL/PURGE-SEC	30	30	HEIGHT	30"-31"	(76.2-78.2 cm)
TOTAL CYCLE TIME	120	120	MAXIMUM CLEARANCE		
WASH TANK CAPACITY	1.7 GAL.	(6.49 L)	HEIGHT FOR DISHES	12-1/8"	(31cm)
WASH PUMP CAPACITY	35 GPM	(132.5 LPM)	STANDARD DISHRACK	1	1
OPERATING TEMPERATURE REQUIRED	120°F	(49°C)	DIMENSIONS	19-3/4"X19-3/4"	(50X50cm)
RECOMMENDED	140°F	(60°C)	ELECTRICAL RATING	VOLTS	AMPS
WATER CONSUMPTION PER RACK	1.7 GAL.	(6.44 L)		115	16
PER HOUR	40.8 GAL.	(154.4 L)	APPROXIMATE SHIPPING WEIGHT	172#	(78kg)
WATER INLET	1/2"	(1.27 cm)	SHIPPING DIMENSIONS	PALLET & BOX @ 29" X 28" X 38"	
DRAIN	1"	(2.54 cm)			

Summary Specifications: Model L-1X CMA Energy Miser low temperature undercounter chemical sanitizing commercial dishwashers meets NSF, UL and CUL sanitation and construction standards WITHOUT the use of BOOSTER or TANK HEATERS. The model L-1X is constructed entirely of stainless steel. Each unit automatically washes, rinses and sanitizes food service utensils in standard 19-3/4"X19-3/4" racks. Units comes standard with upper and lower stainless steel wash arms. The L-1X incorporates a pump purging system that improves results by eliminating soil and chemical carryover during rinse cycle.

Advisory: CMA does NOT endorse "Tankless On-Demand" water heaters for use on CMA Dishmachine products. CMA DOES endorse, and highly recommends, the standard "tank" style water heaters, sized properly to handle each particular facility with its water heating requirements.



CMA Dishmachines 12700 Knott Street Garden Grove, CA 92841 • 800-854-6417 • 714-898-8781 • Fax: 714-895-2141 • www.cmadishmachines.com



3 - compartment Sink



Prep Sink exact model TBD

CONVECTION OVENS

30 Series

[« Previous](#) | [Next »](#)

Turbofan E32D5 and SK32 Stand - Full Size Sheet Pan Digital Electric Convection Oven On a Stainless Steel Stand

Model Number

E32D5 and SK32 Stand

Dimensions

W: 28.88in D: 31.88in H: 63.37in

Volume: Oven = 20.1, Stand = 3.5ft³

Packed Weight: Oven = 231, Stand = 51lbs

Product Features

- 5 x full size sheet pan capacity
- 3 1/3" tray spacing
- 2 speed bi-directional fan
- Electronic controls with digital time and temperature display
- Manual or program modes
- Large 3/4" high LED display
- Water injection key
- Thermostatic range 150-550F
- Timer range from 180 minutes in countdown mode
- Over-temperature safety cut-out
- Single phase connection

Downloads

Specification Sheet	▼
Sales Brochure	▼
Product Range Catalogue	▼
2D CAD plan file	▼
2D CAD front file	▼
2D CAD side file	▼
3D CAD file	▼
Installation Operation Manual	▼

[Product Enquiry](#) | [Printer Friendly](#) | [Share](#) | [Add to Wishlist](#) | [Include in Comparison](#)

turbofan[®]
CONVECTION OVEN SYSTEMS





Globe SP20 Specs

Quantity	1/Each
Shipping Weight	198 lb.
Width	18 1/4 Inches
Depth	19 1/2 Inches
Height	34 1/2 Inches
Amps	6 Amps
Hertz	60 Hz
Phase	1 Phase
Voltage	120 Volts
Wattage	690 Watts
Capacity	20 qt.
Color	Gray
Features	NSF Listed
Horsepower	1/2 hp
Hub	With Hub
Lift Type	Manual
Mixer Type	Planetary
Number of Mixing Heads	1
Plug Type	NEMA 5-15P
Power Type	Electric
RPM	104, 194, 353 RPM
Speeds	3 Speed
Style	Lift
Timer	With Timer
Transmission Type	Gear-Driven
Type	Stand Mixers
Usage	Heavy Duty

Preps Tables - 2 Boos Block and 1 stainless steel



Manufacturer:	JOHN BOOS
Item:	John Boos SNS01 - 36" X 24" Butcher Block Work Table W/ Stainless Steel Under Shelf
Availability:	In Stock
Shipping:	Ships In 10-15 Business Days
SKU:	SNS01
Condition:	New
Length:	36 Inches
Width:	24 Inches
Height:	36 Inches
Reviews	<div>4.4 ★★★★★</div> <div>★ ShopperApproved</div>



Stainless Prep Table 30" W X 24" D X 35.25" H

SOUTH WALL

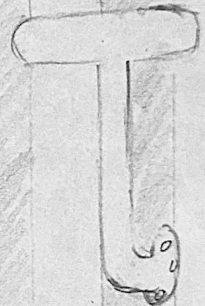
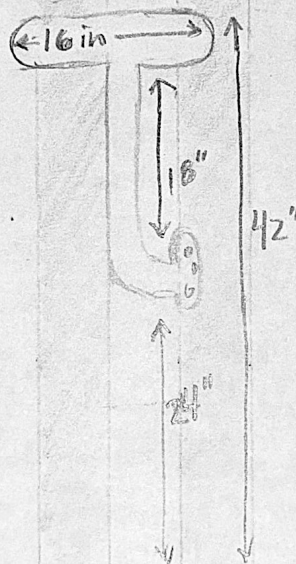
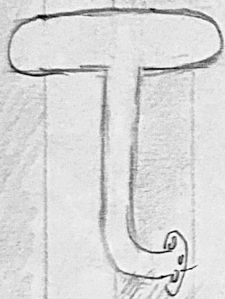

← 24 → ← 36 → 174" opening

0 0 0 0
0 0 0 0
0 0 0 0
0 0 0 0
0 0 0 0
0 0 0 0

peg wall - 40 in door

door opening
w/
proposed
sliding doors
along this
wall.

~~36" 40"~~
← door →

40"
← door →

40"
← door →

Hand sink
Bar

pantry
or
store



1. Provide an elevation sketch of the south wall to show: approximate width of the stripes; location of the wall-mounted tables.

- Please see attached picture of South wall. Stripes will be 6 inches apart, alternating green and white. White aluminum zinc coated steel tables will be spaced equally amongst the wall for standing room only tables.

Provide an elevation sketch of the FOH east wall; what will it look like (paint, shelving, trim, signs, etc)?

- Please see the attached picture of East wall. The FOH East wall will be paneled doors that line on a track, hidden by a 12inch soffit. The doors will each be 40 inch panels made from painted plywood. They will overlap and slide in front of each other. When lined up properly, they will "hide" the back kitchen entrance, will cover the electrical panel but still allow quick accessibility when needed. The far left side of the east wall will be a true wall that is 24 inches wide. This will help break up the front room from the back room. We plan to have a peg wall there to display a few items, perhaps merchandise or needs for service.

Add the depth measurement for the north wall soffit (how far does it protrude?)

- The North wall soffit will protrude out 24 inches.

2. Show what colors and materials will be used for: menu area, north wall shelving, north wall finish, Shug's sign. If planning to paint the ceiling and/or pipes, provide color information

- The soffit will bring the guest attention to the menu boards. We plan to use a powder coated steel menu peg board that measures 90 inches by 24inches. It will be white in color with black letters. The menu board will be attached to the soffit.
- The South wall bar will be plywood painted white, in addition we will use Vertical Grain Douglas Fir for trim and the shelving. This will be repurposed from the original Shug's.
- Pipes will also be painted in same white throughout the front space. Shug's sign will either be a light box or painted wooden sign.

3. The plans indicate that eight of nine lights will be replaced; which one will not be replaced (show its location)?

- The light in the most North East corner will be removed. There are too many pipes in that area to compete for light space.