





93 Pike Street, Suite #204 Seattle WA 98101



Colors		PMS	Paint/Sheen	Translucent Vinyl	Opaque Vinyl	Other
White		N/A	Natural White 42202 SP/Satin	White 230-20	Matte White 220-20	N/A
Blue		2152 C				
Red		492 C			220 283	N/A

Street Side

12'- 9 3/4"

from Bottom of the canopy to Grade

2'-0"

4'-0"



Wall Side

12'- 1 1/4"

from Bottom of the canopy to Grade



NATIONAL
SIGN
CORPORATION

1541 S. 92nd Place, #B, Seattle, WA 98108
P: 206-282-0700
www.nationalsigncorp.com

CLIENT INFORMATION:

Crepe de France
93 Pike Street Suite#204
Seattle,WA 98101

REPRESENTATIVE:

James Zimmerman

DESIGNER:

Pushkar Pant

DATE:

12/11/25

REVISION:

1	
2	
3	
4	
5	
6	
7	
8	
9	

This is an original unpublished drawing, created by National Sign Corporation. It is not to be shown to anyone outside your organization, or to be used, reproduced, copied or exhibited in any fashion. Any usage beyond that granted to buyer herein shall require the separate payment of a design and engineering fee to National Sign Corporation.



SIGN(S) TO BE MANUFACTURED TO U.L. SPECIFICATIONS AND WILL BEAR THE U.L. LABEL(S). INSTALL IN ACCORDANCE WITH NATIONAL ELECTRICAL CODES.

DESIGN NUMBER:

24-00000 V2

JOB NUMBER:

00000-MS

Elevations

SIGN 1 - D/F HANGING BLADE SIGN - NEON
Sign Sq Ft.: 16 Sq. Ft
Scale: 1"=1'-0

Hanging arms to be 1 1/2" Alum Sq. tube,
paint satin black.

Cabinet to be fabricated aluminum,
paint blue, white, and red- satin.

1/4" clear acrylic protection covers,
each side of sign.

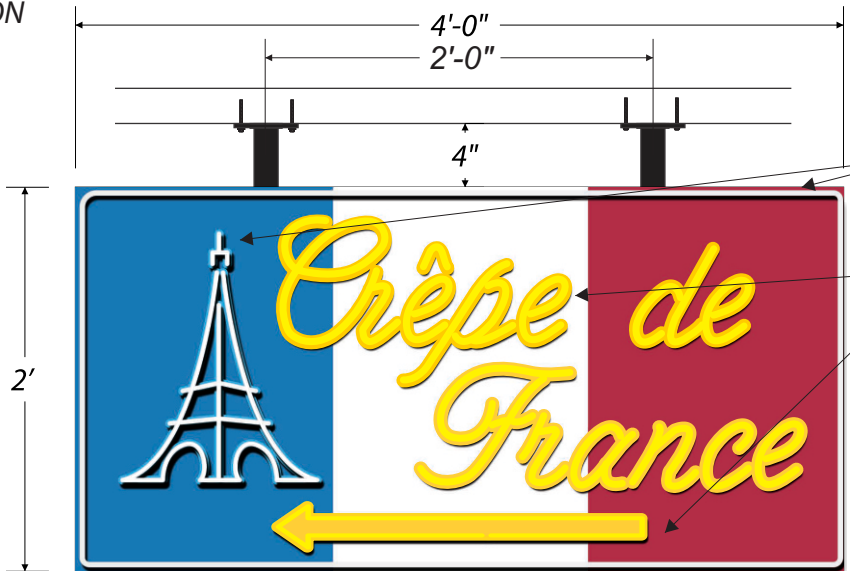

Side 1

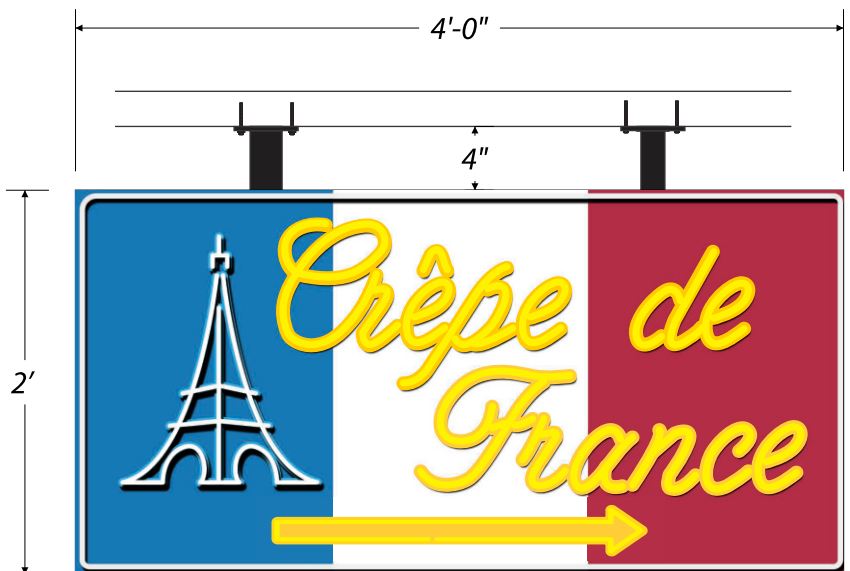

Side 2: Arrow to point to building both sides



Bottom

12mm White Neon Tube (Eiffel Tower, Border)

12 mm Yellow Neon Tube (Letters, Arrow)

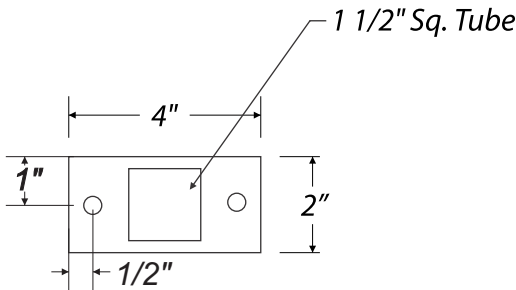

1/4" Mounting Plate
Scale: 3"=1'

3/8"x 3" Thru-Bolts 2 (two) each
2"x4"x 1/4" Alum. Mounting Plate.
(Satin Black)
2 (Two) 1 1/2" Sq. Tube Hanging Arms (Satin Black)
Attach to Canopy Beam

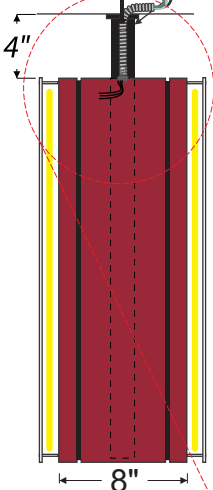

Cabinet

1/4" Clear Acrylic Protection Covers
to each side of the sign

.080 Alum. Face
All Graphics & Border:
Apply First Surface

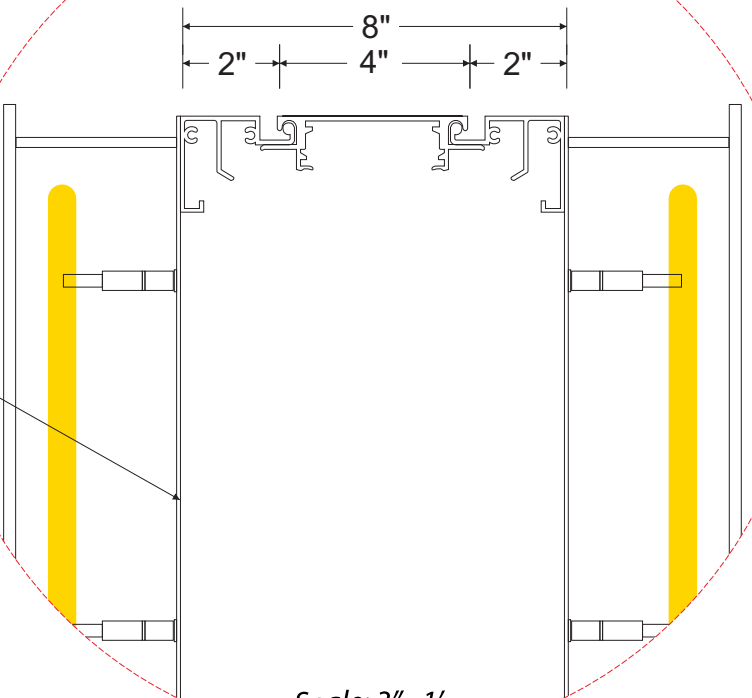

Scale: 3"=1'



**NATIONAL
SIGN**
CORPORATION

1541 S. 92nd Place, #B, Seattle, WA 98108
P: 206-282-0700
www.nationalsigncorp.com

CLIENT INFORMATION:
Crepe de France
93 Pike Street Suite#204
Seattle,WA 98101

REPRESENTATIVE:
James Zimmerman

DESIGNER:
Pushkar Pant

DATE:
12/11/25

REVISION:	
1	
2	
3	
4	
5	
6	
7	
8	
9	

This is an original unpublished drawing, created by National Sign Corporation. It is not to be shown to anyone outside your organization, or to be used, reproduced, copied or exhibited in any fashion. Any usage beyond that granted to buyer herein shall require the separate payment of a design and engineering fee to National Sign Corporation.

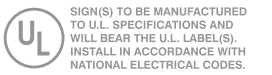

DESIGN NUMBER:
24-00000 V2

JOB NUMBER:
00000-MS



Neon



Paint/Vinyl

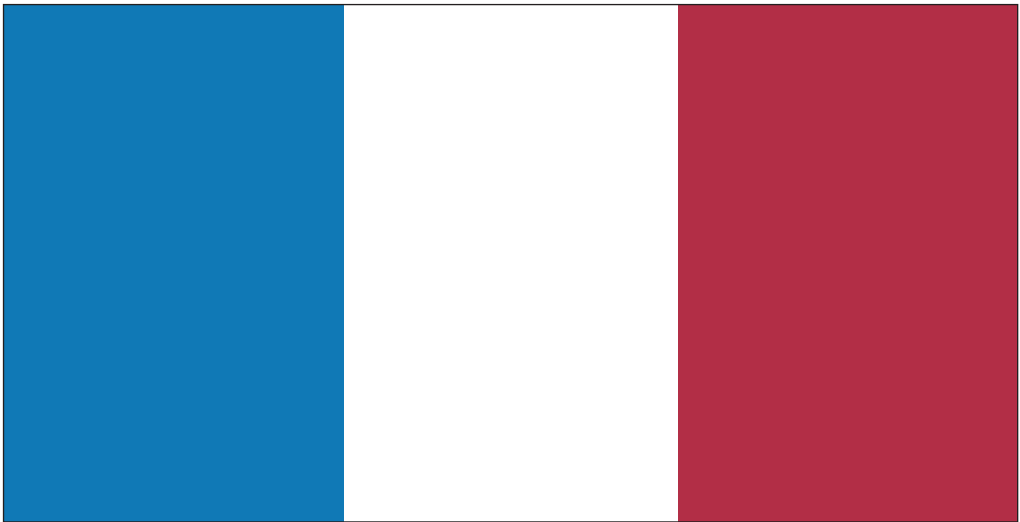

Paint First Surface

Art Details

All Colors To Match Existing Corporate Color Specifications



1541 S. 92nd Place, #B, Seattle, WA 98108
P: 206-282-0700
www.nationalsigncorp.com

CLIENT INFORMATION:
Crepe de France
93 Pike Street Suite#204
Seattle, WA 98101

REPRESENTATIVE:
James Zimmerman

DESIGNER:
Pushkar Pant

DATE:
12/11/25

REVISION:	
1	
2	
3	
4	
5	
6	
7	
8	
9	

This is an original unpublished drawing, created by National Sign Corporation. It is not to be shown to anyone outside your organization, or to be used, reproduced, copied or exhibited in any fashion. Any usage beyond that granted to buyer herein shall require the separate payment of a design and engineering fee to National Sign Corporation.

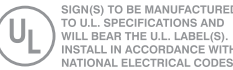

DESIGN NUMBER:
24-00000 V2

JOB NUMBER:
00000-MS

Elevations

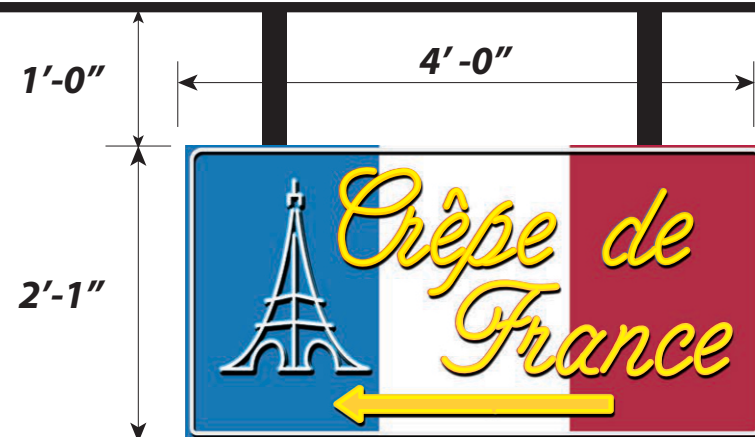

Building Attachment Location on fifth support from LEOLO sign.



Proposed Building Attachment Location

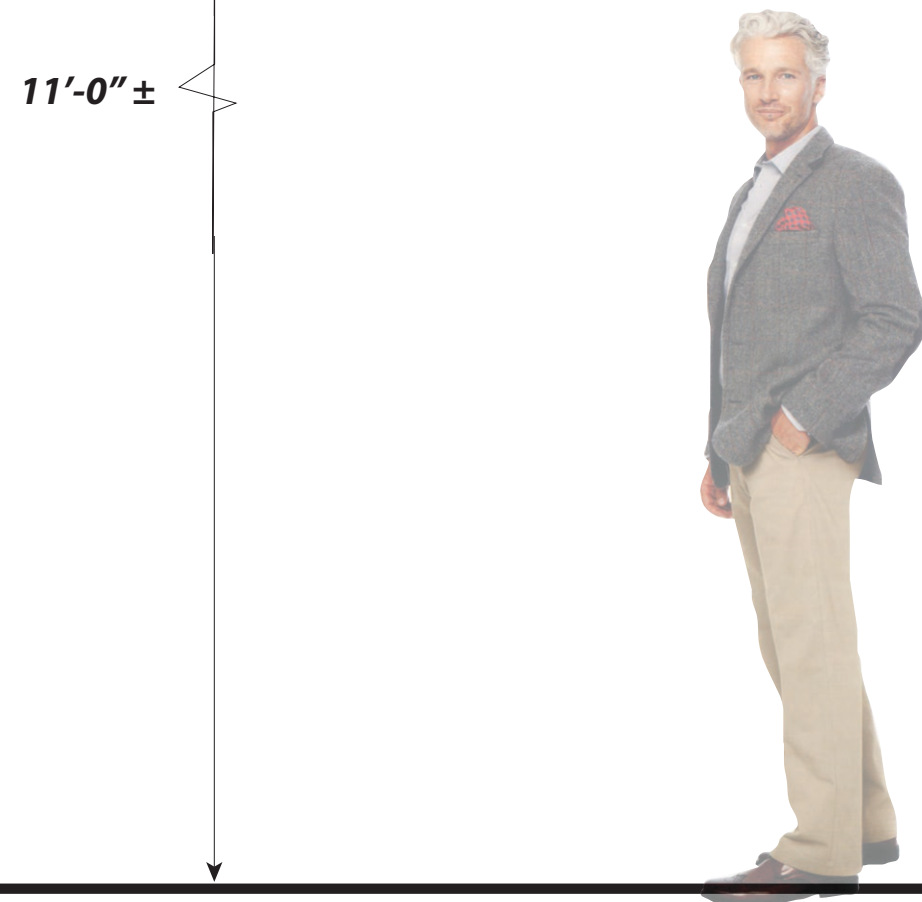

D/F HANGING BLADE SIGN - NEON
Scale: 3/4" = 1'-0"

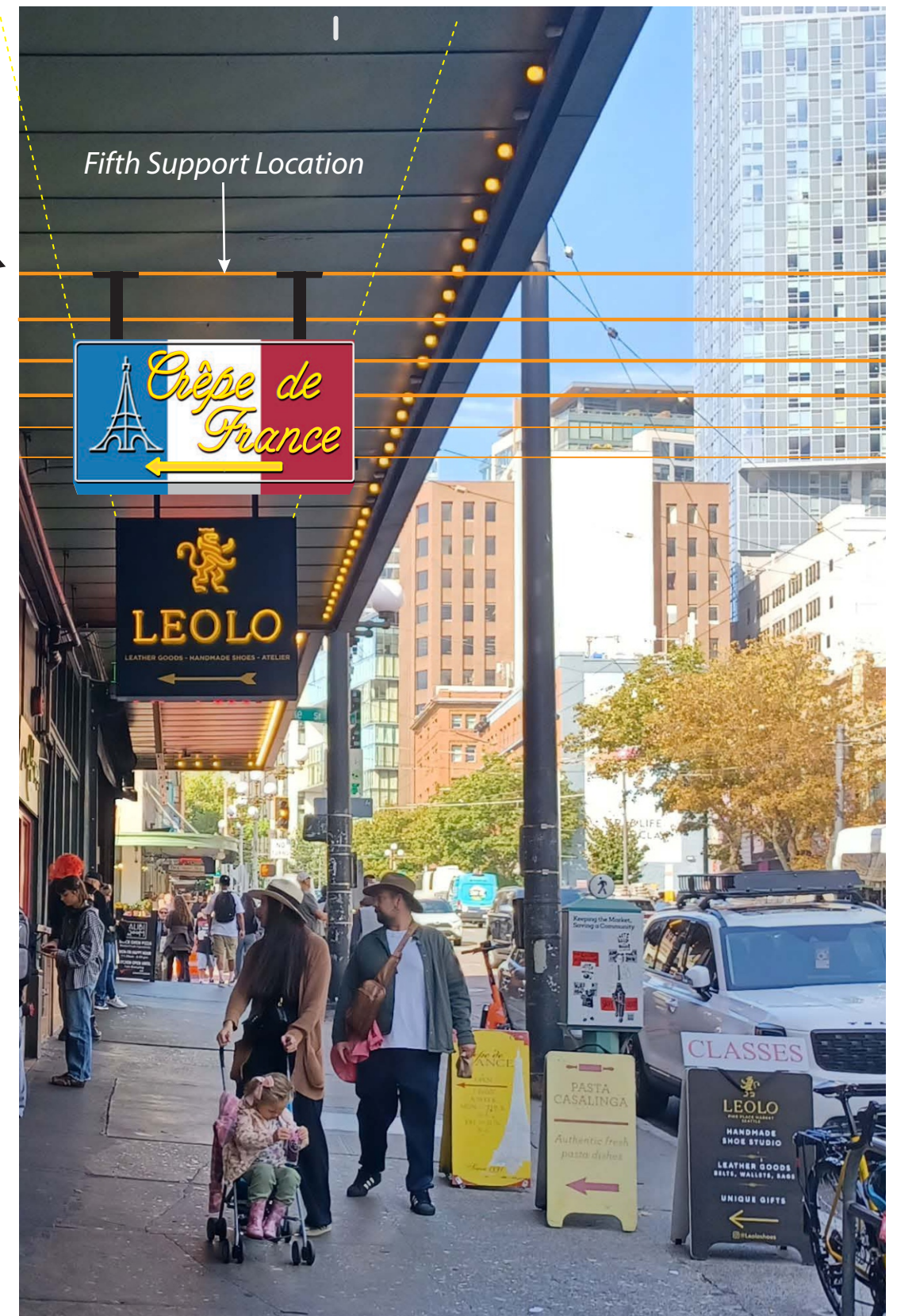

Fifth Support Location



NATIONAL SIGN
CORPORATION

1541 S. 92nd Place, #B, Seattle, WA 98108
P: 206-282-0700
www.nationalsigncorp.com

JOB INFORMATION:
Crepe de France

93 Pike Street Suite#204
Seattle, WA 98101

REPRESENTATIVE:
James Zimmerman

DESIGNER
Pushkar Pant

DATE:
12/11/25

DESIGN NUMBER:
24-0000 V2

SCALE:
N/A

JOB NUMBER:
00000-MS

This is an original unpublished drawing, created by National Sign Corporation. It is not to be shown to anyone outside your organization, or to be used, reproduced, copied or exhibited in any fashion. Any usage beyond that granted to buyer herein shall require the separate payment of a design and engineering fee to National Sign Corporation.

SIGN(S) TO BE MANUFACTURED TO U.L. SPECIFICATIONS AND WILL BEAR THE U.L. LABEL(S). INSTALL IN ACCORDANCE WITH NATIONAL ELECTRICAL CODES.





Double Face Illuminated Neon Display



NATIONAL SIGN
CORPORATION

1541 S. 92nd Place, #B, Seattle, WA 98108
P: 206-282-0700
www.nationalsigncorp.com

JOB INFORMATION:

Crepe de France

93 Pike Street Suite#204
Seattle, WA 98101

REPRESENTATIVE:

James Zimmerman

DESIGNER

Pushkar Pant

DATE:

12/11/25

DESIGN NUMBER:

24-0000 V2

SCALE:

N/A

JOB NUMBER:

00000-MS

This is an original unpublished drawing, created by National Sign Corporation. It is not to be shown to anyone outside your organization, or to be used, reproduced, copied or exhibited in any fashion. Any usage beyond that granted to buyer herein shall require the separate payment of a design and engineering fee to National Sign Corporation.

SIGN(S) TO BE MANUFACTURED TO U.L. SPECIFICATIONS AND WILL BEAR THE U.L. LABEL(S). INSTALL IN ACCORDANCE WITH NATIONAL ELECTRICAL CODES.



Sign Location



NATIONAL
SIGN
CORPORATION

1541 S. 92nd Place, #B, Seattle, WA 98108
P: 206-282-0700
www.nationalsigncorp.com

CLIENT INFORMATION:
Crepe de France
93 Pike Street Suite#204
Seattle, WA 98101

REPRESENTATIVE:
James Zimmerman

DESIGNER:
Pushkar Pant

DATE:
12/11/25

REVISION:

1	
2	
3	
4	
5	
6	
7	
8	
9	

This is an original unpublished drawing, created by National Sign Corporation. It is not to be shown to anyone outside your organization, or to be used, reproduced, copied or exhibited in any fashion. Any usage beyond that granted to buyer herein shall require the separate payment of a design and engineering fee to National Sign Corporation.

UL SIGN(S) TO BE MANUFACTURED TO U.L. SPECIFICATIONS AND WILL BEAR THE U.L. LABEL(S). INSTALL IN ACCORDANCE WITH NATIONAL ELECTRICAL CODES.

DESIGN NUMBER:
24-00000 V2

JOB NUMBER:
00000-MS

Elevations

