

GRACIA



Outdoor Patio Pergola Design

Ballard Historical Society Permit Presentation

This presentation is arranged in the following order:

1. General Photos of Existing Structure
2. Structural Materials
3. Roofing Detail
4. Fencing
5. Weatherproofing materials
6. Rain Gutters
7. Lighting Detail
8. Planters
9. Tables and chairs
10. Heaters

1a

The following photos display the overall look of our patio and it's size in relation to the historical buildings.



Photo 1: View of patio from opposite side of the street. (2024)



Photo 2: View of patio from opposite side of the street before patio structure was built. (2020)

1b



Photo 3: View from the south side looking north

**Please note that every other plank will be removed and a toe rail will be added per SDOTs ruling to demonstrate 50% transparency and to comply with ADA policy.*



Photo 4: View from the street looking south

1c

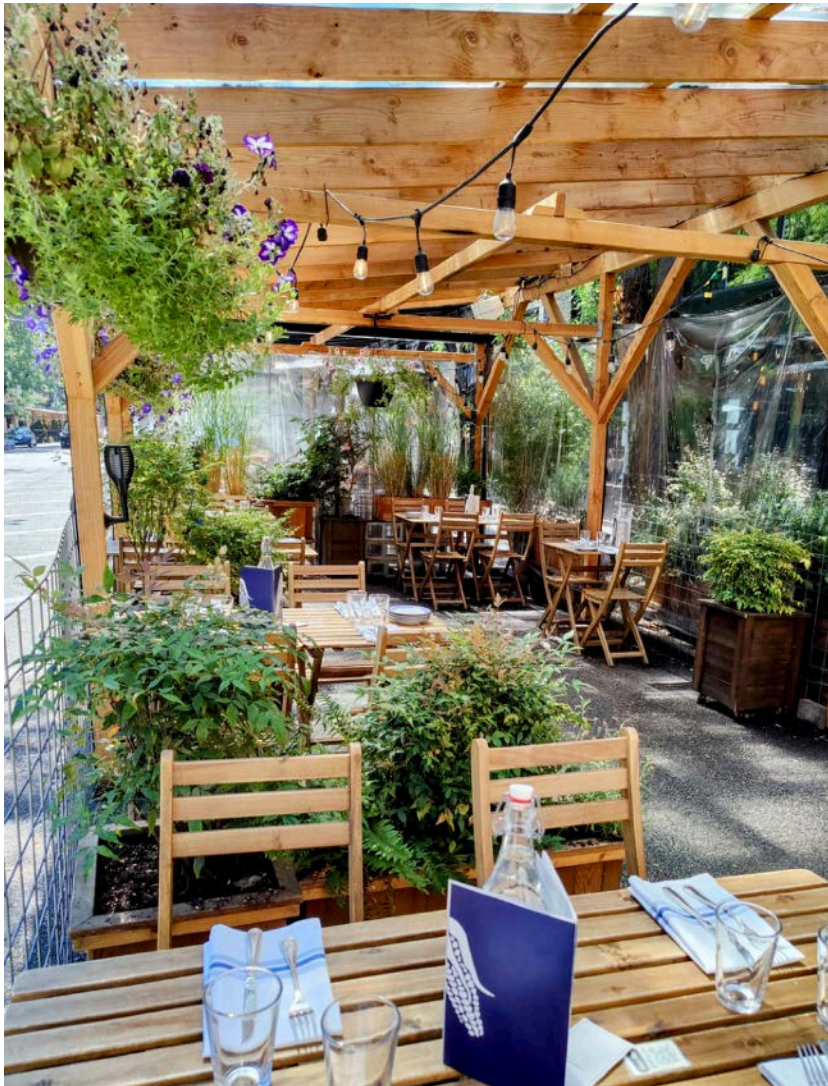

Photo 5: Interior of patio facing south



Photo 6: Interior of patio facing south

Structure: Our pergola is build with sanded and weather treated (clear-coated) **Douglas Fir** wood. The natural wood complements the potted planters and our wooden patio furniture. It is designed to be a calming, welcoming space culminating in harmony of nature and commercial spaces.



Photo 7: Interior of patio facing south



Photo 8: Detail of Douglas Fir joints



Photo 9: Detail of Douglas Fir structure with lighting and flower planters



Photo 10: Detail of Douglas Fir joints detailing clear-coated weatherproofed natural wood grain

3

Roofing materials: Our roof is currently constructed with clear plexiglass material, however, we will be upgrading to clear polycarbonate 10mm panels. This upgrade will be easy to clean, allow plenty of sunlight to pass through, and will not effect the scale of our roof.



Photo 11: We will be replacing our existing plastic sheeting on our structure. This photo shows how the roof is currently constructed.

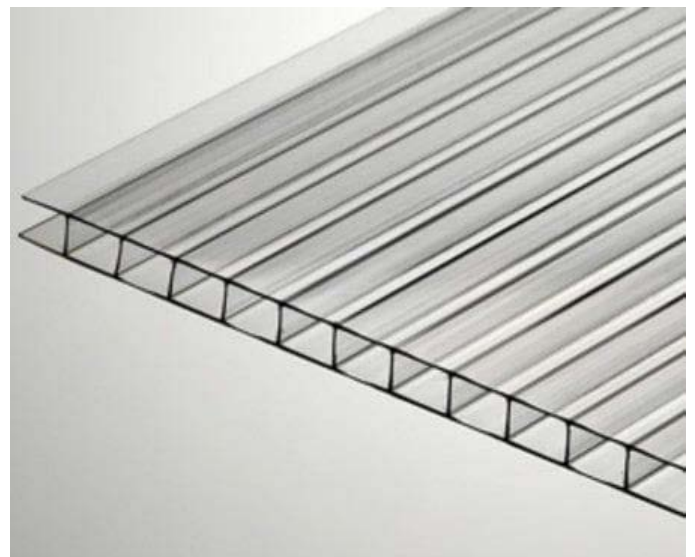

Photo 12 & 13: We will be replacing our existing plastic sheeting with this type of 10mm Polycarbonate panels, per DON guidelines.

4a

Fencing: Our railing along the street side of the pergola is constructed from steel mesh wire and demonstrates 50% transparency per the SDOT requirement. Using this material allows our customers, pedestrians, and those on the roadway an unobstructed view. It is also easily removable to allow entry for the Farmers Market vendors.



Photo 14: Fencing along the street side (viewed facing south)



Photo 15: Fencing detail.



Photo 16: Patio shown from the sidewalk looking southward. This railing is constructed of weather-treated, cane-detectable Douglas Fir and Cedar planks.

**Please note that every other plank will be removed and a toe rail will be added per SDOTs ruling to demonstrate 50% transparency (SDOT DR 03-2023 Section 6.4.3). Mocked photo shown to the right.*



Photo 17: A 5" wide horizontal toe rail will also be added, measuring 2" from the sidewalk as pictured.

4b



Photo 18: View from inside patio looking towards Gracia building. Fencing detail - the opaque lines represent the removed planks. Every other plank will be removed to comply with the SDOT ruling for 50% transparency in fencing.

4c



Photo 19: The photo to the left shows the existing metal fencing covered by the rollable rain flaps.

Photo 20: The photo to the right shows a mock up of replacing the metal fencing with the 42" tall Douglas Fir & Cedar plank fencing. Each plank is 5" wide with a 5" wide gap and features a toe rail for ADA accessibility.

Clear plastic 1/4" thick acrylic rigid Plexiglas will replace this rollable rain flaps for weatherproofing.

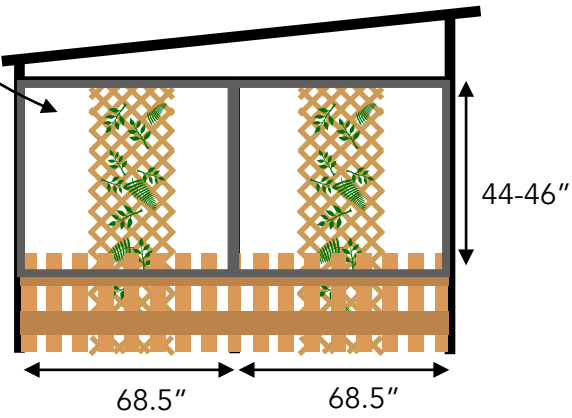

4d



Photo 21: The photo to the left shows the existing metal fencing covered by the rollable rain flaps between Gracia and Sabine's patio.



Photo 22: The photo to the left shows a mock up of replacing the metal fencing with the Douglas Fir & Cedar plank fencing. Each plank is 5" wide with a 5" wide gap and features a toe rail for ADA accessibility.

The fencing will be a sturdier structure delineating the two patio spaces.

Clear plastic 1/4" thick acrylic rigid Plexiglas will replace the rollable rain flaps for weatherproofing.

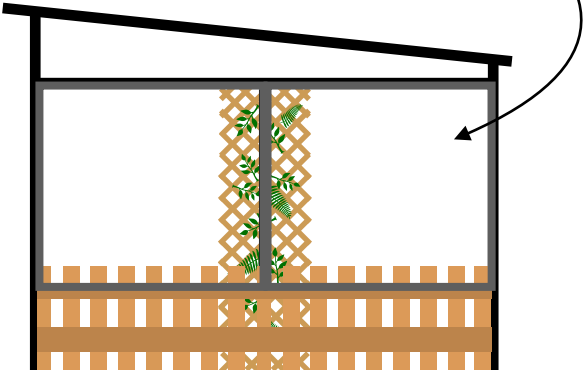

4e

Optix acrylic sheet (plexiglas) is a lightweight, impact resistant, transparent material ideal for glass replacement. This type of sheet also features excellent weather-ability and insulating properties.

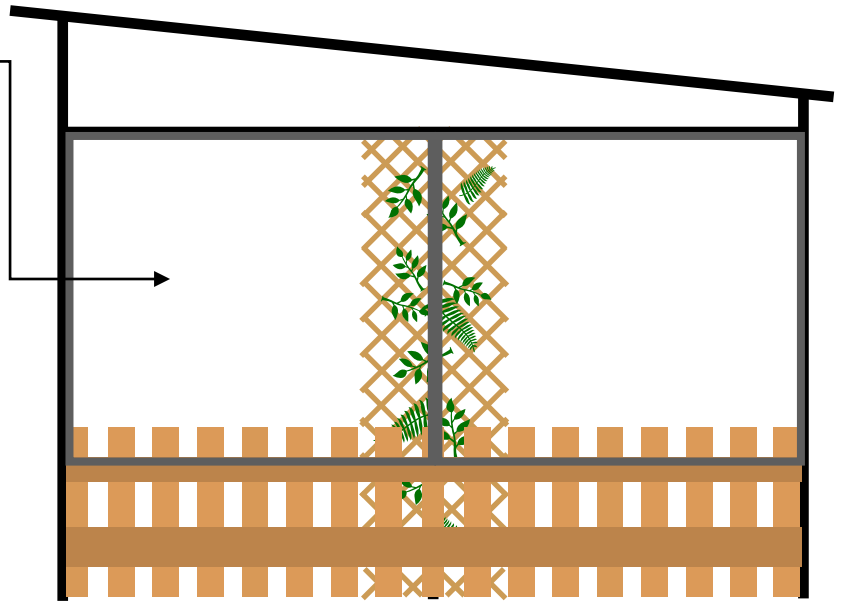

Photo 23: view from inside the patio looking northward - wooden lattice with attached greenery

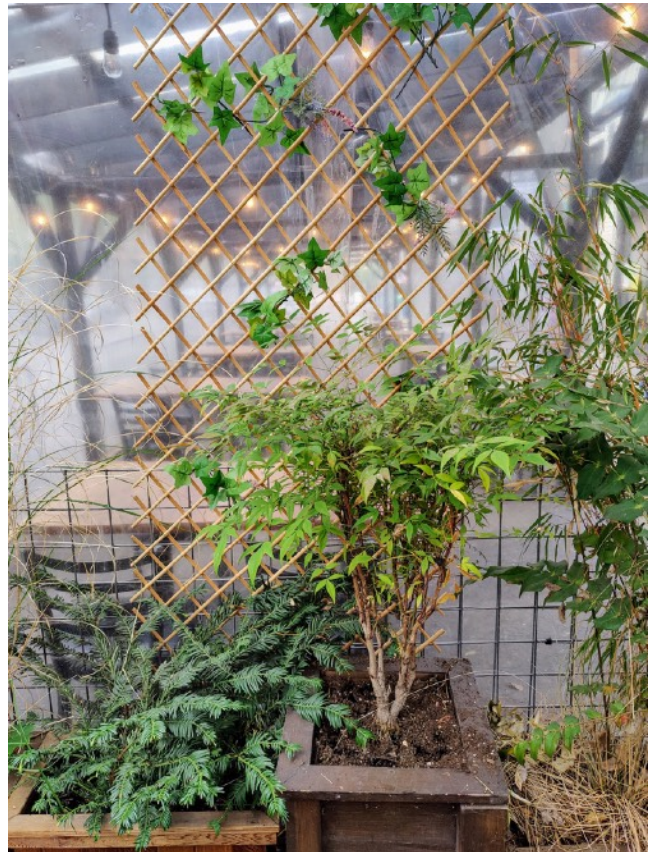

Photo 24: view from inside the patio looking southward towards Sabine's patio - wooden lattice with attached greenery

5

Weatherproofing Materials: Our rain flaps are designed to be rolled up during warmer weather and are removable. They are constructed of 30 gauge clear vinyl with hemmed black edging.



Photo 25: vinyl flaps edging detail



Photo 26: view of rain flaps from interior of patio



Photo 27 & 28: The navy blue curtains are hung on the opening to the patio to be partially closed during inclement weather only. They are made from microfiber waterproof polyester fabric (measures 108" x 54").

6

Rain Gutters: Our gutters are 5" K-Style black aluminum and run the length of the patio on the street side (measures 40'). It runs between Gracia and The Ballard cut (12') and drains down into the street.

Photo 29: View from street looking south toward Vernon Ave.



↔ = highlights the rain gutter path

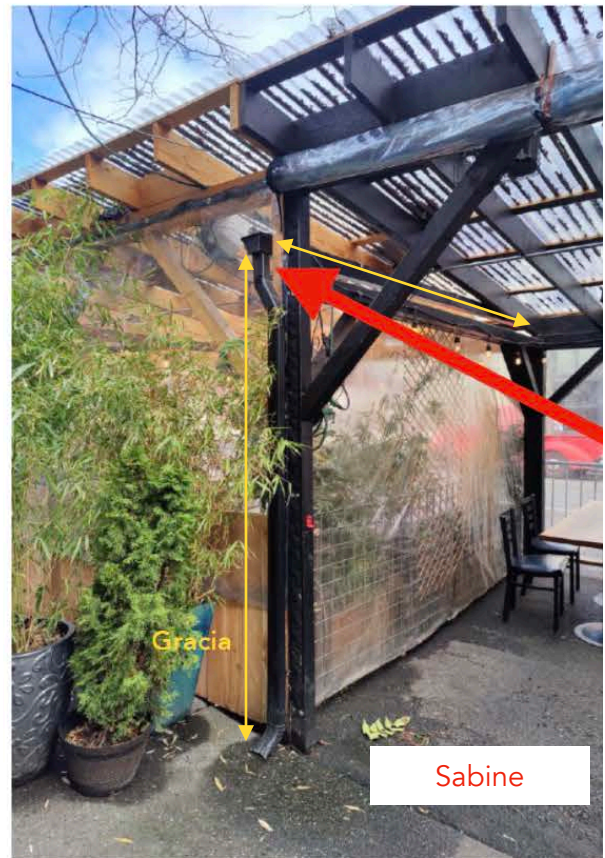

Photo 30: View from sidewalk looking north towards Gracia patio.



Photo 31: The rainwater drains from the gutters onto the sidewalk here where it runs along the curb to the sewer to the south near Vernon Ave.

Light Detail: Our patio is lit by outdoor dimmable electric string lights with a warm color temperature rated to 2700K.



Photo 32: Detail of electric string lighting, viewed from inside the patio.



Photo 33: View of string lighting from outside the patio.

Planters: Our planters enhance the overall look of our patio by bringing nature closer to our guests, creating an outdoor oasis on what would normally be a simple paved street. The greenery is maintained and the flower pots are changed seasonally as needed.



Photo 34: view of planters facing southward



Photo 35: view of planters facing sidewalk

DIMENSIONS (HxLxW):

A - 17" X 17" X 14"

B - 17" X 24" X 14"

C - 24" x 17" x 17"

D - 17" x 20" x 14"

E - 17" x 20" x 14"

F - 17" x 20" x 14"

G - 24" x 17" x 17"

H - 17" x 20" x 14"

I - 24" x 17" x 17"



Photo 36: view of planters facing south



Photo 37: view of planters facing south, towards sidewalk

Tables & Chairs: Made from solid Acacia wood and weather treated with an acrylic stain. Sourced from Ikea.



Photo 38: chair detail



Photo 39: table & chairs detail

Table Dimensions:

Width: 24 "

Height: 2 ½ "

Length: 42 ½ "

Weight: 12 lb 7 oz

Chair Dimensions:

Width: 14 ¾ "

Height: 4 ¾ "

Length: 41 "

Weight: 9 lb 9 oz



Photo 40: table & chairs detail, facing street



Heaters: We have four 3000W electric King Electric SmartWave Carbon Fiber Radiant Heaters installed on the roof of our patio to be used during colder weather days.

Model: RK2030-RMT-BLK
 Color: Black
 208VAC 3000W 60Hz
 Length: 43"

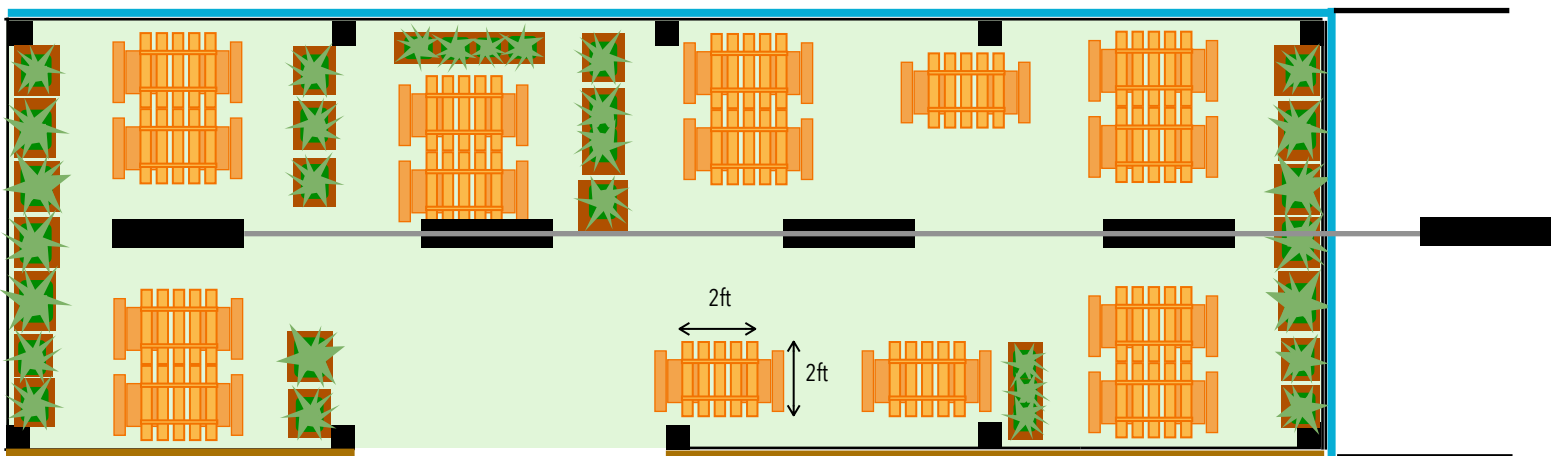

Photo 41: heater attachment detail



Photo 42: heater and roofing detail

Gracia Patio - as seen from above



The drawing above shows the heaters location (black rectangles). The silver line indicates the power conduits that lead from heater to heater. Gracia's heaters are connected to the heaters in the patio adjacent.

GRACIA CURBSIDE PATIO SITE MAP:

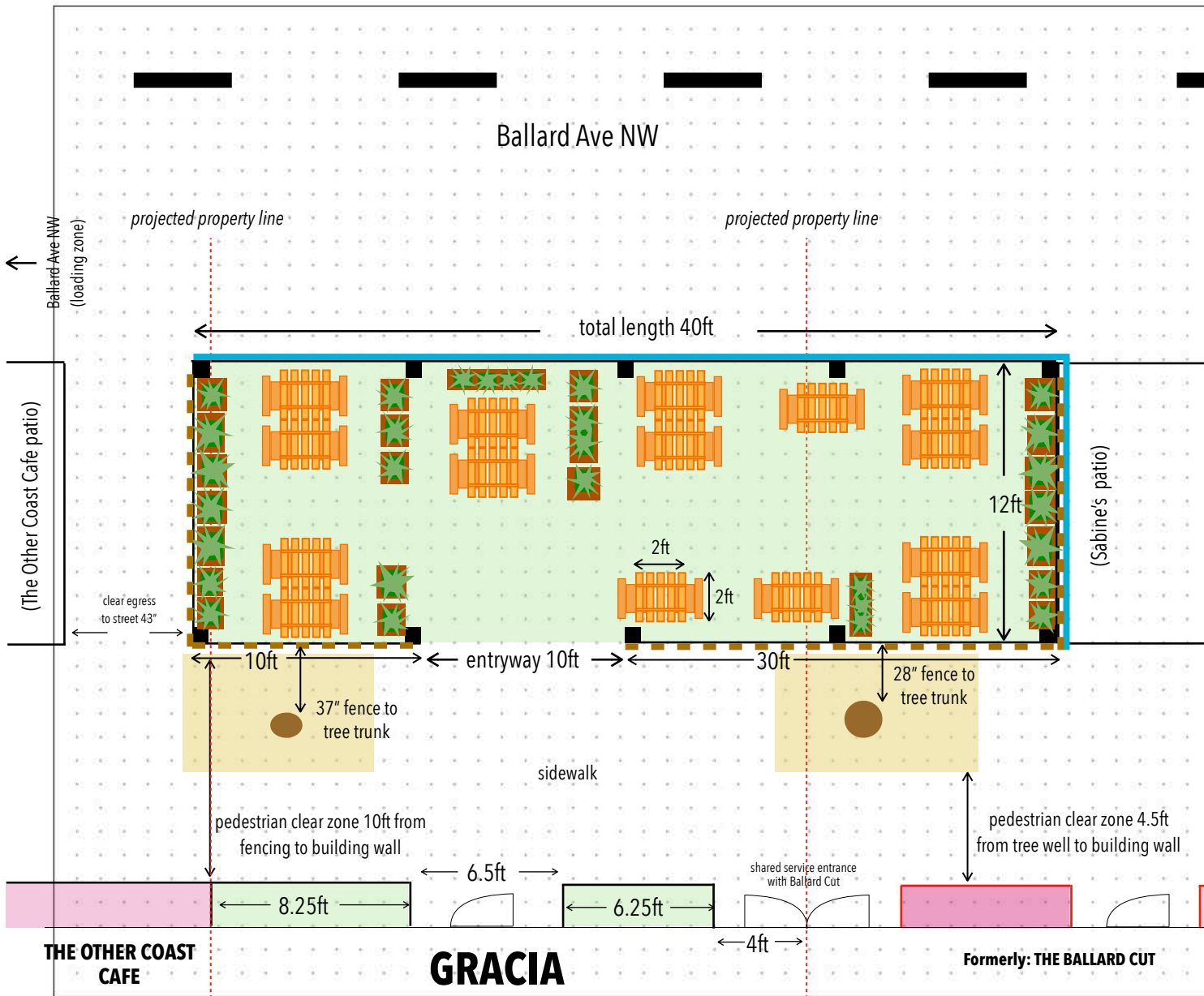

KEY:

- = Gracia footprint
- = tree wells
- = table and chairs
- = moveable planter
- = rain gutter
- = wooden fencing

Seattle Department of Transportation

SDOT Permit Number(s)

(Official Use Only)

SITE PLAN - BLANK

June 2019

24 Hour Contact: Chester Gerl

Phone Number: (206) 268-0217

Project Address: 5313 Ballard Ave NW

Email: graciaballard@gmail.com

- INSTRUCTIONS** - see CAM 2116 for further guidance
- Label all street names.
 - Clearly outline area(s) proposed for use.
 - Show all dimensions for work areas. Include setback distances from curbs, centerlines, driveways, right of way width, etc.
 - List affected street frontages in the table below.

Frontages	Work Area (sq. ft.)	Right of Way Impacts					
		Sidewalk	Planting Strip	Parking Lane	Bike Lane	Travel Lane	Alley
NW 6th St	36' x 16'		X	X			

- Draw existing features on the site plan to the left.
 - Trees, tree pits, drip lines
 - Power poles, cabinets, pay-to-park kiosks
 - Fire hydrants
 - Street fixtures (bike racks, fixed trash containers, etc.)
 - Vaults/meter boxes
 - Areaways
 - Storm drain grates/manhole covers
 - Parking: metered/disabled
 - Loading zones
 - Transit or bus zones
 - Trolley lines/tracks
 - Near curb ramps
 - Marked surfaces

Notes/Inspector Comments:

View from north looking southward

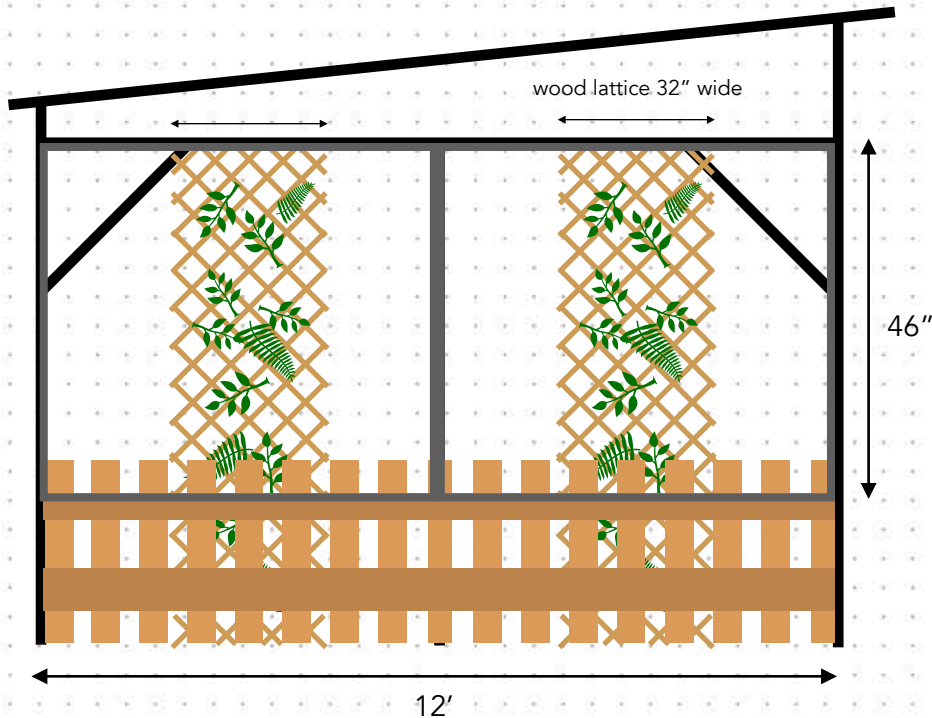

FIGURE 1:

- View looking southward. Fencing between Gracia and The Other Coast Cafe. Current metal fencing to be replaced with wooden 42" tall **Douglas Fir & Cedar Planks** with a 5" wide horizontal toe rail.
- Clear acrylic plexiglass sheeting will be added above fencing for weatherproofing.
- Two decorative wooden latticework adorned with greenery hangs from ceiling to foot on the inside of the patio measuring 32" wide x 91" tall. These allow the guest to feel surrounded by greenery and nature aspects but do not obstruct the view to the surrounding buildings.

View from south looking northward

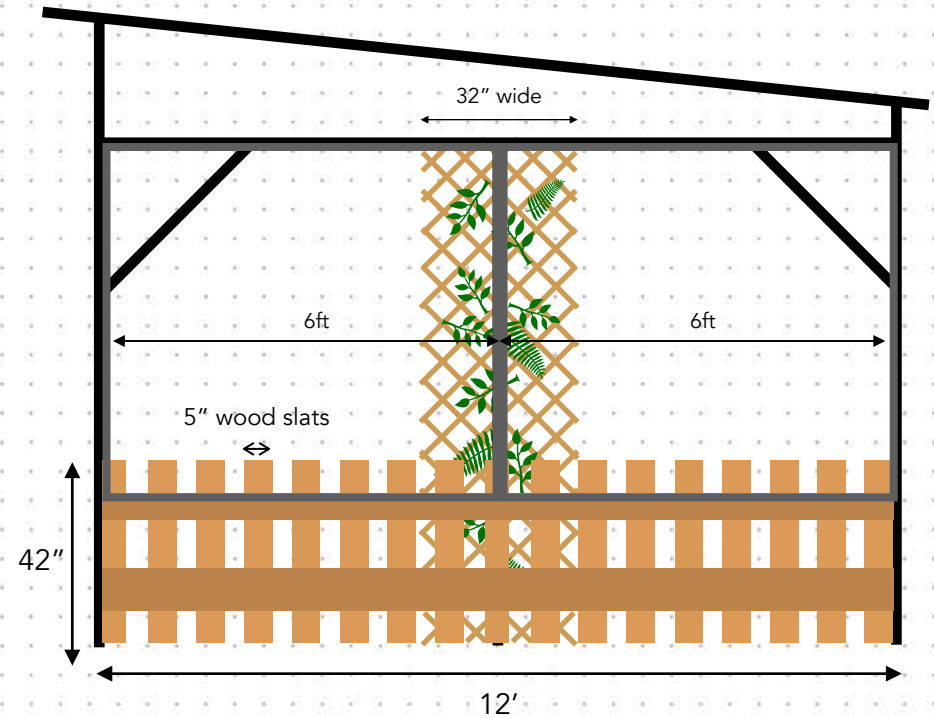
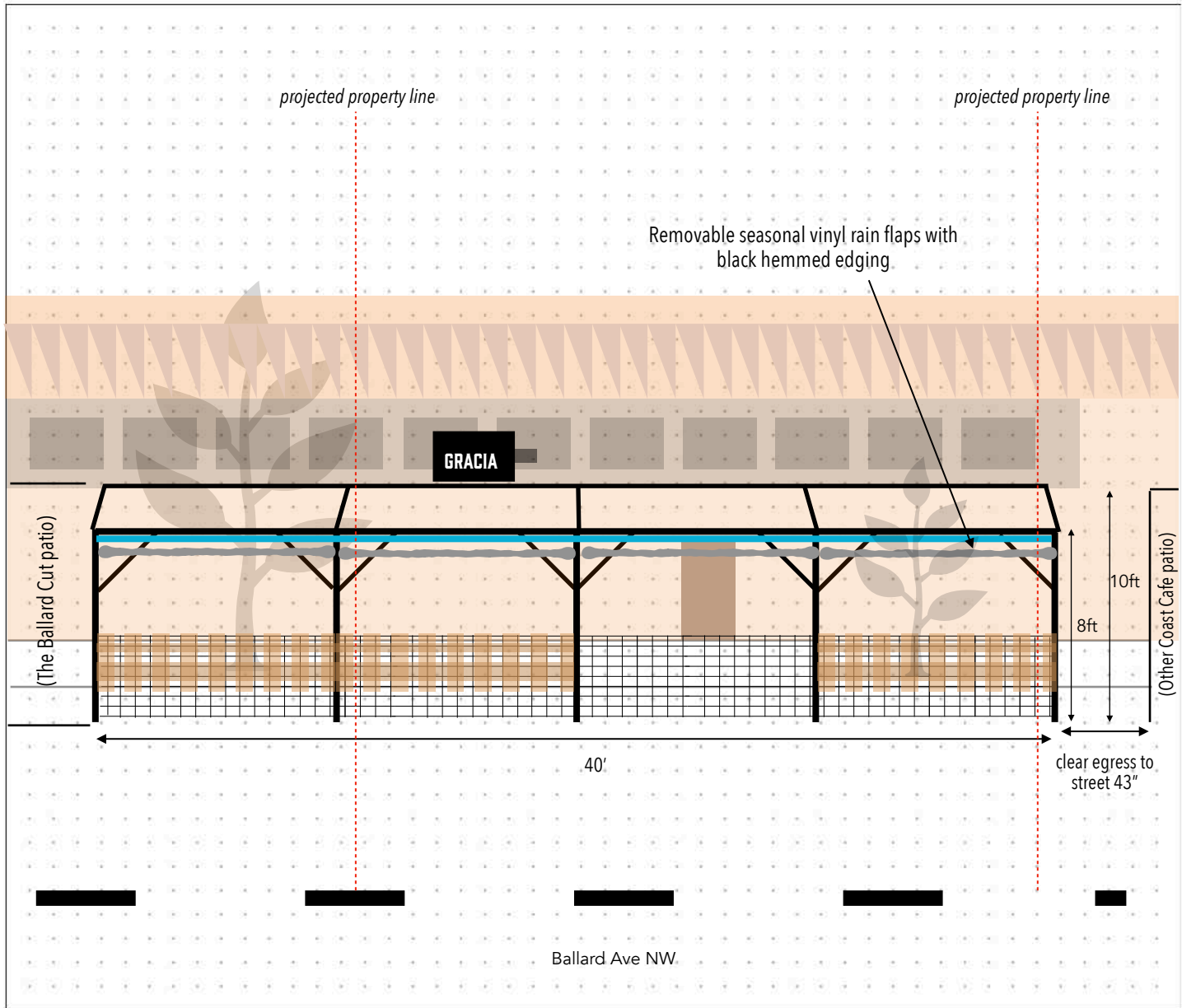

FIGURE 2:

- View looking northward. Fencing between Gracia and Sabine's patio. Current metal fencing to be replaced with wooden 42" **Douglas Fir & Cedar Planks** with a 5" wide horizontal toe rail.
- Clear acrylic plexiglass sheeting will be added above fencing for weatherproofing
- One decorative latticework adorned with greenery hangs from ceiling to foot on the inside of the patio measuring 32" wide x 91" tall. These allow the guest to feel surrounded by greenery and nature aspects but do not obstruct the view to the surrounding buildings.

View from opposite side of street - looking at Gracia



Seattle Department of Transportation
 SDOT Permit Number(s)

 (Official Use Only)
SITE PLAN - BLANK
 June 2017

24 Hour Contact: Jaime Duggan
 Phone Number: (206) 268-0217
 Project Address: 5313 Ballard Ave NW
 Email: graciaballard@gmail.com



- INSTRUCTIONS** - see CAM 2116 for further guidance
1. Label all street names.
 2. Clearly outline area(s) proposed for use.
 3. Show all dimensions for work areas. Include setback distances from curbs, centerlines, driveways, right of way width, etc.
 4. List affected street frontages in the table below.

Frontages	Right of Way Impacts							
	Work Area (sq. ft.)	Sidewalk	Planting Strip	Parking Lane	Bike Lane	Travel Lane	Alley	Unimproved Right of Way
Nw 65th St	36' x 18'			X	X			

5. Draw existing features on the site plan to the left.
- Trees, tree pits, drip lines
 - Power poles, cabinets, pay-to-park kiosks
 - Fire hydrants
 - Street fixtures (bike racks, fixed trash containers, etc.)
 - Vaults/meter boxes
 - Arcaways
 - Storm drain grates/manhole covers
 - Parking: metered/disabled
 - Loading zones
 - Transit or bus zones
 - Trolley lines/tracks
 - Near curb ramp(s)
 - Marked surfaces

Notes/Inspector Comments:

KEY:

-  = rain gutter
-  = rain flaps

View from sidewalk - looking at street cafe patio

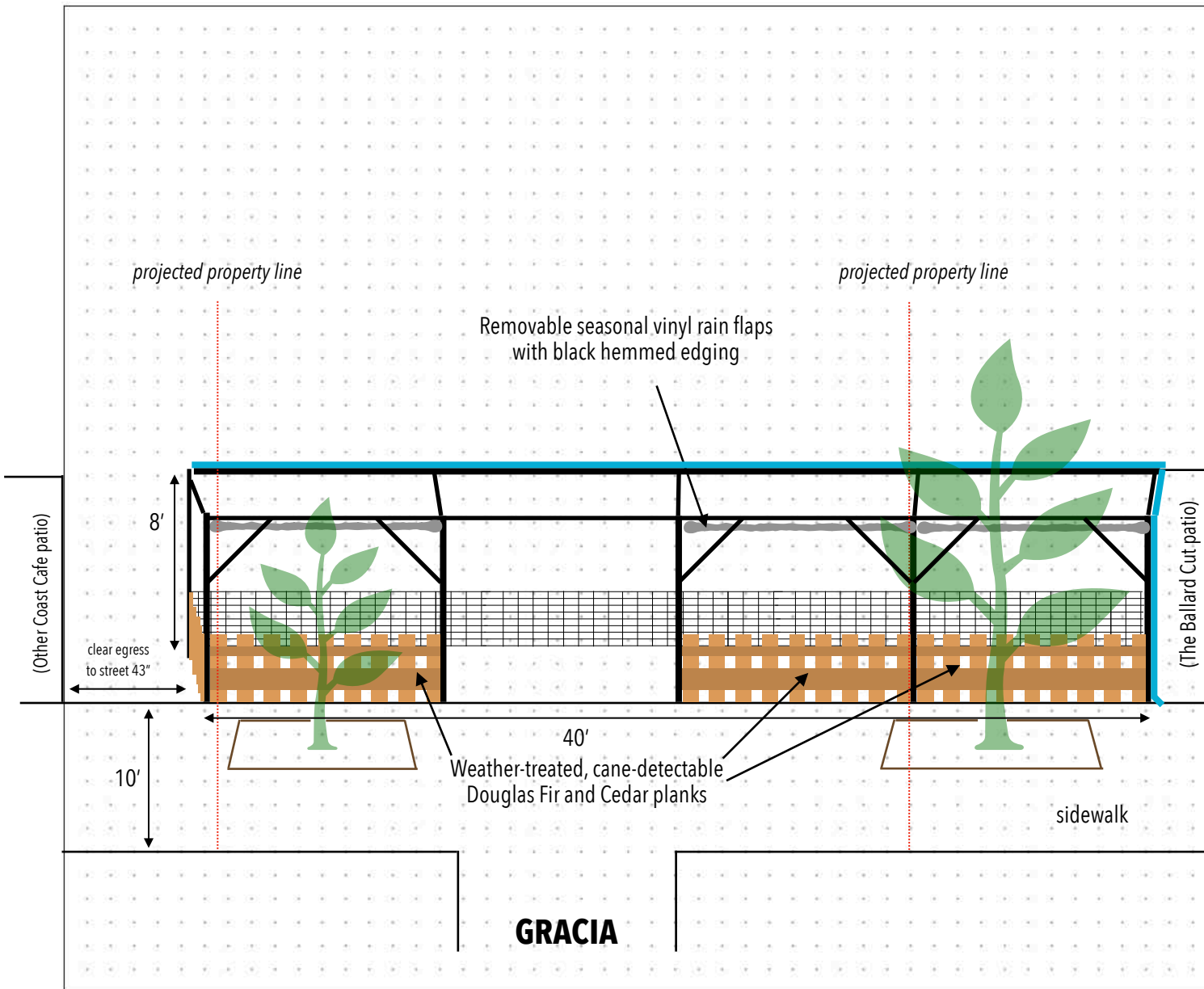

KEY:

- = rain gutter
- = rain flaps

Seattle Department of Transportation

SDOT Permit Number(s)

(Official Use Only)

SITE PLAN - BLANK

June 2019

24 Hour Contact: Jaime Duggan

Phone Number: (206) 268-0217

Project Address: 5313 Ballard Ave NW

Email: graciaballard@gmail.com

- INSTRUCTIONS - see CAM 2116 for further guidance**
- Label all street names.
 - Clearly outline area(s) proposed for use.
 - Show all dimensions for work areas. Include setback distances from curbs, centerlines, driveways, right of way width, etc.
 - List affected street frontages in the table below.

Frontages	Work Area (sq. ft.)	Right of Way Impacts				
		Sidewalk	Planting Strip	Parking Lane	Bike Lane	Unimproved Right of Way
NW 65th St	30' x 10'		X	X		

5. Draw existing features on the site plan to the left.
- Trees, tree pits, drip lines
 - Power poles, cabinets, pay-to-park kiosks
 - Fire hydrants
 - Street fixtures (bike racks, fixed trash containers, etc.)
 - Vaults/meter boxes
 - Areaways
 - Storm drain grates/manhole covers
 - Parking: metered/disabled
 - Loading zones
 - Transit or bus zones
 - Trolley lines/tracks
 - Near curb ramp(s)
 - Marked surfaces

Notes/Inspector Comments: