

John Harte McGraw is honored with a statue, the work of sculptor Richard Brooks of New York in 1913, gift of Col. Bletcher of The Seattle Times and others; (The Times was located at that time across the street: "Times Square.")

A seat-wall extends from two sides of the statue pedestal; a brick enclosed planter box behind contains Annuals, Ivy and two Austrian Black Pines (1963 development).

John H. McGraw (1850-1910) born in Maine, became merchandise clerk at 14, married and came to Seattle via San Francisco in 1876, went into hotel business then became one of four city policemen, became City Marshall then Chief of Police in 1880; elected Sheriff of King County 1882-1890. Meanwhile he studied law and was admitted to bar going into partnership with Judges Roger S. Green and C.H. Hanford. Became president of First National Bank of Seattle. McGraw was elected the second Governor of the State of Washington 1893-1897.\* Then he managed the Yukon River Mining interest and became president of Seattle Chamber of Commerce 1905-'07 and first president of Assoc. of Ch. of Commerce of Pacific Coast 1908-09. In 1874 he married and lived at 1st Av. N. and Prospect St. (terminus of Queen Anne Boulevard). He was a 32 degree Mason.

\* His single campaign issue and slogan was "Dig the Ditch!" (The proposed Ship Canal)

(In 1918 The Olmsted Bros. of Mass. proposed a development plan for "The Monument".)

**WESTLAKE SQUARE:**

Bus-stop Canopy + Benches + Planters  
 Design: Arch. John Morse (Dean of  
 Tile works: family of G.B. Biggestock (brickmason)  
 Fountain sculpture: Joan Johanson  
 Ornamental lights  
 Thornless Honey Locust  
 Permit from Bd. of Pub. Wks. to utilize city property... for a pedestrian mall: -1964  
 (An underground Comfort Station - Bus-stop shelter built here: 1917; demolished and rooms filled in: 1964; last of such public stations in Seattle: others @ Pioneer + Fremont.)  
 Demol. + Improv. = \$47,613 = BF + gifts

Olive Street was named for one of the children arriving with the pioneer party in 1851 on the schooner Exact.  
 Olive Bell; who later married Joseph Stewart for whom Stewart St. is named.  
 (Westlake Av. follows the valley route of the narrow gauge coal train from Seattle to Lake Union and coal barges from the Renton mine.)

**MONORAIL:**

1.3 mi. to Seattle Center  
 Built 1962 for Century 21 World's Fair \$3 1/2 million  
 Downtown Terminal created Westlake Mall: closure of street to autos. Potted trees + benches installed.

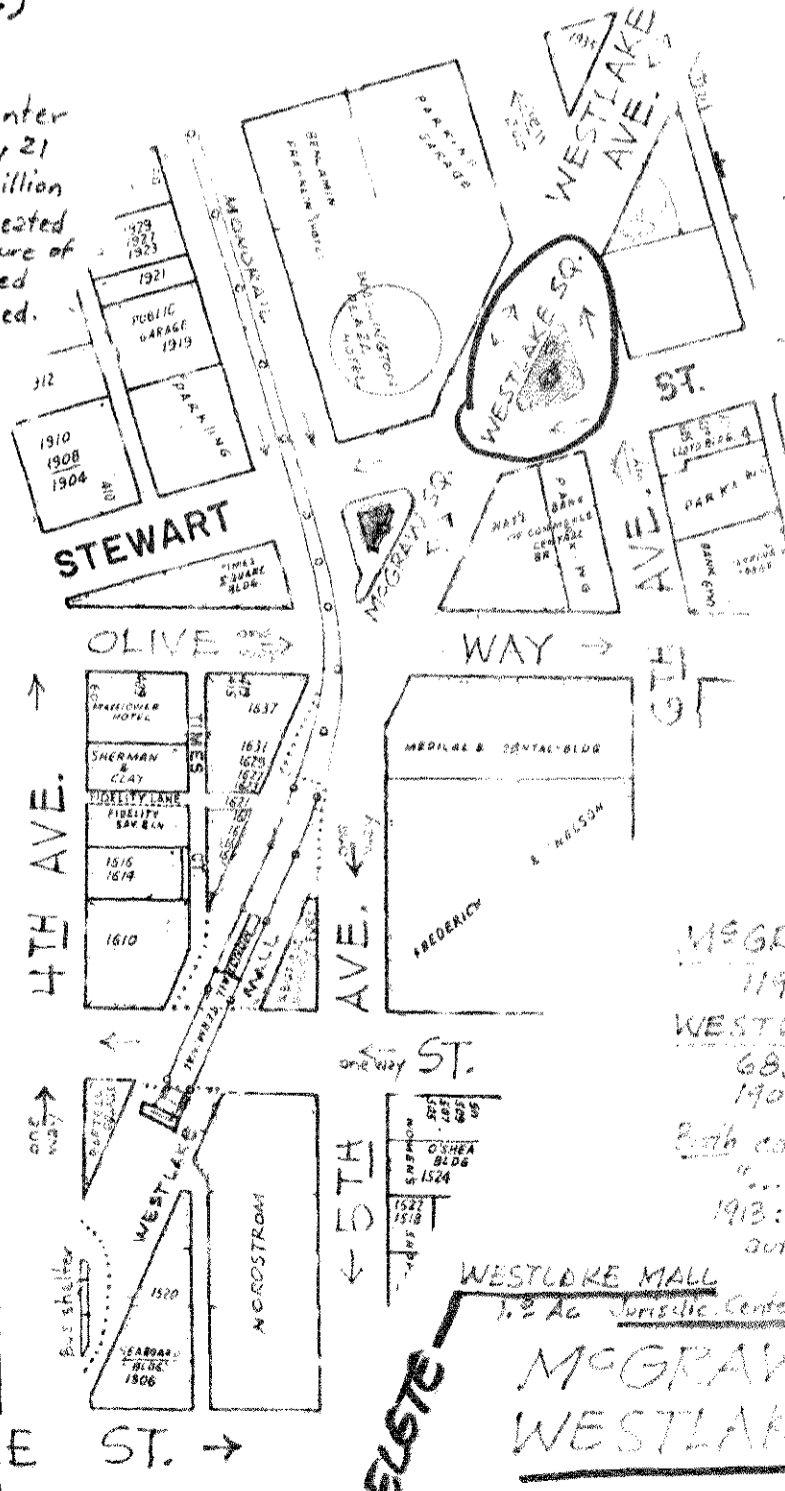

"Times Square" Bldg. is former newspaper plant bldg. 1916-1931

L.I.D. (both)  
 \$12,224 =  
 city - 6,112 =

McGRAW SQ.  
 1190 sq. ft.

WESTLAKE SQ:  
 685 sq. ft.  
 1900 Westlake Av.

Both condemn. 1910  
 "...as a public square..."  
 1913: "jurisdic. + control" by authority Corp. Counsel

WESTLAKE MALL  
 1.2 Ac Jurisdic. Center Dist.

McGRAW SQUARE  
 WESTLAKE SQUARE