

**"MEMORIAL" TREES (= Δ, □ = Plaque)**

- 1 Copper Beech dedicated in 1932 by St. Chap. of Colonial Dames of America in nationwide comm. of 200th anniv. of birth of Geo. Washington (originally included a sundial - octagonal cone. Base remaining: □ in storage yard)
- 2 Dedicated to "The Advancement of Understanding, Goodwill + International Peace Through A World Fellowship of Business + Professional Men United in the Ideal of Service" Planted by Sidney W. Pascall, pres. Rotary Int. June 1932. Planted in honor of Grand Army of The Republic by its Auxiliary the Nat'l Women's Relief Corps: (□ "Langdon" - in storage yard)
- 3 Viola A. Kenyon, provisional president 1885-1888.
- 4 Isaac I. Stevens, Governor of Washington, member of G.A.R.
- 5 Pin Oak dedicated to Anna Clise whose 1919 gift began the notable Orchid collection in the Conservatory. □ Clise Orchid Collection 1921 (in storage shed)
- 6 Oak planted by Eager Beaver Jr. Gardeners, Cub Pack 6, in 1965, sponsored by Citywide Flower Club.
- Citywide Flower Club/Nov. 17, 1932/Mrs. Frank S. Greeley; in storage yard.

"MEMORIAL" ROCK: honors E.O. Schwagerl, supt. + landsc. arch; placed by J. Unkloff.

**OTHER PLAQUES:**

- 1 Spanish-American Volunteers/G. U.S.S. Maine (on rock)
- 2 L.B. Youngs Medallion on Wafer Tower
- 3 (Iron Bench) Mrs. Wm. Pitt Trimble/11-15-1875 to 12-7-1929/ by Wn. State Assoc.
- 4 Chinese Sculpture (3) 1 1/2 @ Seward Monument □ "Black Play sculpture (in stage, @ Conserv. Yard)

**LAKEVIEW CEMETERY (Inc. 1872)** (Gravesites of many pioneers) (Wading Pool is 1973 replacement of Depl's 1st Pool, built in 1910)

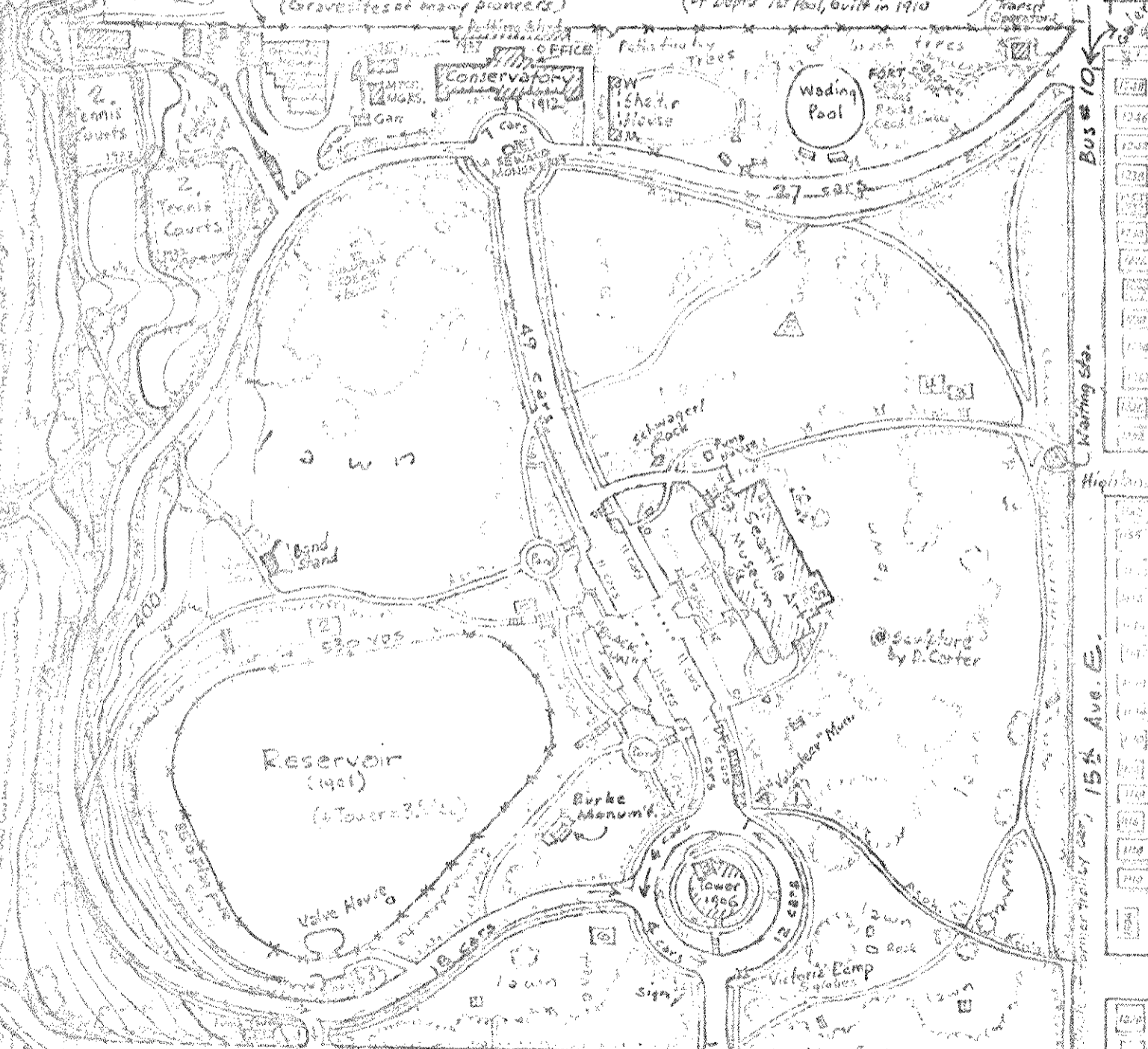
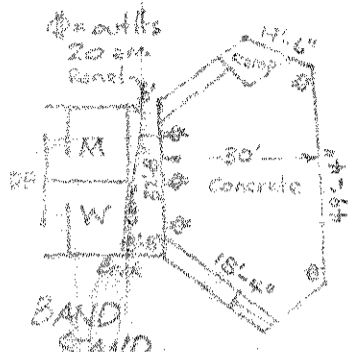

4/6  
 5 Acres (Reservoir + Tower Excluded)  
 1876: 40 Ac. Park in J.M. Colman sawmill engr. did not specify usage. (# 2000+ GF)  
 1885: Ord. 642 - purpose: "Washelli Cemetery"  
 1887: Ord. 277 - changed to "Lake View Park" ordered removal of grave sites.  
 1901: Ord. changed name from "City Park" to "Volunteer Park" to honor Veterans of Spanish-American War (1898-1902).

Feetings 3' vertical  
 Street ground level 13'6"  
 is high point of  
 Capitol Hill 51.4' (1911)  
 (Top tower = 51.5' (1906))

464

447-4710 Museum  
 625-4043 Office (Horticulture + Grounds Office)  
 1400 E. Prospect St.  
**VOLUNTEER PARK**

## VOLUNTEER PARK - History

In 1876 the City purchased 40 acres for \$2,000 from a sawmill engineer, J. M. Colmar (Colman Park) without specifying purpose other than "Municipal". Ordinance 642 in 1885 defined the purpose as "Washelli Cemetery" but two years later it was changed to "Lake View Park" and gravesites were ordered removed. By 1893 the Department had cleared about six acres of timber and planted a nursery supplemented with a greenhouse and hotbed. In 1893 the Park Commissioners petitioned City Council to sell the park in order to buy Bailey Peninsula (Seward Park) as more suitable, because this park was "exceedingly high and dry" - only a small stream on the west side of the hill, "its isolated position and excessive cost of maintenance." Council rejected the petition.

The hilltop location was an ideal site for the Water Department to build a reservoir in 1901. The water tower standpipe was built in 1906 and became a favorite observation tower (closed during wartimes for security reasons). By 1918 a second reservoir was "imperative" to the needs of a growing city; two years of opposition by Park Board, 9th Hill and the public, and finally by the decision of Judge Allen in 1920. In 1941 three incredulous fire companies were summoned to a blazing all brick and concrete water tower! Dragging hoses and extinguishers up the narrow winding stairs, they found two containers - oil and kerosene - on the observation deck. A witness reported two men running from the tower just after the outbreak of flames.

In 1904 the Olmsted Bros. developed plans for Volunteer Park featuring a main concourse occupying the elongated hilltop, formal gardens related to the water feature of the reservoir, and a circuit drive forming approaches to the concourse as well as intending to extend to Washington Park. Feature of the concourse/water orientation was a long vine-covered pergola with a bandstand and comfort stations.

Music in parks has been part of the Seattle scene since Yesler's Sawmill and Pioneer Square were founded. Music was an important part of the 1909 AYP Exposition and so it was continued all over the city, especially here. The pergola bandstand had no acoustic qualities and was small, so in 1915 a larger, ornate, roofed bandshell was built on the site of the present platform. It became the setting for many activities: Easter Sunrise services, Americanization programs, as well as various musical productions. Maintenance and repairs multiplied until finally the bandshell was demolished in 1949 and replaced with the present pipe-frame platform with portable acoustic "splays" and amplifications.

In 1910 there was a strong proposal to build a Washington State Museum of Art in Volunteer Park - vigorously opposed by the Olmsted Bros. So the museum "waited" until 1932 when it was built as a gift from Mrs. Eugene Fuller and her son, Dr. Richard E. Fuller. By agreement with the Art Institute which provides a public museum of art objects, the Department provides water, light, heat, janitorial and custodial services, and building repairs. ADT burglar alarm system added in 1949. Remodeling and additions to the museum have been largely additional gifts of the Fullers, but new equipment cost was borne by the City. Admission charges must be approved by City ordinance. The conflict foreseen by the Olmsteds of placing a building in a "landscape park" that did not aid in the enjoyment of that landscape has proven true. The museum replaced the vine-covered pergola on the main concourse. Paths had been paved with cinders and by the 1940s damage to the museum floors was evident so a (slow) program of asphaltting paths began.

The community petitioned for a children's play area, so the Olmsteds "leveled" the southwest side (recommending acquisition of property along Federal Avenue) and installed play equipment with two concrete stairs down from the drive. Another play area was developed at the northeast corner with a wading pool, swings and pergola comfort stations. The east side of the park was thickly planted to prevent children from running into the double streetcar tracks at the end of the park, terminating just to the north. A picturesque "mushroom" waiting station was built at mid-point of the east side (restored in 1968).

continued

**"MEMORIAL" TREES (= Δ, □ = Plaque)**

- 1. Copper Beech dedicated in 1932 by St. Chap. of Colonial Dames of America in nationwide comm. of 200th anniv. of birth of Geo. Washington (originally included a sundial-octagonal conc. base remaining; □ in storage yard)
- 2. Dedicated to "The Advancement of Understanding, Goodwill + International Peace Through A World Fellowship of Business + Professional Men United in the Ideal of Service" Planted by Sidney W. Pascall, pres. Rotary Int. June 1932. Planted in honor of Grand Army of The Republic by it's Auxiliary the Nat'l Womens Relief Corps: (□ "Langdon" - in storage yard)
- 3. Viola A. Kenyon, provisional president 1885-1888.
- 4. Isaac I. Stevens, Governor of Washington, member of G.A.R.
- 5. Pin Oak dedicated to Anna Clise whose 1919 gift began the notable Orchid collection in the Conservatory. □ Clise Orchid Collection 1921 (in storage shed)
- 6. Oak planted by Eager Beaver Jr. Gardeners, Cub Pack 6, in 1955, sponsored by Citywide Flower Club.
- 7. Citywide Flower Club/Nov. 17, 1932/Mrs. Frank S. Greely: in storage yard.

**"MEMORIAL" ROCK: honors E.O. Schwagerl, supt. + landsc. arch; placed by J. Unkeoff.**

**OTHER PLAQUES:**

- 1. Spanish-American Volunteers/G. U.S.S. Maine (on rock)
- 2. L.B. Youngs Medallion on Water Tower
- 3. (Iron Bench) Mrs. Wm. Pitt Trimble/11-15-1875 to 12-7-1929/ by Wn. State Assoc.
- 4. Chinese Sculpture (3) @ Seward Monument □ "Black Play sculpture (in slye. @ Contry. Yard)

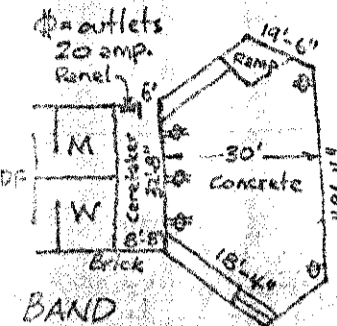

**BAND STAND**

**LAKEVIEW CEMETERY (Inc. 1872)** (Gravesites of many pioneers) (Wading Pool is 1973 replacement of Dept's 1st pool, built in 1910)

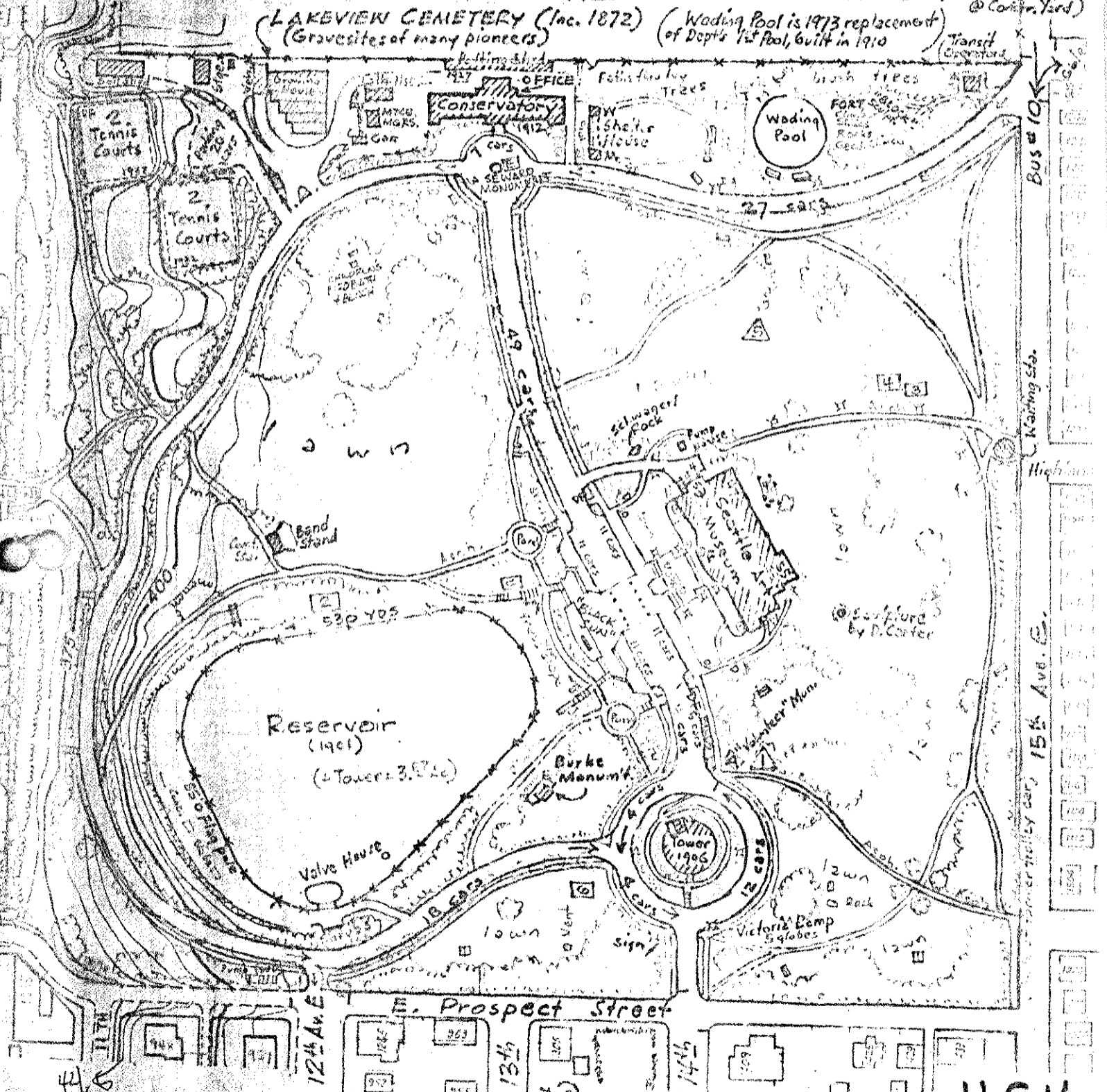

**3 Acres [Reservoir + Tower Excluded]**  
 1876: 40 Ac. Purch. fr. J.M. Colman, sawmill engr. did not specify usage. (# 2,000 GF)  
 1885: Ord. 642 - purpose: "Washelli Cemetery"  
 1887: Ord. 877 - changed to "Lake View Park" ordered removal of grave sites.  
 1901: Ord. changed name from "City Park" to "Volunteer Park" to honor Veterans of Spanish-American War (1898-1902)

Paths = 3 mi. total  
 Street around Tower 13 1/2 mi  
 is high point of Capitol Hill = 1,444 (Top tower = E. 155 ft)

**464**  
 447-4710 Museum  
 625-4043 Office (Horticulture + Grounds Office)  
 1400 E. Prospect St.  
**VOLUNTEER PARK**

## VOLUNTEER PARK - History

In 1876 the City purchased 40 acres for \$2,000 from a sawmill engineer, J. M. Colman (Colman Park) without specifying purpose other than "Municipal". Ordinance 642 in 1885 defined the purpose as "Washelli Cemetery" but two years later it was changed to "Lake View Park" and gravesites were ordered removed. By 1893 the Department had cleared about six acres of timber and planted a nursery supplemented with a greenhouse and hotbed. In 1893 the Park Commissioners petitioned City Council to sell the park in order to buy Bailey Peninsula (Seward Park) as more suitable, because this park was "exceedingly high and dry" - only a small stream on the west side of the hill, "its isolated position and excessive cost of maintenance." Council rejected the petition.

The hilltop location was an ideal site for the Water Department to build a reservoir in 1901. The water tower standpipe was built in 1906 and became a favorite observation tower (closed during wartimes for security reasons). By 1918 a second reservoir was "imperative" to the needs of a growing city; two years of opposition by Park Board, Sam Hill and the public, and finally by the decision of Judge Allen in 1920. In 1941 three incredulous fire companies were summoned to a blazing all brick and concrete water tower! Dragging hoses and extinguishers up the narrow winding stairs, they found two containers - oil and kerosene - on the observation deck. A witness reported two men running from the tower just after the outbreak of flames.

In 1904 the Olmsted Bros. developed plans for Volunteer Park featuring a main concourse occupying the elongated hilltop, formal gardens related to the water feature of the reservoir, and a circuit drive forming approaches to the concourse as well as intending to extend to Washington Park. Feature of the concourse/water orientation was a long vine-covered pergola with a bandstand and comfort stations.

Music in parks has been part of the Seattle scene since Yesler's Sawmill and Pioneer Square were founded. Music was an important part of the 1909 AYP Exposition and so it was continued all over the city, especially here. The pergola bandstand had no acoustical qualities and was small, so in 1915 a larger, ornate, roofed bandshell was built on the site of the present platform. It became the setting for many activities: Easter Sunrise services, Americanization programs, as well as various musical productions. Maintenance and repairs multiplied until finally the bandshell was demolished in 1949 and replaced with the present pipe-frame platform with portable acoustic "splays" and amplifications.

In 1910 there was a strong proposal to build a Washington State Museum of Art in Volunteer Park - vigorously opposed by the Olmsted Bros. So the museum "waited" until 1932 when it was built as a gift from Mrs. Eugene Fuller and her son, Dr. Richard E. Fuller. By agreement with the Art Institute which provides a public museum of art objects, the Department provides water, light, heat, janitorial and custodial services, and building repairs. ADT burglar alarm system added in 1949. Remodeling and additions to the museum have been largely additional gifts of the Fullers, but new equipment cost was borne by the City. Admission charges must be approved by City ordinance. The conflict foreseen by the Olmsteds of placing a building in a "landscape park" that did not aid in the enjoyment of that landscape has proven true. The museum replaced the vine-covered pergola on the main concourse. Paths had been paved with cinders and by the 1940s damage to the museum floors was evident so a (slow) program of asphaltting paths began.

The community petitioned for a children's play area, so the Olmsteds "leveled" the southwest side (recommending acquisition of property along Federal Avenue) and installed play equipment with two concrete stairs down from the drive. Another play area was developed at the northeast corner with a wading pool, swings and pergola comfort stations. The east side of the park was thickly planted to prevent children from running into the double streetcar tracks at the end of the park, terminating just to the north. A picturesque "mushroom" waiting station was built at mid-point of the east side (restored in 1968).

continued

## VOLUNTEER PARK - History (continued)

The two lily pools were designed as ornamental fountains circled with pavement. A number of children fell into them and many dogs were reportedly drowned while chasing goldfish - apparently the reason that a perimeter hedge replaced the pavement. In 1928 the Park Board authorized a crow hunt by a citizen to reduce the great size of the flock.

DS:d 10/27/72

**VOLUNTEER MONUMENT:** ordinance in 1901 changed the name from "City Park" to Volunteer Park to honor the volunteers of the Spanish-American War (1898-1902). The granite boulder was erected in 1952, promoted by J. Willis Sayre, editor, concert and theatre manager, historian and veteran, through the United Spanish War Veterans (designed by Cassius Beardsley). Plaque on the other side of rock is case from metal of the battleship of that 1898 war, the U.S.S. Maine. Monument was originally on the site of "Black Sun"; relocated in 1971. (The other half of rock is at Sunset Hill Park: Fishermen's Plaque.) (It was a festive, bawdy, gold rush mood in 1898 when the Spanish allegedly sank the battleship Maine; in a burst of ecstatic war fever more than were needed volunteered to fight.)

**ART MUSEUM:** Gift to City in 1932 from Mrs. Eugene Fuller and son, Dr. Richard Fuller. \$250,000; C. F. Goulf, Architect. Additions given in 1947, 1953, 1955 and 1968. World renowned collection of Japanese art. "BLACK SUN" by Isamu Noguchi (1969), black Brazilian granite (41,888 lb.), third major outdoor work in U.S., commissioned by Foundation for Arts and Humanities. "Black (setting) Sun" is sister to Yale's "White (rising) Sun"; writhes with organic energy, subtle contours, and sifting balance of volume. **CHINESE SCULPTURE** in museum yard is from 15th and 16th century. "RIVALRY OF WINDS" cedar sculpture by Dudley Pratt, c. 1930. Placed 1955.

\* **SEWARD SCULPTURE** and pedestal by Richard Brooks of New York honors William Seward who was instrumental in purchase of Alaska in 1867. Statue was a feature of the 1909 AYP Exposition held on the U.W. grounds; moved to this location in 1910 (Bailey Peninsula was purchased in 1911 - later named Seward Park). Sculpture financed by public subscription, sponsored by G. G. Beninghauser (jeweler), Meany, McGraw, et al.

\* **BURKE MONUMENT:** bas relief by Herman McNeil, pedestal-bench-plaza by C. F. Gould, architect. Dedicated in 1930 to honor pioneer Judge Thomas Burke (1849-1925) - "patriot, jurist, orator, friend, patron of education", promoter of Pacific Rim harmony and trade; instrumental in bringing transcontinental railroad to Seattle. \$50,000; memorial contributed by admirers of Judge Burke.

"**BLOCK**" **PLAYSCULPTURE** by Chas. Smith, U.W. sculptor, 1962. Honors Dorothy W. Block (1926-1961) for her interest in and activities with children; Park Commissioner 1959-1961. Sculpture sponsored by Block Foundation.

**CONSERVATORY:** Outstanding display of flowering plants from all areas of the world, notable orchid collection began as gift from Anna H. Clise in 1919; 600 varieties. Conservatory built in 1912.

**WATER TOWER:** Built by Water Department 1906, reservoir in 1901. 106 steps to observation deck. 75½' above road pavement at base (top elev. 520') (Space Needle top elev 725'); pavement at elevation 444.5' is high point of Capitol Hill. **MEDALION** on north side honors L. B. Youngs, first Superintendent of Water Department (1895-1923) and Superintendent of Light Department (1904-1910); bronze by V. T. Goumas.

**BANDSTAND:** Music in Parks began in pioneer days in Pioneer Square, became a feature of the 1909 AYP Exposition; the Olmsteds included a bandstand in their design of this park and concerts have been a feature here since then.

continued

VICTORIA LAMP: Five-globe light at 14th Avenue entrance; gift of City of Victoria in 1965; one of famed Hanging Flower Basket Light Standards near Parliament Buildings since 1937.

CAPITOL HILL: District name originated on first (1901) plat on hill by J. A. Moore to honor Capitol Hill of Denver, Colorado (plat just south of park).

DEVELOPMENT: Between 1887 and 1904 the park was improved with paths, lawns, beds of flowers, settees and tables for picnickers, and children's swings, together with native growth, the only greenhouse in the system, and the high pressure reservoir. 1904-1909 the Olmsted Bros. prepared formal plans - gardens, system of macadam drives, lily ponds, children's wading pool and shelter, combination pergola, music pavilion and comfort station, and conservatory building - all completed by 1912.

DS:d  
10/3/73

At the turn of the 20th Century, this portion of 14th Avenue was known as "Millionaires' Row" and was privately owned, with an imposing gate at Roy St. and shrubs neatly planted down the center of 14th. The Row was an exclusive, detached, stately, beautiful neighborhood of 600,000 mansions (in 1900) complete with carriage houses. Barons of Industry lived there: White, Stuart, Skinner, Eckstein, Cobb, Burwell, Schaefer; in 20 room mansions containing granite masonry + woodwork, 7 fireplaces, 6 bathrooms, Italian glass with leaded panes, heavy beam construction; with hitching posts for four horse-drawn carriages and curved stepping stones for the ladies to enter or leave the carriage. The Row was built by the elite of tourist bases and persons like President Harding. (Note hitching post + carriage step in front of 627.) Gradual encroachments of Apartment Zoning are threatening to obliterate The Row as well as other mansions in the Capital Hill area.

465

2.52 Acres  
 1934; Transf. jurisd. to Park Dept.  
**VOLUNTEER PARKWAY**  
 ("Millionaires' Row")

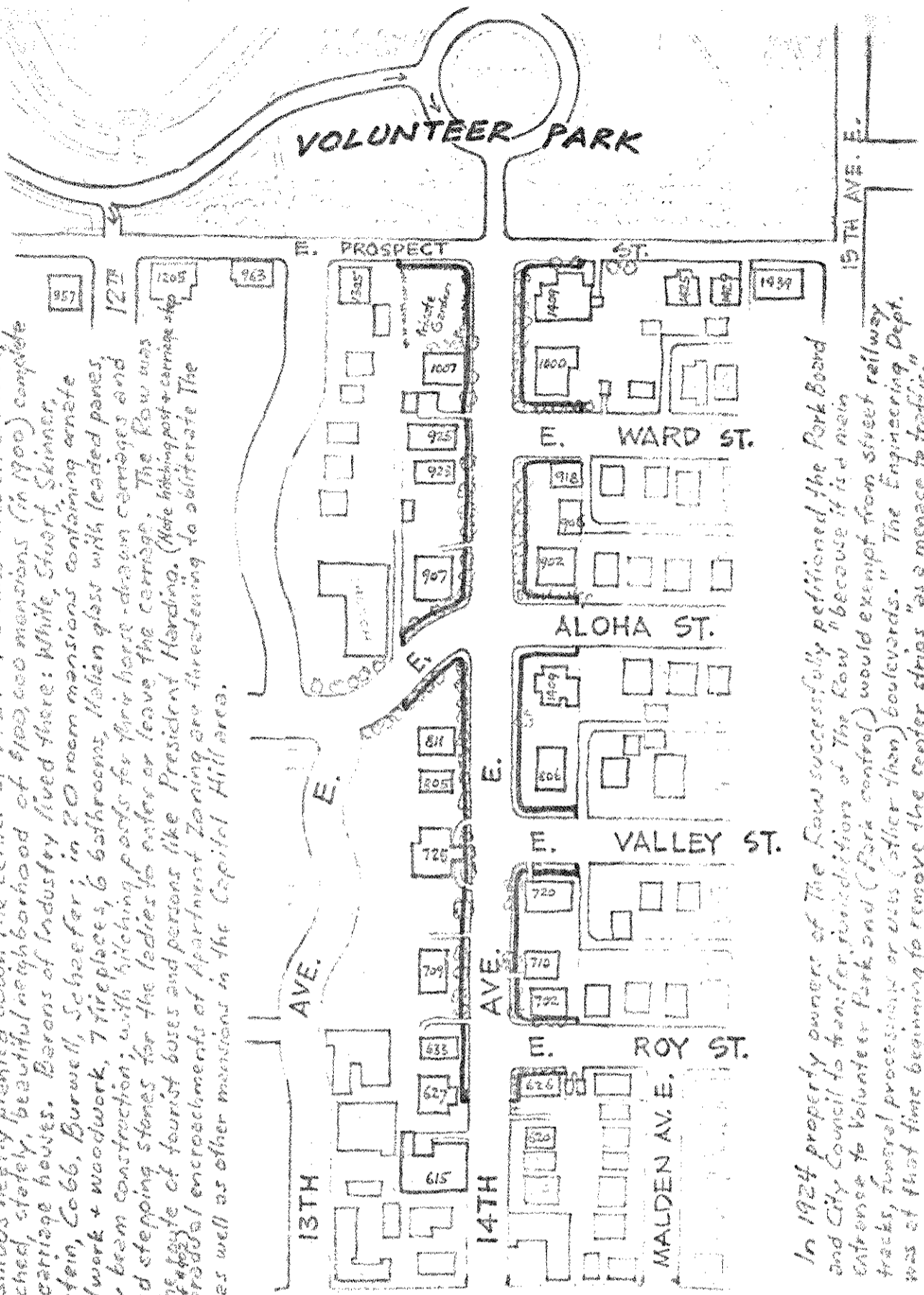

072076