

Playfield takes its name from the community which was named by the Realtor and developer Harry Whitney Treat to honor his daughter LOYAL (who became Mrs. P. K. Nichols, to reside in California). In her honor he named "Loyal Heights", "Loyal Avenue" and "Loyal Way" - route of the "Loyal Railway" (electric car line from Ballard to Golden Gardens Park; to sell real estate along the route).

¹⁸⁶⁹⁻¹⁹²² Harry and ¹⁸⁷²⁻¹⁹⁴³ Olive Graef Treat came to Seattle in 1904. An avid horseman he founded the Seattle Horse Show Assoc. + Hunt Club, was active in the Seattle Golf, Tennis, Rainier, University and Sunset Clubs. Was among the founders of Orthopedic Hospital. The Treat mansion was the most expensive to that date. Mr. Treat died in an auto accident in 1922. Mrs. Treat's father was ("Mr. Bubbles") U.S. importer of Mumm's Champagne. [C.F. Treat was first mayor of Ballard: 1890]

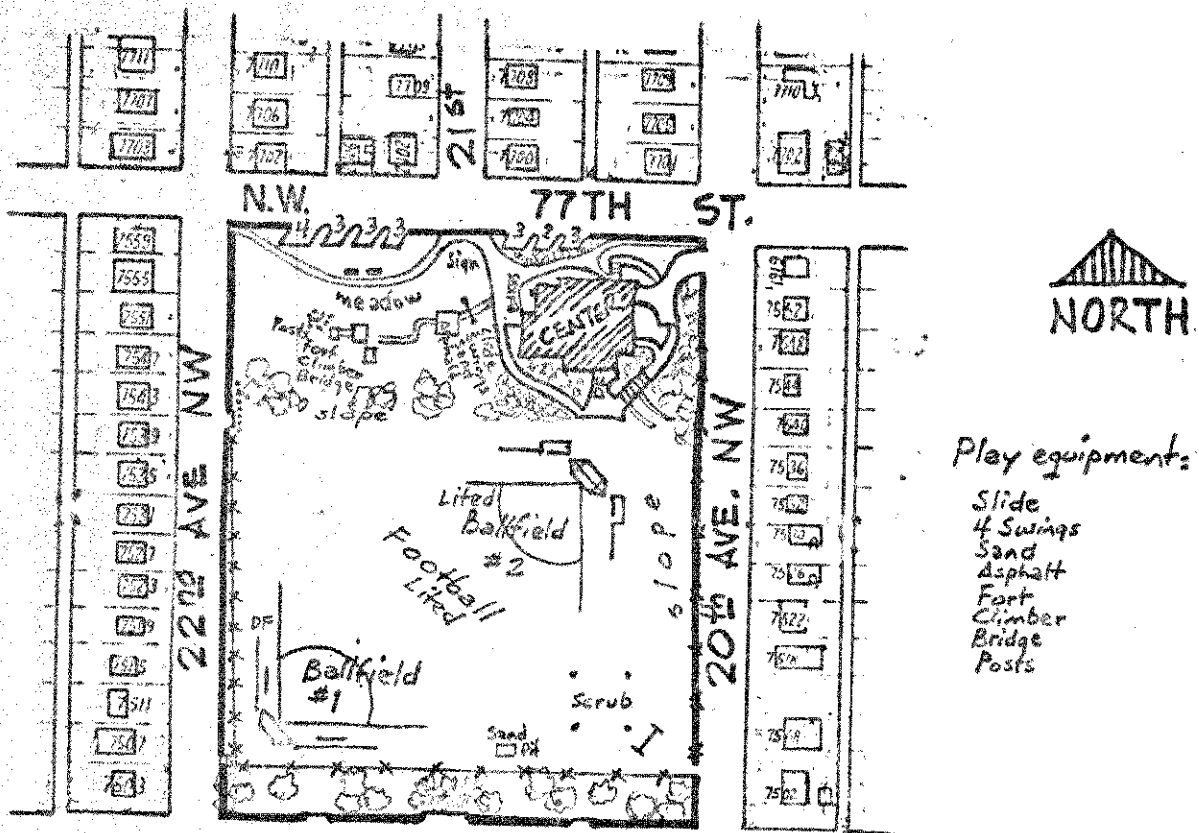

- Play equipment:
- Slide
 - 4 Swings
 - Sand
 - Asphalt
 - Fort
 - Climber
 - Bridge
 - Posts

216

Magnificent View of Mt. Rainier

COMMUNITY CENTER 614 1950: \$333,698 =
 2033 NW 77th STREET '48 BF + GF
 782-1819
 Auditorium/Gym 61' x 102' + stage = 889 persons
 Lounge 32' x 50'
 2 Social rms w/ fireplace 33' x 53' / 33' x 45'
 Kitchette

5.7 Acres ± 29,130 =
 Condemn. 1941 (\$17,267 = L10)
 "...for park + playgr. purp."

45' flag staff on bldg.

LOYAL HEIGHTS P.F.

082476