

GREEN LAKE = 341.9 AC (2.1 Lake)  
 WOODLAND = 187.9  
 Combined = 529.8 ACRES

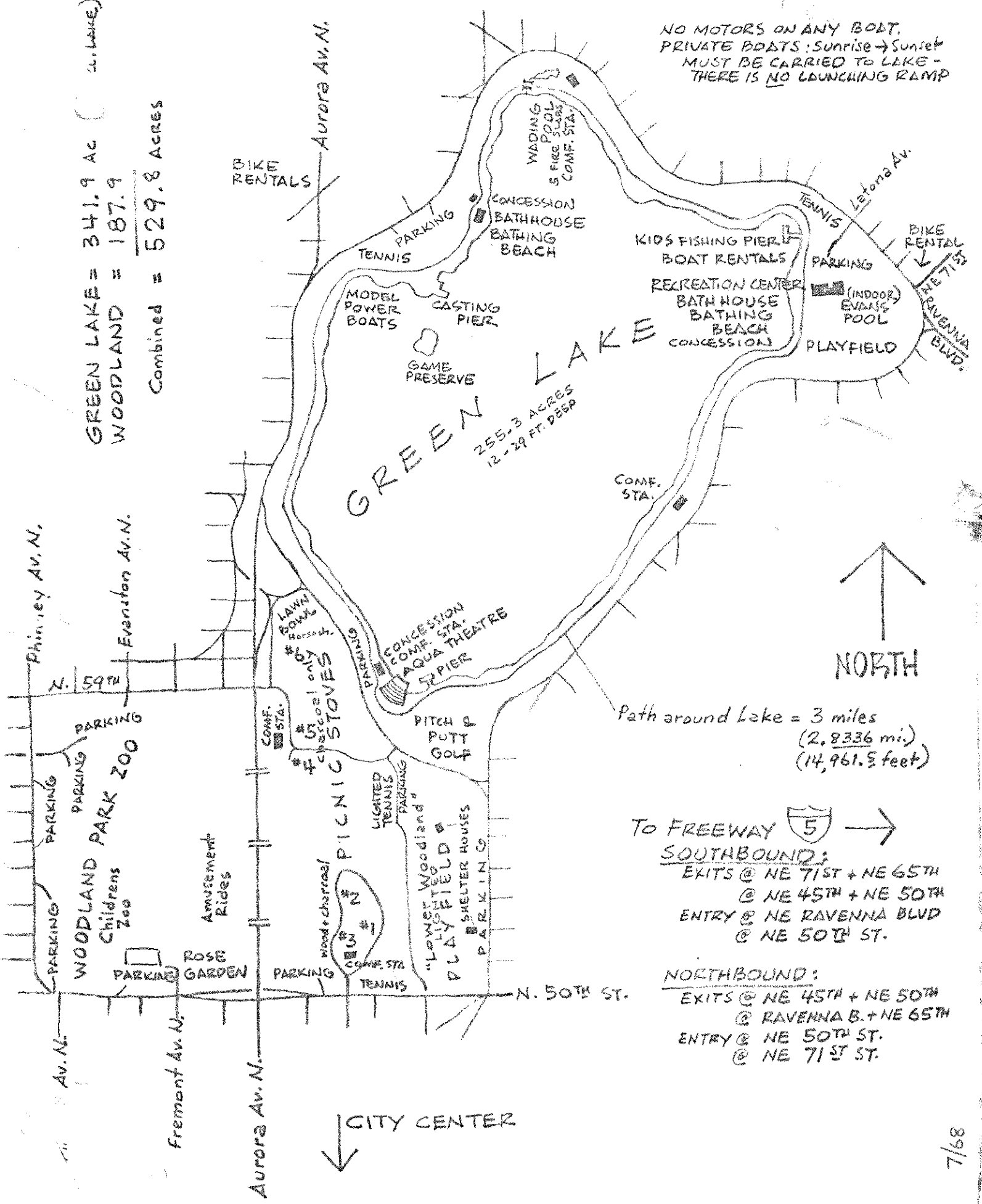

# GREEN LAKE/WOODLAND PARKS

Sheet 1

7/68

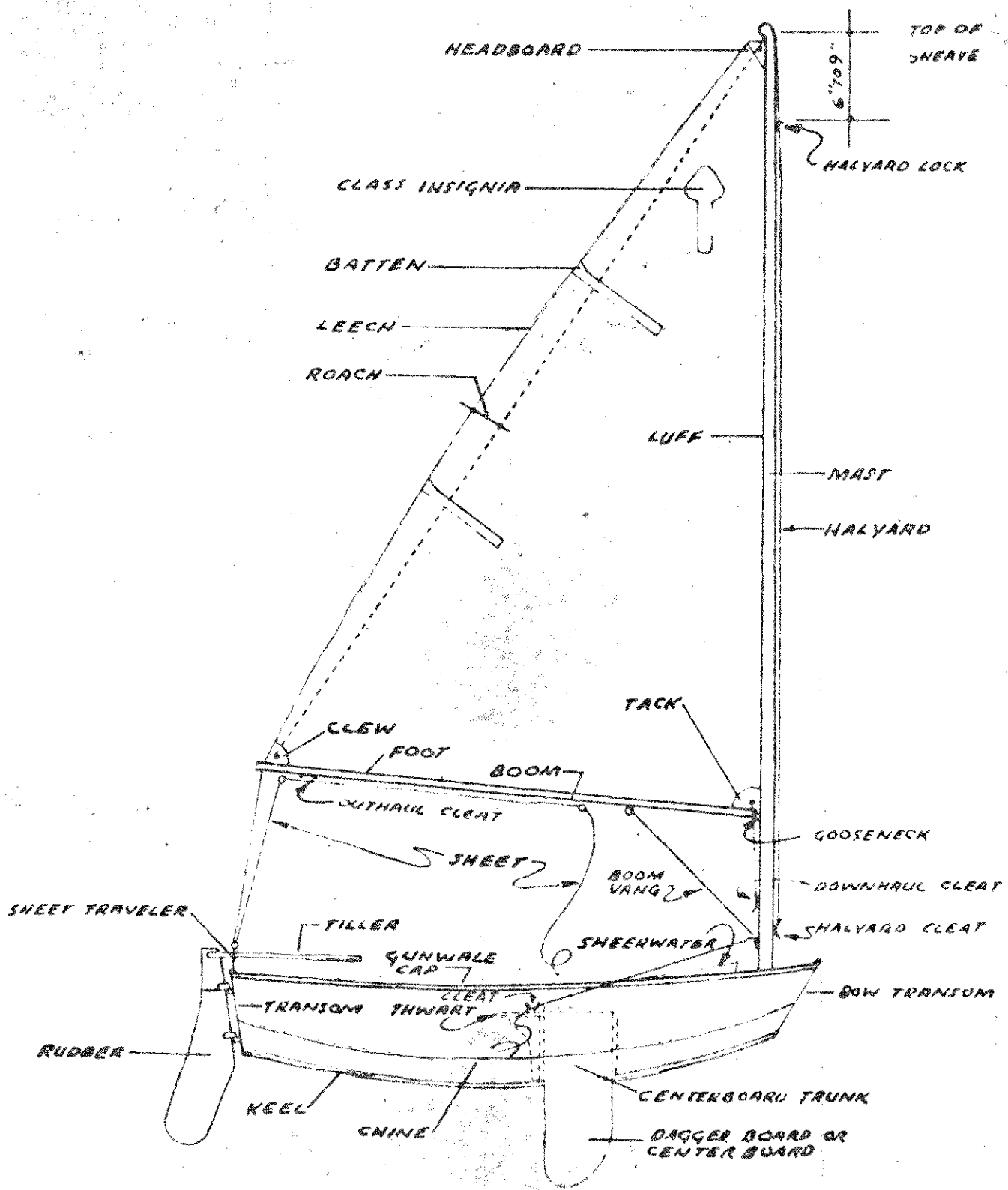

**EL TORO RACING DINGHY**

## GREEN LAKE & PARK:

Originally formed by "Vashon Glacial Ice Sheet", 50,000 years ago. The melt off formed "Lake Russell" whose drainage cut (Ravenna Pk) ravine; glacial basins left include "Lake Green (50' deep)", Bitter Lake, Haller Lake, Puget Sound, etc. Deposits of volcanic ash from (10,436 ft.) Glacier Peak eruption 6,700 years ago have been found on bottom. By natural processes the lake is maturing to extinction: increasing shallowness and natural refuse (+ recent human) have nurtured the objectionable algal blooms, as the name of the lake would indicate - (res 1857 map of Washington Territory by Surveyor General). In 1911 the level of the lake was lowered by 6 ft. and 1,240,000 cu. yds. of fill made behind 2 mi. of dykes @ N. & E. side: taken from uplands to north and by dredging. South end filled when Aurora Ave. was "excavated" thru park in 1930. Bottom and shoreline dredged again in 1962 and several inlets from the Green Lake and Maple Leaf Reservoir overflows were added for water circulation in an effort to rid the lake of its "itchy" algae (av. 9 million gals/day). In pioneer days the lake was fed by springs + creeks draining the forested shorelands and basin northward past Linton Springs to Haller + Bitter Lakes; its outlet followed the "Lake Russell" cut along (Ravenna Blvd) filled in 1911 and (Ravenna Park) to Union Bay (now Univ. Village). Septic tank seepage forced the largest ("Linton Springs") stream into a sewer; in 1922 the overflow from Reservoirs was diverted into the Lake plus chemical treatment.

The pioneer homesteader was Ethart ("Green Lake John") Saifried, living on the northwest shore, who sold out in 1888 to realtor W. D. Wood and electrical engineer Dr. Edw. C. Kilbourne. Wood <sup>Green</sup> subdivided the area, locating an "Amusement Park" at (West Green Lake). A. L. Parker built a sawmill at (East Green Lake) (Woodland Station) and logged the area. Kilbourne built an electric trolley car line "all the way" from Seattle, skirting the eastern shore of the lake (E. Green Lake Way N.) ending at the "Amusement (Picnic mostly) Park". By 1910 the trolley line had been extended around the west side of the lake and through Woodland Park (purchased by the City in 1900) to Woodland Park Av. N., returning to Seattle. A stone bulkhead for a trestle south of 59th still remains. Meanwhile (1889) Guy Phinney had also constructed an electric trolley line to his private Woodland Park and home Estate, as well as developing the south shoreline of the lake with "park" facilities.

In preparation of the City for the 1909 Alaska-Yukon-Pacific Exposition on the (University of Washington) grounds the famed Massachusetts firm of Landscape Architects, the Olmsted Bros., were hired to develop park plans for Seattle. Green Lake Park still reflects the design of the Olmsteds (as does Volunteer Pk. and the Arboretum). Construction of major facilities began in the 1920's: W. Green Lk. Bathhouse and the Recreation Center (see detail sheets of Green Lake & Park); in the 30's WPA built the Island and Wading Pool and bridge plus many smaller projects; in 1950 the Aqua Theater was built and in 1955 the Indoor Swimming pool was added to the Center and dedicated to the Evans brothers, Lou and Ben for their contributions to public recreation and long and faithful service with the Recreation Division: Lou 1912 to 1957 (1892-1966); Ben 1917 to 1960 (1895-

LOU EVANS joined the Dept. as a life guard + an instructor at Ross P.G., then coached football, basketball and baseball at high schools in Texas + Mass. Became director of Collins Center in 1919 and helped reorganize the beach program. Became assistant director of Recreation Division - 1921-'57. In 1961 won the "Pop Warner Award" for service to youth. In retirement he was an adviser + vice-pres. of Seattle's Little League, and dist. commissioner of Nat'l Softball Assoc. Was charter member of F. & A. M., branch pres. of AAU, chr. Water Safety Comm. of Am. Red Cross for 25 yrs.

10/9/56

EVANS POOL

~~Evans Pool operates from 2:00 to 10:00 p.m. daily except Sunday and Monday.~~

The operating crew consists of:

1 Manager  
1 Life Guard - full time  
2 Life Guards - half time  
1 Matron - full time  
1 Matron - half time  
1 Male Attendant - full time  
1 Female Attendant - full time  
1 Male Attendant - half time  
2 Pool operators

N/A

Cost of Pool: \$227,578.00  
Year Built: 1954 and 1955 (Started 6/8/54; Completed 2/10/55)

Maximum number of people pool will accommodate : 125

Size of Pool: Length 75 ft., width 42 ft. Depth: Deep end 12', shallow: 3'

Gallons of water needed to fill pool: 152,840 gals.

~~Annual cost of operating pool: Salaries - \$24,000;~~

~~other expenses - \$4,000~~

Type of filters: Elgin Refinite, Elgin, Ill.

Filters were unsatisfactory mostly due to the fact that when we clean the filter the sludge is pumped out of the filter instead of allowing the waste to go into a reservoir and then be pumped into the sewer.

This is the only Filter Company who specified they could do this. The other filter companies specified that the waste should either gravitate into the sewer or dump into a reservoir from where it could be pumped into the sewer. If your filter plant is about the sewer line, you will not encounter this trouble.

After the pool was completed, there was an additional cost of \$3,000.39 for Acoustical Tile. This only completed about one-half and when more funds are available we hope to finish it.



# Green Lake

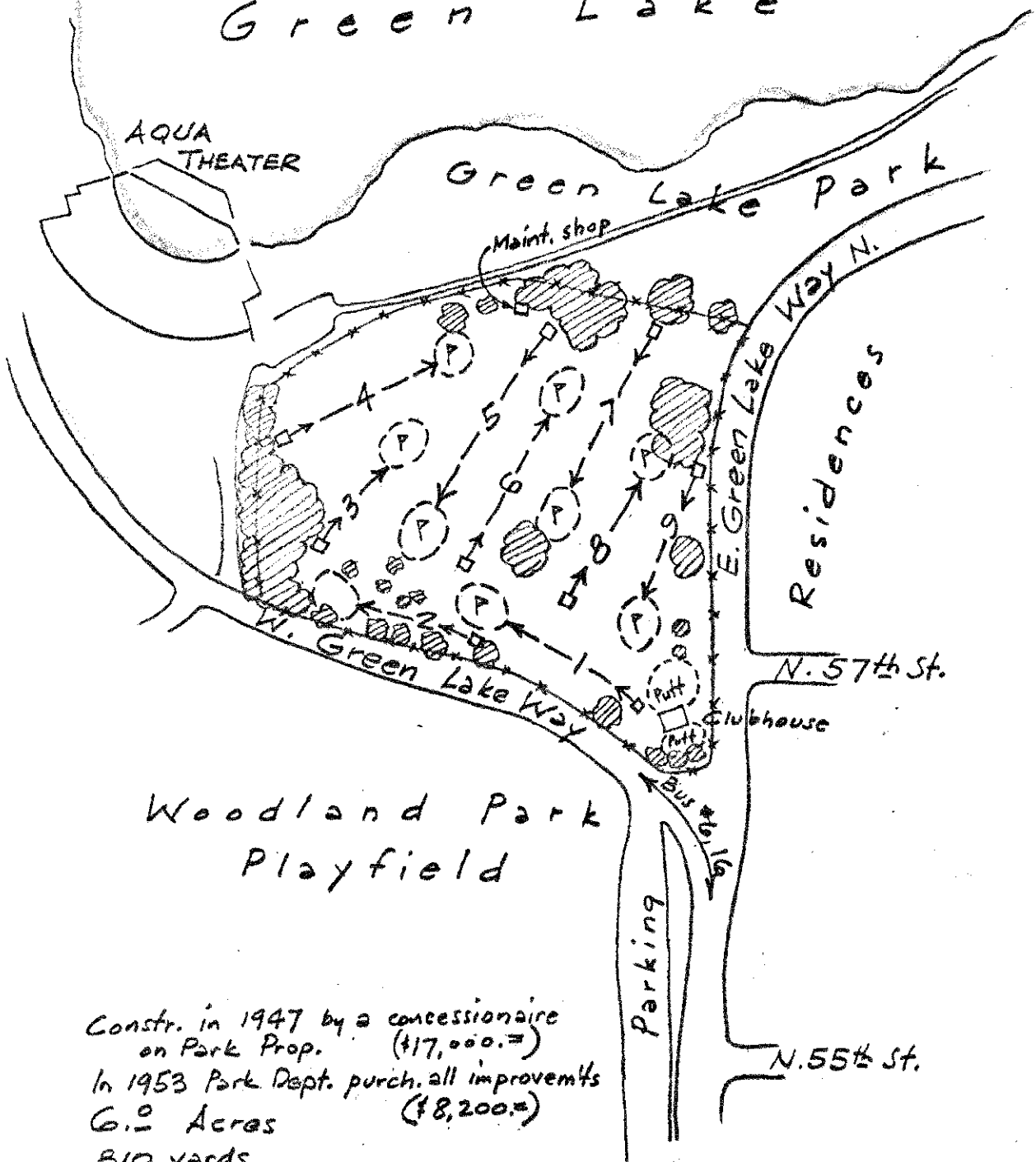

Constr. in 1947 by a concessionaire  
 on Park Prop. (\$17,000.00)  
 In 1953 Park Dept. purch. all improvements  
 6.0 Acres (\$8,200.00)  
 810 yards  
 Par 27  
 Concession operated

Course for beginners or for a short game.  
**PITCH & PUTT GOLF**

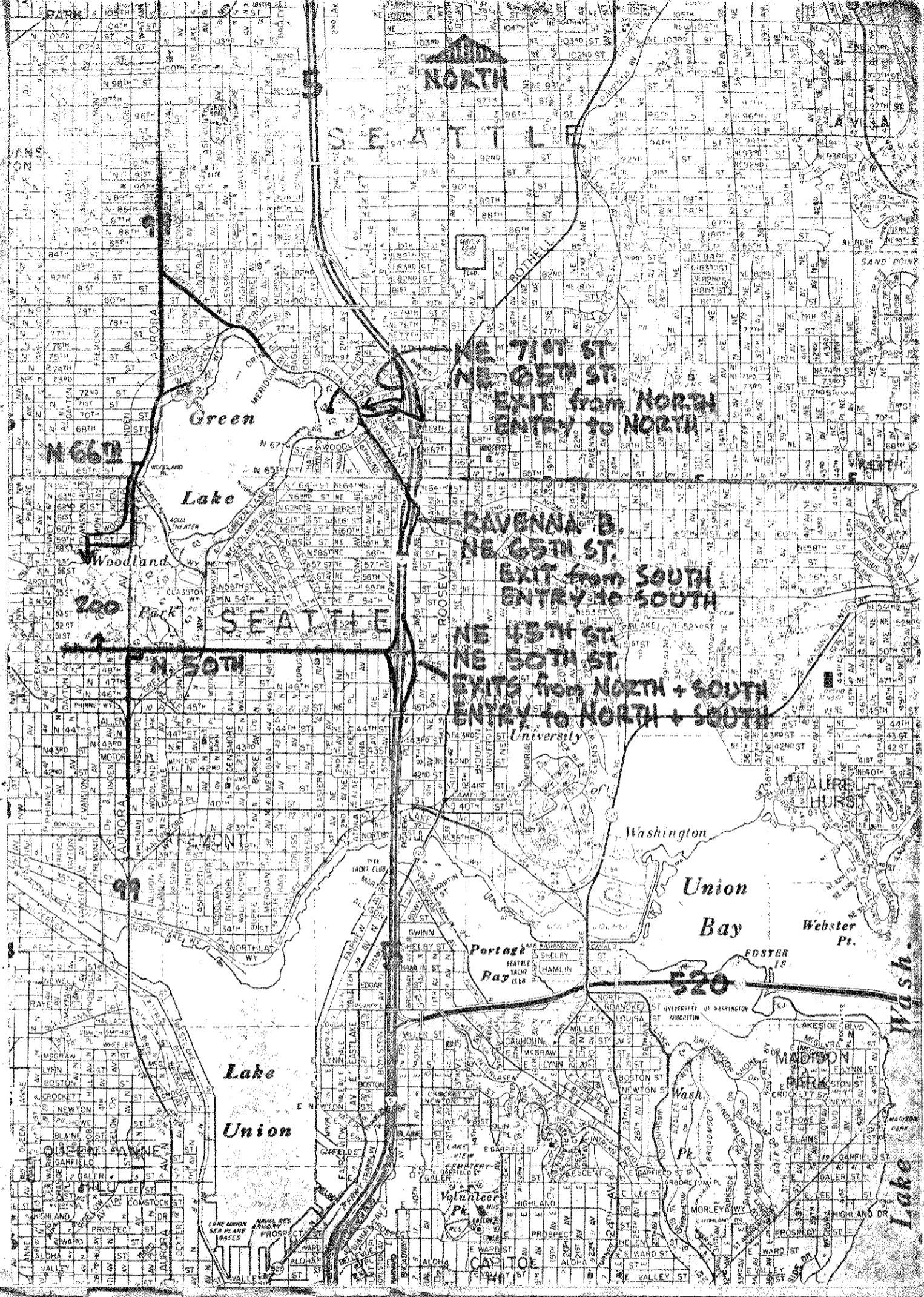

**NORTH**

**SEATTLE**

**Green Lake**

**Lake Union**

**SEATTLE**

**N 66th**

**Woodland Park**

**200 Park**

**N 50th**

**91**

**Lake Union**

**Union**

**NE 71st St  
NE 65th St  
EXIT from NORTH  
ENTRY to NORTH**

**RAVENNA B.  
NE 65th St.  
EXIT from SOUTH  
ENTRY to SOUTH**

**NE 145th St  
NE 130th St  
EXITS from NORTH + SOUTH  
ENTRY to NORTH + SOUTH**

**Portage Bay**

**520**

**Union Bay**

**Webster Pt.**

**Wash. Lake**

**MADISON PARK**

**CAPITOL**

COMMUNITY CENTER - "A": 7201 E. Green Lk. Wy N.

GYM 90' x 61' = 784 persons  
STAGE 27' x 61'

1929  
\$95,562

SHOWERS/LOCKERS  
2 SOCIAL ROOMS - ea. 42' x 23'

POOL 75' x 42' - 12' to 3' deep  
150 persons; 150,840 gal.; showers, lockers

Named in 1955 to honor Ben & Lou EVANS for long & faithful service:  
Lou = 1912 - 1957 (1892 - 1966)  
Ben = 1917 - 1960

Tennis Ctr. - 1945  
Asph. \$2,500.

"East Green Lake area filled + after lowering lake level in 1911, and Community Center built on piling; which accounts for ground settling around building (sanitary)"

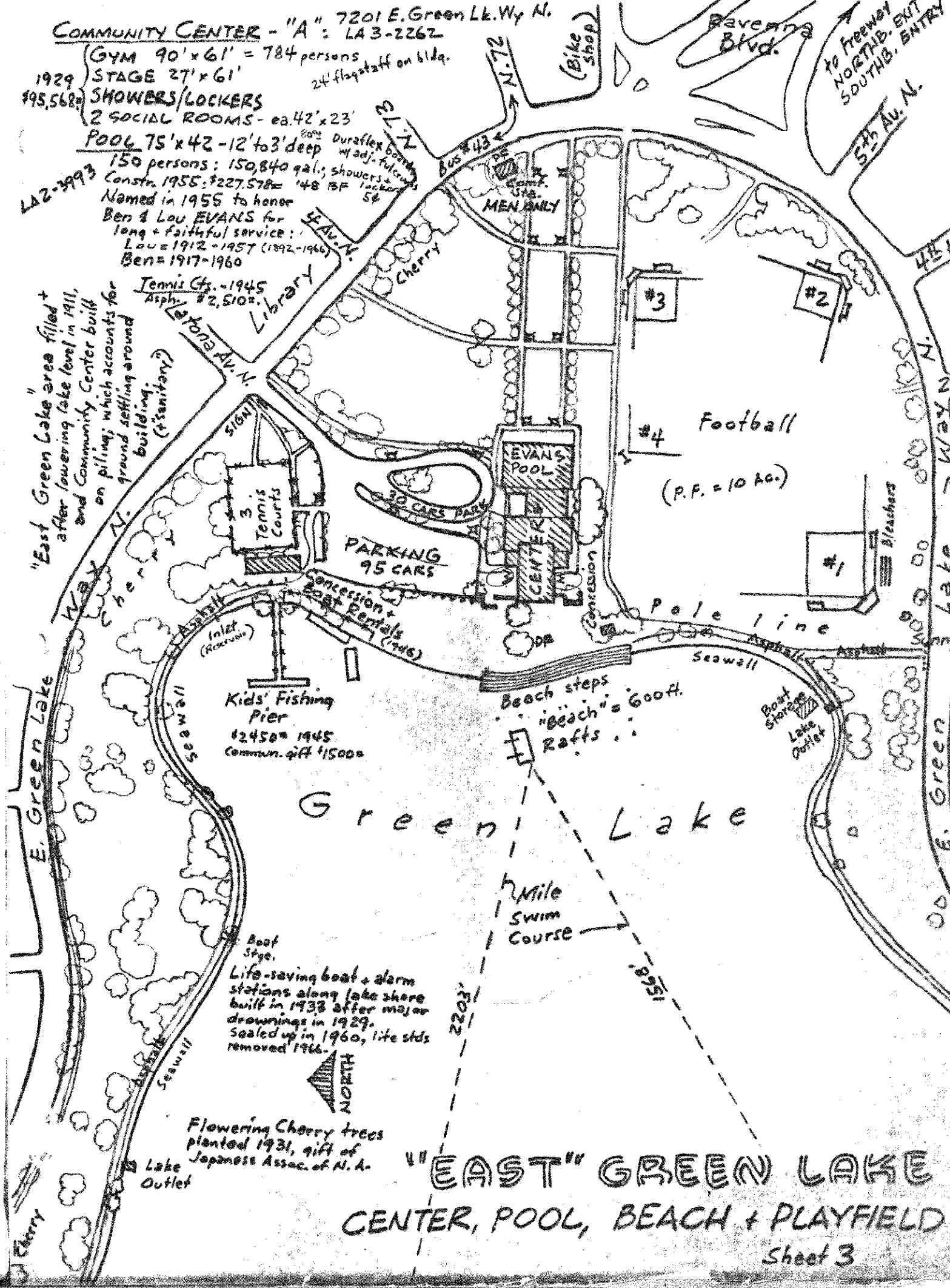

Green Lake

"EAST" GREEN LAKE CENTER, POOL, BEACH + PLAYFIELD  
Sheet 3

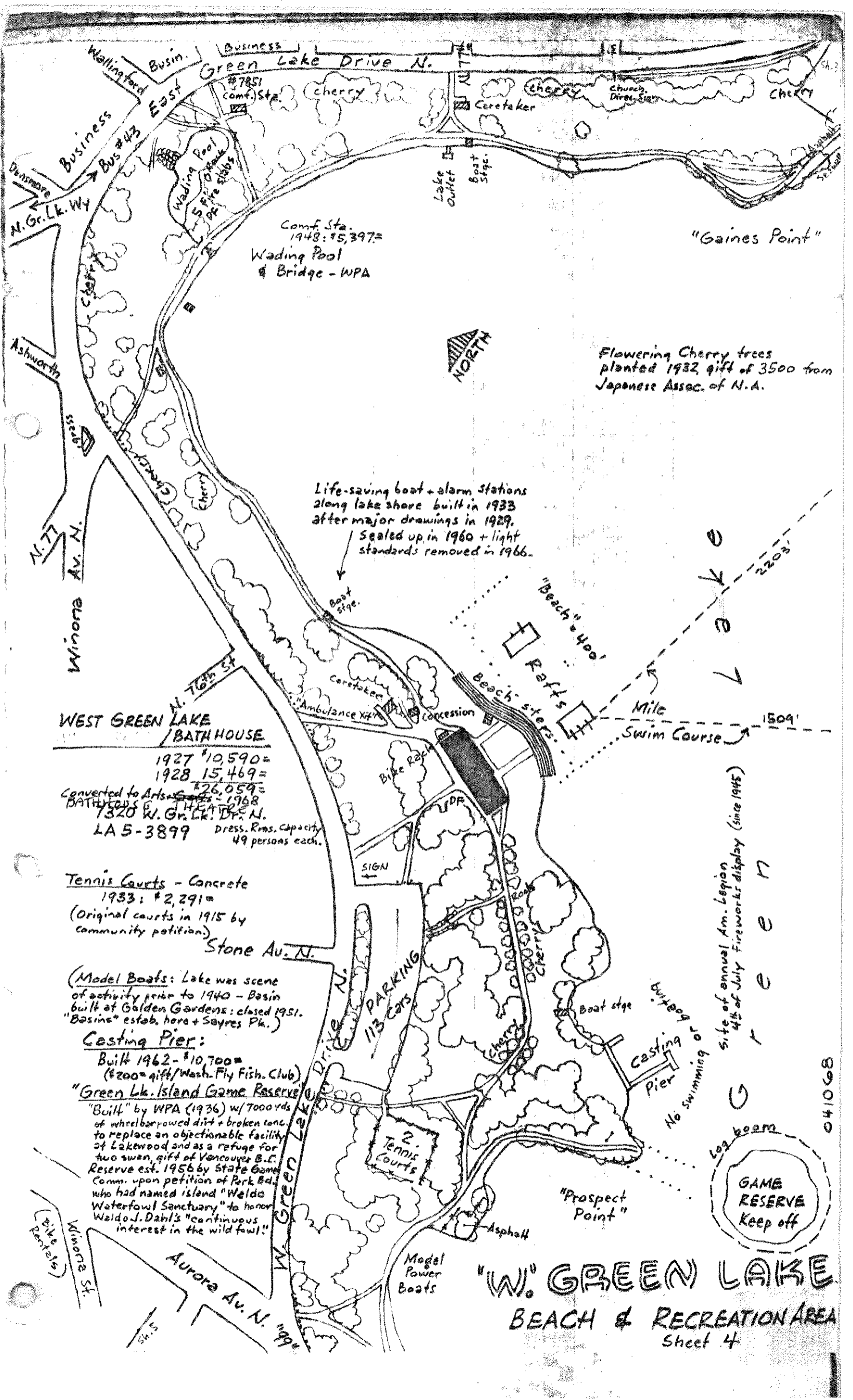

Comp. Sta.  
1948: 95,397=  
Wading Pool  
Bridge - WPA

"Gaines Point"

Flowering Cherry trees  
planted 1932, gift of 3500 from  
Japanese Assoc. of N.A.

Life-saving boat + alarm stations  
along lake shore built in 1933  
after major drawings in 1929.  
Sealed up in 1960 + light  
standards removed in 1966.

**WEST GREEN LAKE  
BATHHOUSE**

1927 \$10,590=  
1928 15,469=  
Converted to Arts & Crafts Bathhouse - 1968  
\$26,059=  
1320 W. Gr. Lk. Dr. N.  
LA 5-3899 Dress. Rms. Capacity  
49 persons each.

**Tennis Courts - Concrete**  
1933: \$2,291=  
(Original courts in 1915 by  
community petition.)

(Model Boats: Lake was scene  
of activity prior to 1940 - Basin  
built at Golden Gardens: closed 1951.  
"Basins" estab. here + Sayres Plk.)

**Casting Pier:**  
Built 1962 - \$10,700=  
(\$2000 gift/Wash. Fly Fish. Club)

**"Green Lk. Island Game Reserve"**  
"Built" by WPA (1936) w/7000 yds  
of wheelbarrowed dirt + broken conc.  
to replace an objectionable facility  
at Lakewood and as a refuge for  
two swan, gift of Vancouver B.C.  
Reserve est. 1956 by State Game  
Comm. upon petition of Park Bd.  
who had named island "Waldo  
Waterfowl Sanctuary" to honor  
Waldo J. Dahl's "continuous  
interest in the wild fowl."

Site of annual Am. Legion  
4th of July Fireworks display (since 1945)

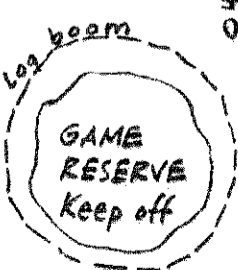

**"W." GREEN LAKE  
BEACH & RECREATION AREA  
Sheet 4**

041068



N. 73rd ST.

W. Green Lake Dr. N.

Parking

2 Tennis Courts

N. 72nd ST.

(Sheet 4)

N. 71st ST.

N. 70th ST.



Game Reserve

N. 68th ST.

Aurora Ave. N.

Green Lake

N. 67th ST.

Boat Stge. (barrel)

N. 66th ST.

Linden Av. N.

Gas Sta.

700 Sign

(Sheet 6)

to Zoo

# GREEN LAKE & PARK

Sheet 5

011068

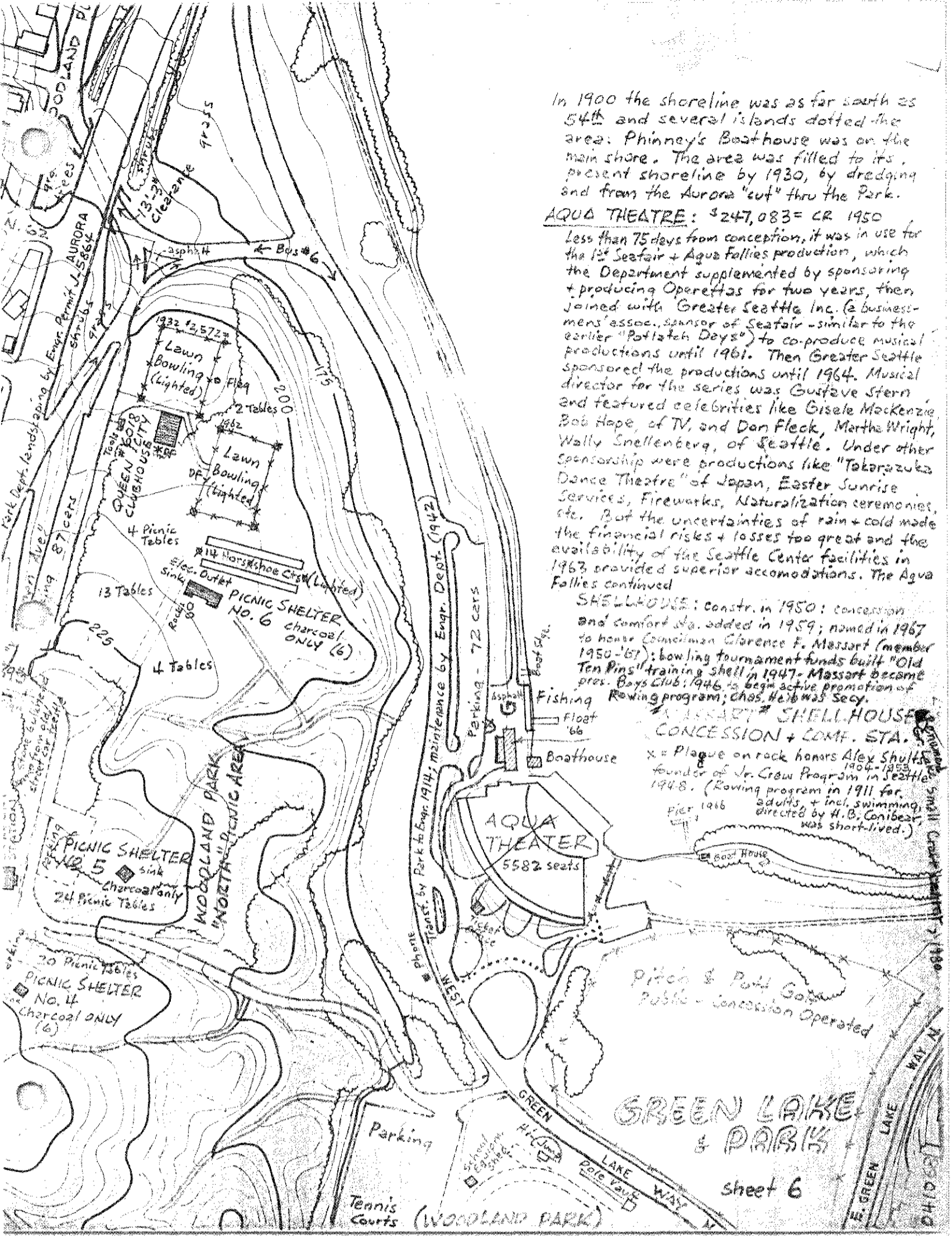

In 1900 the shoreline was as far south as 54th and several islands dotted the area. Phinney's Boat house was on the main shore. The area was filled to its present shoreline by 1930, by dredging sand from the Aurora "cut" thru the Park.

**AQUA THEATRE:** 3247,083 = CR 1950  
 Less than 75 days from conception, it was in use for the 1st Seafair + Aqua Follies production, which the Department supplemented by sponsoring + producing Operettas for two years, then joined with Greater Seattle Inc. (a businessmen's assoc., sponsor of Seafair - similar to the earlier "Potlatch Days") to co-produce musical productions until 1961. Then Greater Seattle sponsored the productions until 1964. Musical director for the series was Gustave Stern and featured celebrities like Gisele Mackenzie, Bob Hope, of TV, and Don Fleck, Marthe Wright, Wally Snellenberg, of Seattle. Under other sponsorship were productions like "Tokorozuka Dance Theatre" of Japan, Easter Sunrise Services, Fireworks, Naturalization ceremonies, etc. But the uncertainties of rain + cold made the financial risks + losses too great and the availability of the Seattle Center facilities in 1963 provided superior accommodations. The Aqua Follies continued

**SHELLHOUSE:** constr. in 1950; concession and comfort sta. added in 1959; named in 1967 to honor Councilman Clarence F. Massart (member 1950-'67); bowling tournament funds built "Old Ten Pins" training shell in 1947. Massart became pres. Boys Club; 1946, is begin active promotion of Rowing program; chas. Heib was Secy.

**MASSART SHELLHOUSE CONCESSION + COMF. STA.**  
 x = Plaque on rock honors Alex Shults 1904-1953 founder of Jr. Crew Program in Seattle 1948. (Rowing program in 1911 for adults + incl. swimming, directed by H.B. Conibear, was short-lived.)

Pitch & Paul Goss Public - Concession Operated

**GREEN LAKE & PARK**

sheet 6

Mile Swim Course  
buoy



Boat Stge.

N. 66th

Residential

Comfort Station  
#6415  
1965 \$11,294 = '60 BF

Residential N. 65th

N. 64th  
Church

Res.  
Meridian Av. N.

63rd St.

Green Lake

Boat Stge.

E. Green Lake Way N.  
Residential

Kirkwood Pl. N.

Residential

Kenwood Pl. N.

Ashworth

GREEN LAKE & PARK

Sheet 7

OHIO