

Upon community petition the Playfield was renamed "DeLridge" to match the new community and street name which had been renamed by the Planning Commission in 1940. The original name for the area had been "Youngstown", so known for the townsite that originated at the cove at the mouth of Longfellow Creek, adjacent to Pigeon Point and the Duwamish River where first white settlers landed (1851), after their canoe voyage following the '49 Gold Rush in California: Jacob and Samuel Maple (father + son), Henry Van Asselt and Samuel Collins, all mid-west farmers. They planted potatoes on the Duwamish delta land and met the Denny Party at Alki beach; their land claims were the first filed in King County. The Young family (?): Wm. Young, a sawmill engineer at Alki; L.B. Youngs was Supt. of Water Dept. 1875-1923 - see Volunteer Park, water tower; and M.H. Young developed the Beacon Hill Traction Co. The town was settled prior to 1894: after the virgin timber had been logged, a steel mill from Lake City was moved onto the shore in 1905: Youngstown grew rapidly. Filling of the Cove and Duwamish tidelands began & Harbor Island was created. The north end of the playfield was filled with dirt from the school excavation (1915), plus fill from Golf Course regrading (WWI workers; in 1952 the housing units were removed and the Community Building remained as a Recreation Center. In 1960 the City Engineering Dept. constructed the pedestrian overpass. The 1923 Shelter house was replaced by Forward Thrust in 1970.

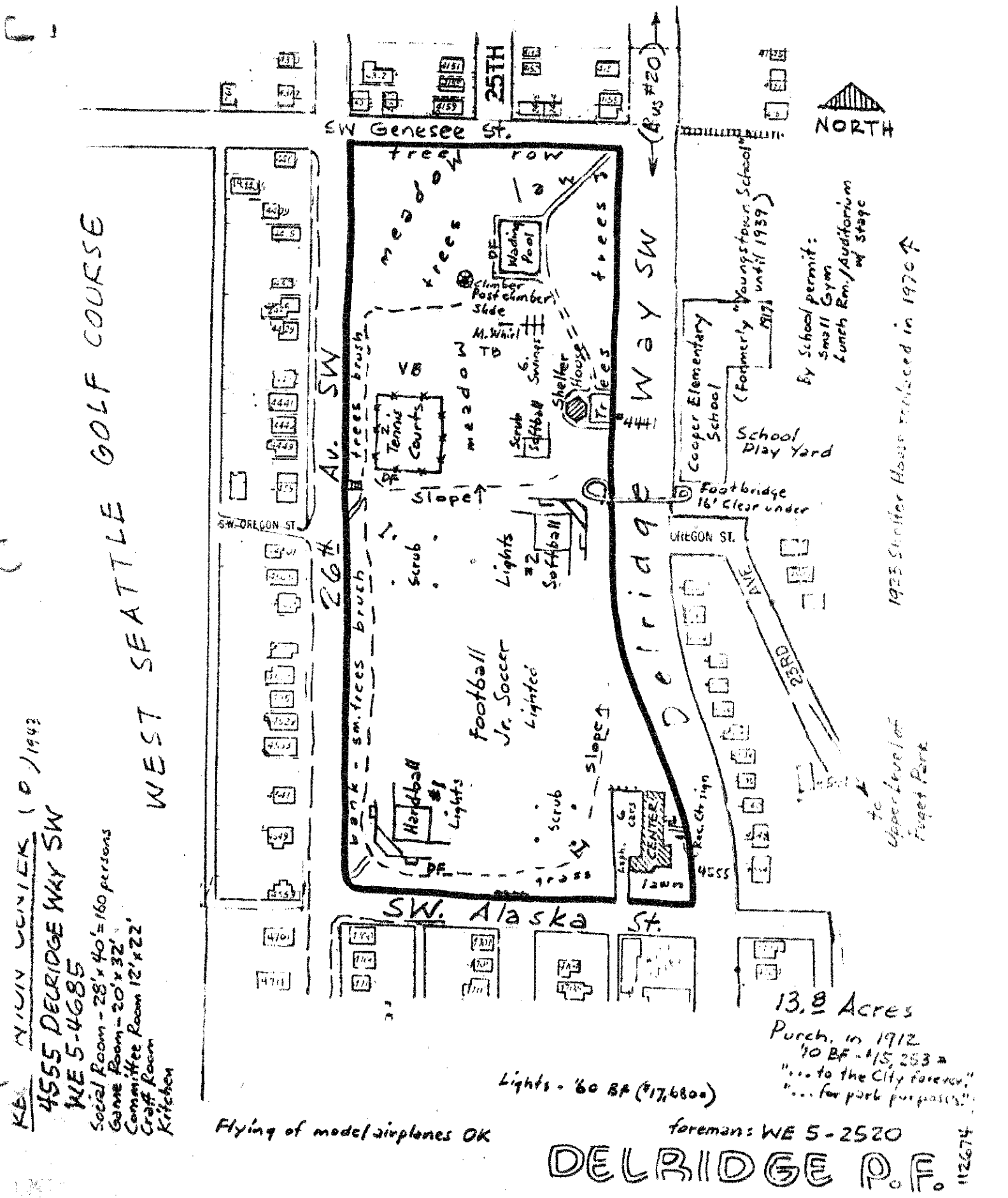

RE MINUV UNIVER (P) 1943
 4555 DELRIDGE WY SW
 WE 5-4685
 Social Room - 28' x 40' = 160 persons
 Game Room - 20' x 32'
 Committee Room 12' x 22'
 Craft Room
 Kitchen

Flying of model airplanes OK

Lights - 60 BF (\$17,680)

foreman: WE 5-2520

DELRIDGE P.F.

13.8 Acres
 Purch. in 1912
 10 BF - 415,253
 "...to the City forever!"
 "...for park purposes."

1923 Shelter House replaced in 1970

112674

Upon community petition the Playfield was renamed "Del'nye" to match the new community and street name which had been renamed by the Planning Commission in 1940. The original name for the area had been "Youngstown", so known for the townsite that originated at the cove at the mouth of Longfellow Creek, adjacent to Pigeon Point and the Duwamish River, where first white settlers landed (1851), after their canoe voyage following the '49 Gold Rush in California: Jacob and Samuel Maple (father + son), Henry Van Asselt and Samuel Collins, all mid-west farmers. They planted potatoes on the Duwamish delta land and met the Denny Party at Alki beach; their land claims were the first filed in King County. The Young family (?): Wm. Young, a sawmill engineer at Alki; L. B. Youngs was Supt. of Water Dept. 1845-1923 - see Volunteer Park, water tower; and M. H. Young developed the Beacon Hill Traction Co. The town was settled prior to 1894: after the virgin timber had been logged, a steel mill from Lake City was moved onto the shore in 1905: Youngstown grew rapidly. Filling of the Cove and Duwamish tidelands began + Harbor Island was created. The north end of the playfield was filled with dirt from the school excavation (1915), plus fill from Golf Course regrading (WWI 1935). During WWII the playfield was taken over as war-time housing project for Steel mill workers; in 1952 the housing units were removed and the Community Building remained as a Recreation Center. In 1960 the City Engineering Dept. constructed the pedestrian overpass. The 1923 Shelter house was replaced by Forward Thrust in 1970.

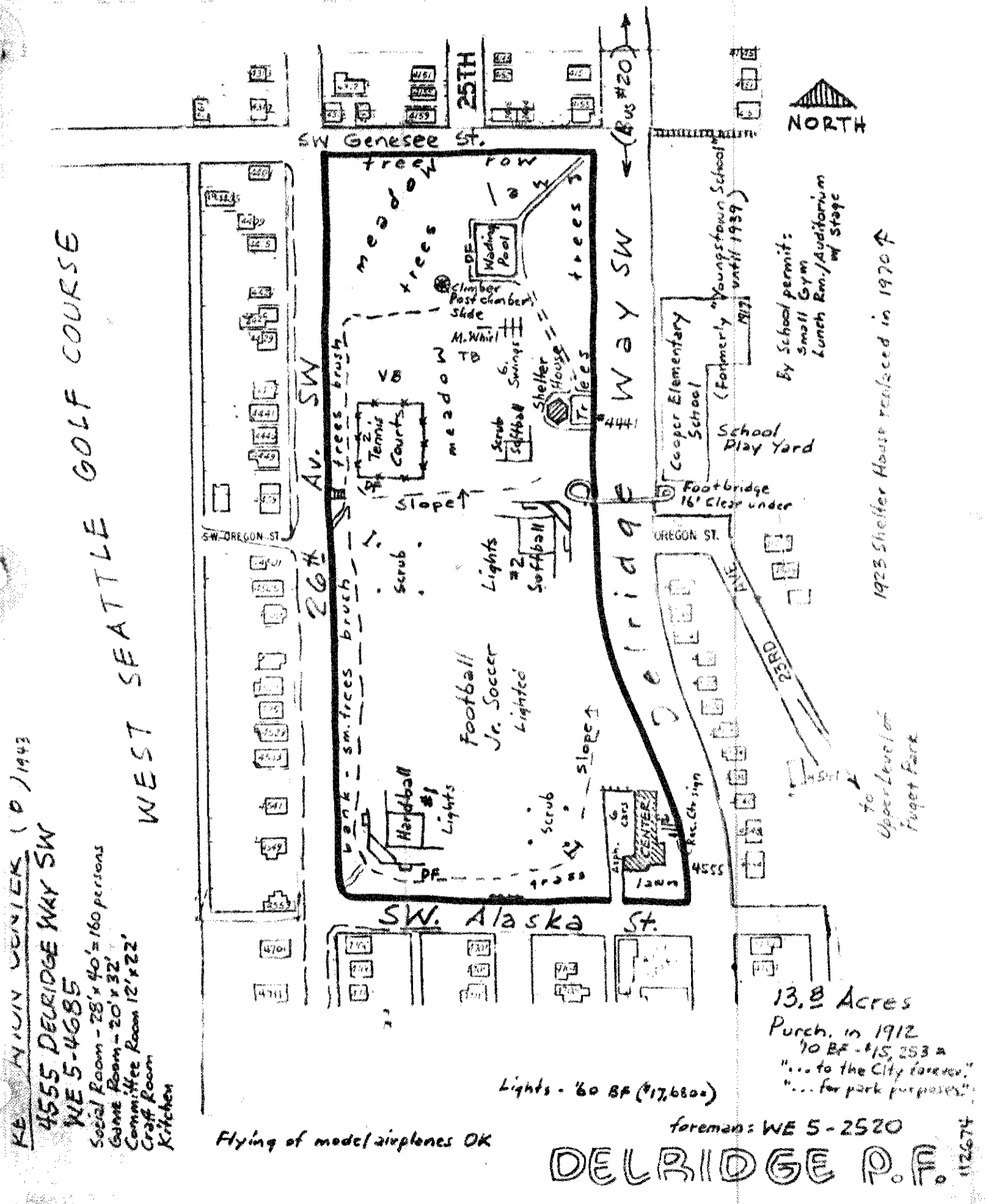

RE MAIN CENTER (0/1943)
 4555 DELBRIDGE WAY SW
 WE 5-4685
 Social Room - 28' x 40' = 160 persons
 Game Room - 20' x 32'
 Committee Room 12' x 22'
 Craft Room
 Kitchen

Flying of model airplanes OK

foreman: WE 5-2520
DELBRIDGE P.F.

112674

Upon community petition the Playfield was renamed "Delridge" to match the new community and street name which had been renamed by the Planning Commission in 1940. The original name for the area had been "Youngs Town", name of the pioneer townsite at the mouth of Longfellow Creek (Lift. Longfellow Logging Co. land) adjacent to Pigeon Point and the Duwamish River, where first white settlers landed (1851), after their canoe voyage following the '49 Gold Rush in California: Jacob and Samuel Maple (father + son), Henry Van Asselt and Samuel Collins, all mid-west farmers. They planted potatoes on the Duwamish delta land and met the Denny Party at Alki beach; their land claims were the first filed in King County. The Young family (?): Wm. Young, a sawmill engineer at Alki; L.B. Youngs was Supt. of Water Dept. 1815-1923 - see Volunteer Park, water tower; and M.H. Young developed the Beacon Hill Traction Co. The town was settled prior to 1894; after Longfellow had logged this area, a steel mill from Lake City was moved onto the shore in 1905; Youngstown grew rapidly. Filling of the Cove and Duwamish tidelands began + Harbor Island was created. The north end of the playfield was filled with dirt from the school excavation (1915), plus fill from Golf Course regrading (1935). During WWII the playfield was taken over as war-time housing project for steel mill workers; in 1952 the housing units were removed and the Community Building constructed as a Recreation Center. In 1950 the City Engineering Dept. constructed the present-day overpass. The 1923 Shelter House was replaced by Forward Thrust in 1970.

102576

RECREATION CENTER (c) 1945 (relocated in SW)
 4555 DELBRIDGE WAY SW
 WE 5-4635
 Social Room - 28' x 40' = 160 persons
 Game Room - 20' x 32'
 Committee Room 12' x 22'
 Craft Room
 Kitchen

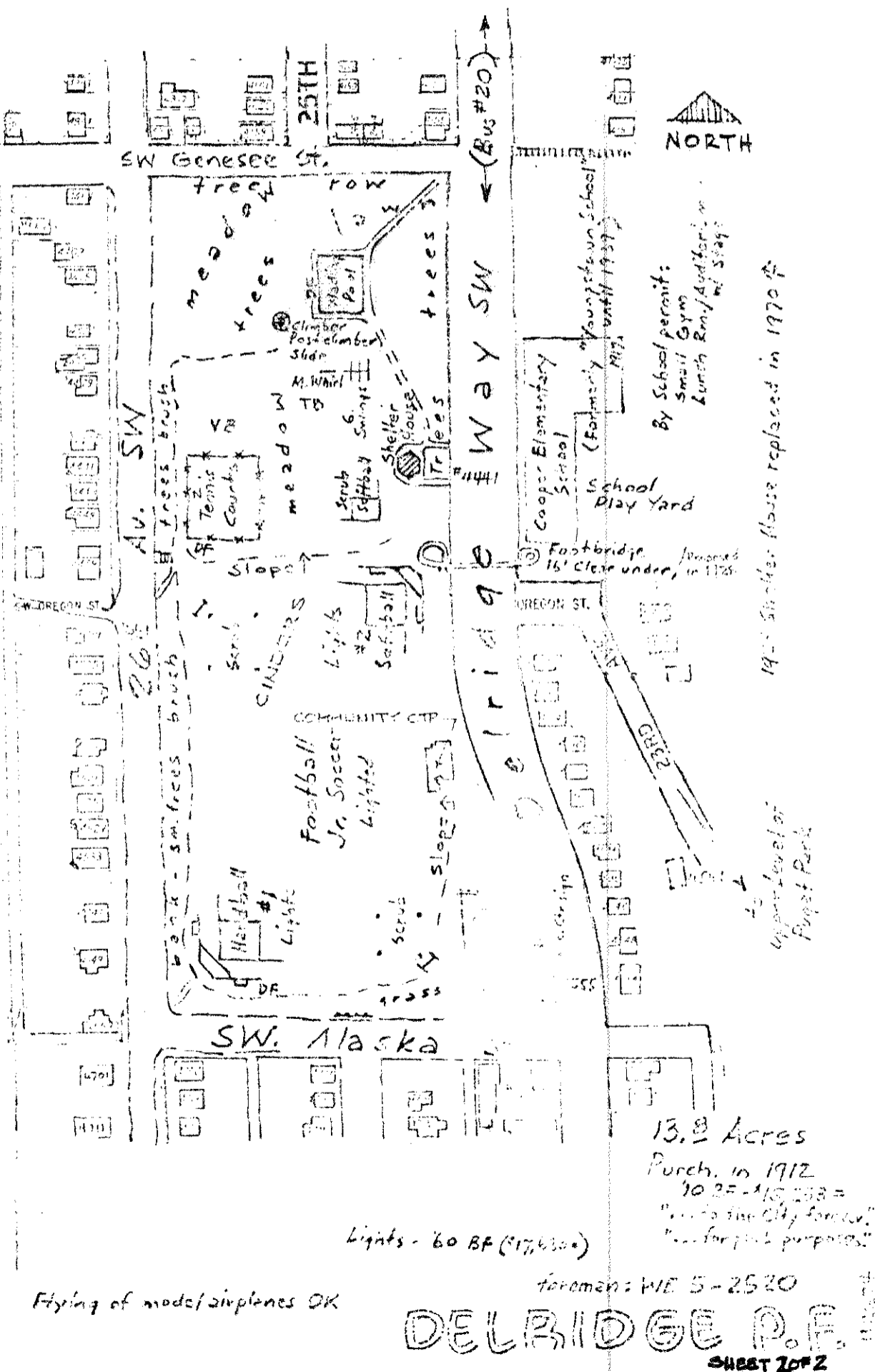

Flying of model airplanes OK

foreman: WE 5-2520
DELBRIDGE P.F.
 SUBST 20F2