

Fremont Ave. reflects name of pioneer townsite just south of here, settled by homesteaders (1885±) from Fremont, Nebraska, led by Edward Blewett; platted & developed by L.H. Griffith. (Capt. John Chas. Fremont came across wagon trail to arrive in 1884.) Early community depended upon agriculture, fishing & logging (esp. Isaac Burlingame's lumber mill brought from Tomwater in 1888). Railroad service began in 1887, helley car to Seattle in 1900, Ship Canal in 1917; brought prosperity. Natural resources began to decline at the 1932 Aurora bridge dumped potential business over + away from Community.

N. Bowdoin Pl.

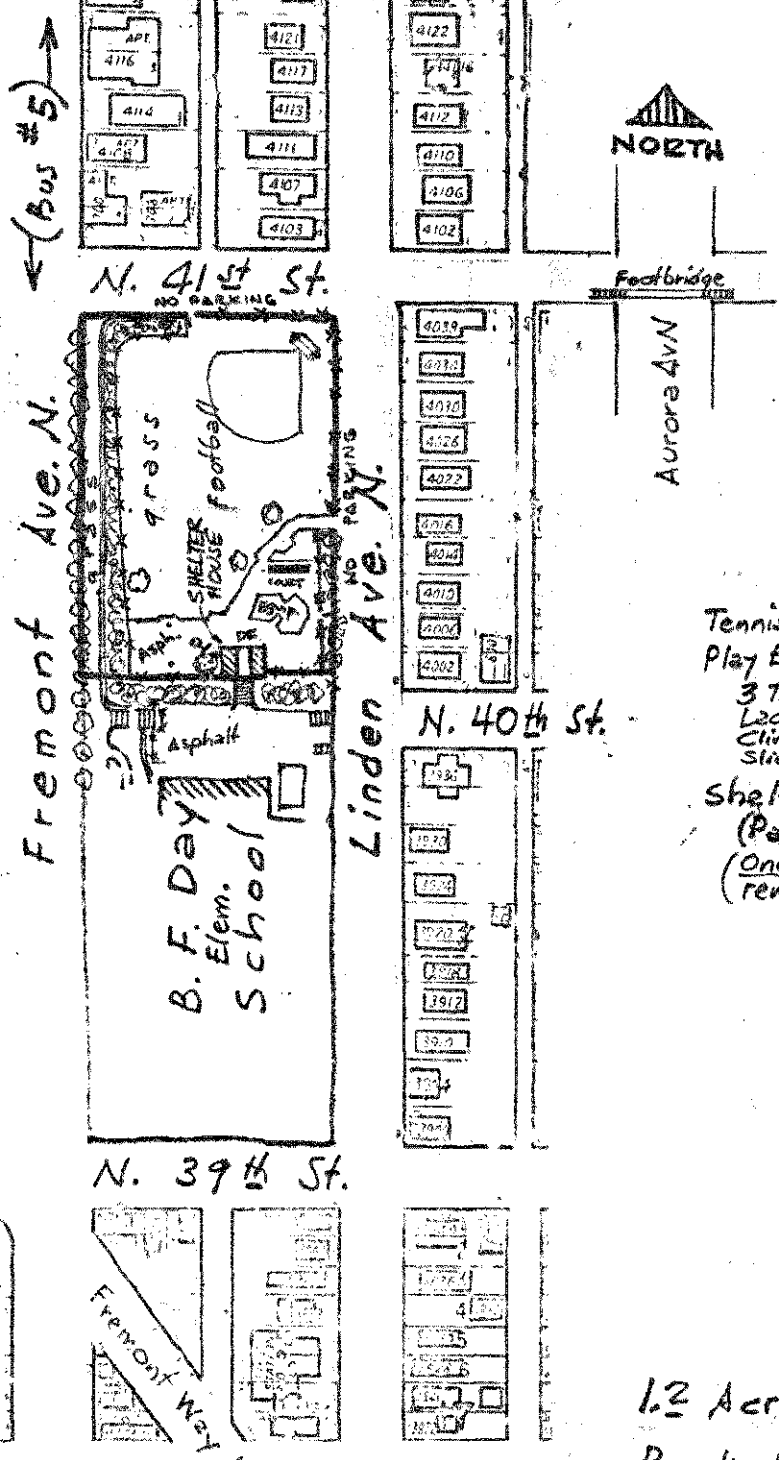

- Tennis Wall (1910?)
- Play Equipment:
  - 3 Tire Swings
  - Ladder
  - Climber
  - Slide
- Shelter House 1909 (Park Contract) (One of oldest buildings) remaining in system.

Name derived from adjacent school.  
 School named for Mr. & Mrs. Benj. F. Day (Fremont realtor) who donated part of their 160 acre farm as a permanent home for the vegabond district school; orig. portion of school built 1892.  
 The school was "across the street" until 1907, when 40th Street was vacated and Shelter House and play equipment built, with supervision furnished by 1911.

[B.F. Days gave a 5-acre tract to Seattle in 1883: David Rodgers Park.]

1.2 Acres (200' So. of N. 41st St.)  
 Purch. 1907 (\$5,158 = '06 B.F.) from C.E. Remsburg, pres. of Remsburg & Dixon Bank, Inc.) Deeded for park + P.G. purposes  
 + Maintenance of entire playground appears to have followed the improvements by Park Board (Contr. + Annual Reports: 1910-11) Authority by (playgr. purp.)? (1.2 Ac.)

209  
 DAY P.G.

090376