

2019 SAFETY & BUS IMPROVEMENTS

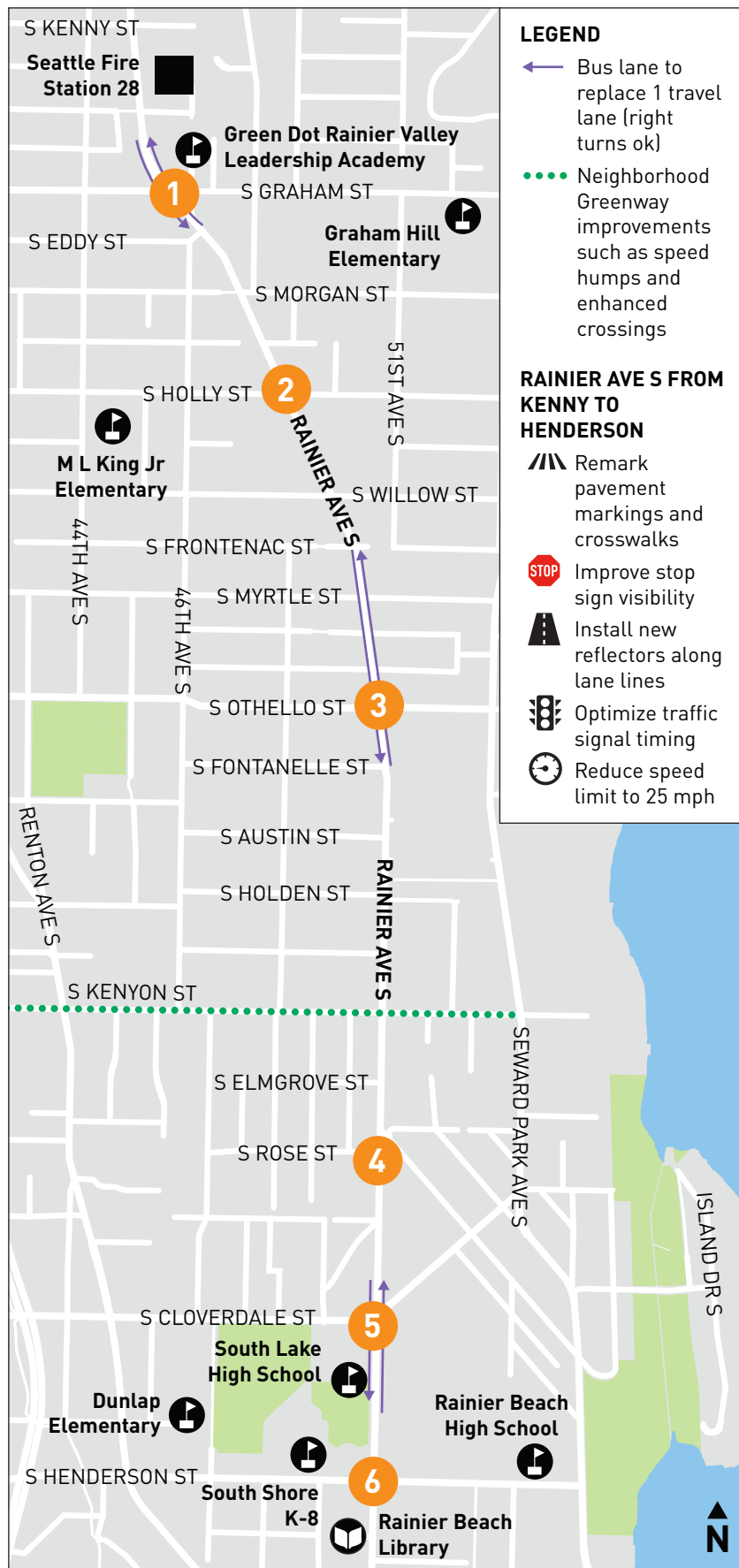

What are these changes for?

We studied the crash patterns at all major intersections. These improvements are designed to slow down drivers, keep buses moving, and make it easier to walk across Rainier.

How do I read the map?

The orange numbers on the project map correspond with the zoomed-in intersection maps. The purple arrows show where we're changing the street layout this year. We'll complete the new street layout within the whole project area next year.

1 Rainier & Graham Safe Routes to School

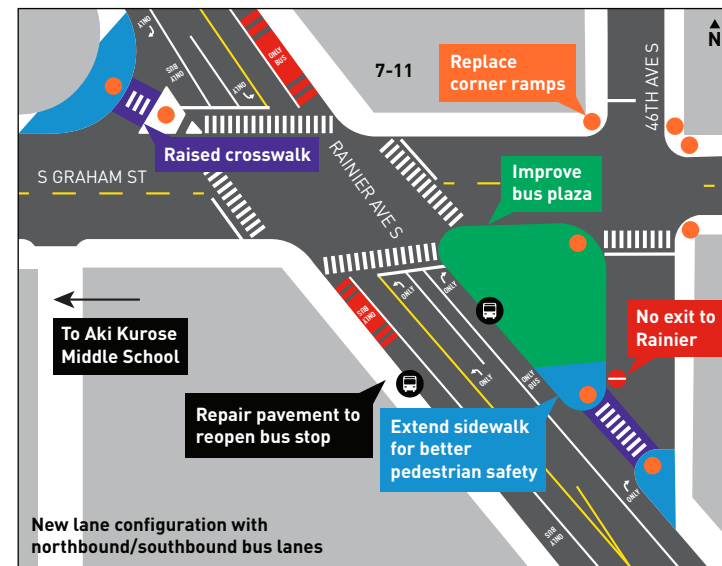

2 Rainier & Holly

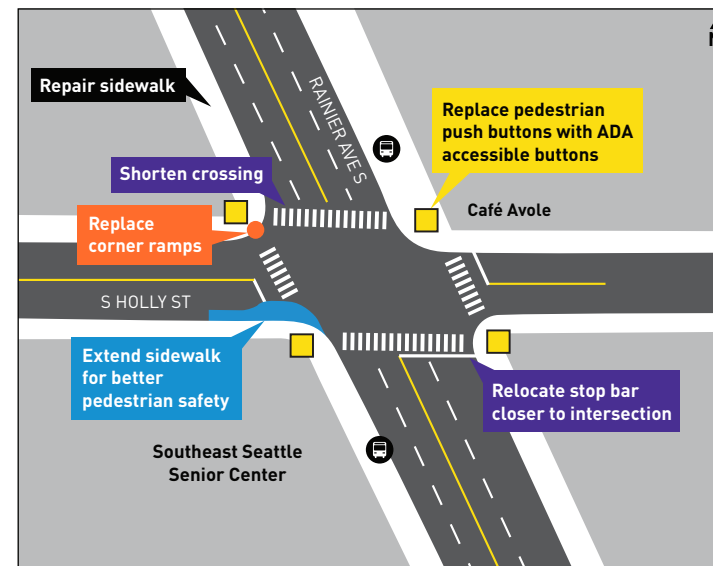

3 Rainier & Othello

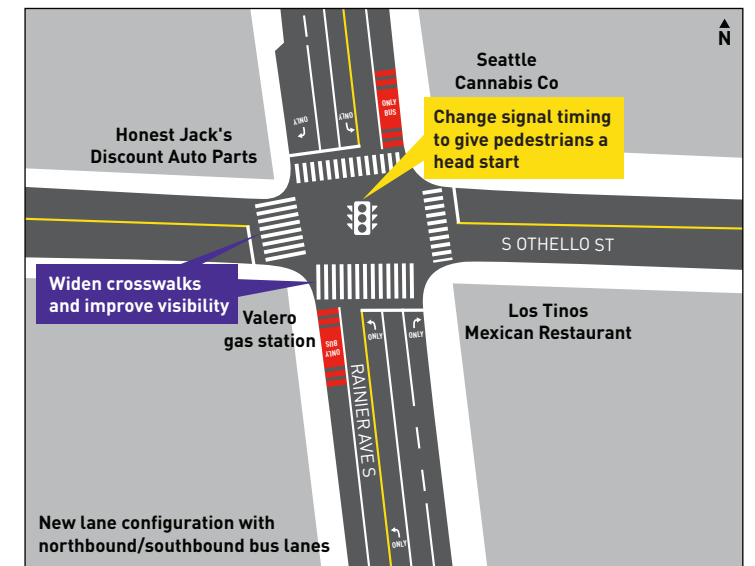

4 Rainier & Rose



5 Rainier & Cloverdale

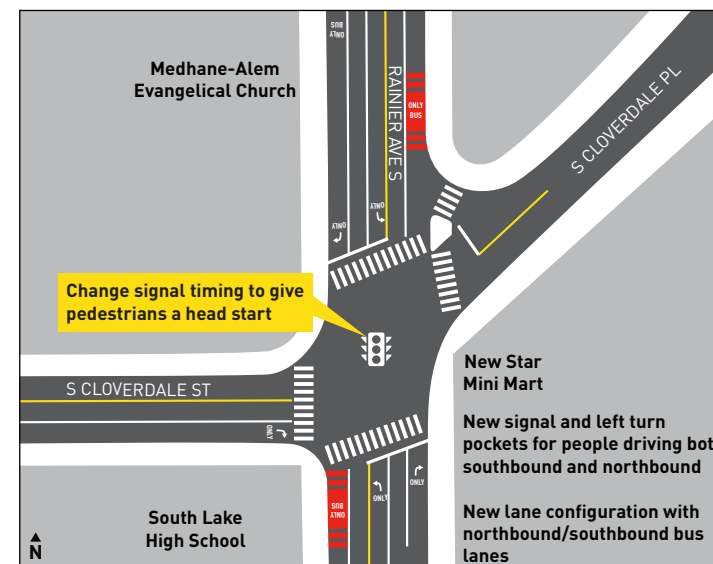

6 Rainier & Henderson

