

# FAIRMOUNT PARK

OPTION 1







# FAIRMOUNT PARK

## SEATTLE, WA

### OPTION 1

To verify product certification, visit [www.ipema.org](http://www.ipema.org).  
The space requirements shown in this publication are shown to ASTM standards. Requirements for other standards may be different.

Presented by:

4818 Evergreen Way, Suite 200 • Everett, WA 98203  
Phone: 1-800-541-0869 • [www.sitelines.com](http://www.sitelines.com)

**PowerScope**  
**GTIMPAX**  
Impact Absorbent Accessible Surfacing

AREA = 3787 SF  
PERIMETER = 245 LF  
EWF REQUIRED FOR 12"  
COMPACTED DEPTH = 125 CY  
(8" TOP-OFF TO EXISTING)

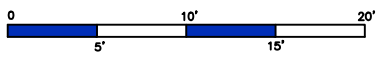
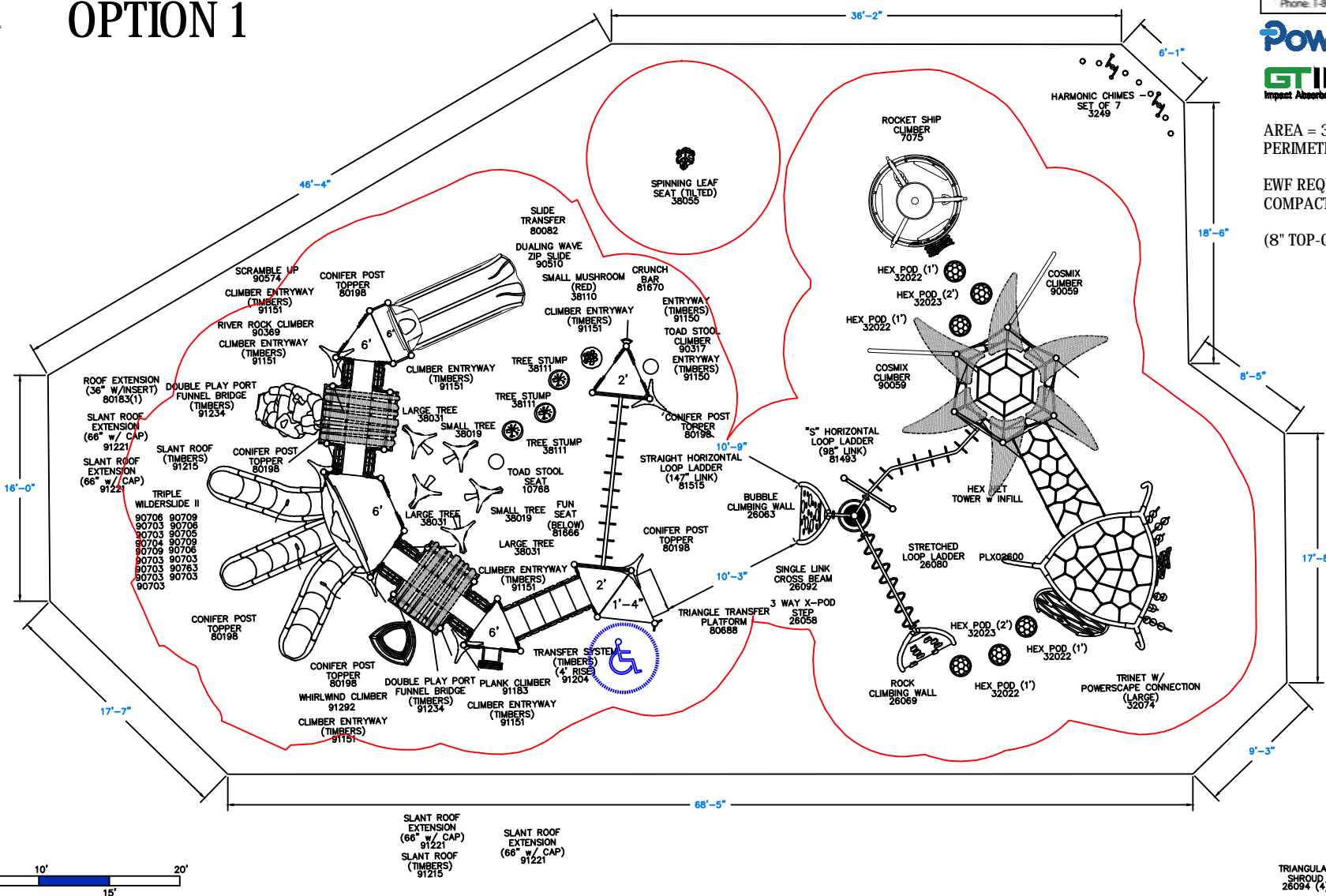

**GameTime**  
150 PlayCore Drive SE  
Fort Payne, AL 35967  
[www.gametime.com](http://www.gametime.com)

**ISO 9001 CERTIFIED**  
**ASTM F1487**

**FAIRMOUNT PARK OPTION 1**  
**SEATTLE, WA**  
**PRESENTED BY SITELINE**  
Representative  
**GARY MAX 1-800-541-0869**

This Unit includes play events and routes or travel specifically designed for special needs users. It is the opinion of the manufacturer that these play events and routes of travel conform to the accessibility requirements of the ADA (Americans with Disabilities Act)

Total Elevated Play Components	12	0	0
Total Elevated Play Components Accessible By Ramp	0	Required	0
Total Elevated Components Accessible By Transfer	10	Required	6
Total Accessible Ground Level Components Shown	25	Required	5
Total Different Types Of Ground Level Components	6	Required	3

This play equipment is recommended for children ages  
5 - 12

Minimum Area Required:  
Scale: 1" = 5'-0"  
This drawing can be scaled only when in an 18" x 24" format

**IMPORTANT:** Soft resilient surfacing should be placed in the use zones of all equipment, and at depths to meet the critical fall heights as specified by the U.S. consumer Product Safety Commission, ASTM standard F 1487 and Canadian Standard CAN/CSA-Z-614

Drawn By:  
**ADAM BASICH**  
Date:  
**MAY 22ND 2019**  
Drawing Name:  
**A052219GMO1**

TRIANGULAR SHROUD 26094 (4)



# FAIRMOUNT PARK

## OPTION 2







# FAIRMOUNT PARK

## SEATTLE, WA

### OPTION 2

To verify product certification, visit [www.ipema.org](http://www.ipema.org).  
The space requirements shown in this publication are shown to ASTM standards. Requirements for other standards may be different.



AREA = 3787 SF  
PERIMETER = 244 LF  
EWF REQUIRED FOR 12"  
COMPACTED DEPTH = 125 CY  
(8" TOP-OFF TO EXISTING)

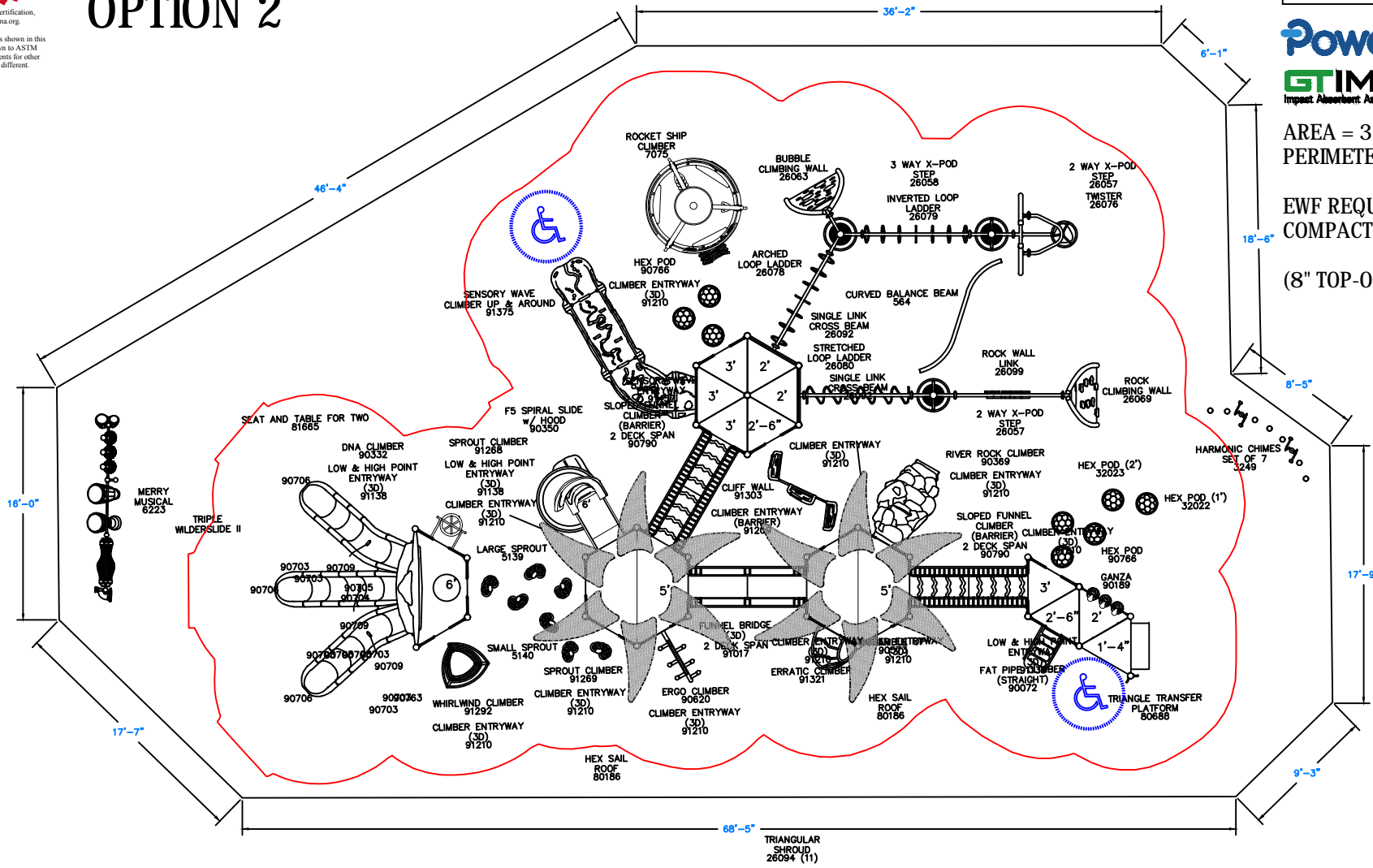

FAIRMOUNT PARK OPTION 2  
SEATTLE, WA  
PRESENTED BY SITELINES  
Representative  
GARY MAX 1-800-541-0869

This Unit includes play events and routes or travel specifically designed for special needs users. It is the opinion of the manufacturer that these play events and routes of travel conform to the accessibility requirements of the ADA (Americans with Disabilities Act)

Total Elevated Play Components	19	0
Total Elevated Play Components Accessible By Ramp	0	Required
Total Elevated Components Accessible By Transfer	15	Required
Total Accessible Ground Level Components Shown	20	Required
Total Different Types Of Ground Level Components	6	Required

This play equipment is recommended for children ages 5 - 12

Minimum Area Required:  
Scale: 1" = 5'-0"  
This drawing can be scaled only when in an 18" x 24" format

**IMPORTANT:** Soft resilient surfacing should be placed in the use zones of all equipment, as specified for each type of equipment, and at depths to meet the critical fall heights as specified by the U.S. consumer Product Safety Commission, ASTM standard F 1487 and Canadian Standard CAN/CSA-Z-614

Drawn By:  
ADAM BASICH  
Date:  
MAY 22ND 2019  
Drawing Name:  
A052219GMO2