



In Harmony
sustainable landscapes

The background of the slide features a light, textured surface, possibly aged paper or parchment, with faint, natural patterns. On the left side, a dark, thin stem extends vertically, with a single, elongated, dried leaf attached near the top. On the right side, another similar stem extends horizontally, with a single, elongated, dried leaf attached near the end. The overall aesthetic is natural and organic.

Sustainable Landscaping Cookbook

Resources, Tools and Opportunities
In the Landscape Profession

Doctors Do It



Lawyers Do It



Carpenters Do It



Almost All Professions Do It



But The Landscape Profession Does NOT.....





A Professional License and Having Oversite of our Operations

Lawyers, Doctors, Plumbers,
Carpenters, Teachers.....

We are the only 'professionals' that do not





All other professions must show
competency before they can do business

But not landscapers.....

Anyone can start a landscape business
(all you need is a truck, mower, and a card)



Gary the Gardner
Lawn Mowing Business

Cell Phone #



Conquering Nature One Lawn at a Time!

But would go to a doctor if you did not know if he/she was licensed?





\$

EVEN IF IT WAS CHEAPER!!!



How about a level playing field?

- How many companies have a business license?
 - How many are properly bonded?
- How many are properly insured? (1 million min.)
 - How many pay fair wages?
- How many pay living wages & health benefits?
 - How many are getting paid under the table?
 - Not paying any taxes at all??



But are we in a race to the bottom?

Business Name

Slogan

Services Provided:

Mowing

Bagging

Reel Mowing

Weed Eating/Trimming

Edging (with a weed eater)

Etc., add or take out services

as you have the ability

Contact Us!

Phone number

Email

We offer free estimates!



We want to be called landscape
professionals

But with so many landscape amateurs,
how can we differentiate ourselves
from all the others???

The Path To Glory





Why a Path to Glory?

To find the path to the two things that
our field needs and wants:

**BETTER WAGES &
MORE RESPECT**

Landscapers take pride in what we do, not what we know



WHY, WHY, WHY??

To get better customers who are interested in quality work not just cost

To get paid more for what we know, not just what we do as routine

To be seen as professionals and not just businesses

We need to show that we ARE professionals, want to be PAID like professionals and that hiring the best professional service will pay long term dividends for customers and the environment





SO.....

What is available for the practitioner or company as
Recognition and Incentives

And what **Resources** are available for
the company or individual to grow
their knowledge?

80% of residents surveyed across 5 Puget Sound counties said they preferred to support environmentally minded businesses

www.envirostars.com



A program that helps small businesses get better and get recognized for their continued efforts

The more proactive your efforts to reduce hazardous materials and waste and to incorporate green business best practices, the more benefits you can receive:

- **Website listings and links**
- **Highlights in radio advertisements**
- **Profiles in local newspapers**
- **Achievement award nominations**
- **Promotion at community and trade events**

There are more than **700 EnviroStars** businesses – From Seattle to Spokane



Certification Process

Step 1: Eligibility

Step 2: Apply

Step 3: Consultation

Step 4: Finalize
Process

Ratings System:

2 Star EnviroStar

3 Star EnviroStar

4 Star EnviroStar

5 Star

EnviroStar



Washington State Sustainable Landscape Professional Certification

EPA-Sustainability is based on a simple principle: Everything that we need for our survival and well-being depends, either directly or indirectly on our natural environment.

Sustainability creates and maintains the conditions under which humans and nature can exist **in** productive **harmony**, that permit fulfilling the social, economic and other requirements of present and future generations



Washington State Sustainable Landscape Professional Certification

Offered by **WSNLA** and **WALP** to certify landscape professionals who work within Washington State, prove knowledge of and practice voluntary sustainable best landscape practices



The program promotes the certified sustainable landscape professional with a recognized credential that enhances employment as a landscape designer, landscape contractor, and landscape maintenance professional

WALP

Washington Association
of Landscape
Professionals



Washington State Sustainable Landscape Professional Certification

Methods

- Publish best practices for sustainable landscape
- Administer a training program that prepares professionals for certification
- Offer professional accreditation recognized throughout Washington State
- Certify individuals who demonstrate knowledge of best landscape practices
- Renew certified individuals

BEST PRACTICE STANDARDS

- Soils Best Practice Standards
- Irrigation & Stormwater Best Practice standards
- Air Quality and Prevention of Noise Pollution Best Practice Standards
- Practice Standards for Habitat Protection, Creation, & Management
- Energy Management Best Practice Standards
- Sustainable Practice Standards for Plants
- Suggested Materials for Sustainable Landscaping
- Practices to Avoid in Sustainable Landscaping

Other Programs Available

Oregon Tilth
Accreditation



Society for Organic Urban
Land Care (SOUL)

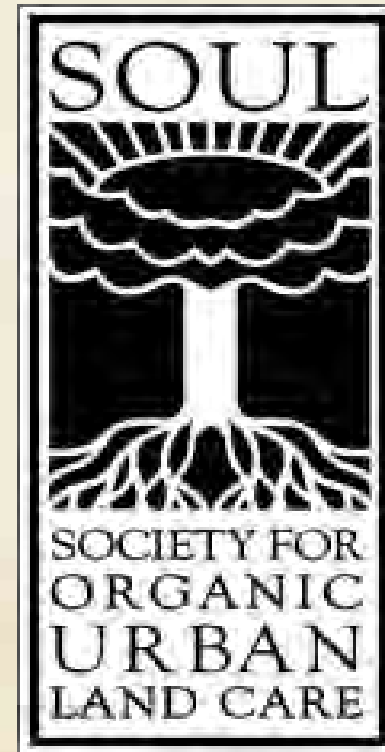



Salmon Safe – Corporate
and University campuses
can get certified

www.salmonsafe.org



Sustainable Sites Initiative



American Society of Landscape Architects
Lady Bird Johnson Wildflower Center
United States Botanic Garden



Creation and implementation of clear and rigorous design, construction, operations and maintenance criteria



The **Sustainable Sites Initiative** envisions that sustainable land practices will enable natural and built systems to work together to protect and enhance the ability of landscapes to provide services such as climate regulation, clean air and water and improved quality of life

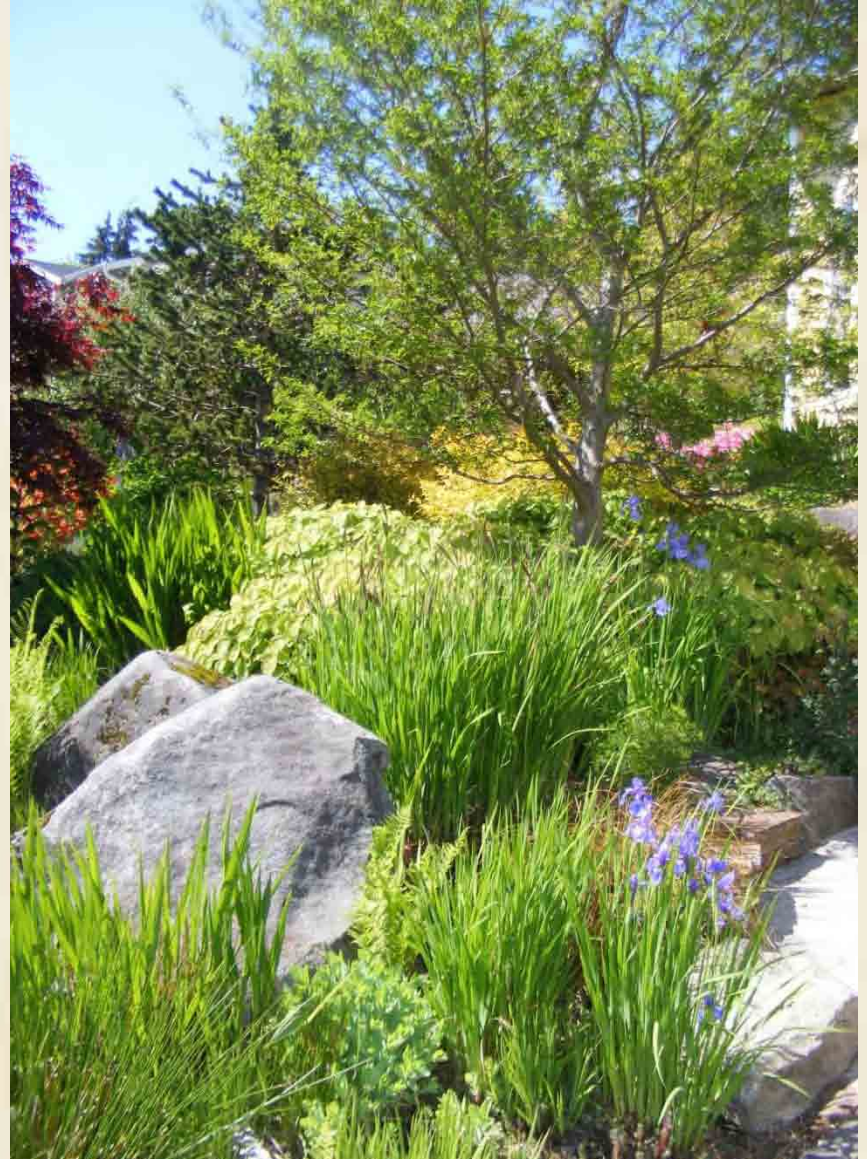



Sustainability is defined as land practices that meet the needs of the present without compromising the ability of future generations to meet their own needs

- The goal of a sustainable site is to protect, restore, and enhance ecosystem services whenever possible through sustainable land development and management practices
- Global climate regulation
- Local climate regulation
- Air and water cleansing
- Water supply and regulation
- Erosion and sediment control
- Hazard mitigation
- Pollination
- Habitat functions
- Waste decomposition & treatment
- Human health and well being
- Food and renewable non food products
- Cultural benefits

Pesticide Free Places

Database of
pesticide-free
and pesticide-
reduced parks
around King
County

**If you work at a
park or public
place (i.e.
school) and are
pesticide free,
get yourself
some
recognition!**



Pesticide Free Places - Where kids and pets play worry-free



RAINWISE

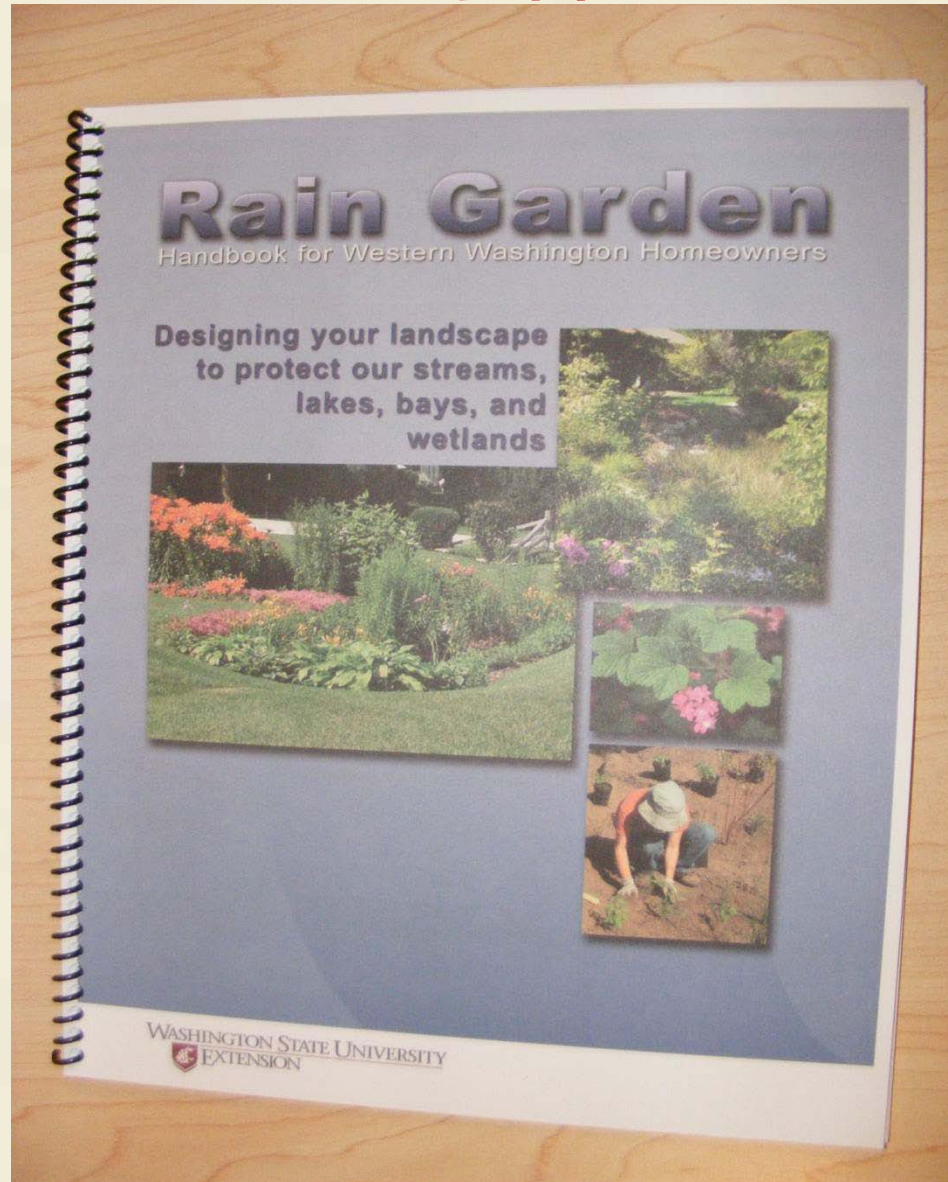

Low Impact Development Natural Landscaping





Sustainable Landscaping Resources

KING COUNTY HAZARDOUS WASTE - Voucher Incentive Program

Monetary assistance for products and equipment



Get reimbursed for purchasing items that helps cut use of pesticide products, reduces waste or reduces energy. King County is pretty flexible.



Helped pay for goat weed control on our property



Join a Professional Organization

WALP - Washington Association of Landscape Professionals

WSNLA – Washington State Nursery and Landscape Association

APLD – Association of Professional Landscape Designers

ISA – International Society of Arboriculture

WASLA - Washington Chapter of the American Society of Landscape Architects



Grow Smart, Grow Safe



A guide to lawn and garden products

4 PRE-EMERGENT Weed controls

These products are used before weeds appear. They have no effect on existing weeds.

Short-term health hazard
Long-term health hazard
Hazard to aquatic life
Hazard to birds, bees or pets
Harmful to soil
Water pollution hazard

EPA-registered pesticide products

Product	Lowest hazard	Moderate hazard	Highest hazard	NA	Not enough data	Active ingredients
100% Water®/Water® Pre-emergent Killer	○	○	○	○	○	dicamba, isoxaben
Scotts® Lawn Pro® 4 Step Program Step 1 for Healthy Starter Fertilizer with Crabgrass Preventer	○	○	○	○	○	
Vigoro® Premium Mulch with Weed Stop®	○	○	○	○	○	dischoypr
Scotts® Supreme Green® Crabgrass Preventer with Fertilizer	○	○	○	○	○	dischoypr
Vigoro® Ultra Turf™ Crabgrass Preventer	○	○	○	○	○	dischoypr
Green Light® Anzac® Grass & Weed Preventer 2	○	○	○	○	○	benefin, oryzalin
Phos® Garden Weed Preventer	○	○	○	○	○	
White® Gr® Garden Weed Preventer & Plant Food	○	○	○	○	○	trifluralin
Phos® Weed Preventer with Brilliant Shimmer™ Fertilizer	○	○	○	○	○	trifluralin
Phos® Mulch Plus®	○	○	○	○	○	trifluralin, isoxaben

○ Lowest hazard
○ Moderate hazard
○ Highest hazard

NA Not applicable
? Not enough data

Note: Products lower in the table are more hazardous. Differences between close-ranking products may not be significant.

Products and methods not EPA-registered may pose risks to the user and/or the environment. Follow all instructions and cautions on labels.

4 SELECTIVE, POST-EMERGENT Weed controls

These products are used on existing weeds. They kill either broadleaf weeds or grasses but generally not both.

Short-term health hazard
Long-term health hazard
Hazard to aquatic life
Hazard to birds, bees or pets
Harmful to soil
Water pollution hazard

Cultural, physical and mechanical methods

Method	Lowest hazard	Moderate hazard	Highest hazard	NA	Not enough data	Active ingredients
Mulch	○	○	○	○	○	
Aerate and overseed lawns	○	○	○	○	○	
Hand tools	○	○	○	○	○	
long-handled weed puller, trowel, hot-hair	○	○	○	○	○	

EPA-registered pesticide products

Product	Lowest hazard	Moderate hazard	Highest hazard	NA	Not enough data	Active ingredients
Scotts® Lawn Pro® Super Turf Builder® with PLUS 2® Weed Control	○	○	○	○	○	2,4-D, mecoprop-P
Scotts® Turf Builder® WinterGuard With PLUS 2® Weed Control	○	○	○	○	○	2,4-D, MCPP
Scotts® Turf Builder® with PLUS 2® Weed Control	○	○	○	○	○	2,4-D, MCPP
Vigoro® Ultra Turf™ Phosphorus-Free Winterizer® Weed & Feed 2	○	○	○	○	○	2,4-D, mecoprop-P, dicamba

HIGHEST HAZARD

Product	Lowest hazard	Moderate hazard	Highest hazard	NA	Not enough data	Active ingredients
Ferti-lime Over-The-Top Grass Killer RTU	○	○	○	○	○	fluazifop-P-butyl
Ortho® Grass-B-Gon® Garden Grass Killer	○	○	○	○	○	fluazifop-P-butyl
Bayer Advanced™ Brush Killer Plus RTU	○	○	○	○	○	triclopyr
Lilly Miller® Brush, Blackberry & Vine Brush Killer RTU	○	○	○	○	○	triclopyr
Ortho® MAX® Poison Ivy & Tough Brush Killer RTU	○	○	○	○	○	triclopyr
Bayer Advanced™ Brush Killer Plus Concentrate	○	○	○	○	○	triclopyr
Green Light® Cut Vine & Stump Killer	○	○	○	○	○	triclopyr
Lilly Miller® Blackberry & Brush Killer	○	○	○	○	○	triclopyr TEA salt
Ortho® MAX® Poison Ivy & Tough Brush Concentrate	○	○	○	○	○	triclopyr
Ortho® Weed-B-Gon® Chickweed, Clover and Oxalis Killer for Lawns	○	○	○	○	○	triclopyr
ACE® Spot Weed Killer 2	○	○	○	○	○	2,4-D, MCPP, dicamba
Bonide® Poison Ivy & Brush Killer 84-32 RTU	○	○	○	○	○	MCPA, triclopyr, dicamba

○ Lowest hazard
○ Moderate hazard
○ Highest hazard

NA Not applicable
? Not enough data

Note: Products lower in the table are more hazardous. Differences between close-ranking products may not be significant.

Products and methods not EPA-registered may pose risks to the user and/or the environment. Follow all instructions and cautions on labels.



Stormwater Manual for Western Washington (SWMMWW)

Detailed stormwater
requirements

2012 manual is out,
but still in draft form

Final should be in
place by October 16th,
2012





Seattle Public Utilities “ProIPM” website

- Sample maintenance guides and specs
- Post Construction Soil Management Guidelines
- Seattle’s Green Stormwater Infrastructure requirements
- Irrigation tips and rebates
- IPM Fact Sheets

Maintenance guides and specs

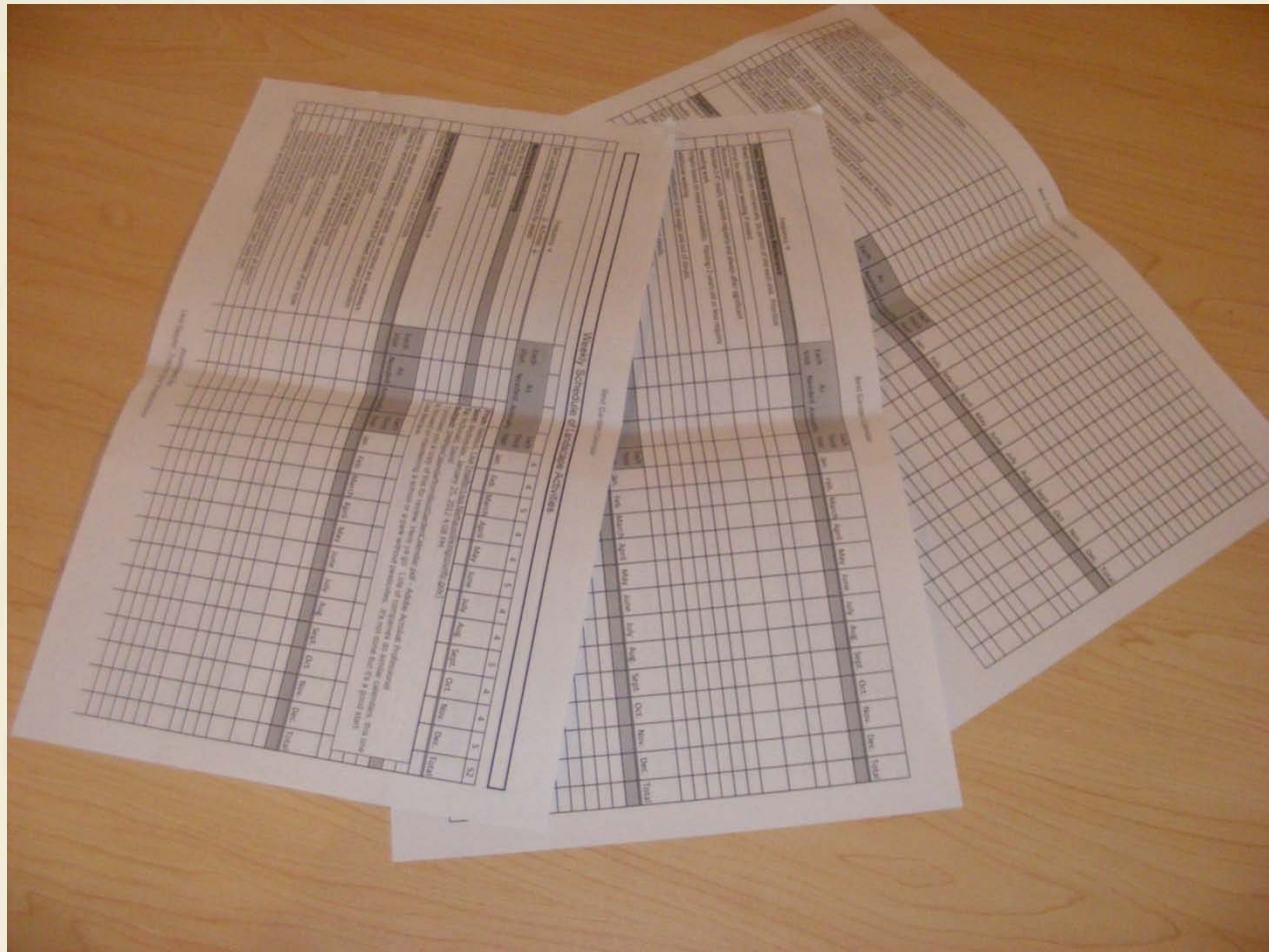

Free hotline for home gardeners
and gardening professionals





In Harmony
sustainable landscapes