



PMP Racial Equity Assessment and Implementation Plan Update

Our vision, mission, and core values

Vision: Seattle is a thriving equitable community powered by dependable transportation

Mission: to deliver a transportation system that provides safe and affordable access to places and opportunities

Committed to **6 core values:**

- Equity
- Safety
- Mobility
- Sustainability
- Livability
- Excellence

Presentation overview

- Overview
- Timeline
- Overlap with PMP Implementation Plan
- Next steps

Overview

- The Racial Equity Assessment (REA) is a framework to center racial equity and guide pedestrian investments
- REA Goals:
 - Build and sustain partnerships with communities, community organizations, and internal partners.
 - Work with BIPOC communities to identify appropriate solutions to pedestrian challenges and barriers
 - Document disparities in Pedestrian Program investments



Overview

- Audience: This project centers BIPOC communities-- specifically, refugees, individuals living with disabilities, low-income households, individuals struggling to maintain/attain stable housing, business owners and/or those disproportionately affected and impacted by COVID-19.
- The REA has a two-pronged approach
 1. Citywide
 2. Neighborhood specific



REA Committee

Equity-focused committee established to advise on REA goals and process:

| Name | Representation |
|--------------------------|---------------------------------|
| Barbie-Danielle DeCarlo | SDOT RSJI Advisor |
| Allison Schwartz | Vision Zero Program Coordinator |
| Jessica Fortino/Amy Gray | RSJI Change Team Member |
| Nathalie Salazar | ADA Team Representative |
| Stephen Barham | Data Analytics Specialist |
| Natasha Marin | NONWHITEWORKS Consultant |

Citywide Approach

- Work with community to understand barriers to walking and rolling and systemic changes to better address needs.
- Community Partners
 - NorthStar Cycling Club—BIPOC-led community building cycling group
 - Young Women Empowered (Y+WE)—mentorship-based empowerment for young women
 - Mentoring Urban Students and Teens (MUST)—Black youth and mentors in Seattle
- Community Partner Outreach and Assessment:
 - Walking, rolling, and biking trip audits/assessments
 - Surveys
 - Gap analysis
 - Community outreach events
 - Digital and physical media campaigns

Draft Timeline

| Activity/Strategy/Deliverable | 2021 | | | 2022 | | | |
|---|------|----|----|------|----|----|----|
| | Q2 | Q3 | Q4 | Q1 | Q2 | Q3 | Q4 |
| Community Based Events | ■ | ■ | ■ | ■ | ■ | | |
| Walking Assessments | | ■ | | | ■ | | |
| Digital & Physical Campaigns | | ■ | | ■ | | | |
| Video Series | | | ■ | ■ | | | |
| Summary & Reports | | | | ■ | ■ | ■ | ■ |
| Community Share Out | | | | | | ■ | ■ |

Neighborhood Approach

- Focusing on two high need areas in 2021/22
 - Chinatown-International District
 - Rainier Beach
- Neighborhoods selected based on:
 - Ped collisions
 - % foreign born
 - % people of color
 - % people of color living below poverty line
 - % people of color living with disabilities
 - % seniors of color
 - % people with limited English proficiency

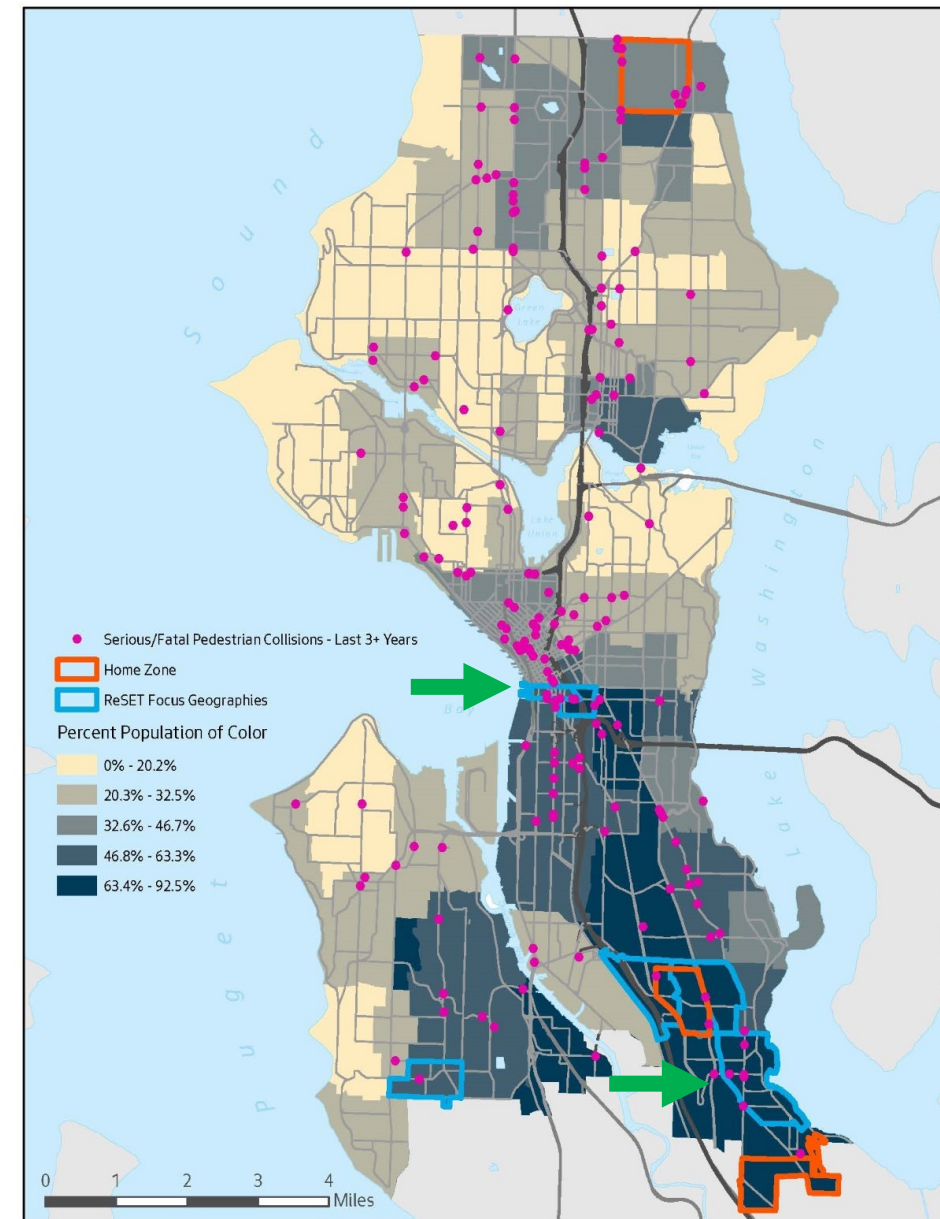

Neighborhood Approach

Strategy

- Work with community partners, organizations, Department of Neighborhoods, SDOT stakeholders, Community Liaisons, and others to engage communities of color
- Identify community concerns and priority projects

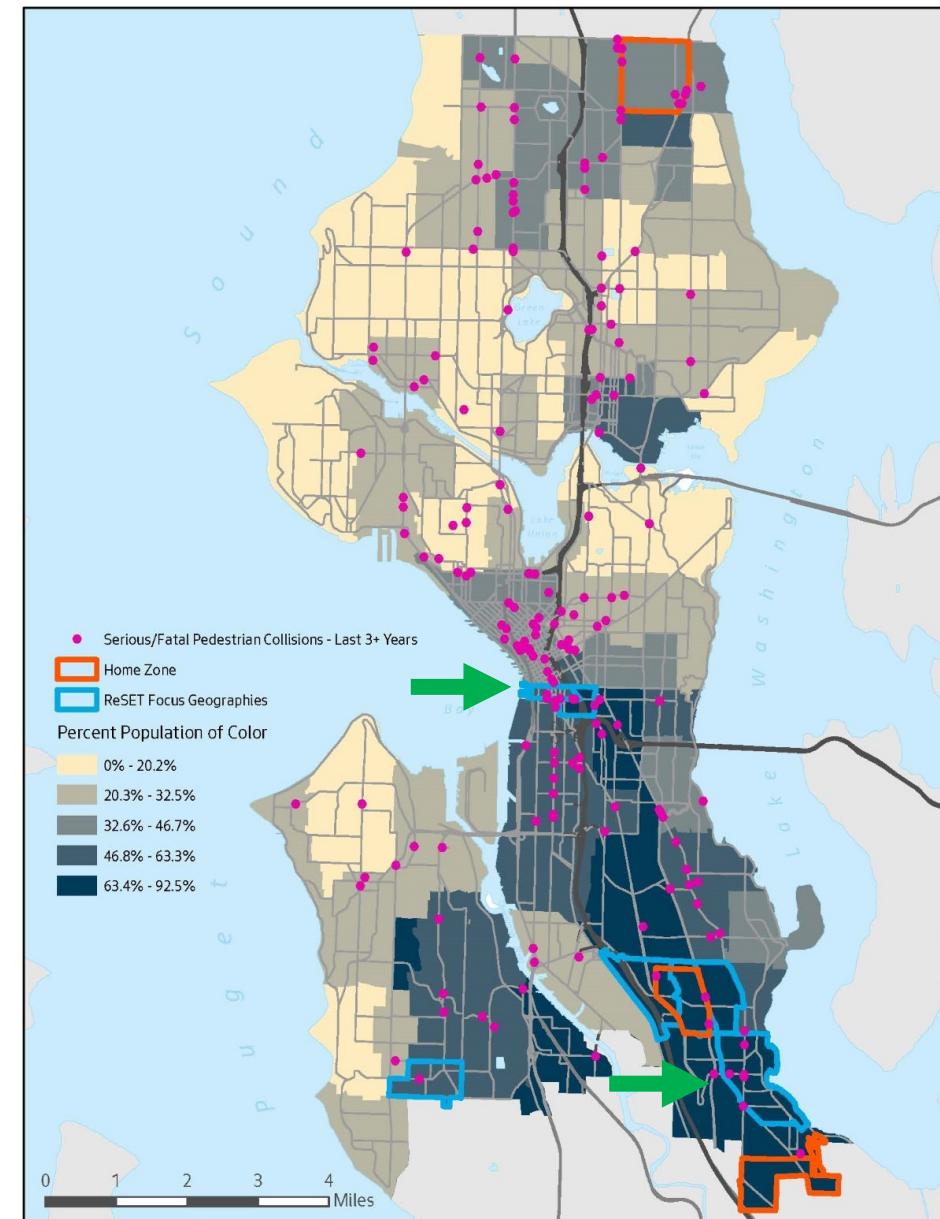

Draft Timeline

| Activity/Strategy/Deliverable | 2021 | | | 2022 | | | |
|---------------------------------|------|----|----|------|----|----|----|
| | Q2 | Q3 | Q4 | Q1 | Q2 | Q3 | Q4 |
| Identify Community Partnerships | | | | | | | |
| Community Engagement | | | | | | | |
| Deliver Projects* | | | | | | | |
| Summary & Report to Community | | | | | | | |

PMP Implementation Plan Update

- Progress report only published in 2020
- Publish new progress report and project list in 2021 based on existing prioritization process
- 2022-2024 work plan to align with the Levy to Move Seattle schedule
- Incorporate community-informed projects into workplan following REA neighborhood-level engagement
 - Chinatown-ID
 - Rainier Beach

Priority Investment Network

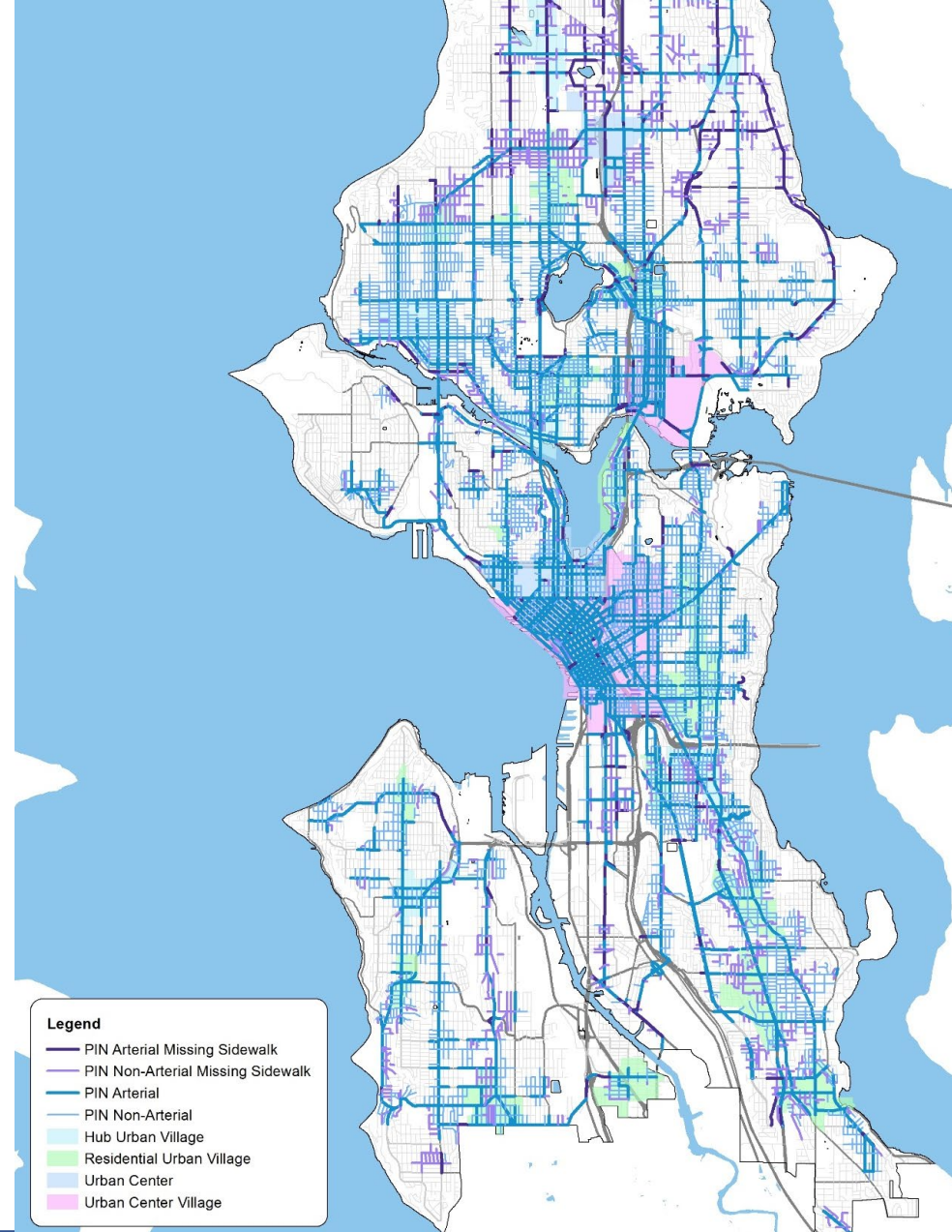

Project Selection Process

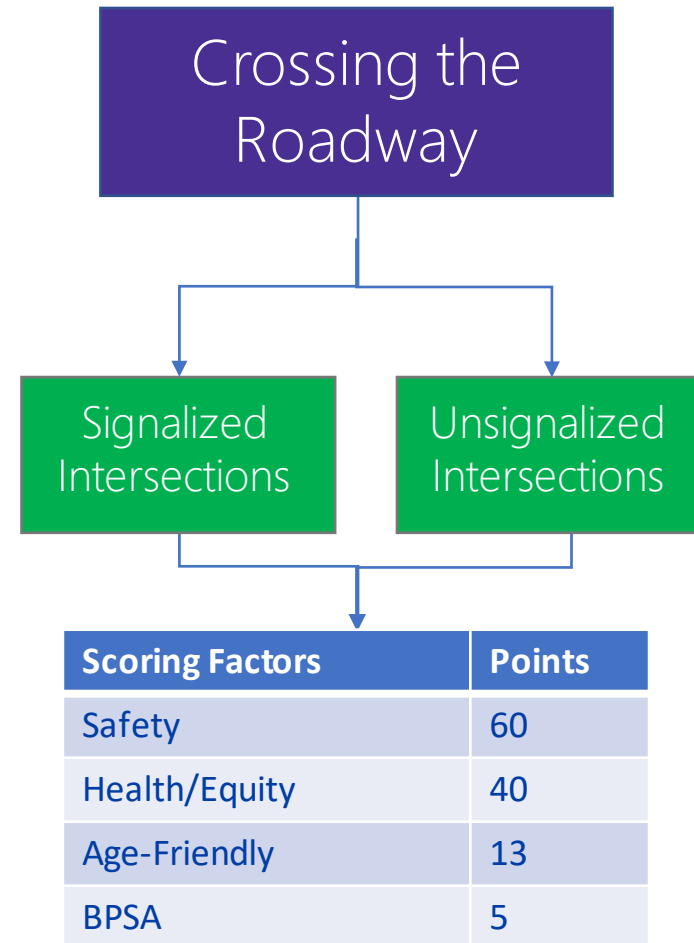
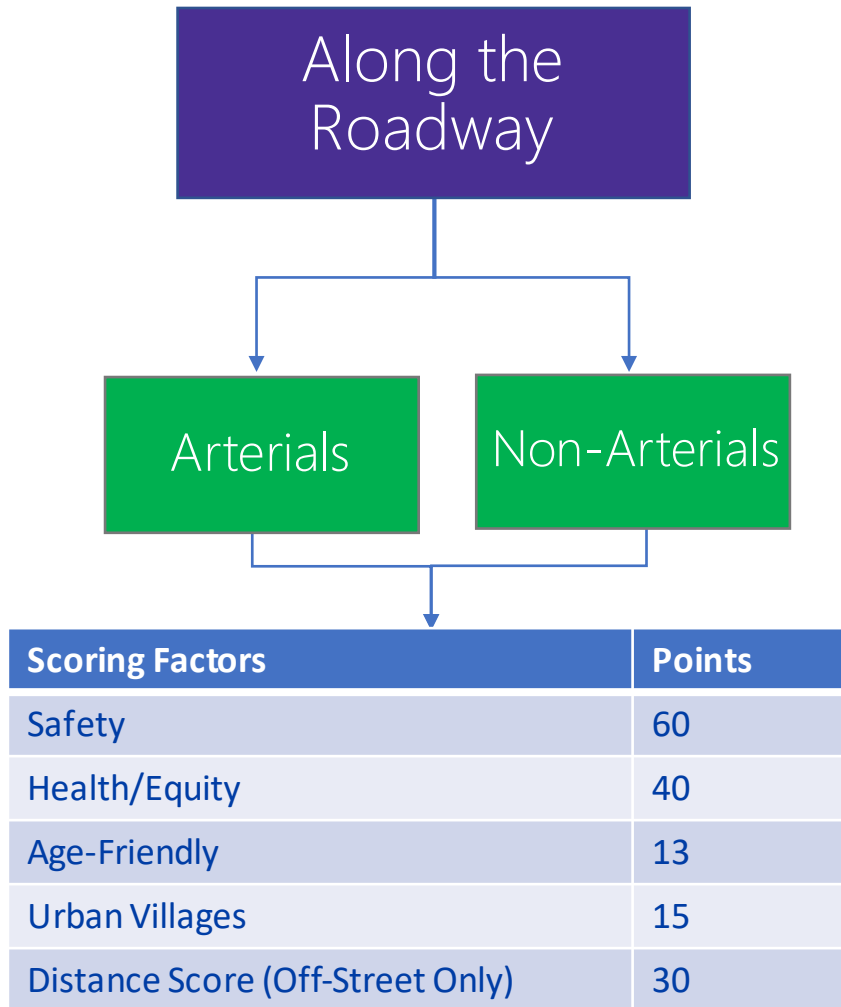

Project Delivery Status

- In 2020, completed 27.25 blocks of new sidewalks
 - 22 blocks of traditional sidewalks
 - 5.25 blocks of cost-effective walkways
- 15 new crossing improvements
- 150 levy-funded customer service request curb ramps
- 18.12 block equivalents of sidewalk repair



2020 Delayed Sidewalk Projects

- Crew-delivered projects:
 - 15th Ave NW – 95th to 96th
 - NW 132nd St – Palatine to 3rd
 - 26th Ave NE – 125th to Hiram
 - NE 90th St – 17th to 20th
- Lake City Way NE sidewalks
- Project funding restored to Sand Point Way NE, 32nd Ave S



2021 Planned Accomplishments

- 24-44 new blocks of sidewalks
 - Mix of traditional and cost-effective
 - Key projects: Sand Point Way NE, 32nd Ave S, Lake City Way NE
- 16 crossing improvements
- 150-200 levy-funded customer service request curb ramps
- 5-15 block equivalents of sidewalk repair

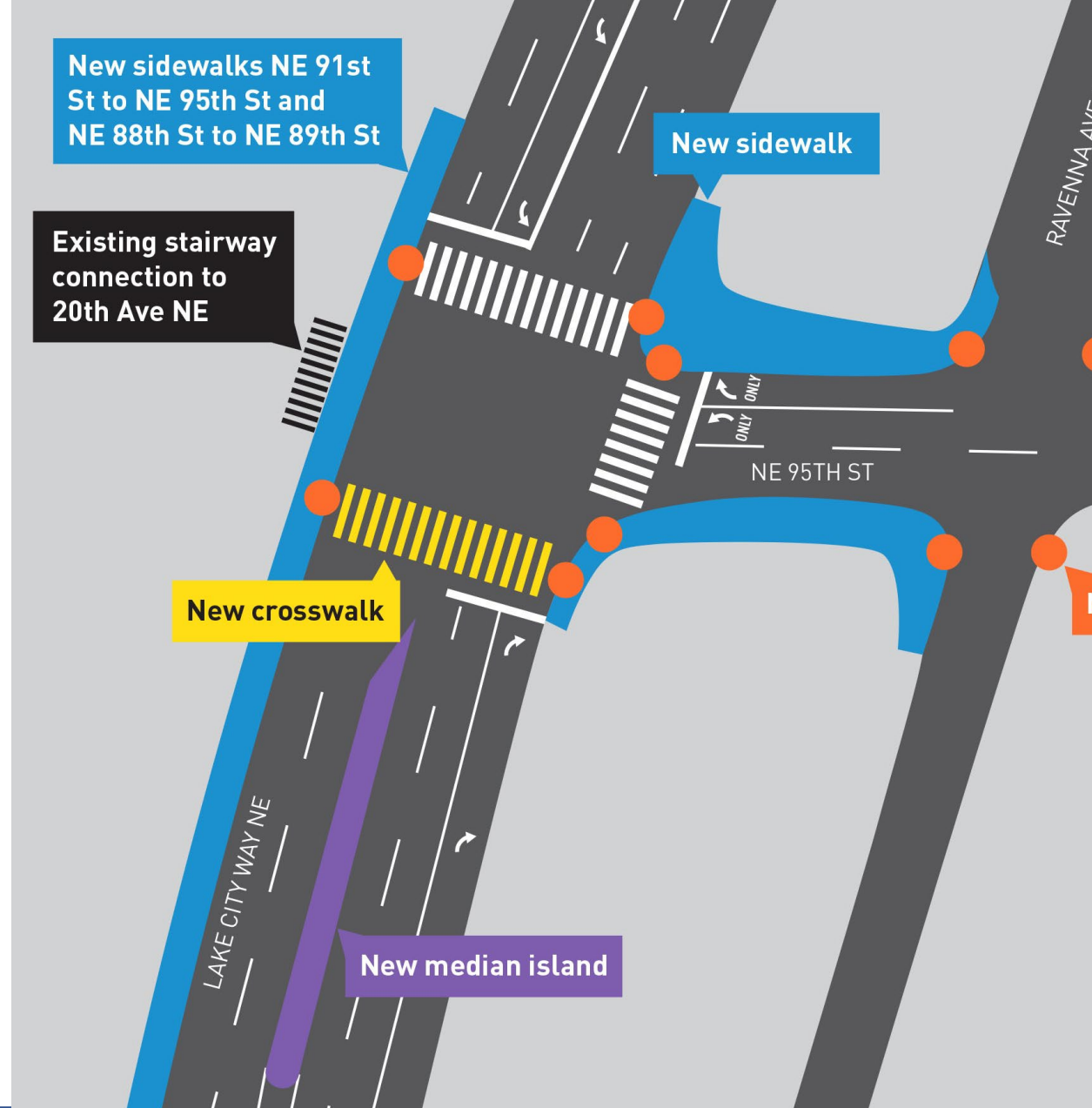

Discussion Questions

- Thoughts about how the PMP is doing to date on racial equity and opportunities
- Feedback on the approach and how SPAB would like to be involved in this effort?
- Recommendations on how to use the information to produce change?

Questions?

Kadie.Bell@seattle.gov | (206) 775-6448

David.Burgesser@seattle.gov | (206) 485-8781

http://www.seattle.gov/transportation/pedestrian_masterplan/

www.seattle.gov/transportation

