



**Seattle**  
Department of  
Transportation

## **Northgate Ped/Bike Bridge Project**

Spring 2018 Outreach Summary



## Table of Contents

Spring 2018 outreach summary.....	2
Drop-in sessions: March 19 – 21, 2018.....	2
Summary .....	2
Background .....	2
Event promotion .....	3
Event accommodations.....	4
Feedback summary.....	4
State Environmental Policy Act (SEPA) comment period .....	5
North Seattle College (NSC) Earth Fair event.....	6
Appendix 1.1—display boards .....	7
Appendix 1.2 – mailer and mailing area map.....	12
Appendix 1.3 – comment cards and full-text written comments.....	16
Appendix 1.4 – environmental review handout.....	27
Photos .....	30

# Northgate Ped/Bike Bridge Project



Seattle  
Department of  
Transportation



## Spring 2018 outreach summary

This report summarizes outreach conducted in the spring of 2018 for the Northgate Ped/Bike Bridge project. Included in this effort were drop-in sessions hosted in March, opportunity to comment on State Environmental Policy Act (SEPA) Mitigated Determination of Non-Significance in April, and participation in Earth Fair, North Seattle College's annual celebration of Earth Day.

This outreach provided updated information on the project and informed the community of the State Environmental Policy Act (SEPA) public comment period.

## Drop-in sessions: March 19 – 21, 2018

### Summary

The most common theme of comments submitted at the 3 drop-in sessions was safety and security, followed by 1st Ave NE elements and pedestrian crossings and sidewalks.

The drop-in sessions drew North Seattle College students, staff, and faculty; neighborhood residents and retirement community members; neighborhood businesspeople; and many project-area stakeholders including elected officials and community organizations. Most attendees were very familiar to somewhat familiar with the project.

### Background

We hosted 3, 90-minute drop-in sessions on March 19, 20, and 21, 2018. Events were held at North Seattle College, Aljoya Thornton Place, and Neighborcare Health at Meridian. The purpose of these sessions was to share information about the project's design refinement to the west approach, the 1st Ave NE protected bike lane, public art, and the SEPA public comment period. The sessions also included updates from Sound Transit, the North Seattle Neighborhood Greenway, and the Northgate Neighborhood Greenway.

### Outreach snapshot

- **Over 10,000 mailers** sent to project area addresses
- **Over 600 invitation emails** sent through the project listserv
- **Nearly 90 attendees** over the course of the 3 sessions

Each drop-in session included information on the following topics:

- Project goals and map

- Current design, including a recent alignment update to the west approach
- Environmental review, including potential impacts and approaches for mitigation
- 1st Ave protected bike lane and multi-use path
- Updated project art by Charles Sowers (called WaveSpan)

See Appendix 1.1 to view display boards.

## Event promotion

We promoted the drop-in sessions through the following methods:

- Mailers to homes in the North Seattle area (see Appendix 1.2). The mailer included Chinese, Spanish, Arabic, and Amharic translations
- Targeted emails and phone calls to stakeholders
- Social media posts
- Project webpage updates
- City-sponsored event calendars
- Distribution of postcards at community gathering spots (e.g., community centers, libraries, colleges, coffee shops, restaurants, apartments, etc.)
- Blogs
  - Haller Lake
  - Pinehurst (shown below)
  - Victory Heights

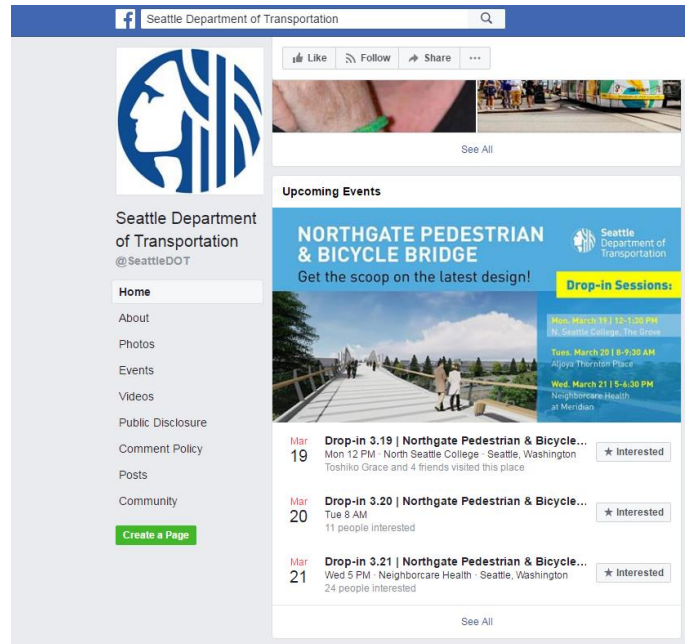

## Northgate Ped/Bike Bridge Drop-in Sessions

SDOT is hosting three informal drop-in sessions for the Northgate Ped/Bike Bridge project later this month. SDOT recently updated the west approach to the bridge, in response to concerns raised by North Seattle College. At these drop-in sessions, SDOT will share the latest design, provide updates on public art, talk about the 1st Ave NE protected bike lane, and give information on SEPA environmental review.

Here are the details:

### Monday, March 19: 12 – 1:30 PM

North Seattle College, The Grove, 9600 College Way N

### Tuesday, March 20: 8 – 9:30 AM

Aljoa Thornton Place, 450 NE 100th St

### Wednesday, March 21: 5 – 6:30 PM

Neighborcare Health at Meridian, Room 110, 10521 Meridian Ave N

Drop-in sessions are opportunities for you to speak with project staff in an informal setting when it's convenient for you. If you can't make one of these events, SDOT will also post the same information on its project webpage as soon as March 12.

SDOT will soon complete SEPA environmental review and will issue a Mitigated Determination of Non-Significance (MDNS) and SEPA checklist in March. There will be a 14-day public comment period followed by a 7-day appeal period on the MDNS and SEPA checklist. SDOT will notify the community when the SEPA documents are issued, where to find them, what the comment period dates are, and how to comment on its website and through its project email listserv.

Posted by Nancy | March 2nd, 2018 | Category: Biking, Transportation | [Leave a comment](#)

## Event accommodations

The following accommodations were provided at the drop-in sessions:

- Americans with Disabilities Act accessible venues that were easily accessible by transit
- Arabic, Chinese, and Spanish translated project folios, and interpretation provided upon request
- Light refreshments from local vendors
- Bike racks at each location

We offered 3 different event locations to serve both east and west sides of the project area and hosted a morning, midday, and early evening session (8 – 9:30 AM, 12 – 1:30 PM, and 5 – 6:30 PM) to accommodate different schedules of students, parents, and people working during typical business hours. The informal format of the sessions allowed participants to come and go at their convenience.

## Feedback summary

We provided drop-in session participants with comment cards at each event. Roughly 20 comment cards were submitted over the 3 drop-in sessions. The 3 most common themes were safety and security, 1st Ave NE elements, and pedestrian crossings and sidewalks.

See Appendix 1.3 for full-text comment cards. Below are representative comments:

### Theme: Safety and security

*“Concerned about lighting and sidewalks in the surrounding area...with the increased traffic and population with construction.”*

*“Video cameras on the bridge?”*

*“Lots of buses go too fast...don’t feel safe...”*

*“Concerns about PBL on 100th Street and Aljoma residents...concerns about frequency of buses + safety of people walking.”*

### Theme: 1st Ave NE elements

*“I want crossings for people walking + bikes on E/W streets at 1st Ave NE...”*

*“Please put a physical barrier between PBL’s and traffic on 1st. Traffic moves very fast....”*

*“Why not change the “protected bike lane” to multi-use—allow walkers/runners on the same side. Pedestrians first, bikers 2nd, cars last. Thanks!”*

*“Is 3rd Ave NE (tree lined Meridian is quieter) being considered as an alternative to 1st Ave NE?...”*

**Theme: Pedestrian crossings and sidewalks**

*“What are your plans for sidewalks on either/both NE 115 + NE 117, between Pinehurst and 5th Ave NE?...”*

*“5th Ave sidewalks-westside (103 to NGate)...need improvements...”*

*“Signal on 103<sup>rd</sup>/5<sup>th</sup> Ave...light time – difficult to cross street (Recommend 4-way walk light)...cuts down on time to cross the street.”*

Other topics occasionally mentioned include environmental impacts, transit/shuttle circulation, street and residential parking, public art, bike connectivity, Northgate Neighborhood Greenway and advertisement space on the bridge.

## **State Environmental Policy Act (SEPA) comment period**

SEPA is a process that identifies and analyzes environmental impacts associated with governmental decisions. These decisions may be related to issuing permits for private projects, adopting regulations or policies, or constructing public facilities. The SEPA review process helps agency decision-makers, applicants, and the public understand how the entire proposal will affect the environment (Washington State Department of Ecology, 2018). SEPA review also gives the public a chance to provide official comments for consideration.

We provided notice of the SEPA comment and appeal periods through the following methods:

- Targeted emails to over 600 contacts
- Updates to the project webpage
- Legal ads placed in the Daily Journal of Commerce
- Environmental handout information (see Appendix 1.4)
- SEPA information was also included on all promotional materials for the drop-in sessions (see page 3 for a full list of each type)

During the comment period, the SEPA Checklist and signed Mitigated Determination of Non-Significance were posted on the project webpage. Documents were also available for viewing at the Seattle Department of Construction and Inspections Public Resource Center, Seattle Central Library, and the Northgate Library.

## North Seattle College (NSC) Earth Fair event

On April 18, North Seattle College (NSC) hosted an Earth Fair in celebration of Earth Day. The event featured a variety of environmental topics including food waste, alternative transportation, and ecological justice. Our table shared updates on the refined design of the west approach (which touches down on the NSC campus) and provided information about environmental impacts and mitigation to trails and wetlands.

The event was attended by students, staff, and faculty and the general response to the project design was positive. We spoke to roughly 35 people. Both those familiar with the project and those who were not engaged project staff with asking questions regarding project timeline, funding, and safety.

Example questions and comments received include:

- Who's funding this project?
- Where's the future Sound Transit station located?
- Where will the bridge start and end?
- How can I support this project or be more informed?
- When will the bridge open to people?
- Why is there a solid berm on the west approach and not pillars?
- Feedback about lighting, bicycle speed, safety of bridge users, and frog migration under the bridge

# Appendix 1.1

Display boards

## NORTHGATE PED/BIKE BRIDGE

# CONNECTING COMMUNITIES EAST AND WEST OF I-5

### Project Goals:

- **Connect services and opportunities** on the east and west sides of I-5
- **Add a new, accessible walking/biking route in Northgate** that connects to the citywide network
- **Provide better access to regional transit**, including the existing transit center and future Link light rail station



[www.seattle.gov/transportation/northgatepedbridge.htm](http://www.seattle.gov/transportation/northgatepedbridge.htm)

THE CITY OF  
**MOVE SEATTLE**  
SEATTLE  
Department of Transportation

## NORTHGATE PED/BIKE BRIDGE

# CURRENT DESIGN

Since spring 2017, we've been working closely with our partners at North Seattle College (NSC) to ensure the success of the bridge, which will be a substantial amenity for NSC students, faculty, and staff. Working with the College, we've refined the design of the west approach.

- Straighter alignment
- Reduced slope
- Accommodates site constraints
- Preserves valuable College land
- Meets Sound Transit's schedule



[www.seattle.gov/transportation/northgatepedbridge.htm](http://www.seattle.gov/transportation/northgatepedbridge.htm)

THE CITY OF  
**MOVE SEATTLE**  
SEATTLE  
Department of Transportation

## ENVIRONMENTAL REVIEW

Water on both the west and east sides eventually drains into Thornton Creek. Pacific Tree Frogs can be found in the NSC natural area, and fish have been found in all watercourses.



## Potential impacts

- Permanent and temporary impacts to NSC trails
- Fill and reshaping wetlands and watercourses
- Discovery of cultural resources during construction/impacting existing historic site

### Avoidance, minimization, and mitigation

- Relocation of displaced trails/restoration of trails after construction
- Wetland enhancement/on- and off-site mitigation
- Security call boxes on the bridge (bridge lighting also provides facial recognition and security)
- Avoiding historic sites and monitoring for cultural resources during construction

# NORTHGATE PED/BIKE BRIDGE

## 1ST AVE NE PROTECTED BIKE LANE AND MULTI-USE PATH

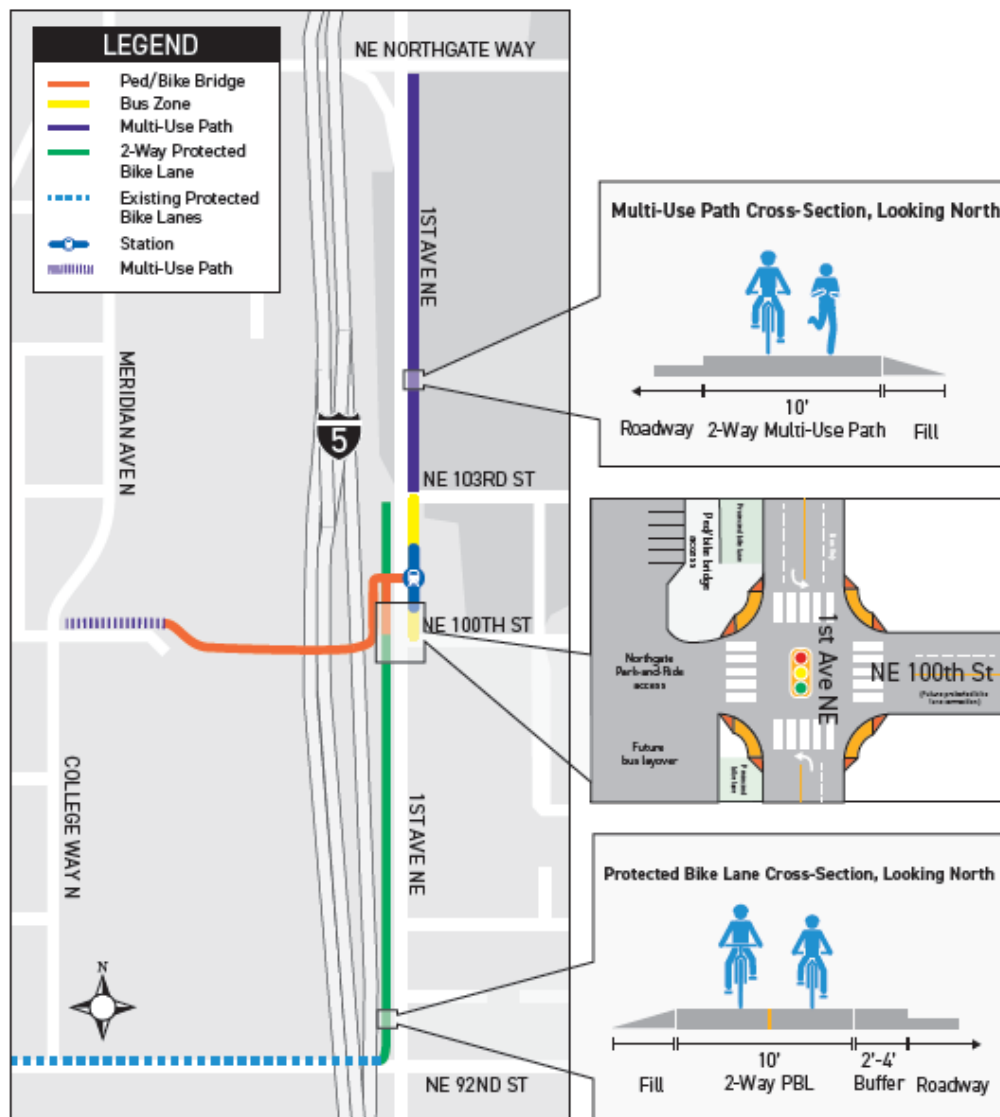

# NORTHGATE PED/BIKE BRIDGE

## PROJECT ART

### Project Artist: Charles Sowers

Charles Sowers is an artist whose practice links art, science, and physical phenomena.

*WaveSpan* is a kinetic/interactive sculpture that features "pickets" that will line the south side of the bridge's west approach ramp. Motion sensors will be spaced throughout the artwork and respond to the passing of a person and rotate that picket in towards the bridge and then release it, setting in motion a slowly moving wave that ripples through the 40 to 60 pickets arrayed over 200-300 feet of the west ramp. The wave is real, a so-called torsion wave. It is a product of rotational movement through the medium of cable coupled pickets. The sensor driven picket rotates, dragging along its neighbors who in turn pass the motion along to their neighbors.

See more of Charles's work at: [charlessowers.com](http://charlessowers.com)

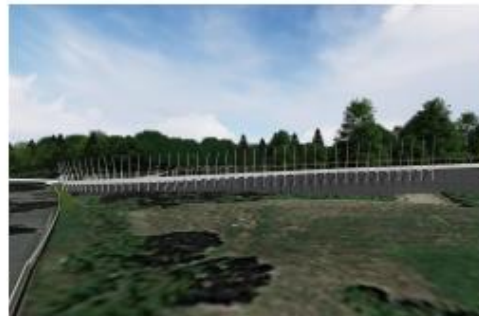

This art installation was commissioned with SDOT 1% for Art funds.



OFFICE OF ARTS & CULTURE  
SEATTLE

[www.seattle.gov/transportation/northgatepedbridge.htm](http://www.seattle.gov/transportation/northgatepedbridge.htm)



# Appendix 1.2

Mailer and mailing area map



## Northgate Ped/Bike Bridge Project

### Join us at a drop-in session: March 19, 20, & 21

We're designing a new accessible, all ages and abilities pedestrian and bike bridge over I-5 in North Seattle. Come learn about:

- Bridge design updates
- 1st Ave NE protected bike lane
- Public art
- Upcoming State Environmental Policy Act (SEPA) environmental review and how to provide feedback during the public comment period

See inside for details!



For more information  
NorthgateBridge@seattle.gov, (206) 615-0925  
[www.seattle.gov/transportation/northgatepedbikebridge.htm](http://www.seattle.gov/transportation/northgatepedbikebridge.htm)

Northgate Ped/Bike Bridge Project  
For more information  
NorthgateBridge@seattle.gov, (206) 615-0925  
[www.seattle.gov/transportation/northgatepedbikebridge.htm](http://www.seattle.gov/transportation/northgatepedbikebridge.htm)

See inside for more details  
NORTHGATE PEDESTRIAN/BIKE BRIDGE PROJECT UPDATE  
ACTUALIZACIÓN DEL PROYECTO DEL PUENTE PARA  
PEATONES Y CICLISTAS DE NORTHGATE  
Más detalles en el interior  
Northgate 步行/自行車項目最新資訊  
請參考裡面的內容瞭解詳情

Seattle Municipal Tower  
700 9th Ave, Suite 3800  
PO Box 34996  
Seattle, WA 98124-4996

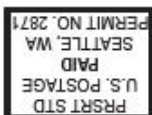

## Drop in anytime to learn more:

Drop-in sessions are open, informal opportunities for you to come and go as fits your schedule and speak with project staff. Information will also be posted on our project webpage.

**Monday, March 19: 12-1:30 PM**  
North Seattle College, The Grove  
9600 College Way N

**Tuesday, March 20: 8-9:30 AM**  
Aljoya Thornton Place  
450 NE 100th St

**Wednesday, March 21: 5-6:30 PM**  
Neighborcare Health at Meridian  
Room 110  
10521 Meridian Ave N

- These venues are ADA accessible
- To plan your trip, visit [tripplanner.kingcounty.gov](http://tripplanner.kingcounty.gov)
- To request an interpreter or accommodations for persons with disabilities, please contact (206) 615-0925 at least 5 working days before the event

### Can't make these events?

Review materials online as soon as March 12 at:  
[www.seattle.gov/transportation/northgatepedbridge.htm](http://www.seattle.gov/transportation/northgatepedbridge.htm)



Working with our partners at North Seattle College, we recently refined the west approach to the bridge. Stop by a session to see the updated design and public art updates and learn about environmental review.

## State Environmental Policy Act (SEPA) checklist coming soon

We'll soon complete SEPA environmental review and will issue a Mitigated Determination of Non-Significance (MDNS) and checklist in March. Once issued, there will be a 14-day public comment period followed by a 7-day appeal period on the MDNS and checklist. We'll notify the community when the documents are

issued, including where to find them, what the comment period dates are, and how to comment, on our project webpage and through email updates. To learn more about the project, the SEPA process, and the upcoming comment period, please attend our drop-in sessions, visit our webpage, and sign up for email updates.

**近期活動！** Northgate步行/自行車橋來訪會，以及州環境政策法案 (State Environmental Policy Act, SEPA) 清單和評論期

前來瞭解西側上橋入口的設計改進、公共藝術、SEPA的公眾評論期，以及如何在SEPA的公眾評論期提供反饋意見。

我們將透過項目網站及項目電郵更新來通知社區關於SEPA檔案的發布、您可以在哪裡看到這些文件、評論期的時限，以及如何提出建議。

請在我們的網站上註冊，以電子郵件的方式獲得最新資訊（請見以下的連結）。

請在以下任何一個來訪會議時間前來：

3月19日，星期一：	3月20日，星期二：	3月21日，星期三：
中午12時 – 下午1:30	上午8時 – 9:30	下午5時 – 6:30
The Grove, North Seattle College (北西雅圖社區大學) 9600 College Way N	Aljoya Thornton Place 450 NE 100th St	Neighborcare Health at Meridian, 110房間 10521 Meridian Ave N

### 無法參加這些活動？

3月12日之後您即可在線上檢視這些材料：  
[www.seattle.gov/transportation/northgatepedbridge.htm](http://www.seattle.gov/transportation/northgatepedbridge.htm)

若需要口譯服務，或是接待殘障人士，請在活動前至少5個工作日前撥打(206) 615-0925與我們聯絡。

**¡Próximamente!** Sesiones informales sobre el Puente para peatones y ciclistas de Northgate y la lista de verificación y el período de comentarios de la Ley Estatal de Política Ambiental (SEPA, State Environmental Policy Act).

Venga a informarse sobre el diseño actualizado del acceso del lado oeste del puente, arte público, el período de comentarios del público sobre SEPA y cómo dar sus opiniones durante este período.

A través del sitio web del proyecto y de actualizaciones por email, le avisaremos a la comunidad cuando estén publicados los documentos de SEPA, dónde encontrarlos, las fechas del período de comentarios del público y cómo hacer sus comentarios.

Anótese en nuestra página web para recibir actualizaciones por email (use el enlace de más abajo).

Venga en cualquier momento durante una de estas sesiones informales:

Lunes 19 de marzo:	Martes 20 de marzo:	Miércoles 21 de marzo:
12 – 1:30 p.m.	8 – 9:30 a.m.	5 – 6:30 p.m.
North Seattle College, The Grove 9600 College Way N	Aljoya Thornton Place 450 NE 100th St	Neighborcare Health at Meridian, sala 110 10521 Meridian Ave N

### ¿No puede asistir a estas reuniones?

A partir del 12 de marzo podrá leer los materiales en internet:  
[www.seattle.gov/transportation/northgatepedbridge.htm](http://www.seattle.gov/transportation/northgatepedbridge.htm)

Para solicitar un intérprete o adaptaciones para discapacidades, llame al (206) 615-0925 por lo menos 5 días hábiles antes de la sesión.

### For more information

[NorthgateBridge@seattle.gov](mailto:NorthgateBridge@seattle.gov), (206) 615-0925  
[www.seattle.gov/transportation/northgatepedbridge.htm](http://www.seattle.gov/transportation/northgatepedbridge.htm)



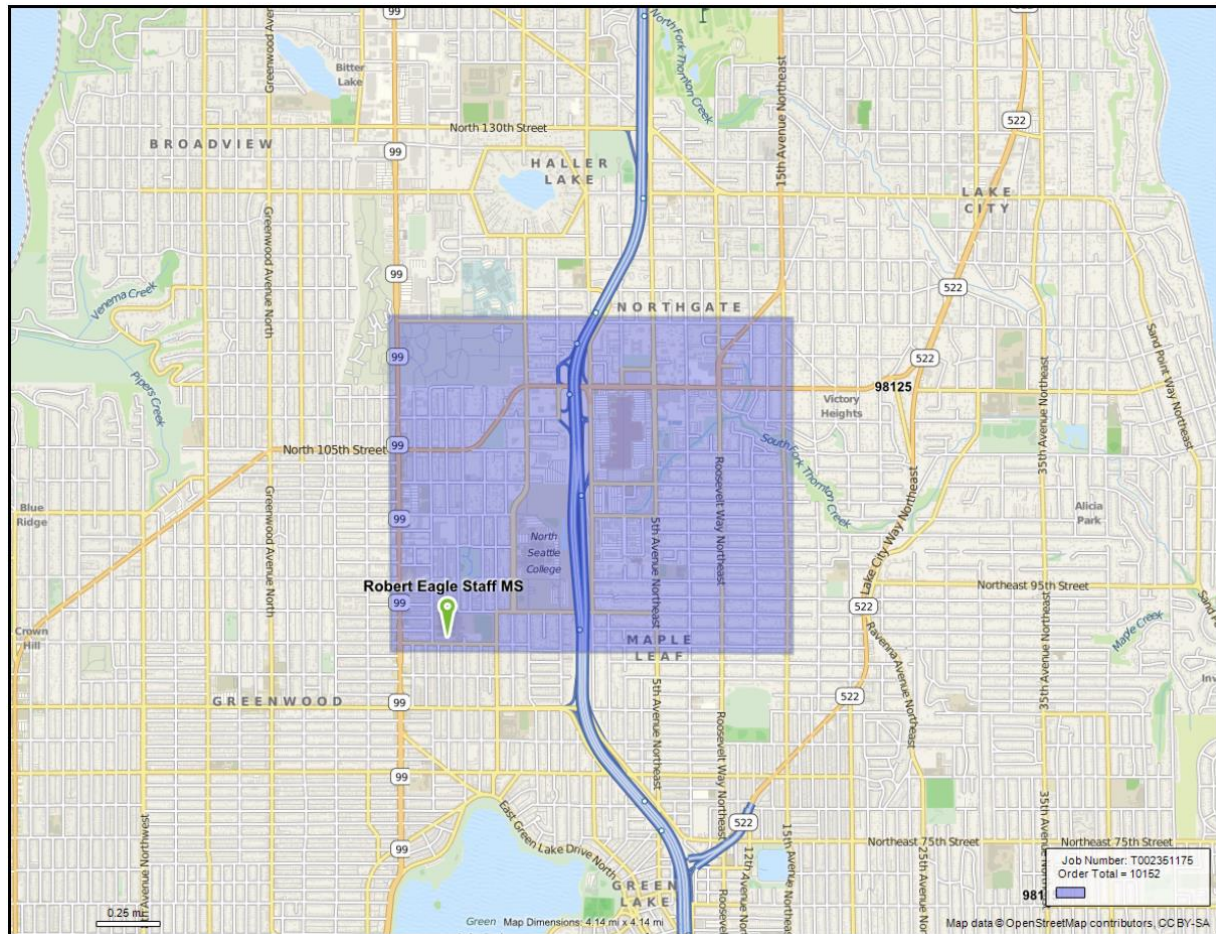

# Appendix 1.3

Comment card and full-text written comments

NORTHGATE BRIDGE PROJECT  
DROP-IN SESSION COMMENT FORM  
MARCH 19, 20 & 21, 2018

Name (optional):

Email (optional):

Please write your comments and questions below and on the back:

Please write your comments and questions below and on the back:

More info on expanding the RPZ on the West side of the pedestrian bridge? People will park in this neighborhood and use the bridge. What/who will help with the RPZ?

Please write your comments and questions below and on the back:

Concerned about lighting and sidewalks in the surrounding area (specifically Haller Lake) with the increased traffic and population with the construction

Please write your comments and questions below and on the back:

(TO COLLEGE WAY & N 100<sup>TH</sup>)  
WE <sup>WILL</sup> NEED EFFICIENT TRANSIT SHUTTLE  
SHORT ROUTES TO SERVICE THE NEIGHBORHOODS  
WEST OF I-5 TO THE SOUND. 105<sup>TH</sup>/125<sup>TH</sup>/130<sup>TH</sup> ETC.  
SHUTTLES TO CONNECT NEIGHBORHOODS TO THE  
W. SIDE OF PEDESTRIAN BRIDGE VS TRAFFIC  
~~JAMS~~ JAMS OF LYFT/UBER CONGESTING THE  
AREA AROUND THE COLLEGE. (OVER)

WE'LL

ALLOW FOR  
PROJECTED GROWTH  
EXPANSION.

ALSO ~~NEED~~ NEED MANY BIKE  
MORE  
LOCKERS ON BOTH SIDES OF THE  
BRIDGE. MORE USE OF ELECTRIC BIKES  
SHOULD BE ANTICIPATED WITH THIS PLAN.

This bridge  
is essential!  
Thanks!

Please write your comments and questions below and on the back:

The bridge will provide a great connection to light rail from the  
west side of I-5 - avoiding the Transit Center congestion.  
Please consider a good (circular?) <sup>pickup</sup> drop off at NE 100th +  
<sup>(on Meridian)</sup> Meridian. Bus riders can use it too. Consider a shuttle  
from Aurora Ave too.

Please write your comments and questions below and on the back:

This art project is a huge disappointment. It requires motors and electricity to function properly. There is no solar use or wind power. It will require continual maintenance to operate properly and ~~we~~ all know

maintenance is the last thing we need. The "Spikeness" is off putting and certainly not inviting ~~not~~ imparting a sense of security. There is no "natural phenomena" here. It is all mechanical and fake. No color, no love. Again, a huge disappointment!! huge disappointment!

Please write your comments and questions below and on the back:

Can North Seattle College get  
advertising space on the bridge?

Please write your comments and questions below and on the back:

METRO - Please enable frequent-reliable bus  
transit to the Northgate station? Add BUS only lanes  
+ whatever other means. We cannot all drive to the  
station. EAST/WEST connections

Please write your comments and questions below and on the back:

The greatest environmental impact on the natural  
area by the bridge is from I-5 - tire  
dust, oil, etc. Any environmental plan needs  
to address remediation of this problem, which

is by far larger than the impact of the bridge.  
the areas around the bridge need substantial  
work- removal of invasives, planting of  
native species - both for environmental  
restoration and for security.

Please write your comments and questions below and on the back:

What are the plans for sidewalks  
on either/both NE 115 + NE 117, between  
Pinehurst and 5<sup>th</sup> Ave NE? ~~Will~~ Both 115 + 117  
on 5<sup>th</sup> have bus stops. ~~separately~~ Thank-you, Sch

Please write your comments and questions below and on the back:

① Signal 103rd/5th Ave - ~~turning~~ right hand  
turn - on North side  
Bus turn on red - cuts into walk light  
time - diff, cut to cross street (Recommend  
4-way ~~stop~~ walk light) \*  
Cuts down on time to cross the street

② 5<sup>th</sup> Ave sidewalks - west side (103 to W 6<sup>th</sup>)  
overgrown w/ivy  
lots of buses - go too fast  
don't feel safe  
Need improvements (e east side too)  
(103<sup>rd</sup> to community center)

Please write your comments and questions below and on the back:

Please keep us posted on progress, public reviews, etc.  
We would welcome project reps to speak to us at our meetings  
Thanks!

Please write your comments and questions below and on the back:

video cameras on the bridge?

Please write your comments and questions below and on the back:

Use of bike lane on 100<sup>th</sup>  
especially corner of 5<sup>th</sup> N.E. + N.E. 100<sup>th</sup>  
(+ for the rest of business area)

Please write your comments and questions below and on the back:

Concerned about PBL on 100<sup>th</sup> Street  
and Aljaya residents conflicts w/ bikes  
crossing the bike lane. + volume of traffic  
Concern also about frequency of buses +  
safety of people walking

Please write your comments and questions below and on the back:

Is 3rd Ave NE (tree-lined median & quieter)  
being considered as an alternative to 1st  
Ave NE? It would need an easement & ramp to  
connect but would be much more pleasant.

Please list your comments and questions below:

For Northgate Neighborhood Greenway, why was the option to connect Olympic View Elementary to Maple Leaf Reservoir Park not selected?

See back for more space

Please list your comments and questions below:

Any chance for a bike lane on 92<sup>nd</sup> between 1<sup>st</sup> Ave & 5<sup>th</sup>? Would nicely connect 2 bike routes!

See back for more space

Please list your comments and questions below:

Please put a physical barrier between PBL's and traffic on First. Traffic moves very fast.  
Thank you.

See back for more space

Please list your comments and questions below:

I want crossings for people walking + bikes on E/W streets at 1st Ave NE. For example, 95th, 94th to access west side PBL.

[See back for more space](#)

Please list your comments and questions below:

Why not change the "protected bike lane" to the multi-use - allow walkers/runners on the same side. Pedestrians first, bikers 2<sup>nd</sup>, cars last. Thanks!

[See back for more space](#)

Please list your comments and questions below:

Will we get more street parking back? This project will only make parking + traffic worse. What addresses this?

[See back for more space](#)

# Appendix 1.4

Environmental review handout

# NORTHGATE PED/BIKE BRIDGE

## ENVIRONMENTAL REVIEW

March 2018

Environmental review for the Northgate Ped/Bike Bridge project will meet federal requirements of the National Environmental Policy Act (NEPA) and state requirements of the State Environmental Policy Act (SEPA). NEPA review is required for projects with federal funding and SEPA review is required for City capital projects.

We're completing environmental reports that evaluate impacts to:

- Transportation
- Open space and trails
- Wetlands
- Fish and wildlife
- Cultural resources
- Endangered species

### What is the SEPA process and when will SEPA be completed?

SEPA is a process that identifies and analyzes environmental impacts associated with governmental decisions. These decisions may be related to issuing permits for private projects, adopting regulations or policies, or constructing public facilities. The SEPA review process helps agency decision-makers, applicants, and the public understand how the entire proposal will affect the environment.<sup>1</sup> SEPA review also gives the public a chance to provide official comments for consideration. SDOT and the North Seattle College (NSC) have determined that impacts associated with the pedestrian/bike bridge can be mitigated. We'll issue a Mitigated Determination of Non-Significance in late March, which will begin SEPA review. This includes a 14-day public comment period followed by a 7-day public appeal period. Unless appealed, SEPA will then be complete.

### What is the NEPA process and when will NEPA be completed?

The NEPA process is similar to the SEPA process, and documentation is similar to a SEPA checklist. We expect NEPA review to be completed later this year.

### Understanding the project site

On the west side of the project, the North Seattle College (NSC) campus's unique environmental features include a wetland complex, a natural area, open space, and a historic site. Some of these areas are used for passive recreation, including woods and wetlands that contain trails with numerous points of interest, a greenbelt surrounding the campus, and an abandoned ballfield.

At the east end of the project, the bridge meets grade east of I-5 near NE 100th St and 1st Ave NE, using land owned by the Washington State Department of Transportation (a Park and Ride lot) and City of Seattle right of way.

Environmental features in this area include 4 wetlands and 2 watercourses (i.e., brooks, streams or channels).



Green Lake Gardens Company, 1934 (Densho Digital Repository, 2015).



Cranberry Loop (Seattle Department of Transportation, 2016).

### PROJECT INFORMATION & CONTACT

NorthgateBridge@seattle.gov, (206) 615-0925  
[www.seattle.gov/transportation/northgatepedbridge.htm](http://www.seattle.gov/transportation/northgatepedbridge.htm)



Seattle  
Department of  
Transportation



<sup>1</sup>Washington State Department of Ecology, 2018

## Impacts to wetlands and recreational resources

The wetlands complex on NSC's campus is made up of a series of 7 wetlands. A small portion of one wetland on campus will be permanently impacted during the bridge construction and will be realigned after project completion. The buffers of other wetlands will be temporarily impacted during construction. The North Watercourse that runs along NE 1st Ave will be filled to make way for a protected bike lane. There will be no direct impacts to Thornton Creek downstream as a result of the project.

Some recreational resources will also be affected. The bridge will be built on top of an existing trail running through the NSC campus, referred to as the North Berm Trail. This trail will be relocated south of the bridge and continue to serve as a pathway for people moving through the campus. The project will also temporarily impact some trails and an abandoned ballfield during construction, but these will be restored after construction is complete.



Map showing the Greenbelt Trails system at NSC (Angell, Bryony). Secret Urban Wildlife Hikes Around Seattle and the Eastside, 2014. <https://www.parentmap.com/article/secret-urban-hikes-part-two>

## What are the mitigation efforts we're proposing?

Mitigation measures include:

- Relocating the North Berm Trail, which will be displaced by the bridge
- Wetland and watercourse enhancement/ on- and off-site mitigation
- Safety improvements including security call boxes on the bridge and bridge lighting that provides facial recognition
- Future parking improvements for North Seattle College

### SEPA REVIEW AND HOW TO COMMENT

We'll notify the community on our project website and through email updates when the SEPA documents are issued, where to find them, comment period dates, and how to comment.

Please check the project website at:

**[www.seattle.gov/transportation/NorthgatePedBridge.htm](http://www.seattle.gov/transportation/NorthgatePedBridge.htm)**

**IF YOU NEED THIS INFORMATION TRANSLATED**, please call (206) 615-0925.  
Si necesita traducir esta información al español, llame al (206) 615-0925.

Nếu quý vị cần thông tin này chuyển ngữ sang tiếng Việt xin gọi (206) 615-0925.  
당신이 번역이 정보를 필요로하는 경우에, (206) 615-0925로 전화 해주십시오.

### PROJECT INFORMATION & CONTACT

[NorthgateBridge@seattle.gov](mailto:NorthgateBridge@seattle.gov), (206) 615-0925  
[www.seattle.gov/transportation/northgatepedbridge.htm](http://www.seattle.gov/transportation/northgatepedbridge.htm)



**Seattle**  
Department of  
Transportation



# Photos

Drop-in session #1 at North Seattle College on March 19, 2018



Drop-in session #2 at Aljoja Thornton Place on March 20, 2018



Drop-in session #3 at Neighborcare Health at Meridian on March 21, 2018

