

# Harborview Medical Center Major Institution Master Plan

## Standing Advisory Committee June 29<sup>th</sup>, 2016

# HARBORVIEW INFO

- Harborview Medical Center is owned by King County, governed by a county-appointed board of trustees and managed by the University of Washington.
- Harborview is the only Level 1 adult and pediatric trauma center in the state of Washington.
- Serves as the regional trauma center for Alaska, Montana and Idaho

# HARBORVIEW INFO

## 2015 Statistics

Inpatient beds.....	413
Employees.....	4,476
Admissions.....	17,362
Clinic visits.....	247,615
Emergency Department visits.....	62,217

# MIMP

Harborview's last Major Institution Master Plan was adopted in October 2000.

## Master Plan Objectives

1. Meet essential patient care needs
2. Upgrade seismic standards for patient care areas
3. Develop a campus plan that respects community context
4. Address anticipated increase in clinical and support services
5. Phase development based on constructability and funding

# Past Projects and Current Assessments



# MIMP

**Planned Projects – Development sites meant to be developed first.**

**Potential Projects- Development sites meant to be developed further into the future.**

**The code allows for development sites to move from Potential to Planned or visa versa.**

# HMC CAMPUS PLAN

Major Institution  
Overlay boundary

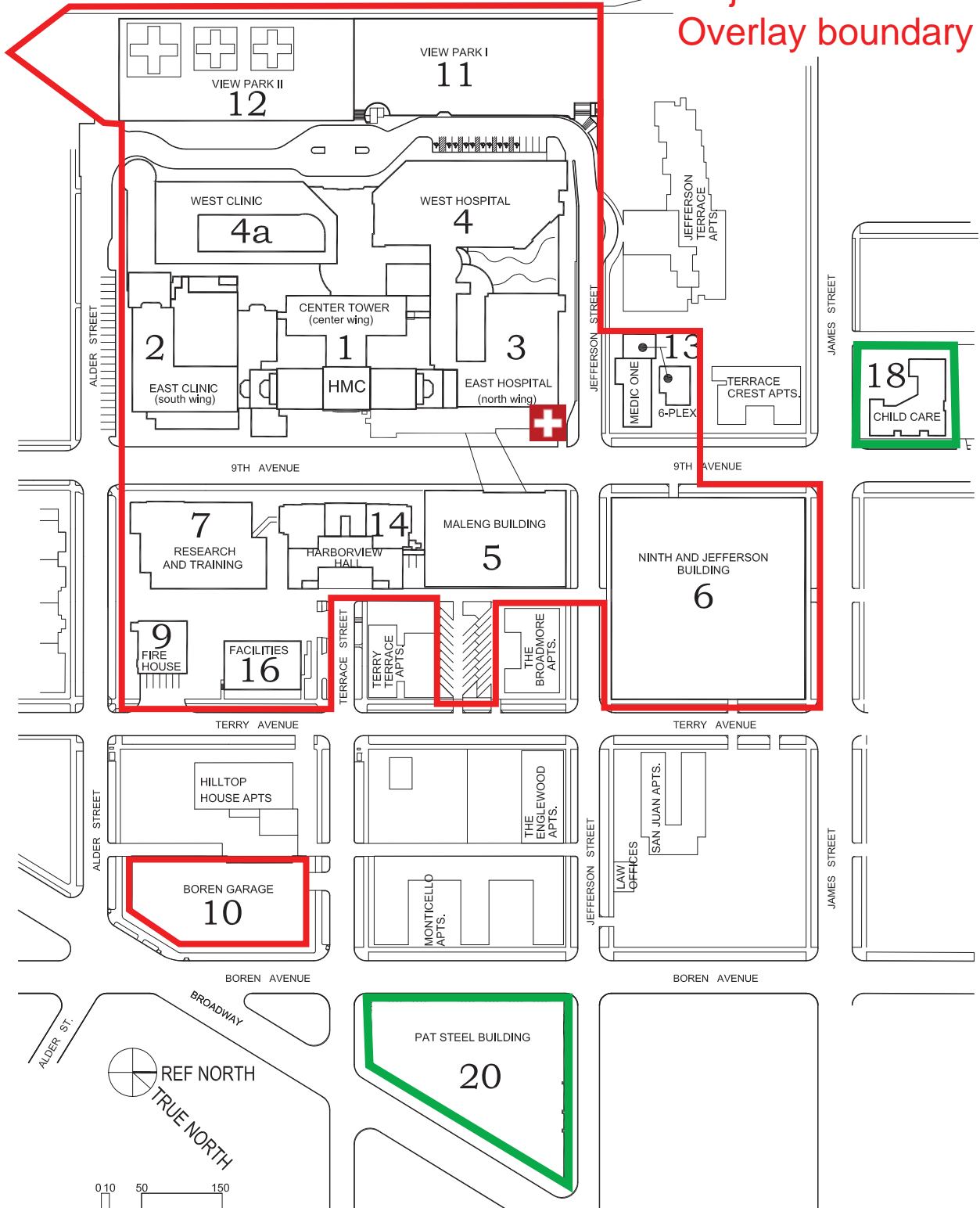

# HMC CAMPUS PLAN

## Planned Projects

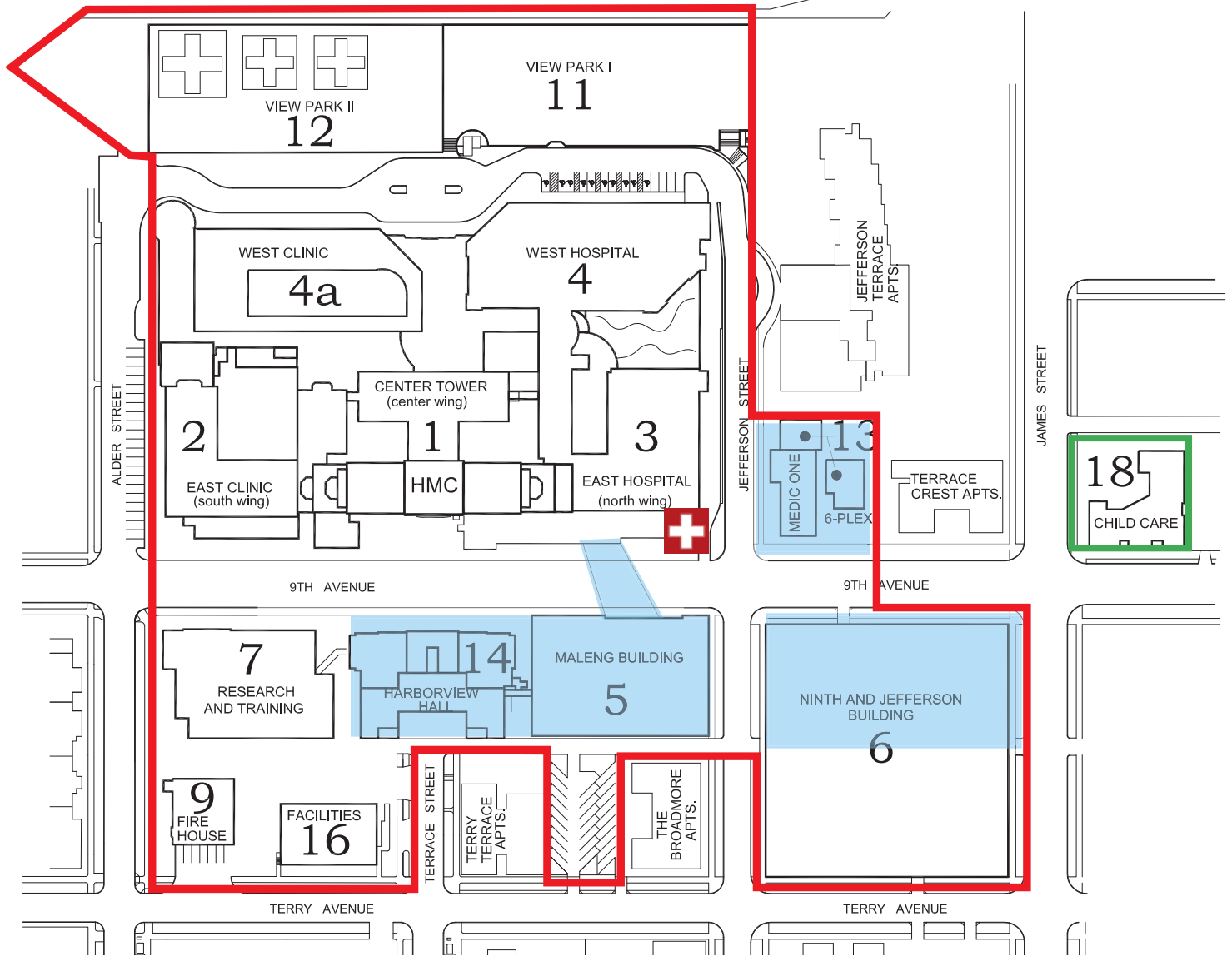



# HMC CAMPUS PLAN

Planned Projects and Potential Projects

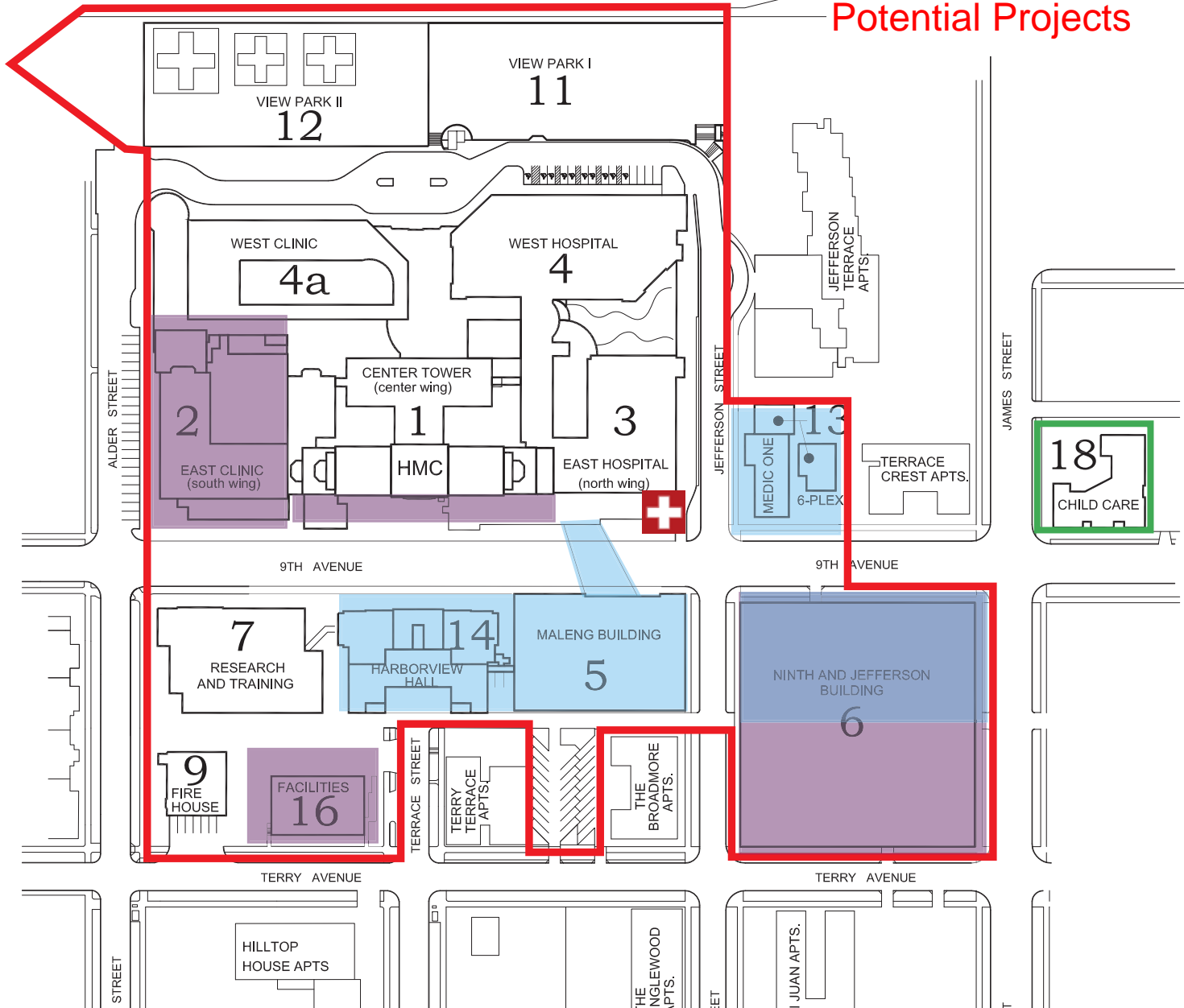



# HMC CAMPUS PLAN

Remaining Planned  
and Potential sites

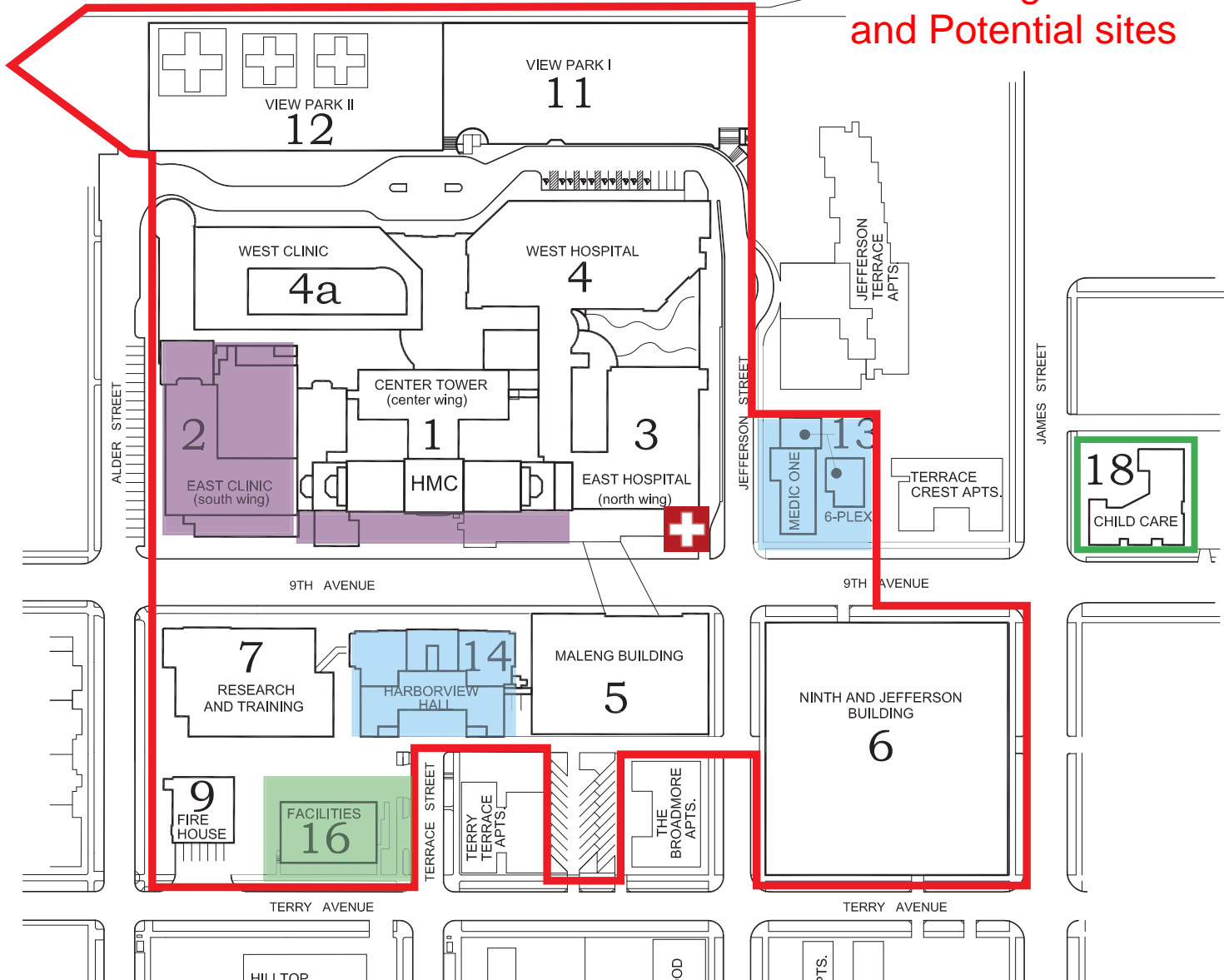

PROPOSED  
ADAPTIVE  
RE-USE  
SITE PLAN

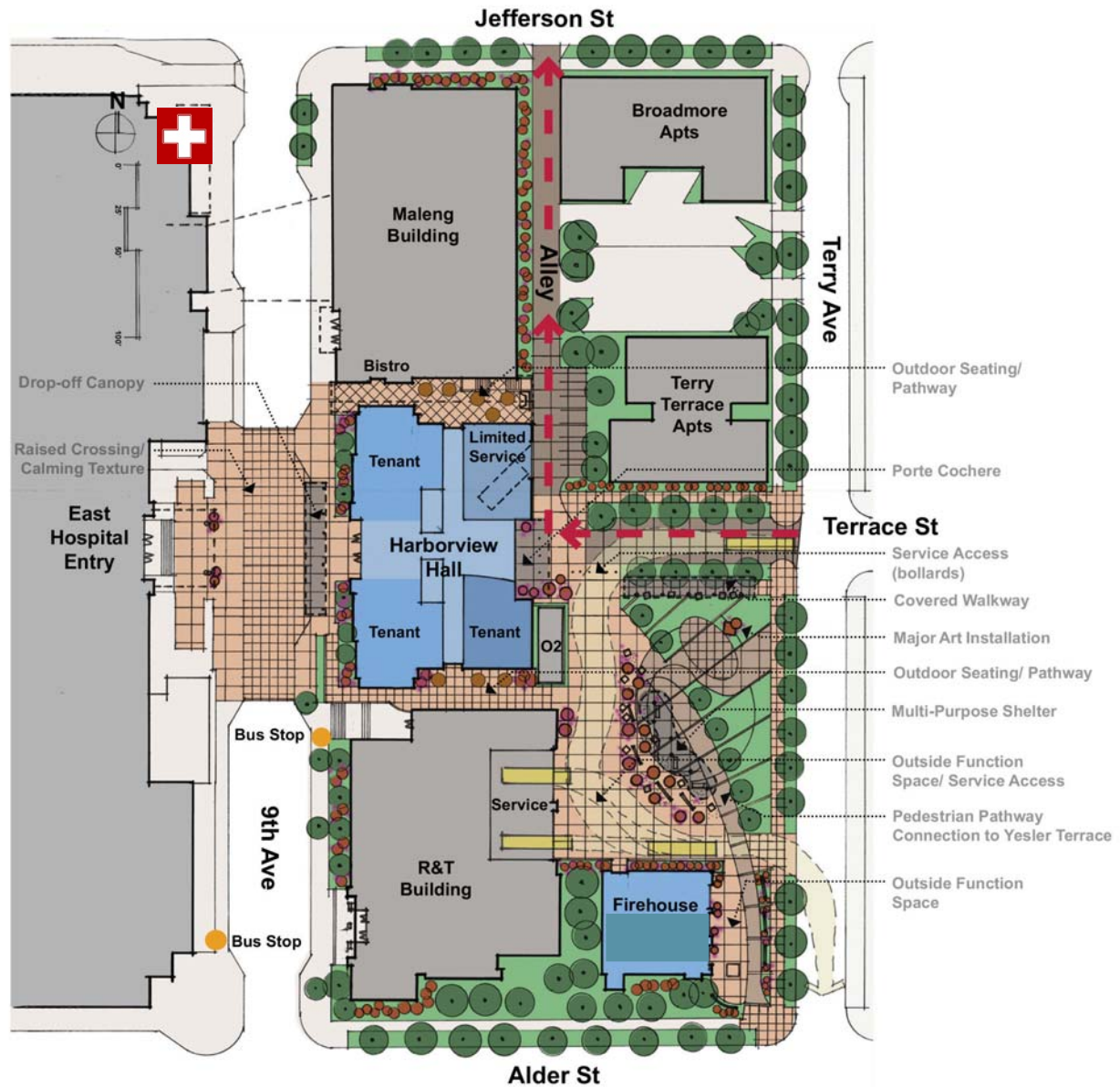

# MIMP

## Current Work –

- Architectural consultant team assessing the Center Tower and East Clinic.
- King County, UW Medicine and Harborview to evaluate assessment results and then begin planning for a potential 2018 voter approved measure.
- The Harborview SAC will be consulted when next steps are determined.